

INDEX OF SHEETS

1. Title Sheet
2. Typical (3" Bit. Conc. Pavement - Item 301 Mod.)
3. Drainage and Item Quantity Sheet
4. Earthwork Sheet
5. Earthwork Summary Sheet
- 6-10. Plan and Profile Sheets
11. B-1 Banking Tables 7/17/67 R
12. B-5 Slope Grading 3/10/65
13. B-2 CRN Roadways 3/3/71
14. E-31 F.A. Construction Identification Signs 2/17/71
15. E-32 Road Construction Approach Signs 5/6/71 R
16. G-1 Wood Guide and Wood Marker Posts 12/30/65 R
17. J-1 Project Markers and Boundary Markers 3/10/65
- 18-27. Mainline Sections
- 28-29. Approach Sections
30. R.O.W. Detail Sheet

RECORD PLANS  
MATERIALS

PAVEMENT AREA  
8,333 S.Y.

SUBBASE OF GRAVEL & SUBBASE OF SAND—BIGELOW PIT—CROWN POINT, N.Y.  
PLANT MIXED BASE COURSE & BITUMINOUS CONCRETE—L.M. PIKE & SON—NEW HAVEN, VT.  
TACK COAT TYPE III—MOBIL OIL CO.—ALBANY, N.Y.  
GRITS—DEMERS—SHELBURNE, VT.  
METAL CULVERT PIPE—NORTHEASTERN CULVERT CORP.—WESTMINSTER, VT.  
REINFORCED CONCRETE PIPE, GUARD RAIL & EROSION CONTROL ITEMS—S.T. GRISWOLD & CO., INC.—WILLISTON, VT.  
PROJECT MARKERS—HUME PIPE CO.—WINDSOR, VT.

CONTRACTOR  
CHAMPLAIN CONSTRUCTION CO.  
MIDDLEBURY, VT.  
RESIDENT ENGINEER—ROBERT E. BRADY.  
INSPECTOR—MARK GRAVEL  
RECORD PLANS—M. LAVIN.

CONTRACT  
DATED—DECEMBER 6, 1971.  
STARTED—JANUARY 3, 1972.  
COMPLETED—JULY 27, 1972.  
ACCEPTED—JULY 28, 1972.

STATE OF VERMONT  
DEPARTMENT OF HIGHWAYS

PROPOSED IMPROVEMENT

FEDERAL AID SECONDARY PROJECT

TOWN OF ADDISON  
COUNTY OF ADDISON  
CHIMNEY POINT—ADDISON ROAD  
VERMONT ROUTE #17

BEGINNING AT A POINT APPROXIMATELY 3.304 MILES NORTHEASTERLY OF THE CROWN POINT, N.Y.—ADDISON, VT. TOWN LINE AND EXTENDING NORTHEASTERLY 0.663 MILE.  
LENGTH OF PROJECT 3,500 FEET = 0.663 MILE

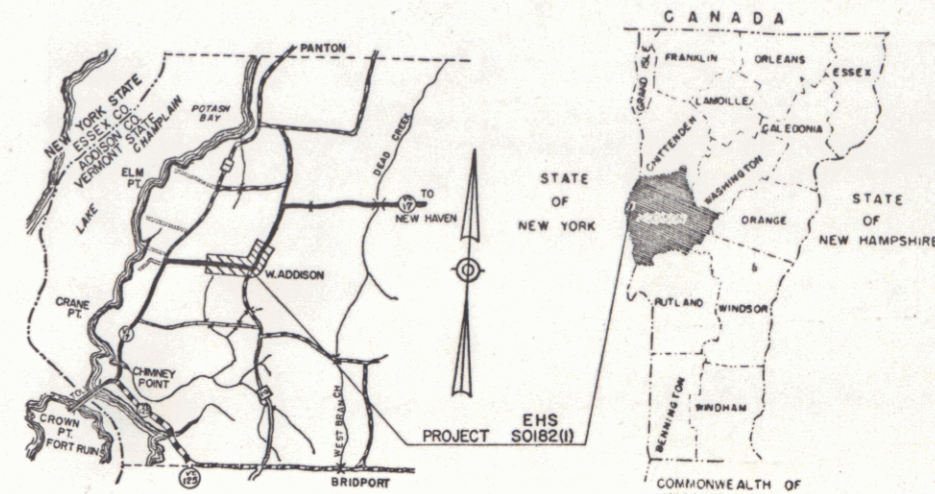

*M*

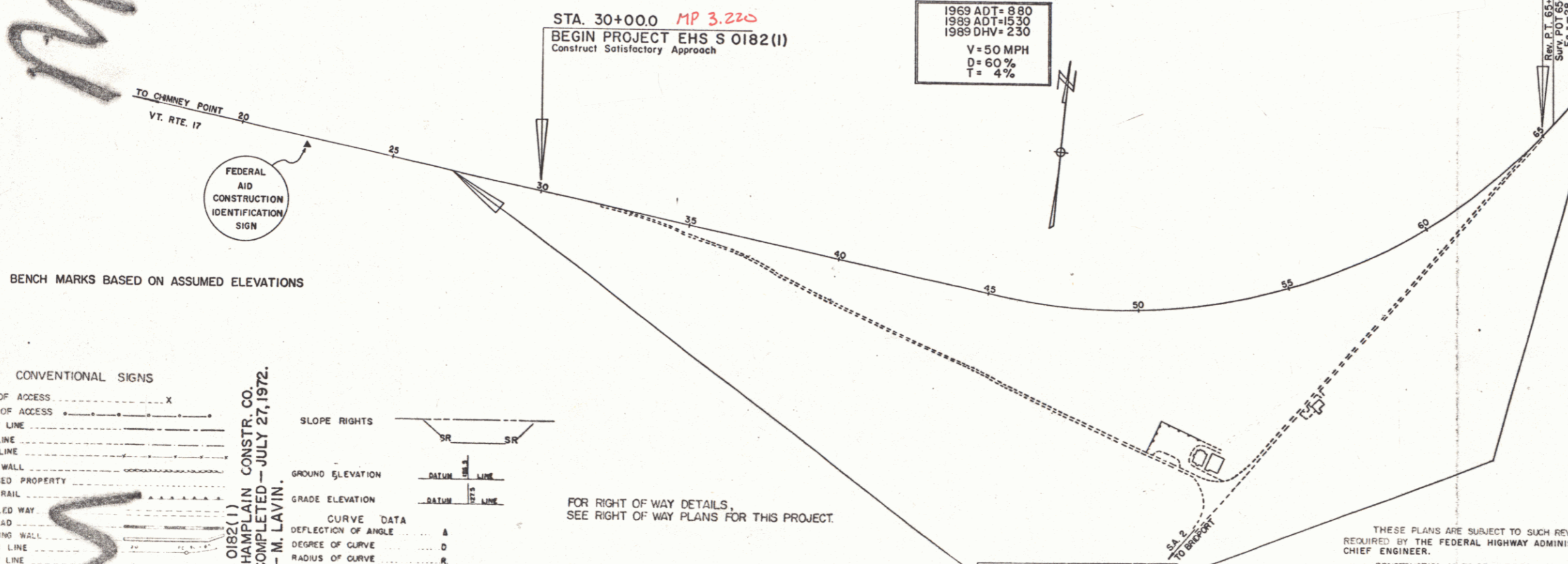

BENCH MARKS BASED ON ASSUMED ELEVATIONS

CONVENTIONAL SIGNS

- POINT OF ACCESS
- LIMITS OF ACCESS
- COUNTY LINE
- TOWN LINE
- FENCE LINE
- STONE WALL
- UNFENCED PROPERTY
- GUARD RAIL
- TRAVELED WAY
- RAILROAD
- RETAINING WALL
- CENTER LINE
- SURVEY LINE
- CULVERT
- DROP INLET
- TROLLEY POLE
- POWER POLE
- TELEPHONE POLE
- TREES
- HEDGE
- F.A. CONSTRUCTION IDENTIFICATION SIGNS

ADDISON EHS S 0182 (I) CHAMPLAIN CONSTR. CO. CONSTRUCTION COMPLETED—JULY 27, 1972. RECORD PLANS—M. LAVIN.

- SLOPE RIGHTS
- GROUND ELEVATION
- GRADE ELEVATION
- CURVE DATA
- DEFLECTION OF ANGLE
- DEGREE OF CURVE
- RADIUS OF CURVE
- TANGENT DISTANCE
- LENGTH OF CURVE
- EXTERNAL DISTANCE
- POINT OF INTERSECTION
- POINT OF CURVE
- POINT OF TANGENT
- POINT ON TANGENT
- POINT ON SUB-TANGENT
- POST
- R.O.W. LIMITS

FOR RIGHT OF WAY DETAILS, SEE RIGHT OF WAY PLANS FOR THIS PROJECT.

CONSTRUCTION AREA  
Sta. 27+00.0 Sta. 68+28.5

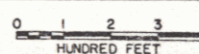

THESE PLANS ARE SUBJECT TO SUCH REVISIONS AS MAY BE REQUIRED BY THE FEDERAL HIGHWAY ADMINISTRATION OR THE CHIEF ENGINEER.  
CONSTRUCTION IS TO BE CARRIED ON IN ACCORDANCE WITH THESE PLANS AND THE STANDARD SPECIFICATIONS FOR HIGHWAY AND BRIDGE CONSTRUCTION DATED APRIL 1964, AS APPROVED BY THE BUREAU OF PUBLIC ROADS ON OCTOBER 12, 1964, INCLUDING ALL SUBSEQUENT APPROVED REVISIONS AND SUCH REVISED SPECIFICATIONS AND SPECIAL PROVISIONS AS ARE INCORPORATED IN THESE PLANS.

RIGHT-OF-WAY DIVISION  
TOWN FILE  
PERPETUAL  
Town of VT 17  
(To Be Returned To R.O.W. Division)

Pin # 00R521

NOTE: ANY FURTHER INFORMATION CONCERNING FINAL QUANTITIES, AMOUNTS OR OTHER DETAILS RELATIVE TO THIS PROJECT MAY BE FOUND IN EITHER THE FIELD BOOKS OR THE ESTIMATE FILE.

APPROVED <i>K.M. Smith</i> SECONDARY ENGINEER DATE <u>April 22, 1970</u>	APPROVED <i>Robert E. Brady</i> DISTRICT ENGINEER DATE <u>4-27-70</u>	APPROVED <i>[Signature]</i> CONSTRUCTION ENGINEER DATE <u>1 May 20</u>	APPROVED <i>[Signature]</i> DIRECTOR R.O.W. DATE <u>5/1/70</u>	APPROVED <i>[Signature]</i> HIGHWAY ENGINEER DATE <u>5/1/70</u>	APPROVED <i>[Signature]</i> DISTRICT ENGINEER DATE <u>5/1/70</u>	APPROVED <i>[Signature]</i> DATE <u>5/1/70</u>
--	---	--	--	---	--	---

DEPARTMENT OF TRANSPORTATION FEDERAL HIGHWAY ADMINISTRATION	
APPROVED	DATE
DIVISION ENGINEER	DATE
PROJECT EHS S No. <u>0182 (I)</u>	
SHEET <u>1</u> OF 29 SHEETS	

PLAN  
 DRAWN BY: G. Gagnon  
 CHECKED BY: A. Gagnon  
 DATE: 11/27/00  
 PROJECT: Tracel

PROFILE  
 DRAWN BY: G. Gagnon  
 CHECKED BY: A. Gagnon  
 DATE: 11/27/00  
 PROJECT: Tracel

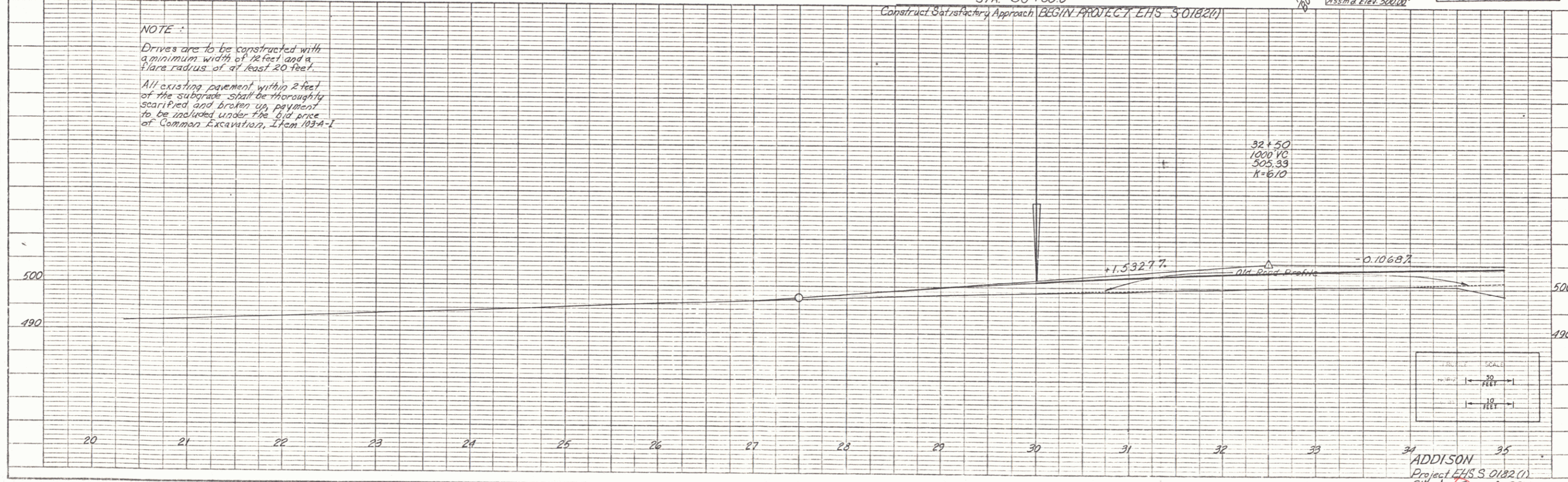
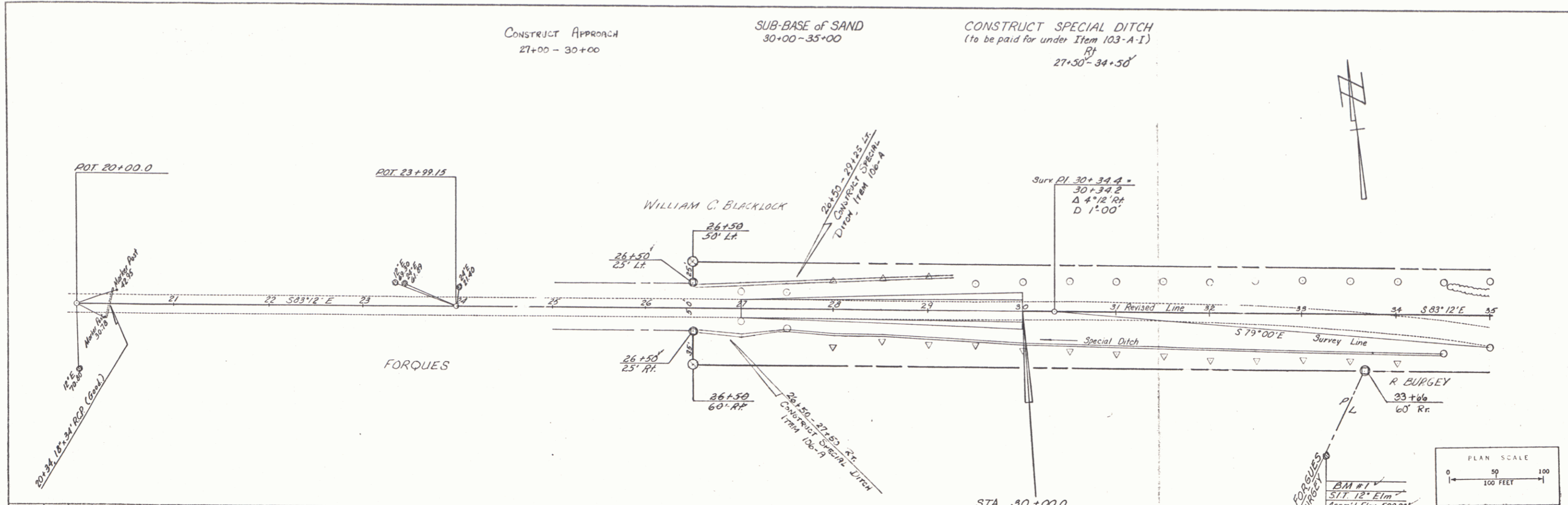
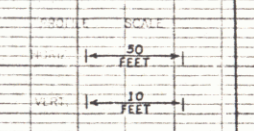
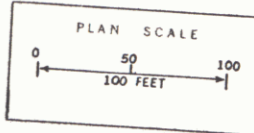
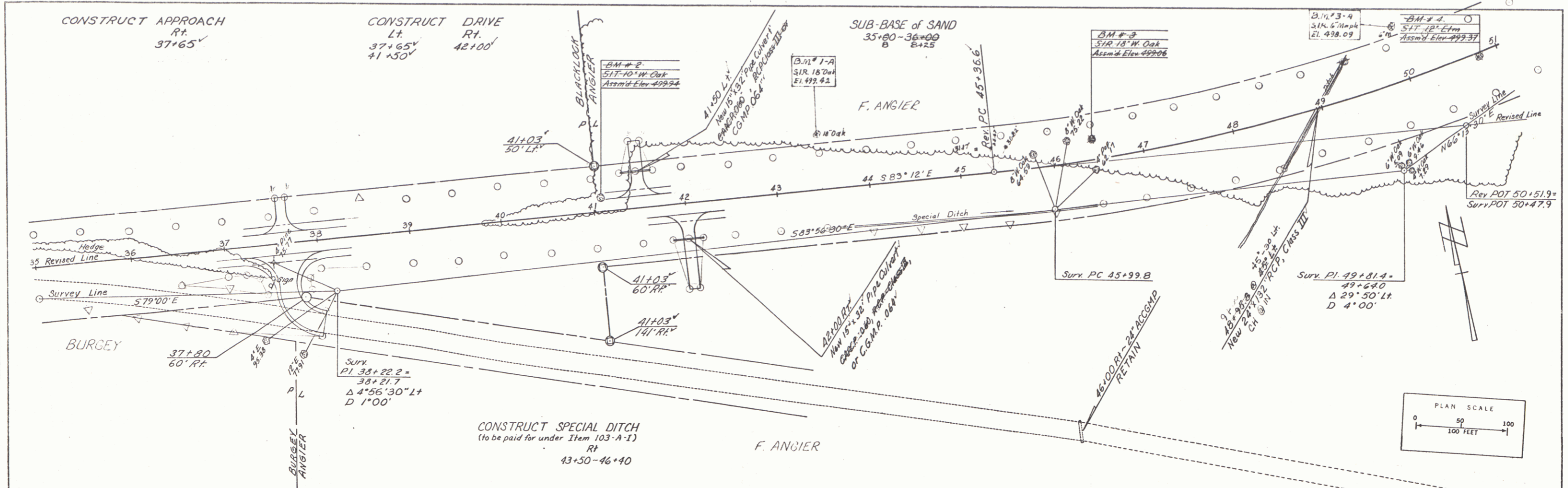

PLATE 1: PLAN PROFILE  
 49 7012 IMPREGAL™  
 49 7012 IMPREGAL™

PLAN  
 DRAWN BY: F. Angier  
 CHECKED BY: A. Griffin  
 DATE: Mar 27  
 NO. 1

PROFILE  
 DRAWN BY: F. Angier  
 CHECKED BY: A. Griffin  
 DATE: Mar 27  
 NO. 1



ADDISON  
 Project 148 S-0182(1)  
 Sheet 2 of 22

EXCAVATION AND REMOVAL OF ROAD SURFACES AND/OR PAVEMENTS ITEM 119

CONSTRUCT APPROACH

CONSTRUCT SPECIAL DITCH  
(to be paid under Item 103-A-1)

CONSTRUCT DRIVE

Rt  
59+00-62+00  
2+50

Rt  
58+80  
SUB-BASE OF SAND  
63+30-65+00  
2+75

Rt  
62+75-66+00

Rt  
57+25  
62+60  
65+25  
63+50  
63+76  
SIT 12" Elm  
Assm'd Elev 498.48

DM # 6  
SIT 15" W. Oak  
Assm'd Elev 496.69

Rev Curve Data  
Δ 60° 27' 30" Lt  
D 3° 00'  
R 1909.86'  
T 1112.9'  
L 2015.3'  
E 300.6'  
Bank 3/8" in 12"

SIT 12" Elm  
Assm'd Elev 498.48

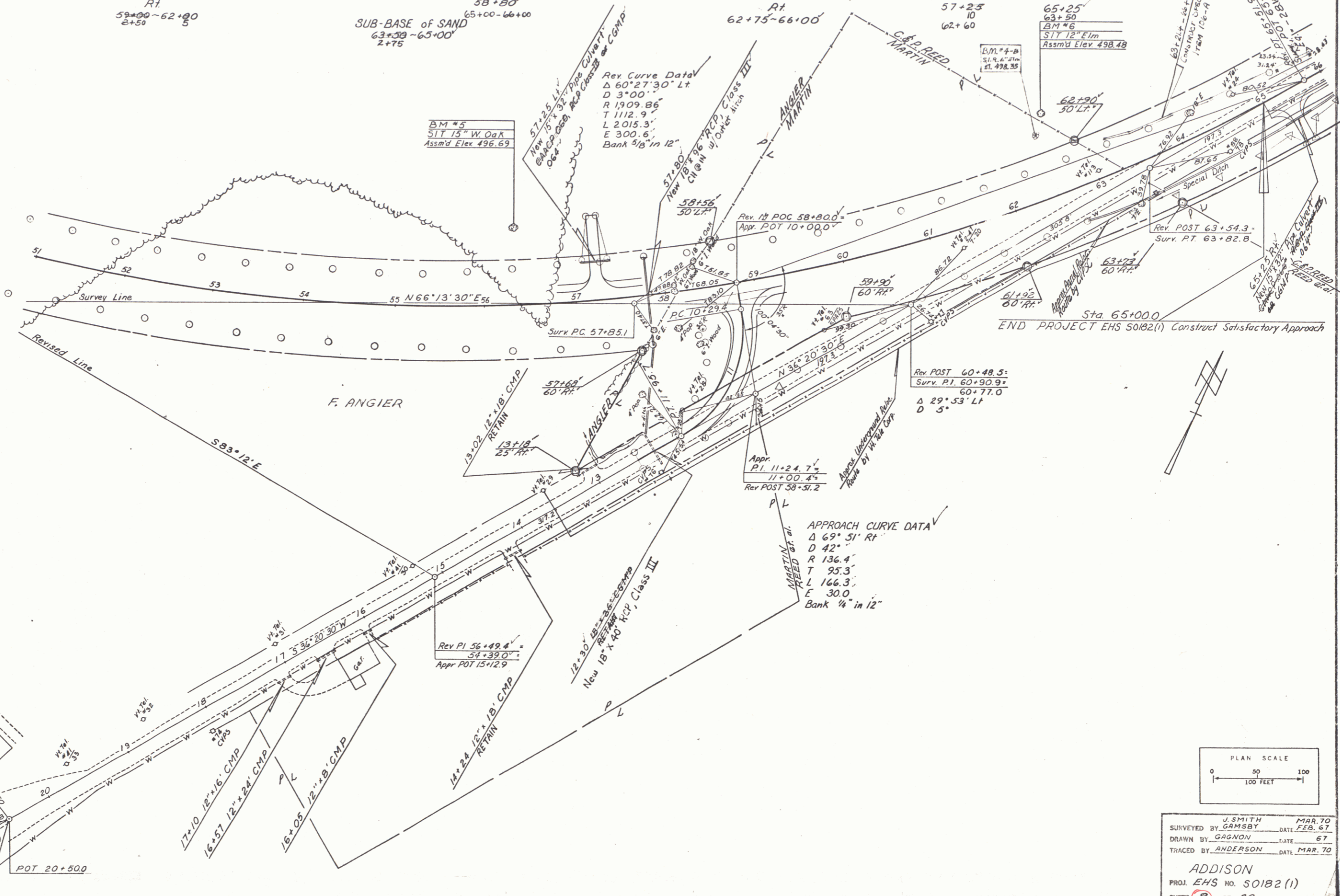

PLAN SCALE  
0 50 100  
100 FEET

J. SMITH MAR 70  
SURVEYED BY GAMSBY DATE FEB 67  
DRAWN BY GAGNON DATE 67  
TRACED BY ANDERSON DATE MAR 70

ADDISON  
PROJ. EHS NO. 50182(1)  
SHEET 8 OF 29

D-7

DATE: 10/20/00  
 DRAWN BY: [Signature]  
 CHECKED BY: [Signature]  
 NO. 1

DATE: 10/20/00  
 DRAWN BY: [Signature]  
 CHECKED BY: [Signature]  
 NO. 1

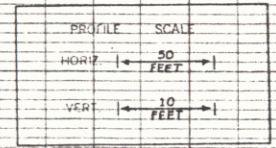
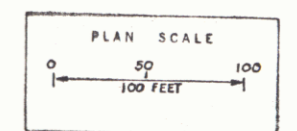
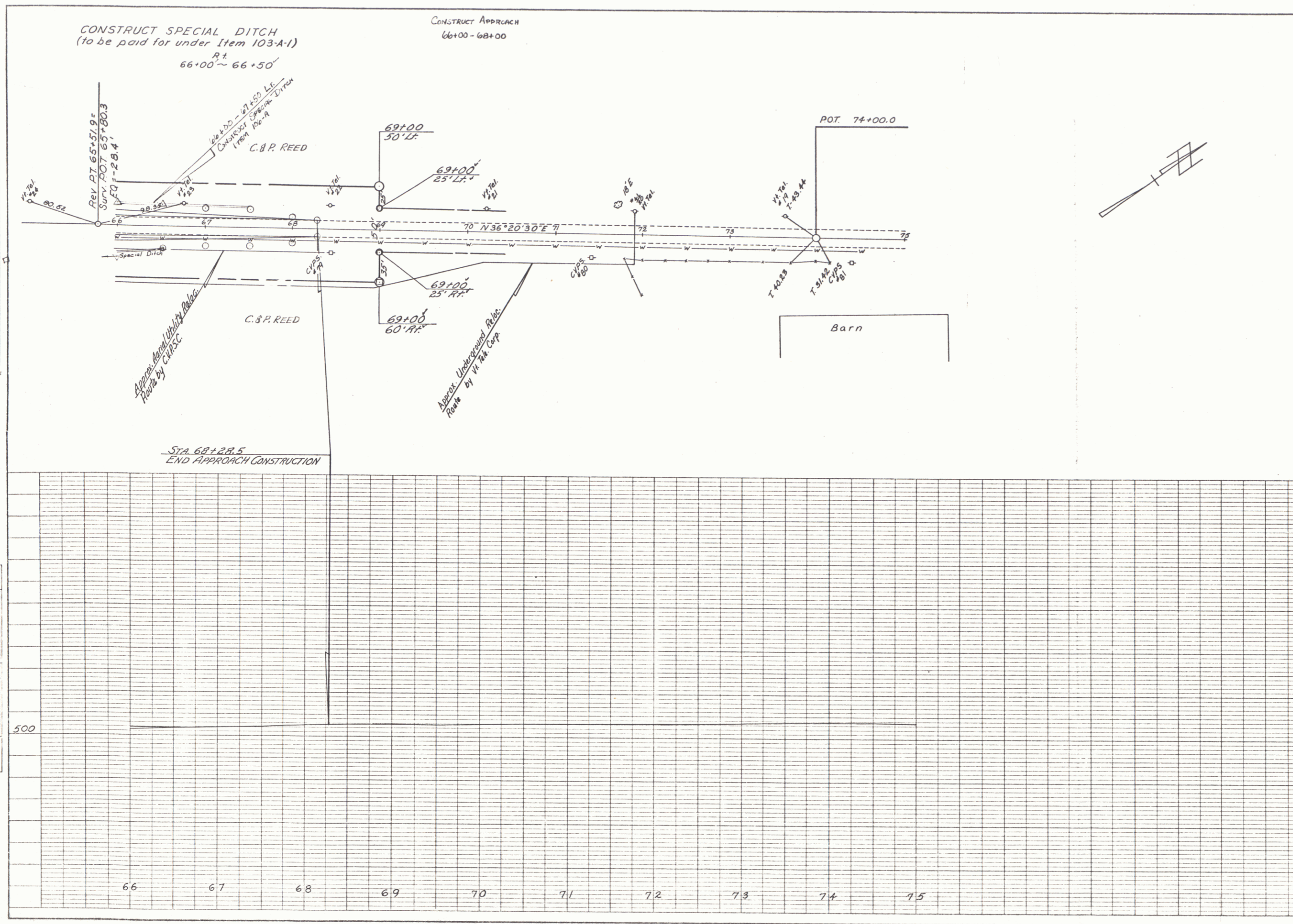

ADDISON  
 PROJECT # S 0102(1)  
 SHEET 10 of 29

5