

WOOD GUARD RAIL REQUIRED

Station	Left	Right
148+74	24 ft.	24 ft.
152+50	24 ft.	24 ft.

NEW REINFORCED CONG. PIPE CULVERTS REQUIRED

Station	Diam	Length	Conc. B	Steel
148+74	18"	40.00	3404	30"
154+20	15"	36.00		

FED. ROAD DIST. NO.	STATE	FED. AID PROJ. NO.	FISCAL YEAR	SHEET NO.	TOTAL SHEETS
9	Vt.		1929	12	33

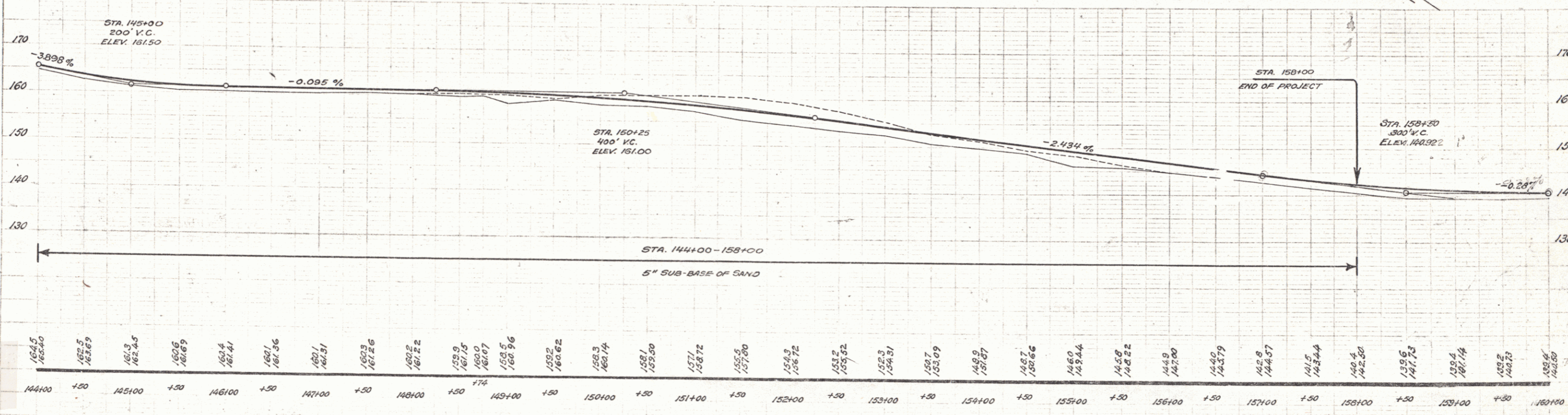
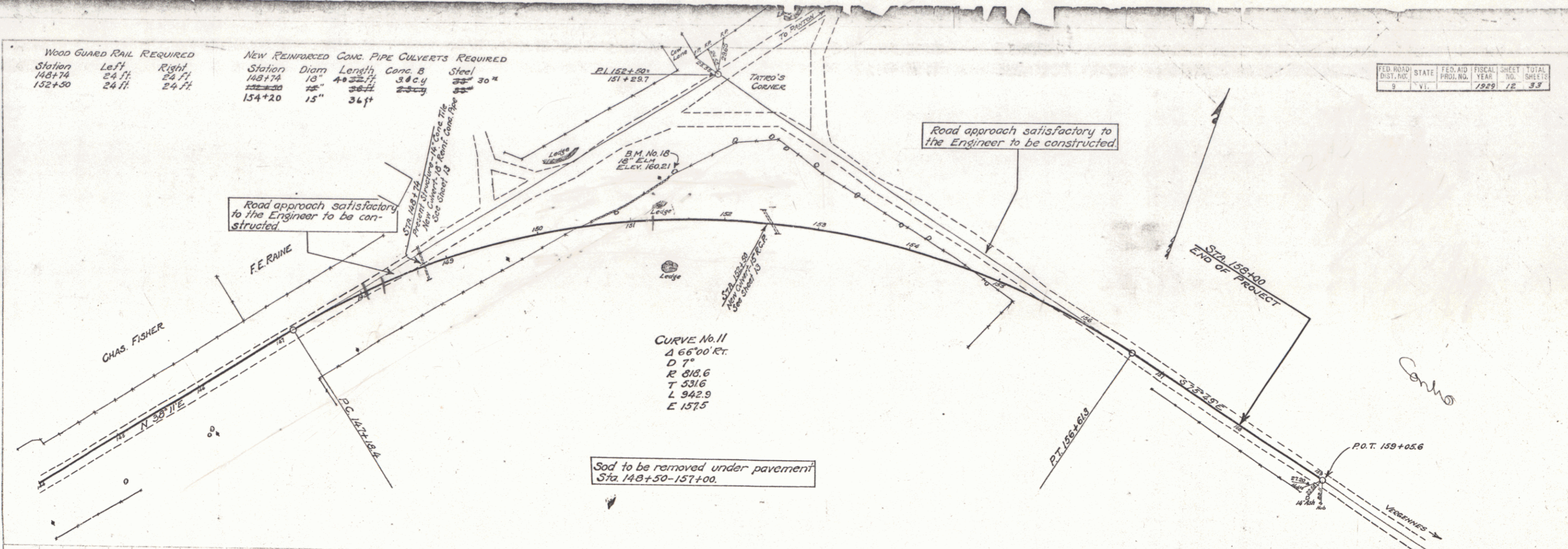

B.M. No. 18 - Spike in 18" Elm, Lt. of Sta. 151+50 - Elev. 160.21