

INDEX OF SHEETS

SHEET NO. 1	TITLE PAGE
2	TYPICAL CROSS-SECTION OF IMPROVEMENT DOUBLE TRACK COAT OF REFINED TAR WITH PEASSTONE SEAL, ITEM 316 A (INDOOR 1951)
3	BANKING AND WIDENING TABLES
4	QUANTITY SHEET (ITEMS)
5	QUANTITY SHEET (DRAINAGE)
6-7	EARTHWORK SHEETS
8-13	PLAN AND PROFILE SHEETS
14-26	CROSS-SECTIONS
27	PRELIMINARY INFORMATION SHEET
28	BRIDGE PLAN AND SECTION
29	DETAILS OF ABUTMENTS NOS. 1 AND 2
30	DETAILS OF PIERS NOS. 1 AND 2
31-35	CHANNEL SECTIONS
36	EARTHWORK SHEET
37	PRELIMINARY INFORMATION SHEET
38	BRIDGE PLAN AND SECTION
39	DETAILS OF ABUTMENT NO. 1
40	DETAILS OF PIERS NOS. 1 AND 2
41	DETAILS OF ABUTMENT NO. 2
42-44	CHANNEL SECTIONS
45	EARTHWORK SHEET
46	PRELIMINARY INFORMATION SHEET
47	BRIDGE PLAN AND SECTION
48	DETAILS OF ABUTMENT NO. 1
49	DETAILS OF PIER NO. 1
50	DETAILS OF PIER NO. 2
51	DETAILS OF ABUTMENT NO. 2
52	BEAM LAYOUT AND REINFORCING STEEL SUPERSTRUCTURE
53-55	CHANNEL SECTIONS
56	EARTHWORK SHEET
57	STANDARD STRUCTURE SHEET S 40 BARRICADES, SIGNS AND LIGHTS (ROADWAY)
58	STANDARD STRUCTURE SHEET S 41 TYPICAL GRADING
59	STANDARD STRUCTURE SHEET S 45-49 T.W.O. CABLE GUARD RAIL
60	STANDARD STRUCTURE SHEET CONSTRUCTION DETAILS
61	STANDARD STRUCTURE SHEET S 47-49 PIPE CULVERTS
62	STANDARD STRUCTURE SHEET SB 5-S1 BRIDGE RAILING DETAILS
63	STANDARD STRUCTURE SHEET SB II BARRICADES, SIGNS AND LIGHTS (BRIDGE)
64	STANDARD STRUCTURE SHEET SB 20 DETAILS A, D, I, K, AND L
65	STANDARD STRUCTURE SHEET S1 B-30 (H-20) SUPERSTRUCTURE
66	STANDARD STRUCTURE SHEET (END AND ANCHORAGE AT BRIDGE APPROACH)
67	STANDARD STRUCTURE SHEET S 51-56 STEEL BEAM GUARD-RAIL
68	STANDARD STRUCTURE SHEET S 52-56 STEEL BEAM GUARD-RAIL

**STATE OF VERMONT
STATE HIGHWAY DEPARTMENT**

**PLAN AND PROFILE OF PROPOSED
STATE HIGHWAY**

**TOWN OF MONTGOMERY
COUNTY OF FRANKLIN
VERMONT ROUTE 118**

BEGINNING AT A POINT APPROXIMATELY 500 FT. SOUTHWESTERLY OF THE INTERSECTION OF ROUTE 118 AND STATE AID ROAD NO. 1, TO SOUTH RICHFORD AND EXTENDING NORTHWESTERLY 0.658 MILE WITH TWO BRIDGES OVER TROUT RIVER; ONE BRIDGE OVER WEST HILL BROOK, APPROXIMATELY 1.8, 2.0 AND 2.1 MILES SOUTHERLY RESPECTIVELY OF THE MONTGOMERY-ENOSBURG TOWN LINE.

LENGTH OF BRIDGES 491.09 FEET = 0.093 MILE
LENGTH OF ROADWAY 2,981.11 FEET = 0.565 MILES
LENGTH OF PROJECT 3,472.20 FEET = 0.658 MILES

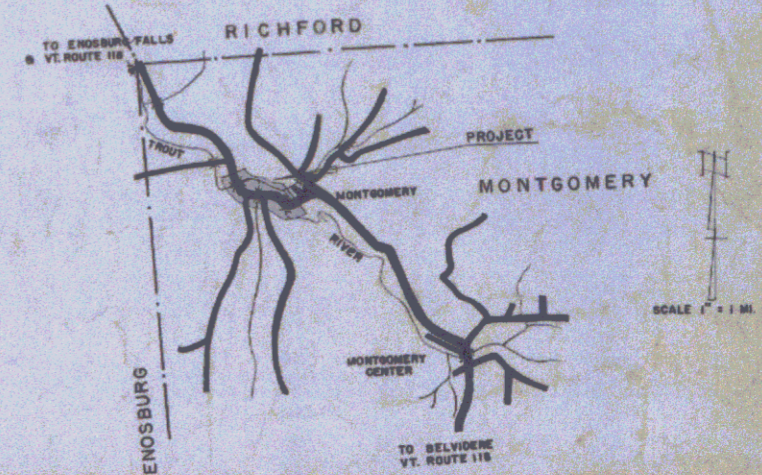

PROJECT NAME & NUMBER		TYPE	PAVEMENT AREA
MONTGOMERY S 33 (2)		DEL TACK COAT	9074 S.Y.
RECORD PLANS			
MATERIALS			
SUB-BASE OF GRAVEL	LOCAL RIVER GRAVEL	ACCGMP NEW ENGL. MET. CULY CO., BOSTON, MASS.	
CR. GRAVEL	LEWIS & SCOTT CRUSHER, BAKERSFIELD	BIT. CONC.	MUNICIPAL PLANT, BURLINGTON
TAR	KOPPERS, EVERETT, MASS.	BIT. CONC. AGG.	KIRBY & STANLEY PLANTS, BURL.
FEASTONE CONC. AGG.	NADEAU PLANT, JOHNSON	GUARD RAIL	BETHLEHEM ST. CO., SPARROWS PT. N.J.
CEMENT	LEHIGH, ALSEN, N.Y.	GRANITE CURB	FLETCHER, CHELMSFORD, MASS.
REIN. STEEL	VT. STEEL	RCP	VT. CONC. PIPE CO., WINDSOR
CONTRACTOR	OSCAR L. OLSON	CONTRACT DATED	JULY 2 1951
RES. ENGINEER	H.F. EARLE - H.G. BAREIS	CONTRACT STARTED	JULY 3 1951
INSPECTORS	T.P. PHILLO - S.R. JENKINS	CONTRACT COMPLETED	JULY 23 1953
RECORD PLANS	K. EASTMAN	CONTRACT ACCEPTED	JULY 23 1953

STANDARD STRUCTURE SHEETS APPROVED BY THE CHIEF ENGINEER, VERMONT STATE DEPARTMENT OF HIGHWAYS.
S 40 JUNE 10, 1950

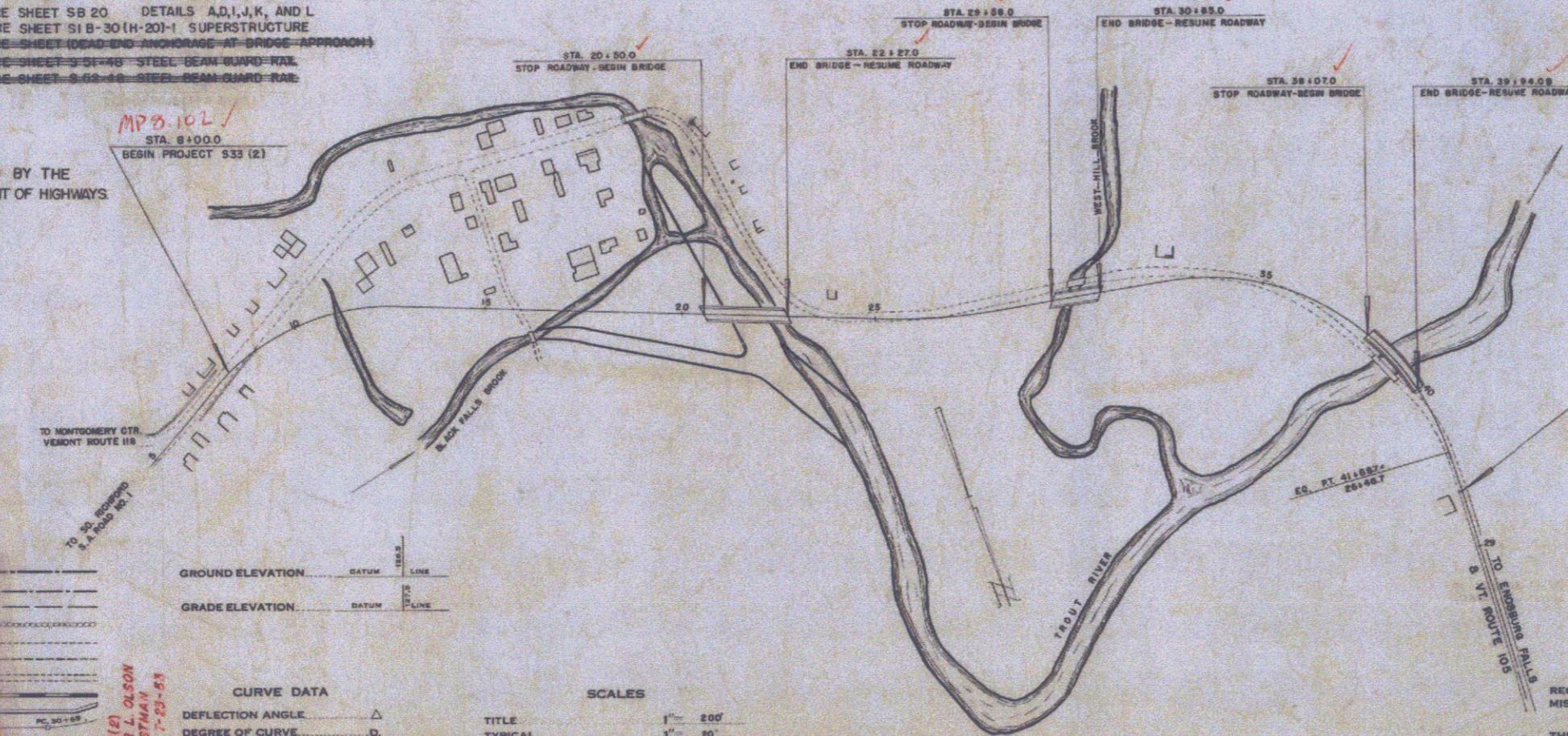

CURVE DATA

DEFLECTION ANGLE	Δ
DEGREE OF CURVE	D
RADIUS OF CURVE	R
TANGENT DISTANCE	T
LENGTH OF CURVE	L
EXTERNAL DISTANCE	E
POINT OF INTERSECTION	P. I.
POINT OF CURVE	P. C.
POINT OF TANGENT	P. T.
POINT ON TANGENT	P. O. T.

SCALES

TYPICAL	1" = 200'
PLAN	1" = 50' & 80'
PROFILE HORIZONTAL	1" = 50' & 20'
PROFILE VERTICAL	1" = 5' & 20"
CROSS SECTIONS	1" = 5' & 10"

MONTGOMERY
PROJECT S 33 (2)
DESIGNED BY OSCAR L. OLSON
CHECKED BY H.F. EARLE
DATE JULY 23 1951
LOCATION N.W. From Intersection Route 118 & 105
Toward Enosburg & Route 118

APPROVED DEC 15 1950
APPROVED DEC 15 1950
APPROVED DEC 27 1950
PROJECT S No. 33(2) FILED
SHEET 1 OF 68

Pin # 00R515

APPROVED DEC. 15, 1950
H.E. August
CHIEF ENGINEER

SUBMITTED BY ORDER OF THE STATE HIGHWAY BOARD

NOTE: ALL RECORD PLANS MUST BE SUBMITTED TO THE BUREAU OF PUBLIC ROADS FOR APPROVAL. FAILURE TO DO SO WILL RESULT IN THE RECORD PLANS BEING REJECTED.

DEPARTMENT OF COMMERCE
BUREAU OF PUBLIC ROADS

RECOMMENDED FOR APPROVAL

DISTRICT ENGINEER DATE

APPROVED

DIVISION ENGINEER DATE

THESE PLANS ARE SUBJECT TO SUCH REVISIONS AS MAY BE REQUIRED BY THE BUREAU OF PUBLIC ROADS OR THE COMMISSIONER OF HIGHWAYS.
CONSTRUCTION IS TO BE CARRIED ON IN ACCORDANCE WITH THE PLANS AND THE STANDARD ROAD AND BRIDGE SPECIFICATIONS OF 1948, AS APPROVED JULY 25, 1948 BY THE BUREAU OF PUBLIC ROADS INCLUDING ALL SUBSEQUENT APPROVED REVISIONS AND SUCH REVISED SPECIFICATIONS AND SPECIAL PROVISIONS AS ARE SUBMITTED WITH THE PLANS.