

INDEX OF SHEETS

|           |                                      |
|-----------|--------------------------------------|
| SHEET NO. | TITLE PAGE                           |
| 1         | TITLE PAGE                           |
| 2         | TYPICAL CROSS-SECTION OF IMPROVEMENT |
| 3         | BANKING AND WIDENING TABLES          |
| 4         | PLAN AND PROFILE                     |
| 5         | Standard Structure Sheet S-28        |
| 6         | S-29                                 |
| 7         | Cross Sections                       |
| 8         | Drainage Outlets                     |

STATE OF VERMONT  
STATE HIGHWAY DEPARTMENT

PLAN AND PROFILE OF PROPOSED  
STATE HIGHWAY

TOWN OF MONTGOMERY — VT ROUTE 118  
A PORTION OF MAIN STREET IN THE VILLAGE OF MONTGOMERY CENTER  
BEGINNING ABOUT 500 FEET EAST OF CEMETERY AND ENDING  
200 FEET SOUTH OF THE BRIDGE OVER WADE BROOK.

Pin# 00RS14  
Project ST 33P-1  
Date 1/1/1940

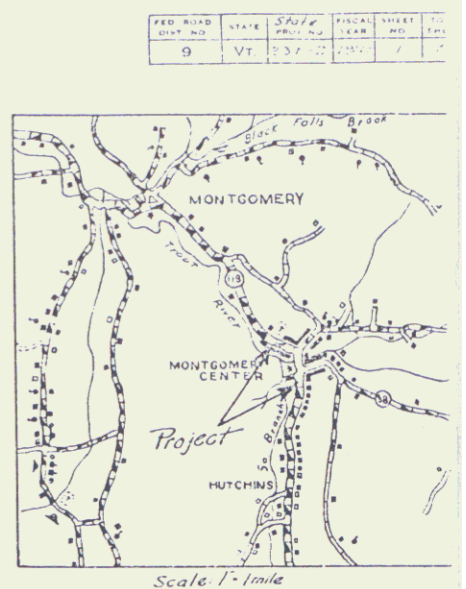

[To Be Returned to H. O. R. Division]  
1/118  
126  
MONTGOMERY  
MONTGOMERY  
MONTGOMERY

LENGTH OF PROJECT 2046.0 FEET • 0.387 MILES

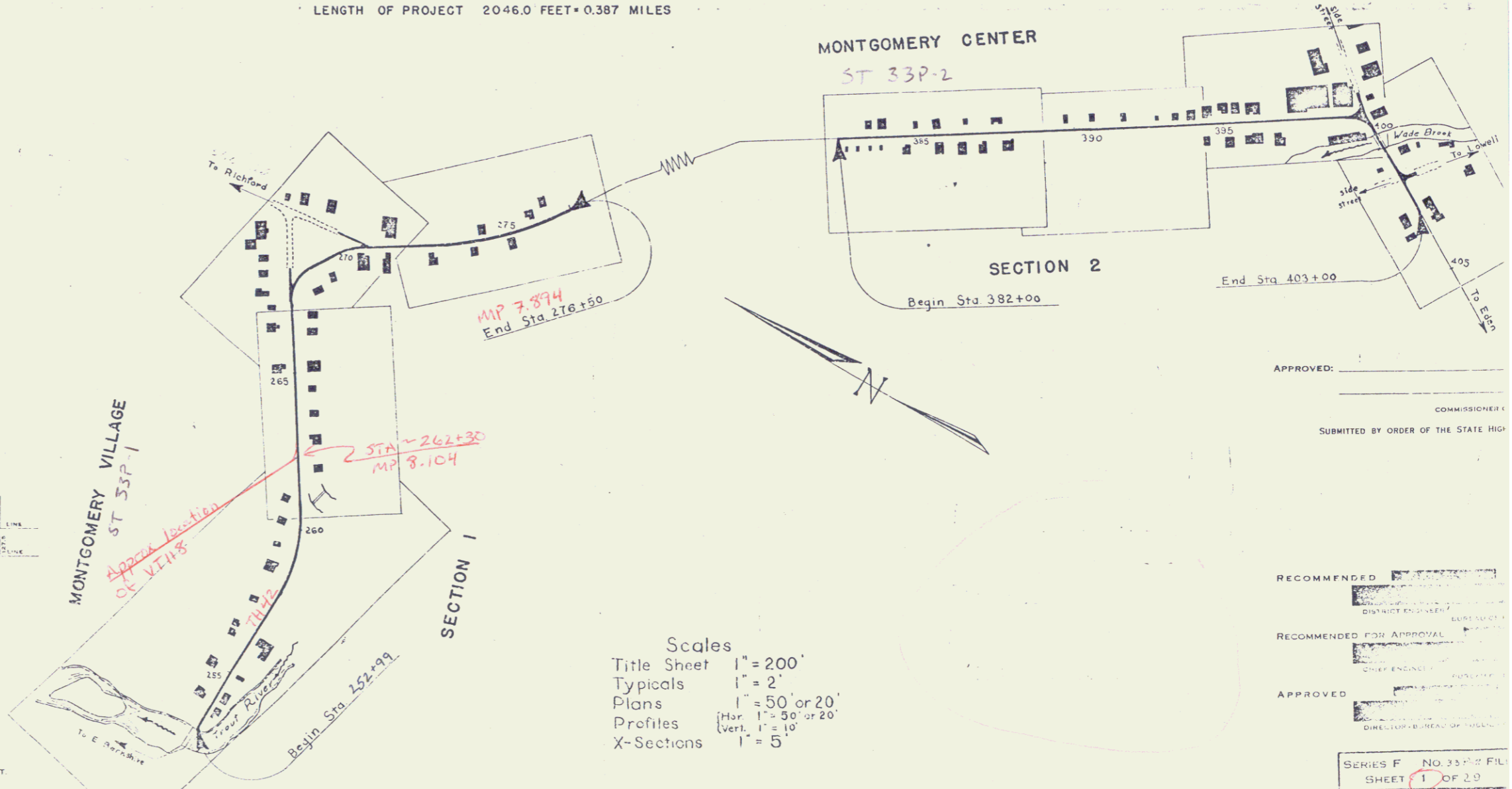

CONVENTIONAL SIGNS

|                   |                  |
|-------------------|------------------|
| COUNTY LINE       | GROUND ELEVATION |
| TOWN LINE         | GRADE ELEVATION  |
| FENCE LINE        |                  |
| STONE WALL        |                  |
| UNFENCED PROPERTY |                  |
| GUARD RAIL        |                  |
| TRAVELED WAY      |                  |
| RAILROAD          |                  |
| RETAINING WALL    |                  |
| CENTER LINE       |                  |
| SURVEY LINE       |                  |
| CULVERT           |                  |
| DROP INLET        |                  |
| TROLLEY POLE      |                  |
| POWER POLE        |                  |
| TRAIL PHONE POLE  |                  |

CURVE DATA

|                       |          |
|-----------------------|----------|
| DEFLECTION ANGLE      | Δ        |
| DEGREE OF CURVE       | D        |
| RADIUS OF CURVE       | R        |
| TANGENT DISTANCE      | T        |
| LENGTH OF CURVE       | L        |
| EXTERNAL DISTANCE     | E        |
| POINT OF INTERSECTION | P. I.    |
| POINT OF CURVE        | P. C.    |
| POINT OF TANGENT      | P. T.    |
| POINT ON TANGENT      | P. O. T. |

Scales  
Title Sheet 1" = 200'  
Typicals 1" = 2'  
Plans 1" = 50' or 20'  
Profiles Hor. 1" = 50' or 20'  
Vert. 1" = 10'  
X-Sections 1" = 5'

APPROVED: \_\_\_\_\_  
COMMISSIONER  
SUBMITTED BY ORDER OF THE STATE HIGHWAY DEPARTMENT

RECOMMENDED FOR APPROVAL  
RECOMMENDED FOR APPROVAL  
APPROVED

SERIES F NO. 35 FILE  
SHEET 1 OF 20

DIST. # 8