

INDEX OF SHEETS

SHEET NO.	TITLE PAGE
1	TITLE PAGE
2	TYPICAL CROSS-SECTION OF IMPROVEMENT
3	BANKING AND WIDENING TABLES
4-12	PLAN AND PROFILE
13	Standard Structure Sheet S-28
14	Standard Structure Sheet S-30
15-28	Cross Sections
29	Drainage Outlets

STATE OF VERMONT  
STATE HIGHWAY DEPARTMENT

PLAN AND PROFILE OF PROPOSED  
STATE HIGHWAY

TOWN OF MONTGOMERY — VTRoute 118

A PORTION OF MAIN STREET IN THE VILLAGE OF MONTGOMERY CENTER

BEGINNING ABOUT 500 FEET EAST OF CEMETERY AND ENDING  
200 FEET SOUTH OF THE BRIDGE OVER WADE BROOK.

FED. ROAD DIST. NO.	STATE	STAGE	YEAR	SHEET NO.	TOTAL SHEETS
9	VT.	237-2	1940	7	30

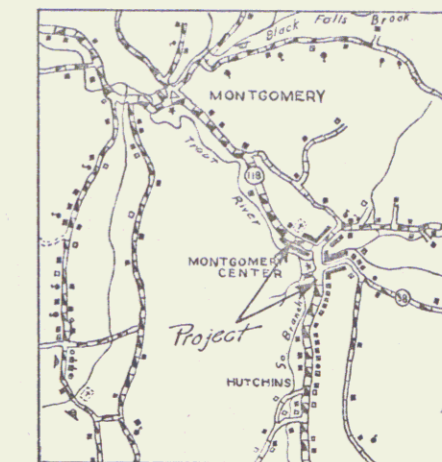

(To Be Returned to R.O.W. Division)  
 HIGHWAY DIVISION  
 TOWN FILE  
 PERMIT  
 1118

LENGTH OF PROJECT 2046.0 FEET = 0.387 MILES

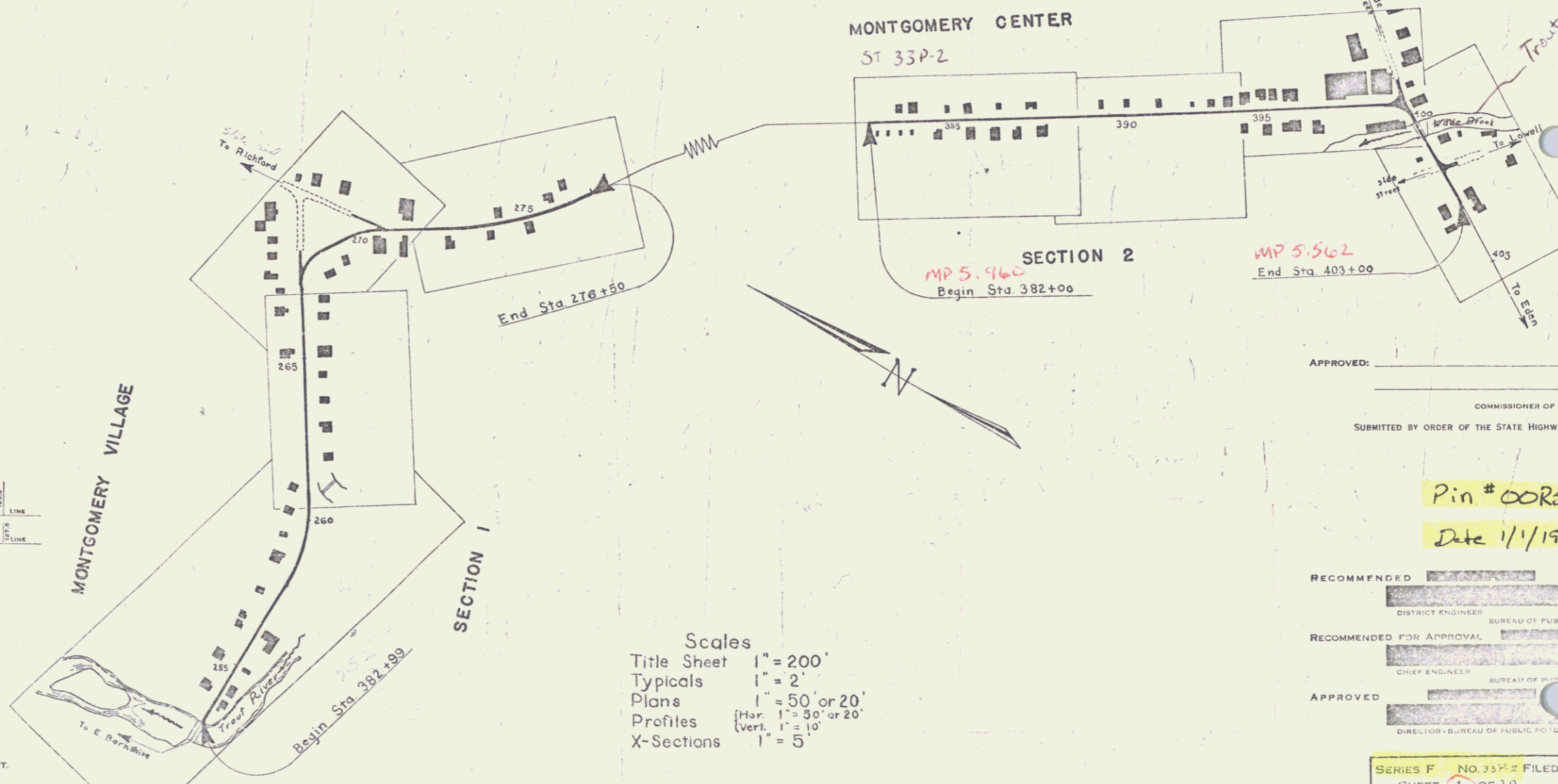

CONVENTIONAL SIGNS

COUNTY LINE	GROUND ELEVATION	DATUM	SCALE
TOWN LINE	GRADE ELEVATION	DATUM	SCALE
FENCE LINE			
STONE WALL			
UNFENCED PROPERTY			
GUARD RAIL			
TRAVELED WAY			
RAILROAD			
RETAINING WALL			
CENTER LINE			
SURVEY LINE			
CULVERT			
DROP INLET			
TROLLEY POLE			
POWER POLE			
TELEPHONE POLE			
TREES			

CURVE DATA

DEFLECTION ANGLE	Δ
DEGREE OF CURVE	D
RADIUS OF CURVE	R
TANGENT DISTANCE	T
LENGTH OF CURVE	L
EXTERNAL DISTANCE	E
POINT OF INTERSECTION	P. I.
POINT OF CURVE	P. C.
POINT OF TANGENT	P. T.
POINT ON TANGENT	P. O. T.

Scales  
 Title Sheet 1" = 200'  
 Typicals 1" = 2'  
 Plans 1" = 50' or 20'  
 Profiles (Hor. 1" = 50' or 20', Vert. 1" = 10')  
 X-Sections 1" = 5'

APPROVED: \_\_\_\_\_

COMMISSIONER OF HIGHWAYS  
 SUBMITTED BY ORDER OF THE STATE HIGHWAY BOARD

Pin # 008512

Date 1/1/1940

RECOMMENDED \_\_\_\_\_  
 DISTRICT ENGINEER BUREAU OF PUBLIC ROADS  
 RECOMMENDED FOR APPROVAL \_\_\_\_\_  
 CHIEF ENGINEER BUREAU OF PUBLIC ROADS  
 APPROVED \_\_\_\_\_  
 DIRECTOR BUREAU OF PUBLIC ROADS

SERIES F NO. 332 FILED  
 SHEET 1 OF 29

DIST. # 8 PLANS