

POOR ORIGINAL COPY

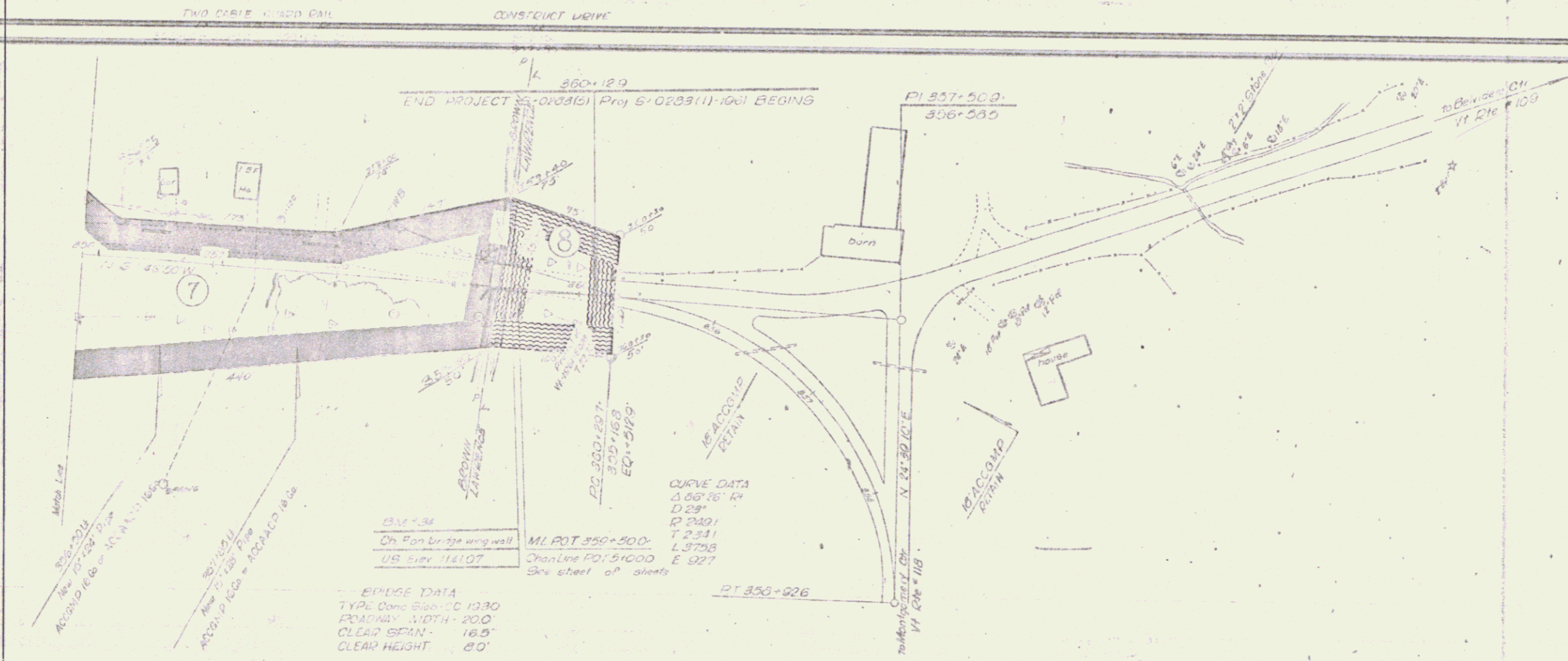

PLAN	DATE
REVISED	
BY	
CHECKED	
APPROVED	

EPISODE DATA
TYPE Conc Span CC 1930
ROADWAY WIDTH - 20.0'
CLEAR SPAN - 16.0'
CLEAR HEIGHT - 20.0'

Ch. Fan bridge wing wall
US Elev. 114107

ML POT 350+90.0
Chan Line POT 510000 E 927
Site street of sheets

RT 356+926

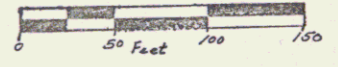

VERMONT DEPARTMENT OF HIGHWAYS
RIGHT-OF-WAY PLANS
PROJECT: EDEN - BELVIDERE
NO. S 0283 (5)
SHEET 13 OF 13

SHEET 34A

20