

INDEX OF SHEETS RECORD PLANS-MATERIALS

EDEN RS 0283 (4)
 SAND BORROW-VILLENEUVE PIT- EDEN
 GRANULAR BORROW-VILLENEUVE PIT-EDEN
 GRANULAR BACKFILL FOR STRUCTURES-VILLENEUVE PIT
 SUBBASE OF GRAVEL-DAVIS PIT-EDEN
 BITUMINOUS CONCRETE PAVEMENT-PIKE INDUSTRIES-LACONIA,N.H.
 CONCRETE CLASS B-ANDERSON'S-WATERBURY,VT.
 CGMPP 114" X 138"-LANE METAL PRODUCTS CO.-BALLISTON,N.Y.
 18" AND 24" ACCGMP (.064) LANE METAL PRODUCTS CO.-BALLISTON,N.Y.

| | | |
|---------------------------|---|------------|
| 1. | Title | |
| 2. | Typical | |
| 3-4. | Quantity Sheets | |
| 5-8. | Earthwork Sheets & Summary | |
| 9. | Drainage Sheet | |
| 10-13. | RDW Detail Sheets | |
| 14-16. | Blank | |
| 17-27. | Plan & Profile Sheets | |
| 28-32. | BR 100 Series | |
| 33-34. | Blank | |
| Roadway Standards: | | |
| 35. | A-60 Slopes in Solid Rock Excavation | 4/20/73 R |
| 36. | B-5 Slope Roundings, Embankments | 12/06/71 R |
| 37. | B-11 Underdrain with Shattered Rock Subgrade | 12/12/74 R |
| 38. | C-1 Treated Timber Curb | 8/30/73 R |
| 39. | C-2 CRM Roadwalls, Underdrain | 3/08/72 R |
| 40. | D-3 Treated Gutters | 4/27/73 R |
| 41. | D-4 M.E.S., Flushing Basins, Elbows | 7/24/75 R |
| 42. | D-6 Reinf. Conc. Drop Inlet with Grate | 4/04/73 R |
| 43. | D-10 Precast Curb Drop Inlet Grate | 11/14/72 R |
| 44-46. | Blank | |
| 47. | E-2 Approach Signs, Road Construction | 5/14/74 R |
| 48. | E-3 Approach Signs, Bridge Construction | 5/14/74 R |
| 49. | E-6 Construction Signs, On-Project | 5/14/74 R |
| 50. | E-7 Barricades | 9/19/73 R |
| 51. | G-4 Wood Guide & Marker Posts | 5/23/74 R |
| 52. | G-4a. 3-Cable Guard Rail - Wood Posts Anchors | 4/17/73 R |
| 53. | J-1 Boundary Markers | 12/06/71 R |
| 54. | T-1 Erosion Control Details | 6/14/73 R |
| 55. | T-2 Erosion Control Details | 7/05/72 R |
| 56-57. | Blank | |
| 58-134. | Metalline Sections | |
| 135-137. | TH 16 Sections | |
| 138. | TH 9 Sections | |
| 139-142. | Banking Transition | |

12" AND 15" CGMP (.064) LANE METAL PRODUCTS CO. BALLISTON, N.Y.
 12" AND 15" CAACP (.060) LANE METAL PRODUCTS CO. BALLISTON, N.Y.
 15" AND 18" RCP CL. S.T. GRISWOLD CO. INC. WILLISTON, VT.
 18" AND 24" M.E.S. FOR ACCGMP (.064) LANE METAL PRODUCTS CO. BALLISTON, N.Y.
 12" CGMP ELBOW (.064) BALLISTON, N.Y.
 6" UNDERDRAIN
 6" U.D. CARRIER
 U.D. FLUSHING BASIN
 PROCDI W/CAST IRON GRATE-CALCO INC. WATERFORD, VT.

**STATE OF VERMONT
 DEPARTMENT OF HIGHWAYS**



**FEDERAL AID SECONDARY
 PROPOSED IMPROVEMENT
 TOWN OF EDEN
 COUNTY OF LAMOILLE
 VERMONT ROUTE 118
 EDEN-BELVIDERE CORNERS ROAD**

BEGINNING AT A POINT APPROXIMATELY 2.324 MILES NORTH OF THE INTERSECTION OF VT. RTE. 100 AND EXTENDING NORTHWESTERLY 2.133 MILES.
 LENGTH OF ROADWAY 11,260.57 FEET = 2.133 MILES
 LENGTH OF PROJECT 11,260.57 FEET = 2.133 MILES

1974 ADT = 215
 1994 ADT = 350 (EST.)
 1994 DHV = 70 (EST.)
 D = 56 %
 T = 6 %
 V = 40 MPH

TREATED TIMBER CURB
 WOOD MARKER POST
 GUARD RAIL, 3 CABLE W/LIGHT WOOD POST } GRISWOLD FENCE CO. ESSEX JCT. VT.
 ANCHOR FOR GUARD RAIL
 WOOD GUIDE POST

CONTRACT DATED 9 OCTOBER 1975
 CONTRACTOR- CALEDONIA INC. ST. JOHNSBURY, VT.
 CONSTRUCTION BEGAN 9 OCTOBER 1975
 CONSTRUCTION SUSPENDED 31 DECEMBER 1975
 CONSTRUCTION RESUMED 12 APRIL 1976
 CONSTRUCTION COMPLETED AND ACCEPTED 25 JUNE 1976
 RES. ENGR. HERBERT J. WASHER
 RECORD PLANS-PAUL E. SINGLETON

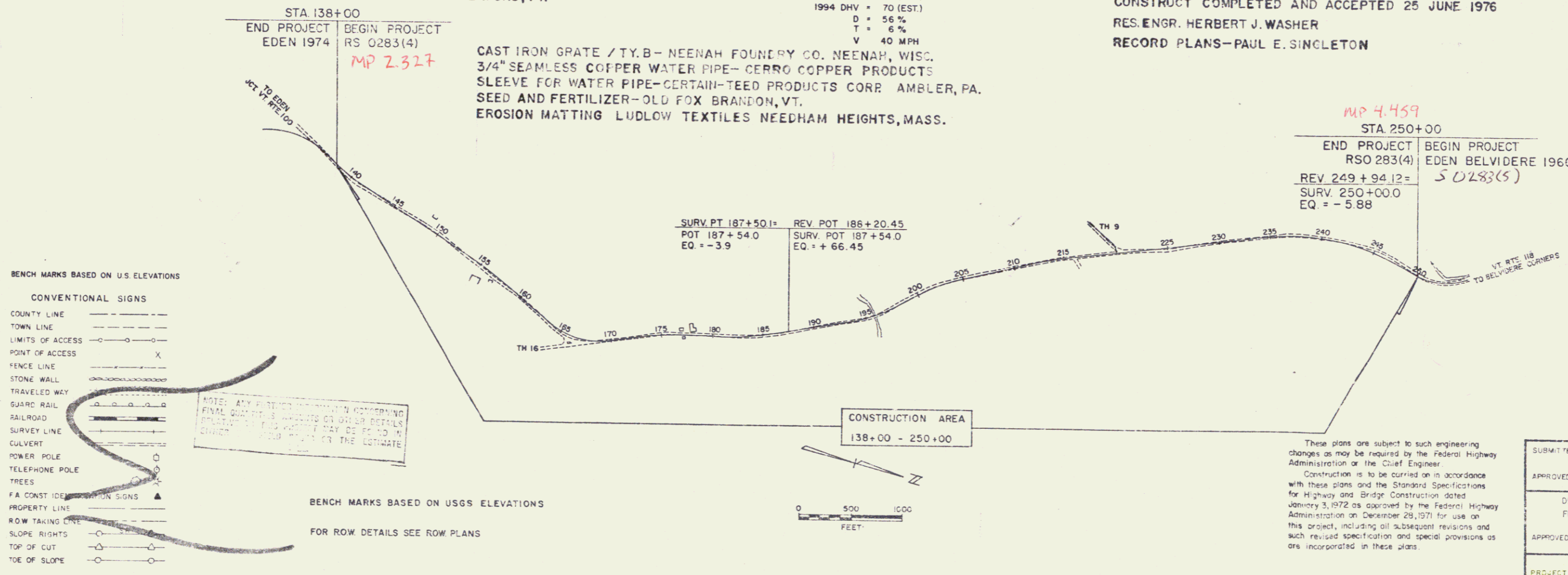
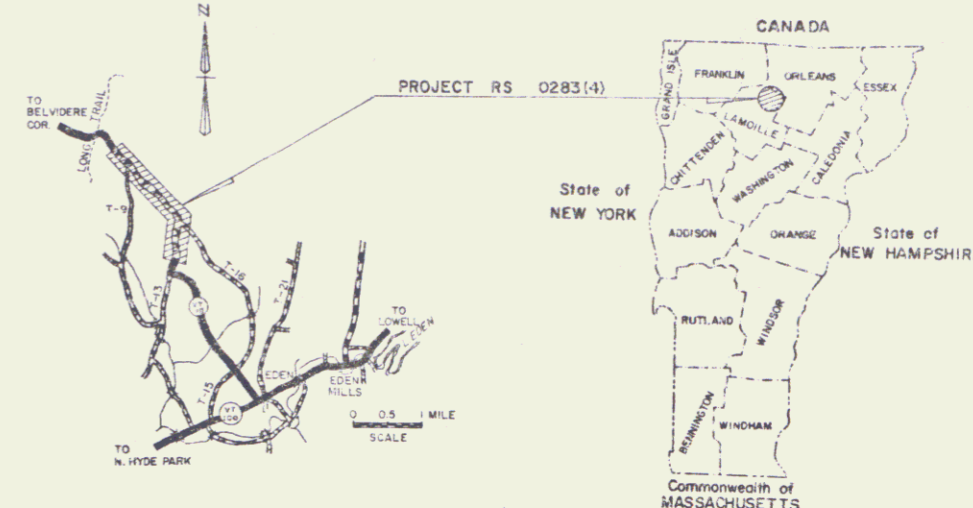

- BENCH MARKS BASED ON U.S. ELEVATIONS**
- CONVENTIONAL SIGNS**
- COUNTY LINE
 - TOWN LINE
 - LIMITS OF ACCESS
 - POINT OF ACCESS
 - FENCE LINE
 - STONE WALL
 - TRAVELED WAY
 - GUARD RAIL
 - RAILROAD
 - SURVEY LINE
 - CULVERT
 - POWER POLE
 - TELEPHONE POLE
 - TREES
 - FA CONST. ID.
 - PROPERTY LINE
 - ROW TAKING LINE
 - SLOPE RIGHTS
 - TOP OF CUT
 - TOE OF SLOPE
- BENCH MARKS BASED ON USGS ELEVATIONS**
- FOR ROW DETAILS SEE ROW PLANS

These plans are subject to such engineering changes as may be required by the Federal Highway Administration or the Chief Engineer. Construction is to be carried on in accordance with these plans and the Standard Specifications for Highway and Bridge Construction dated January 3, 1972 as approved by the Federal Highway Administration on December 28, 1971 for use on this project, including all subsequent revisions and such revised specification and special provisions as are incorporated in these plans.

SUBMITTED BY ORDER OF THE STATE HIGHWAY BOARD

APPROVED: *[Signature]* DATE: 8/15

CHIEF ENGINEER

DEPARTMENT OF TRANSPORTATION
 FEDERAL HIGHWAY ADMINISTRATION

APPROVED: _____ DATE: _____

DIVISION ENGINEER

PROJECT RS 0283(4)

SHEET 17 OF 142 SHEETS

D-10 SRS 12/17/70