

DATE BOOK EXAMINED CHECKED
 NO. 10/25/52 M.L.F.
 9,000

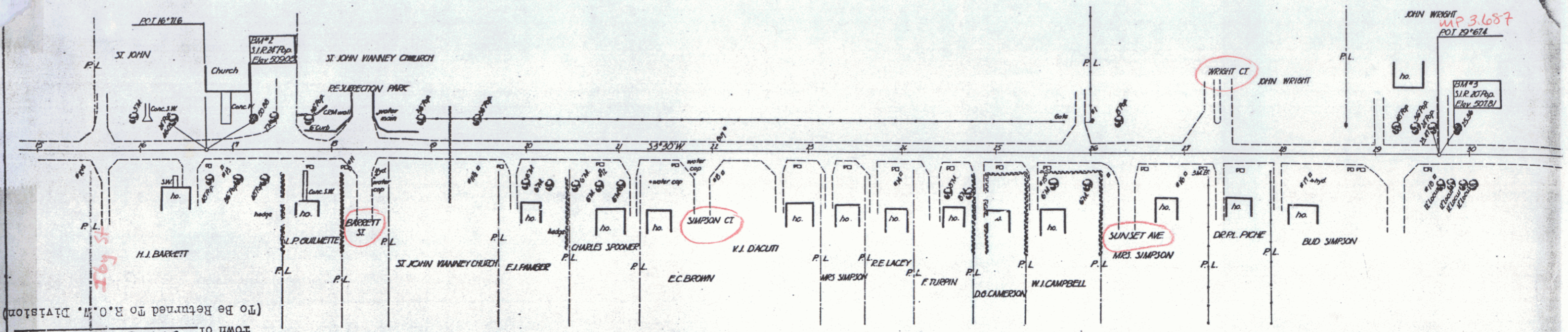

RIGHT-OF-WAY DIVISION
 TOWN FILE
 MP 3.6 - 4.252
 PERPETUAL
 Town of U116
 (To Be Returned To R.O.W. Division)



B.M. 2 S. R. 20 Pop 28 LT Sta 11711 El 509.00
 B.M. 3 S. R. 20 Pop 22 LT Sta 29'02 El 507.01

SO BURLINGTON No. 2
 Jones Sheet of