

INDEX OF SHEETS

SHEET NO. 1 TITLE PAGE

" 2 TYPICAL CROSS-SECTION OF IMPROVEMENT } GRAVEL MIXED-IN-PLACE SURFACE COURSE

" 3 BANKING AND WIDENING TABLES

" 4 - 26 PLAN AND PROFILE SHEETS

" 27 STANDARD STRUCTURE SHEET 3-28 PIPE CULVERTS

" 28 " " " 3-29 BOX CULVERTS

" 29 " " " 3-30 GUARD RAIL

" 30 BARRICADES, SIGNS AND LIGHTS 3B-11

" 31 SPECIAL CULVERT SHEET

" 32

" 33-95 CROSS SECTIONS

STANDARD SHEETS 3-28 AND 3-29 SUBMITTED TO THE CHIEF ENGINEER ON MAY 16, 1933.

STANDARD SHEET 3-30 SUBMITTED TO THE CHIEF ENGINEER ON AUG. 15, 1933

STATE OF VERMONT
STATE HIGHWAY DEPARTMENT

PLAN AND PROFILE OF PROPOSED
STATE HIGHWAY

NATIONAL RECOVERY SECONDARY PROJECT

TOWNS OF SOUTH BURLINGTON, WILLISTON,
SHELBURNE ST. GEORGE

BURLINGTON-BRISTOL ROAD

FROM ITS INTERSECTION WITH THE BURLINGTON
- MONTPELIER ROAD SOUTHERLY 6592 FEET TO
THE HOUSE OF FRANK MAXWELL

LENGTH OF PROJECT = 34808.0 FT.
= 6.592 MILES

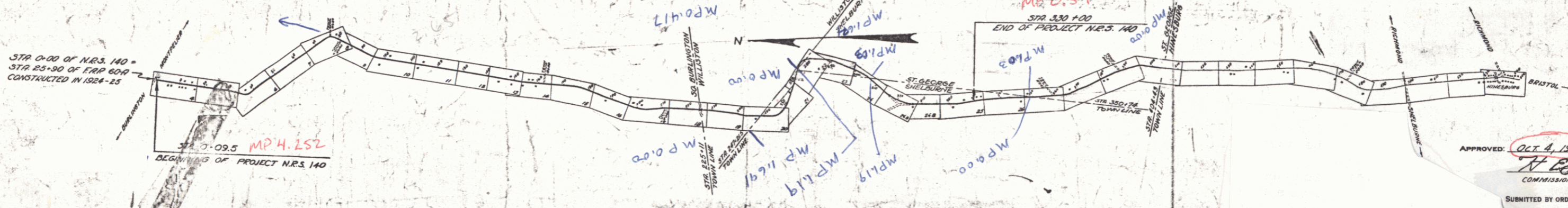
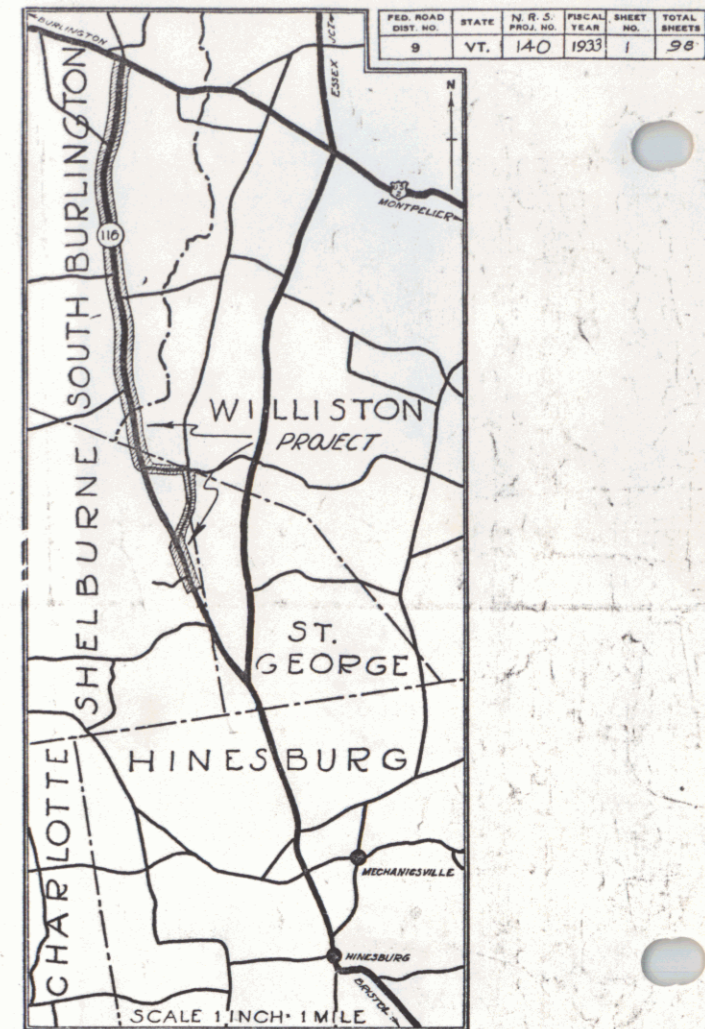

CONVENTIONAL SIGNS

COUNTY LINE	GROUND ELEVATION
TOWN LINE	GRADE ELEVATION
FENCE LINE	
SPRINKLER	
UNPAVED ROAD	
GUARD RAIL	
TRAVELED WAY	
RAILROAD	
RETAINING WALL	
CENTER LINE	
SURVEY LINE	
CULVERT	
DROP INLET	
TROLLEY POLE	
POWER POLE	
TELEPHONE POLE	
TREES	
HEDGE	

CURVE DATA

DEFLECTION ANGLE	Δ
DEGREE OF CURVE	D
RADIUS OF CURVE	R
TANGENT DISTANCE	T
LENGTH OF CURVE	L
EXTERNAL DISTANCE	E
POINT OF INTERSECTION	P. I.
POINT OF CURVE	P. C.
POINT OF TANGENT	P. T.
POINT ON TANGENT	P.O.T.

SCALES

TITLE	1" = 2000'
PLAN	1" = 50'
PROFILE HOR.	1" = 50'
PROFILE VERT.	1" = 10'
CROSS SECTIONS	1" = 3'

Note
These plans are subject to such revisions as may be required by the Bureau of Public Roads or the Commissioner of Highways. Construction is to be carried out in accordance with the standard road and bridge specifications of 1930 with all subsequent approved revisions and such specifications and special provisions as are submitted with the plans.
Attention of contractors is called to the fact that the State Highway Board reserves the right to extend this project southerly of the same contract prices. Said cost of extension not to exceed 25% of the amount of contract.

APPROVED Oct 4, 1933
H. August
COMMISSIONER OF HIGHWAYS

SUBMITTED BY ORDER OF THE STATE HIGHWAY BOARD

Pin# 00R502
Route VT116

RECOMMENDED _____
DISTRICT ENGINEER BUREAU OF PUBLIC ROADS

RECOMMENDED FOR APPROVAL _____
CHIEF ENGINEER BUREAU OF PUBLIC ROADS

APPROVED _____
DIRECTOR - BUREAU OF PUBLIC ROADS

Correct Oct 4, 1933
E. W. ...
UPON ENGINEER

SERIES NRS No 140 FILED
SHEET 1 OF 30