

POST WAR F A PRIMARY

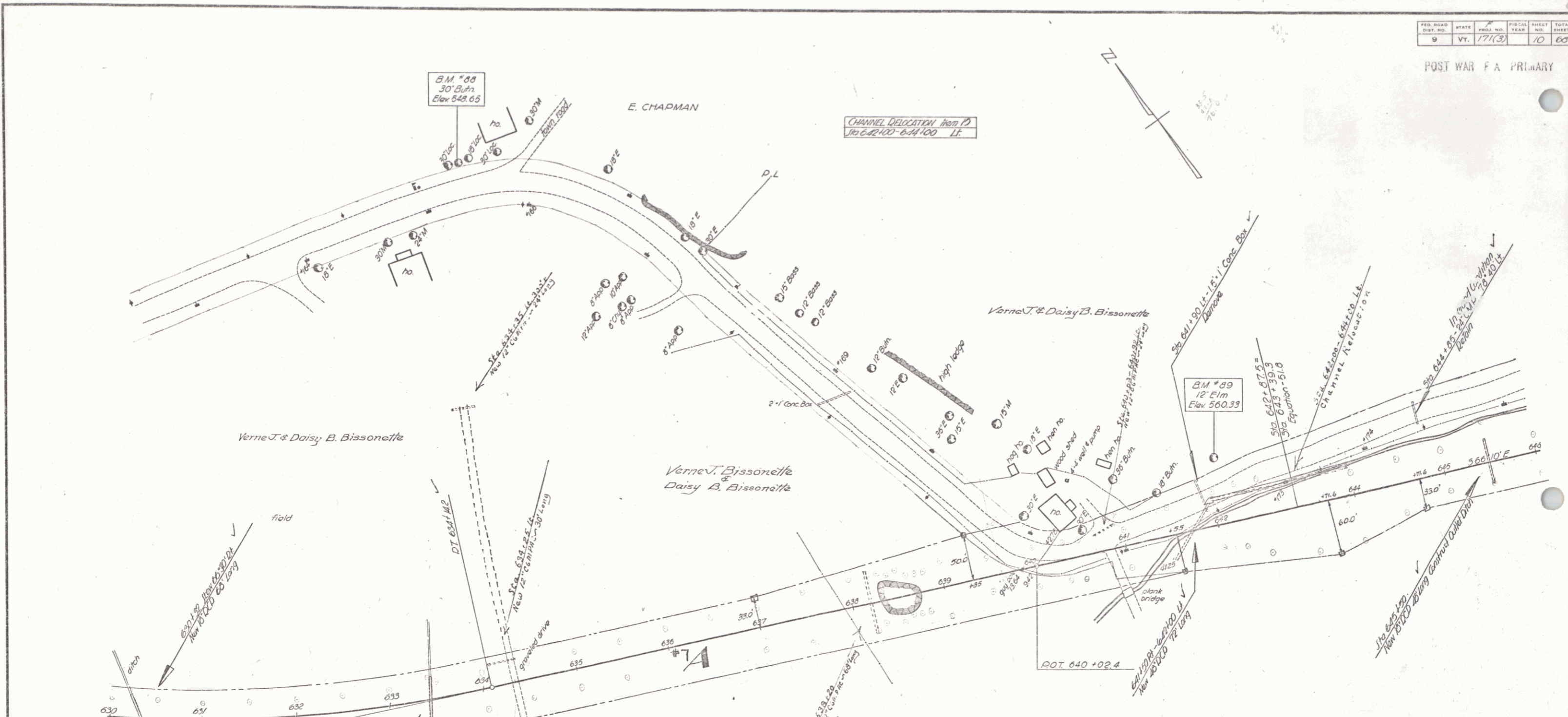

DRIVES CONSTRUCTED

Stn.	Remarks
630+25	Rt.
633+25	Rt.
634+35	Rt.
634+35	Extends 90' Lt. 300' Lt
637+15	Rt.
638 ±	Cattle Pass
640+50	Lt.
641+25	Lt.
641+40	Rt.
642+25	Lt.

CONTROL OF SECTION OF OLD HIGHWAY BETWEEN STA 622+33 (3741) AND STA 630+41 (3041) RELINQUISHED TO TOWN OF HINESBURG RECORDED BOOK 1, PAGE 133 JAN. 12, 1950

HINESBURG

Surveyed by Spaulding
 Designed by Spaulding & Peger
 Traced by Jones
 Checked by
 Series F No. 171(3) Filed
 Sheet 10 of 60 Sheets