

THREE CABLE GUARD RAIL WITH STEEL POSTS
 LI 35+00-35+73 RI 35+00-36+71
 TREATED TIMBER CURB
 LI 35+00-35+73
 SURFACED SHOULDER (ITEM 317)
 LI 35+00-35+73

PAVED GUTTER (ITEM 554)
 LI 35+73
 CONSTRUCT SPECIAL DITCH (ITEM 103-A-1)
 LI 35+70-41+50

EXCAVATION AND REMOVAL OF ROAD SURFACES AND/OR PAVEMENTS
 RI 36+25-39+25
 CONSTRUCT DRIVE
 LI 43+00 RI 39+00

$\Delta 36^{\circ}51'30''$ LI
 D 5100
 P 1145.0
 T 381.8
 L 787.2
 E 61.9
 Bank $1\frac{1}{2}'$ in $12''$

PLAN
 SHEET NO. 16
 PROJECT NO. 018-5-6657
 STA. 44+00 TO 44+33

PROFILE
 SHEET NO. 16
 PROJECT NO. 018-5-6657
 STA. 44+00 TO 44+33

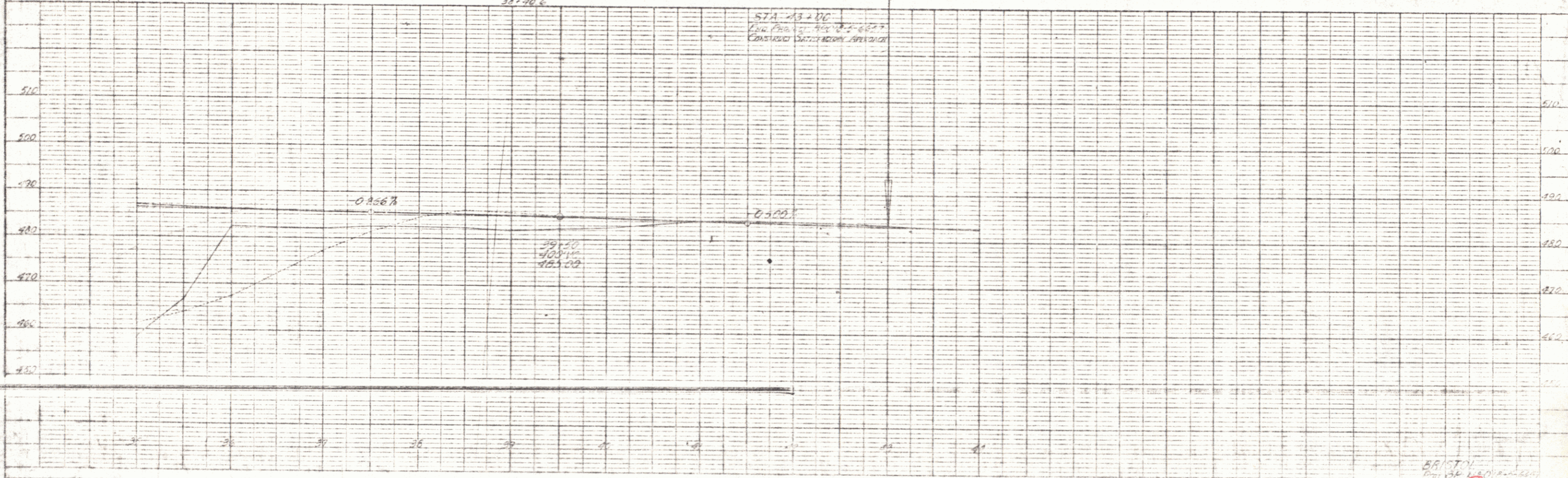
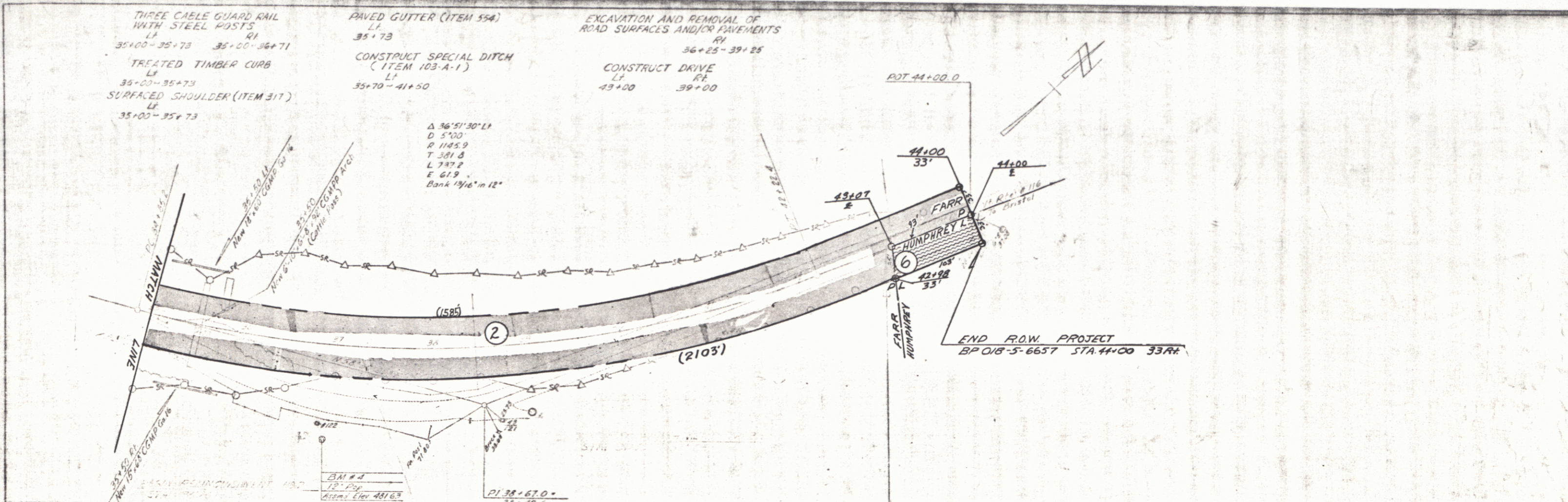

PLATE 1, PLAN PROFILE
 16

5