

ED. ROAD DIST. NO.	STATE	FED. AID PROJ. NO.	FISCAL YEAR	SHEET NO.	TOTAL SHEETS
9	VT.				

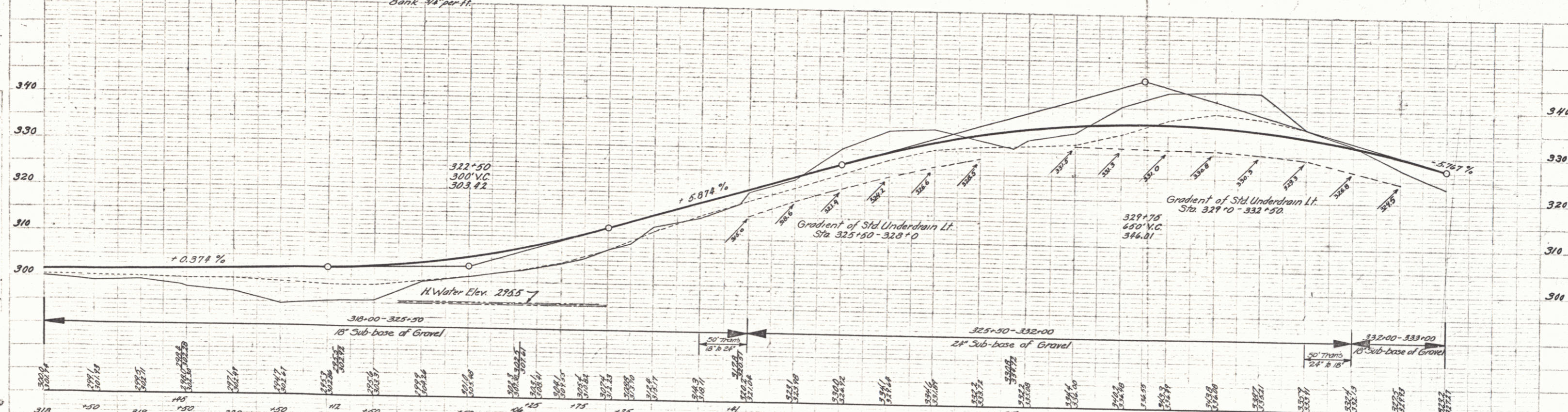
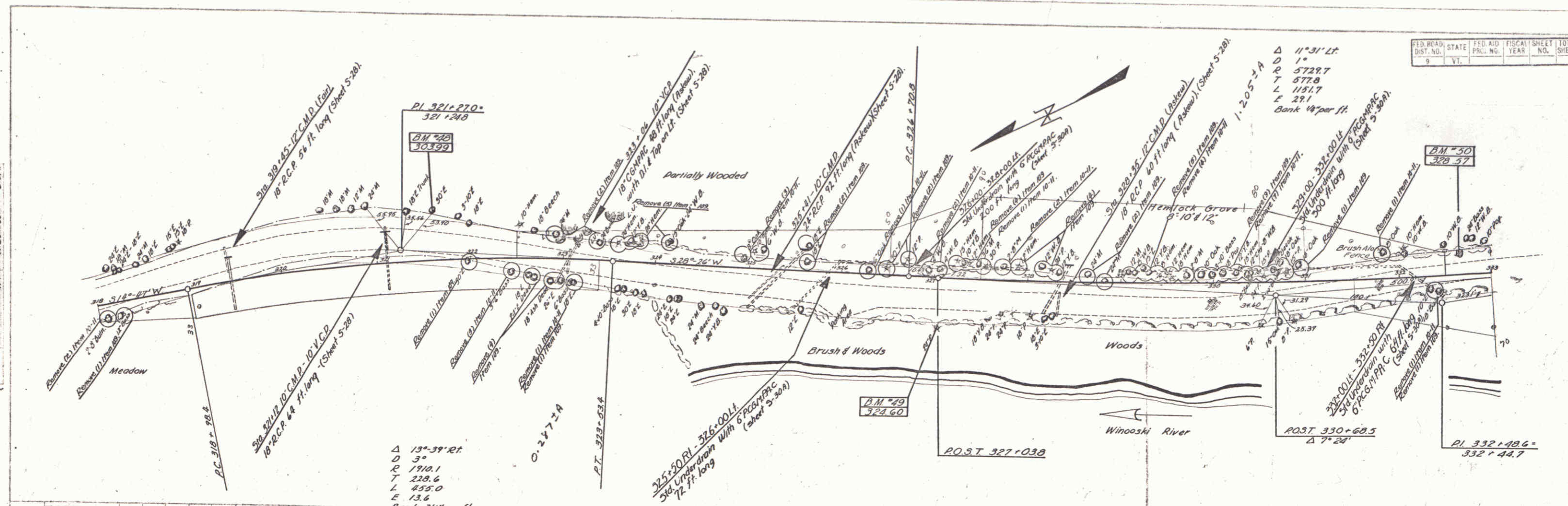

B.M. #28 S.I.R. 30" Elm 49 ft. Lt. Sta. 321+40 Elev. 303.99  
 B.M. #29 S.I.R. 24" Pine 53 ft. Rt. Sta. 327+03 Elev. 324.60  
 B.M. #50 Spot on Boulder 20 ft. Lt. Sta. 332+71 Elev. 328.57