

FED. ROAD DIST. NO. 5 STATE 9 PROJ. NO. 2700 FISCAL YEAR 17 SHEET NO. 17 TOTAL SHEETS 76
 POST WAR SECONDARY

BM 11
 3/12/21 Elev. 1293.02

PLAN
 DATE 1-28-49
 DRAWN BY S. J. G. / M. L. C.
 CHECKED BY T. J. C.

PLAN
 DATE 1-28-49
 DRAWN BY S. J. G. / M. L. C.
 CHECKED BY T. J. C.

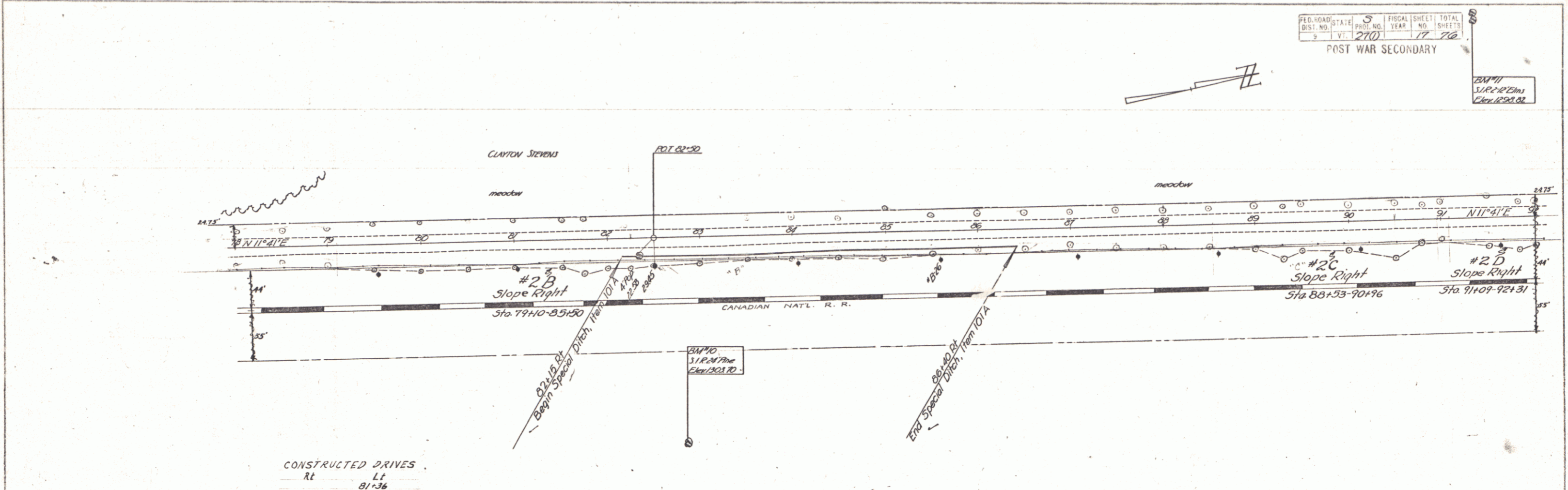

CONSTRUCTED DRIVES
 Rt Lt
 81+36

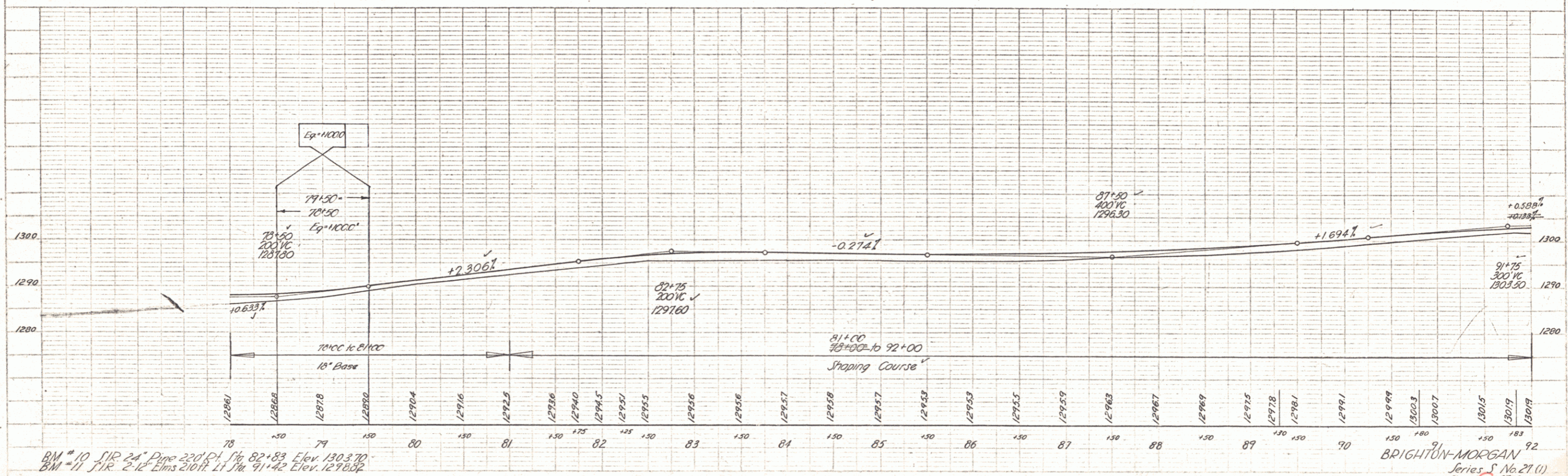

BM # 10 I.R. 24" Pipe 220' PL. Sta. 82+83 Elev. 1303.70
 BM # 11 I.R. 2" 12" Elms 210' PL. Sta. 91+42 Elev. 1293.02

BRIGHTON-MORGAN
 Series S No. 27 (1)
 Sheet 17 of 76 Sheets