

INDEX OF SHEETS	
SHEET NO.	TITLE PAGE
1	TITLE PAGE
2	TYPICAL CROSS-SECTION OF IMPROVEMENT
3	BANKING AND WIDENING TABLES
4	QUANTITY SHEET (ITEMS)
5	QUANTITY SHEET (DRAINAGE)
6-9	EARTHWORK SHEETS
10-15	PLAN AND PROFILE SHEET
16	DETAILS OF ABUTMENT NUM. 1 BRIDGE SHEET
17	DETAILS OF ABUTMENT NUM. 2 BRIDGE SHEET
18	DETAILS OF SUPERSTRUCTURE BRIDGE SHEET
19	STANDARD STRUCTURE SHEET SB 20 TYPICAL DETAILS B, C, E, G & J
20	STB 30 STANDARD T-BEAM DETAILS
21	SB-5C-1 TWO CABLE GUARD RAIL (BRIDGE)
22	SB-11 BARRICADES, SIGNS & LIGHTS (BRIDGE)
23	SC-1 STANDARD BOX CULVERTS
24	SC-21 DETAILS FOR BOX CULVERTS
25	S-40 BARRICADES, SIGNS & LIGHTS
26	S-41 TYPICAL GRADING CROSS SECTION
27	S-46-45 BOUNDARY MARKERS
28	S-47-45 PIPE CULVERTS
29	S-48-46 THREE CABLE GUARD RAIL
30-48	CROSS SECTIONS

STANDARD STRUCTURE SHEET APPROVED BY THE CHIEF ENGINEER, VERMONT DEPARTMENT OF HIGHWAYS.

S-40 FEB. 28, 1949
 S-41 DEC. 3, 1941
 S-46-45 FEB. 28, 1949
 S-47-45 FEB. 28, 1949
 S-48-46 MAY 13, 1946

STATE OF VERMONT
 STATE HIGHWAY DEPARTMENT

PLAN AND PROFILE OF PROPOSED
 STATE HIGHWAY

SECONDARY PROJECT

TOWN OF BRIGHTON

COUNTY OF ESSEX

VT ROUTE 114

ISLAND POND-MORGAN CENTER ROAD

BEGINNING AT A POINT 6,066.3 FEET SOUTHERLY OF THE BRIGHTON-MORGAN TOWN LINE AND EXTENDING NORTHEASTERLY 5,451.3 FEET.

LENGTH OF ROADWAY 5,418.2 FEET=1.026 MILES
 LENGTH OF BRIDGE 32.9 FEET=.006 MILES
 LENGTH OF PROJECT 5,451.1 FEET=1.032 MILES

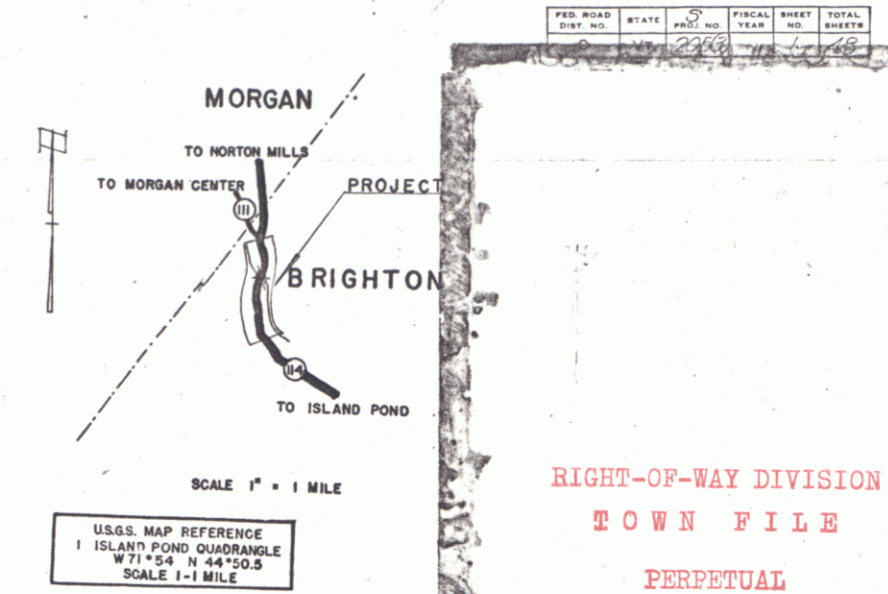

RIGHT-OF-WAY DIVISION
 TOWN FILE
 PERPETUAL
 Town of Brighton
 To Be Returned To R.O.W. Division

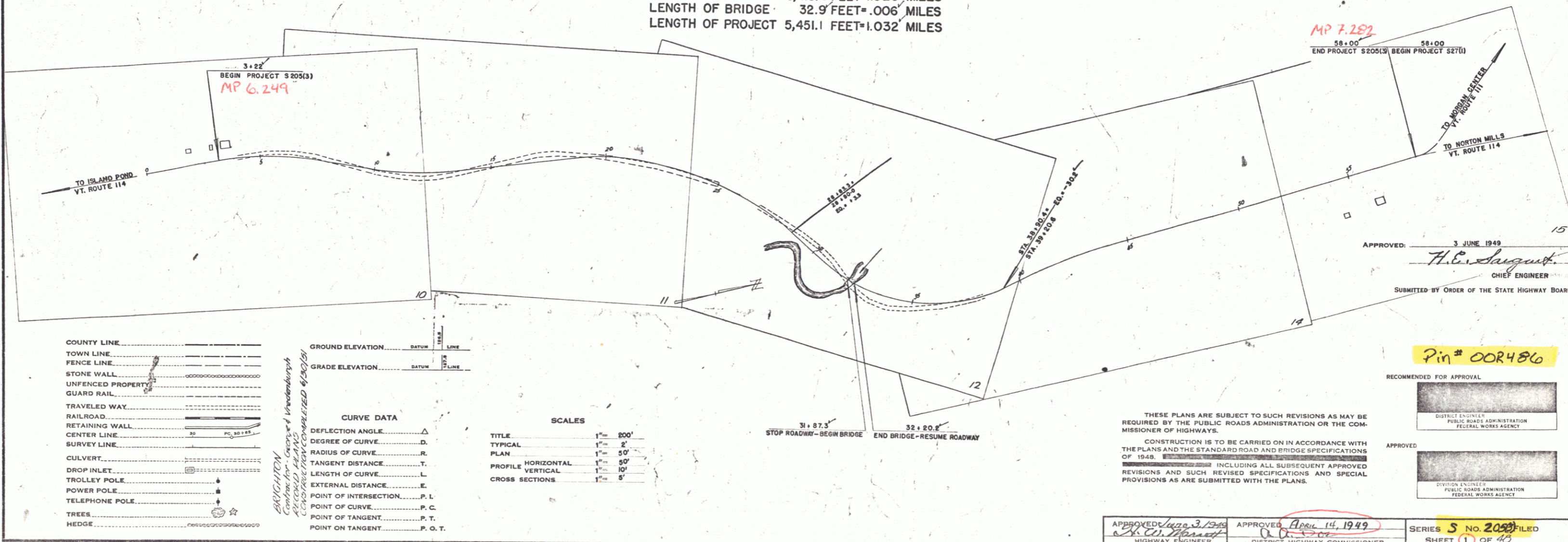

SYMBOL	DESCRIPTION
---	COUNTY LINE
---	TOWN LINE
---	FENCE LINE
---	STONE WALL
---	UNFENCED PROPERTY
---	GUARD RAIL
---	TRAVELED WAY
---	RAILROAD
---	RETAINING WALL
---	CENTER LINE
---	SURVEY LINE
---	CULVERT
---	DROP INLET
---	TROLLEY POLE
---	POWER POLE
---	TELEPHONE POLE
---	TREES
---	HEDGE

SYMBOL	DESCRIPTION
---	GROUND ELEVATION DATUM
---	GRADE ELEVATION DATUM

SYMBOL	DESCRIPTION
---	CURVE DATA
---	DEFLECTION ANGLE
---	DEGREE OF CURVE
---	RADIUS OF CURVE
---	TANGENT DISTANCE
---	LENGTH OF CURVE
---	EXTERNAL DISTANCE
---	POINT OF INTERSECTION
---	POINT OF CURVE
---	POINT OF TANGENT
---	POINT ON TANGENT

SCALE	DESCRIPTION
1" = 200'	TITLE
1" = 2'	TYPICAL
1" = 50'	PLAN
1" = 10'	PROFILE VERTICAL
1" = 5'	CROSS SECTIONS

THESE PLANS ARE SUBJECT TO SUCH REVISIONS AS MAY BE REQUIRED BY THE PUBLIC ROADS ADMINISTRATION OR THE COMMISSIONER OF HIGHWAYS.
 CONSTRUCTION IS TO BE CARRIED ON IN ACCORDANCE WITH THE PLANS AND THE STANDARD ROAD AND BRIDGE SPECIFICATIONS OF 1948, INCLUDING ALL SUBSEQUENT APPROVED REVISIONS AND SUCH REVISED SPECIFICATIONS AND SPECIAL PROVISIONS AS ARE SUBMITTED WITH THE PLANS.

APPROVED June 3, 1949 H. C. August DISTRICT HIGHWAY COMMISSIONER
 APPROVED April 14, 1949 H. C. August DISTRICT HIGHWAY COMMISSIONER
 SERIES S No. 2050 FILED
 SHEET (1) OF 40

Pin # 00R486

RECOMMENDED FOR APPROVAL
 DISTRICT ENGINEER
 PUBLIC ROADS ADMINISTRATION
 FEDERAL WORKS AGENCY

PLAN
 DATE 5-28
 DRAWN BY
 CHECKED BY
 SCALE 1" = 40'

PROFILE
 DATE 5-28
 DRAWN BY
 CHECKED BY
 SCALE 1" = 40'

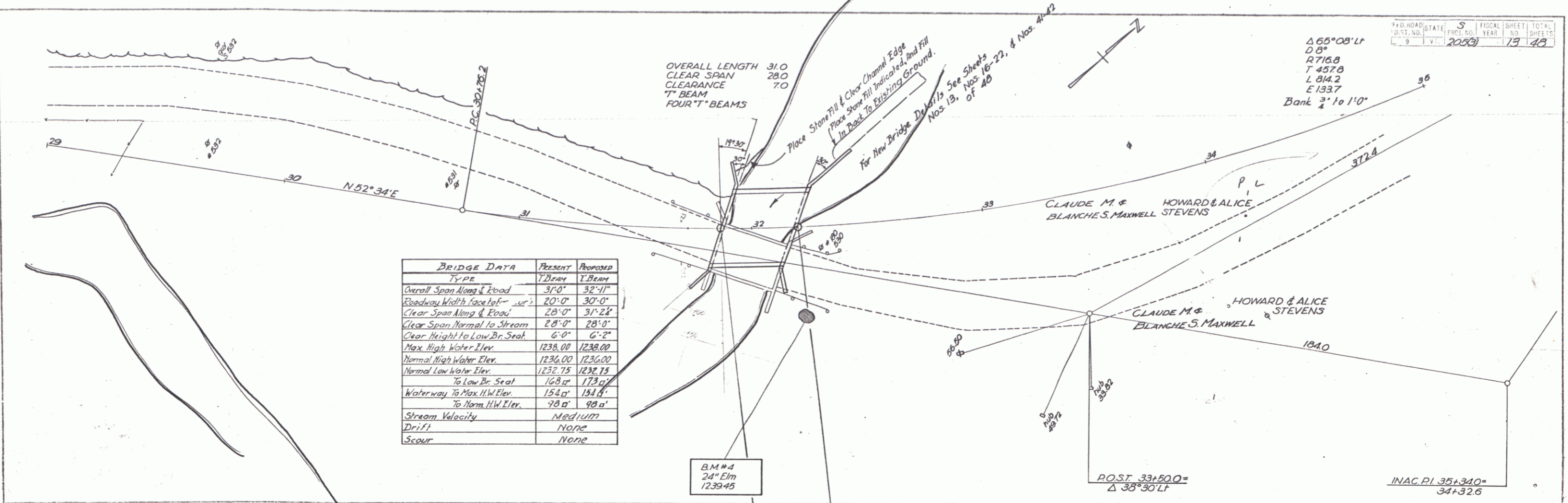

BRIDGE DATA		
Type	Present	Proposed
Overall Span Along Flood	31'-0"	32'-11"
Roadway Width Face to Face	20'-0"	30'-0"
Clear Span Along Flood	28'-0"	31'-2 1/2"
Clear Span Normal to Stream	28'-0"	28'-0"
Clear Height to Low Br. Seat	6'-0"	6'-2"
Max. High Water Elev.	1238.00	1238.00
Normal High Water Elev.	1236.00	1236.00
Normal Low Water Elev.	1232.75	1232.75
To Low Br. Seat	168'	173'
Waterway To Max. H.W. Elev.	154'	154'
To Norm. H.W. Elev.	98'	98'
Stream Velocity		Medium
Drift		None
Scour		None

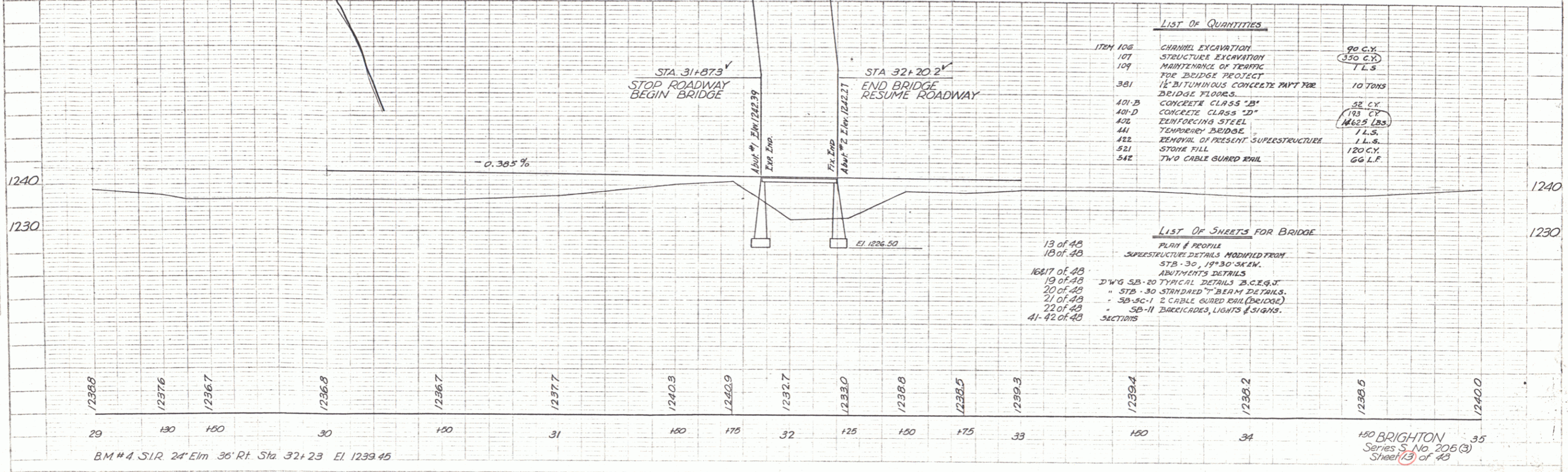

LIST OF QUANTITIES

ITEM NO.	DESCRIPTION	QUANTITY
106	CHANNEL EXCAVATION	90 C.Y.
107	STRUCTURE EXCAVATION	350 C.Y.
109	MAINTENANCE OF TRAFFIC FOR BRIDGE PROTECT	T.L.S.
381	1 1/2" BITUMINOUS CONCRETE 7'x7' 7'x8'	10 TONS
401-B	BRIDGE FLOORS	52 C.Y.
401-D	CONCRETE CLASS "D"	193 C.Y.
402	REINFORCING STEEL	1625 LBS.
441	TEMPORARY BRIDGES	1 L.S.
442	REMOVAL OF PRESENT SUPERSTRUCTURE	1 L.S.
521	STONE FILL	120 C.Y.
542	TWO CABLE GUARD RAIL	66 L.F.

LIST OF SHEETS FOR BRIDGE

NO.	DESCRIPTION
13 of 48	PLAN & PROFILE
18 of 48	SUPERSTRUCTURE DETAILS MODIFIED FROM STB-30, 19'30" SKEM.
16817 of 48	ABUTMENT'S DETAILS
19 of 48	DWG SB-20 TYPICAL DETAILS B.C.E.S.J.
20 of 48	" STB-30 STANDARD T-BEAM DETAILS.
21 of 48	" SB-50-1 2 CABLE GUARD RAIL (BRIDGE)
22 of 48	" SB-11 BACKSCAPES, LIGHTS & SIGNS.
41-42 of 48	SECTIONS

PROJ. NO. 5
 FISCAL YEAR 2000
 SHEET 19
 TOTAL SHEETS 49

Δ 65° 08' 11"
 0.8"
 R 716.8
 T 457.8
 L 814.2
 E 133.7
 Bank 3' to 1'-0"

CLAUDE M. & HOWARD & ALICE STEVENS
 BLANCHE S. MAXWELL

CLAUDE M. & HOWARD & ALICE STEVENS
 BLANCHE S. MAXWELL

POST 33+50.0 = Δ 38° 30' L.F.

INAG. P.I. 35+34.0 = 34+32.6

STA 31+87.3
 STOP ROADWAY BEGIN BRIDGE

STA 32+20.2
 END BRIDGE RESUME ROADWAY

BM #4 SIR 24" Elm 36' Rt. Sta 32+23 El 1239.45

150 BRIGHTON
 Series S. No. 205(B)
 Sheet 13 of 48

