

INDEX OF SHEETS

SHEET NO. 1	TITLE PAGE
2	BANKING AND WIDENING TABLES
3	TYPICAL SECTIONS
4	TYPICAL SECTIONS
5	QUANTITY SHEET, ITEMS
6	QUANTITY SHEET, DRAINAGE
7-10	EARTHWORKS
11-20	PLAN AND PROFILE SHEETS
21	CONSTRUCTION DETAILS CD DRAINAGE & MARKERS
22	CONSTRUCTION DETAILS CD-1 DITCHES
23	CONSTRUCTION DETAILS CD-2 TYPICAL SLOPE GRADING
24	STANDARD STRUCTURE SHEET S-40 BARRICADES, SIGNS, & LIGHTS
25	STANDARD STRUCTURE SHEET S-48-46 THREE CABLE GUARD RAIL
26-50	CROSS SECTIONS

STANDARD STRUCTURE SHEETS APPROVED BY THE CHIEF ENGINEER, VERMONT STATE DEPARTMENT OF HIGHWAYS, 5-40 JUNE 10, 1950

Hot Mix Macadam with Crushed Gravel / Asphalt Cement Item 311-B

**STATE OF VERMONT
DEPARTMENT OF HIGHWAYS**

PROPOSED IMPROVEMENT

SECONDARY PROJECT

TOWN OF CANAAN

COUNTY OF ESSEX

VERMONT ROUTE 114

CANAAN-AVERILL ROAD

PROJECT NAME & NUMBER	CANAAN S 209 (3)	TYPE	HOT MIX MACAD.	PAVEMENT AREA	30.111 S.Y.
RECORD PLANS					
MATERIALS					
SUB-BASE OF GRAVEL	PAQUETTE PIT CLARKSVILLE, N.H.	G.R. CABLE	AM. STEEL & WIRE CO., NEW HAVEN, CONN.		
CUTBACK ASPHALT	ESSO CO., EVERETT, MASS.	G.R. PAINT	BRADLEY LABS., BRATTLEBORO		
R.C.P.	VT. CONC. PIPE CORP., WINDSOR	MACADAM AGG.	PAQUETTE PIT CLARKSVILLE, N.H.		
ACC.G.M.P.	N.E. MET. CULVERT CO., BOSTON, MASS.	6" UNDERDRAIN	N.E. MET. CULV. CO., BOSTON, MASS.		
PEN. ASPHALT	AMBITUMULES CO. E. PROV. R.I.				
CONTRACTOR	H. J. O'CONNELL, LTD.	CONTRACT DATED	JUNE 8, 1954		
RESIDENT ENGR	R. WOODWARD	CONTRACT STARTED	JUNE 15, 1954		
INSPECTORS	H. MILES	CONTRACT COMPLETED	OCT. 6, 1955		
RECORD PLANS	KAMBOUR-WOODWARD	CONTRACT ACCEPTED	OCT. 6, 1955		

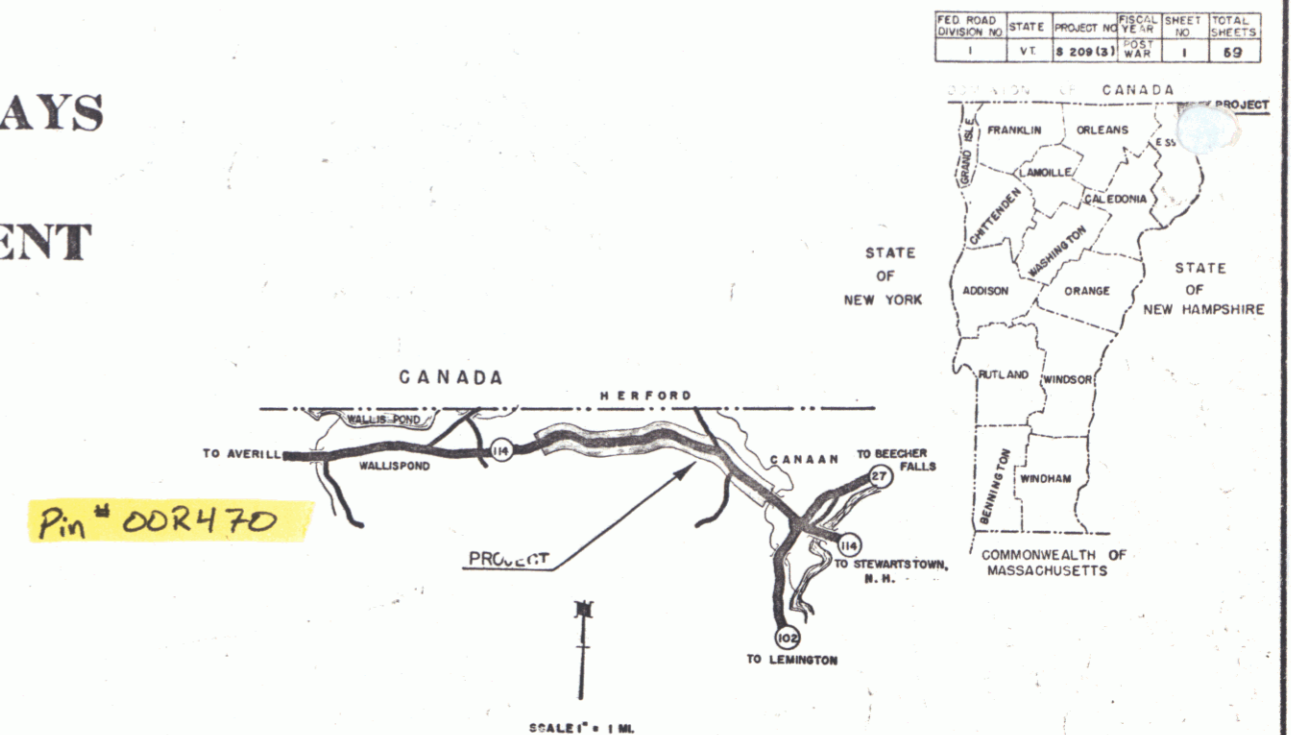

BEGINNING AT THE WESTERLY END OF THE BRIDGE OVER LEACH CREEK AND EXTENDING WESTERLY 13,549.8 FEET

LENGTH OF PROJECT 13,549.8 FT. = 2.566 MILES

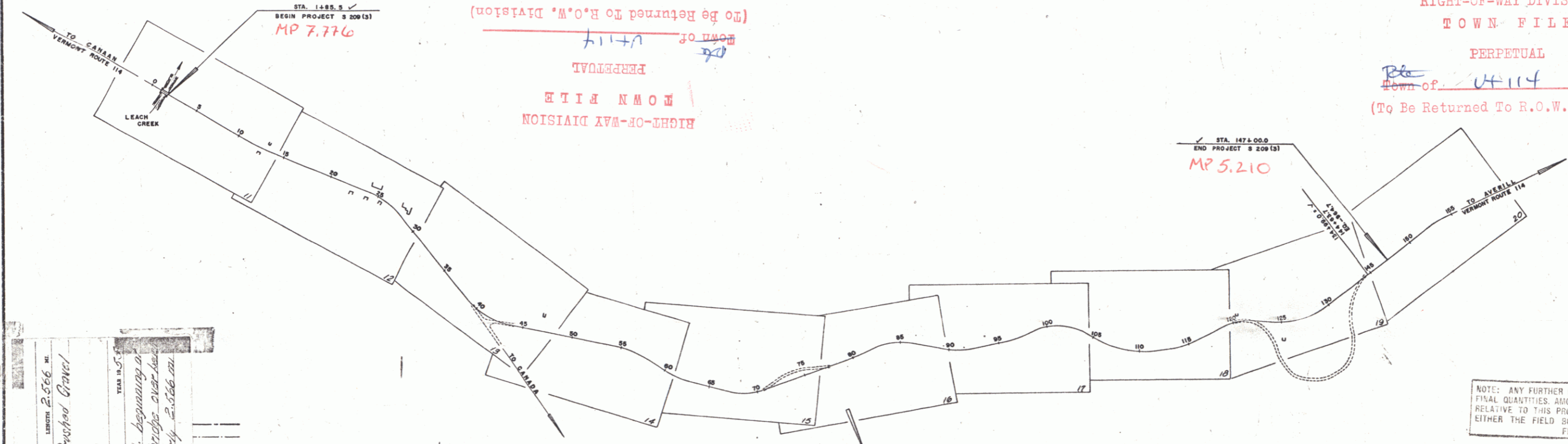

PROJECT: Canaan
NUMBER: S 209 (3)
TYPE: Hot Mix Macadam with Crushed Gravel / Asphalt Cement
CONTRACTOR: H. J. O'Connell, Ltd.
LOCATION: Canaan - Averill Road, beginning at the westerly end of the bridge over Leach and extending westerly 2.566 miles

GROUND ELEVATION	DATUM	LINE
GRADE ELEVATION	DATUM	LINE
CURVE DATA		
DEFLECTION ANGLE	Δ	
DEGREE OF CURVE	D	
RADIUS OF CURVE	R	
TANGENT DISTANCE	T	
LENGTH OF CURVE	L	
EXTERNAL DISTANCE	E	
POINT OF INTERSECTION	P.I.	
POINT OF CURVE	P.C.	
POINT OF TANGENT	P.T.	
POINT ON TANGENT	P.O.T.	
POINT ON SUB-TANGENT	P.O.S.T.	

CONTRACTOR: H. J. O'CONNELL, LTD.
RECORD PLANS: KAMBOUR-WOODWARD
CONSTR. COMPLETED: OCT. 6, 1955

SCALES

TITLE	1" = 500'
TYPICAL	1" = 2'
PLAN	1" = 50'
PROFILE HORIZONTAL	1" = 50'
PROFILE VERTICAL	1" = 10'
CROSS SECTIONS	1" = 5'

THESE PLANS ARE SUBJECT TO SUCH REVISIONS AS MAY BE REQUIRED BY THE BUREAU OF PUBLIC ROADS OR THE COMMISSIONER OF HIGHWAYS.

CONSTRUCTION IS TO BE CARRIED ON IN ACCORDANCE WITH THE PLANS AND THE STANDARD ROAD AND BRIDGE SPECIFICATIONS OF 1948, AS APPROVED JULY 25, 1949 BY THE BUREAU OF PUBLIC ROADS, INCLUDING ALL SUBSEQUENT APPROVED REVISIONS AND SUCH REVISED SPECIFICATIONS AND SPECIAL PROVISIONS AS ARE SUBMITTED WITH THE PLANS.

APPROVED: [Signature] CONSTRUCTION ENGINEER DATE: 12-19-53	APPROVED: [Signature] SECONDARY ENGINEER DATE: 12-19-53	APPROVED: [Signature] DISTRICT ENGINEER DATE: 12-18-53	APPROVED: [Signature] HIGHWAY ENGINEER DATE: 12-18-53	APPROVED: [Signature] CHIEF ENGINEER DATE: 12-18-53
--	---	--	---	---

NOTE: ANY FURTHER INFORMATION CONCERNING FINAL QUANTITIES, AMOUNTS, OR OTHER DETAILS RELATIVE TO THIS PROJECT MAY BE FOUND IN EITHER THE FIELD BOOKS OR THE ESTIMATE FILE.

DEPARTMENT OF COMMERCE
BUREAU OF PUBLIC ROADS

DISTRICT ENGINEER: [Signature]

APPROVED: [Signature] DATE: []

PROJECT S NO. 209 (3)
SHEET 1 OF 59 SHEETS