

INDEX OF SHEETS

SHEET NO.	TITLE PAGE
1	TITLE PAGE
2	TYPICAL SECTIONS HOT MIXED MACADAM WITH CRUSHED GRAVEL AND ASPHALT CEMENT, ITEM 344-B
3	BANKING AND WIDENING TABLES
4	QUANTITY SHEET (ITEMS)
5-6	QUANTITY SHEETS (DRAINAGE)
7-13	EARTHWORK SHEETS
14-33	PLAN & PROFILE SHEETS
34-35	METAL PLATE ARCH DETAILS 395+50
36	CONSTRUCTION DETAILS CD DRAINAGE & MARKERS
37	CONSTRUCTION DETAILS CD-1 DITCHES
38	CONSTRUCTION DETAILS CD-2 TYPICAL SLOPE GRADING
39	STANDARD STRUCTURE SHEET S-53-48 DROP INLETS
40	STANDARD STRUCTURE SHEET S-40 BARRICADES, SIGNS & LIGHTS
41	STANDARD STRUCTURE SHEET S-48-46 THREE CABLE GUARD RAIL
42-101	CROSS SECTIONS

STANDARD STRUCTURE SHEETS APPROVED BY THE CHIEF ENGINEER, VERMONT STATE DEPARTMENT OF HIGHWAYS
S-40 JUNE 10, 1950

**STATE OF VERMONT
DEPARTMENT OF HIGHWAYS**

PROPOSED IMPROVEMENT

FEDERAL AID
SECONDARY PROJECT

**TOWNS OF CANAAN AND AVERILL
COUNTY OF ESSEX
VERMONT ROUTE 114
CANAAN-AVERILL ROAD**

BEGINNING AT A POINT 27,519 FEET EASTERLY OF THE CANAAN-AVERILL TOWN LINE AND EXTENDING WESTERLY 29,207.3 FEET.
LENGTH OF PROJECT 29,207.3 FEET = 5.632 MILES.
29,207.3 5.626

FED. ROAD DIST. NO.	STATE	PROJECT NO.	YEAR	SHEET NO.	TOTAL SHEETS
1	VT	S 2094	1955	1	101

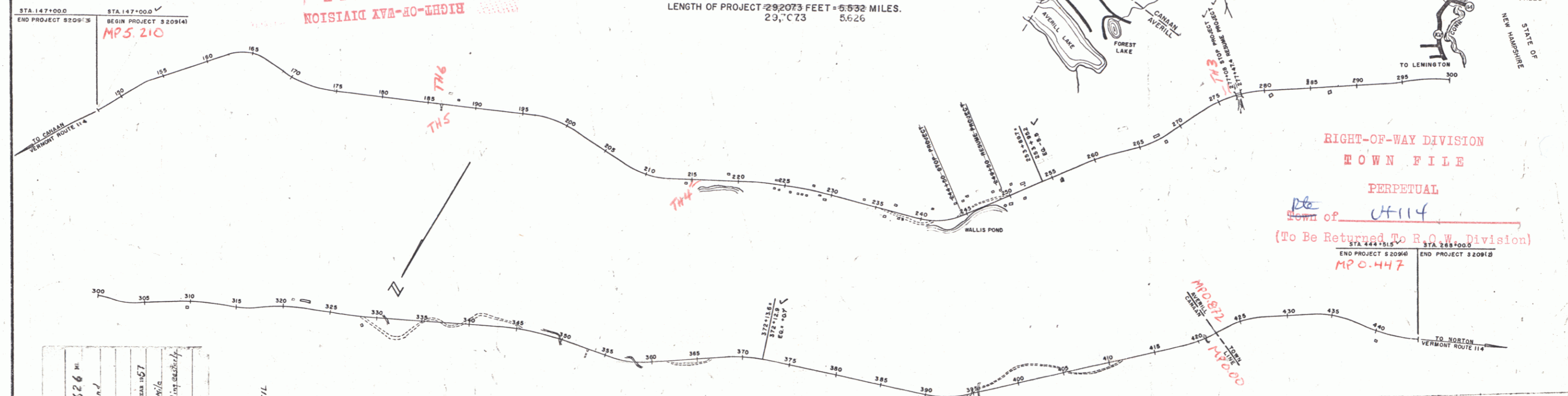
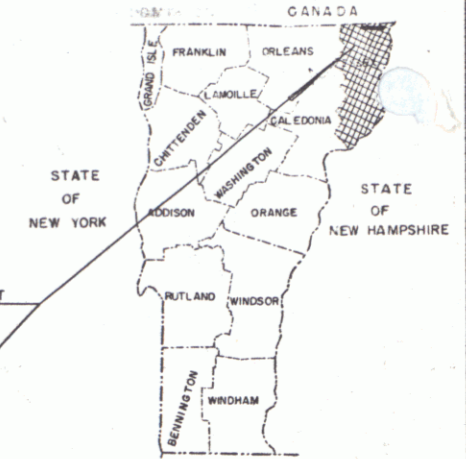

CANAAN-AVERILL
LENGTH 5.626 MI.
TRAFFIC
RAIL
REI
GEN
SUF
CUL
DRT
TRC
POW
TELEP
TREES
HEDGE

Hot mixed macadam with crushed gravel and asphalt cement surface course
Contractor Lambert Construction Co., Inc.
Location Vt. Route 114, beginning at a point 27,519 feet easterly of the Canaan-Averill town line and extending westerly 29,207.3 feet to the intersection of the Canaan-Averill town line and the Vermont State Department of Highways right-of-way line.

CANAAN-AVERILL
CONTRACTOR Lambert Const. Co. Inc.
RECORD PLANS 11 MILES
CONSTRUCTION COMPLETED Sept. 21, 1957

GROUND ELEVATION DATUM
GRADE ELEVATION DATUM

CURVE DATA
DEFLECTION OF ANGLE Δ
DEGREE OF CURVE D
RADIUS OF CURVE R
TANGENT DISTANCE T
LENGTH OF CURVE L
EXTERNAL DISTANCE E
POINT OF INTERSECTION P.I.
POINT OF CURVE P.C.
POINT OF TANGENT P.T.
POINT ON TANGENT P.O.T.
POINT ON SUB-TANGENT P.O.S.T.

SCALES

TITLE	1" = 500'
TYPICAL	1" = 2'
PLAN	1" = 50'
PROFILE HORIZONTAL	1" = 10'
CROSS-SECTIONS	1" = 5'

PROJECT NAME AND NUMBER	TYPE	PVMT AREA
CANAAN-AVERILL 5209 (4)	HOT MIX MACADAM	66,016 SQ.
RECORD PLANS		
MATERIALS		
SAND Wheeler Pt. Clarksville	GRAVEL Paquetta Pt. Clarksville MA	
ASPHALT Socany Riverside RI	REIN. STEEL Berger Metal Westminster VT	
AC.C.G.H.P. Berger Metal Westminster VT	CONCRETE Carpenter Transitmix St. Johnsbury VT	
R.C.P. Vermont Cone Pipe, Windsor	CABLE GUARD RAIL American Steel & Wire Co. New Haven Conn.	
CONTRACTOR Lambert Const. Co. Inc.	CONTRACT DATED Aug 31, 1955	
ENGINEERS R. J. Woodward 1955	CONTRACT STARTED Sept 8, 1955	
S. J. Gage 1956 H.M. Miles 1957	CONTRACT COMPLETED Sept 21, 1957	
INSPECTORS Earl Lane H.M. Miles	CONTRACT ACCEPTED Sept 14, 1957	
RECORD PLANS H.M. Miles		

THESE PLANS ARE SUBJECT TO SUCH REVISIONS AS MAY BE REQUIRED BY THE BUREAU OF PUBLIC ROADS OR THE COMMISSIONER OF HIGHWAYS.

CONSTRUCTION IS TO BE CARRIED ON IN ACCORDANCE WITH THE PLANS AND THE STANDARD ROAD AND BRIDGE SPECIFICATIONS OF 1948, AS APPROVED JULY 25, 1949 BY THE BUREAU OF PUBLIC ROADS, INCLUDING ALL SUBSEQUENT APPROVED REVISIONS AND SUCH REVISED SPECIFICATIONS AND SPECIAL PROVISIONS AS ARE SUBMITTED WITH THE PLANS.

NOTE: ANY FURTHER INFORMATION CONCERNING PLAN QUANTITIES, AMOUNTS OR OTHER DETAILS RELATIVE TO THIS PROJECT MAY BE FOUND IN EITHER THE FIELD BOOKS OR THE ESTIMATE FILE.

APPROVED CONSTRUCTION ENGINEER DATE JUN 3 1958	APPROVED SECONDARY ENGINEER DATE JUN 3 1958	APPROVED DISTRICT ENGINEER DATE 2/7/55	APPROVED CHIEF ENGINEER DATE JUN 3 1955	APPROVED CHIEF ENGINEER DATE Jan 4 1955
---	--	---	--	--

DEPARTMENT OF COMMERCE
BUREAU OF PUBLIC ROADS

APPROVED _____
DIVISION ENGINEER

DATE _____

PROJECT 5 NO. 209 (4)

SHEET 1 OF 101 SHEETS

WEBSTER-MARTIN, INC. - CONSULTING ENGINEERS
80 BURLINGTON, VT.