

CONSTRUCT DRIVE
 Lt Rt
 985+60 986+90
 986+60
 992+50
 Appr POT 989+08.2
 989+08.1 Lt

DRILLING AND BLASTING OF SOLID
 ROCK SUBGRADE
 985+50 - 988+25

STANDARD STEEL BEAM GUARD
 RAIL with STEEL POSTS
 Lt Rt
 984+96 - 985+28 984+90 - 985+86

CONSTRUCT APPROACH
 Lt
 989+08.2

CONSTRUCT PAVED GUTTER
 (with Bituminous Concrete - 3' wide)
 Rt
 986+20 - 987+25
 986+00 - 986+25

REMOVAL AND DISPOSAL OF PRESENT
 GUARD RAIL
 Lt Rt
 984+96 - 985+10 985+02 - 985+74

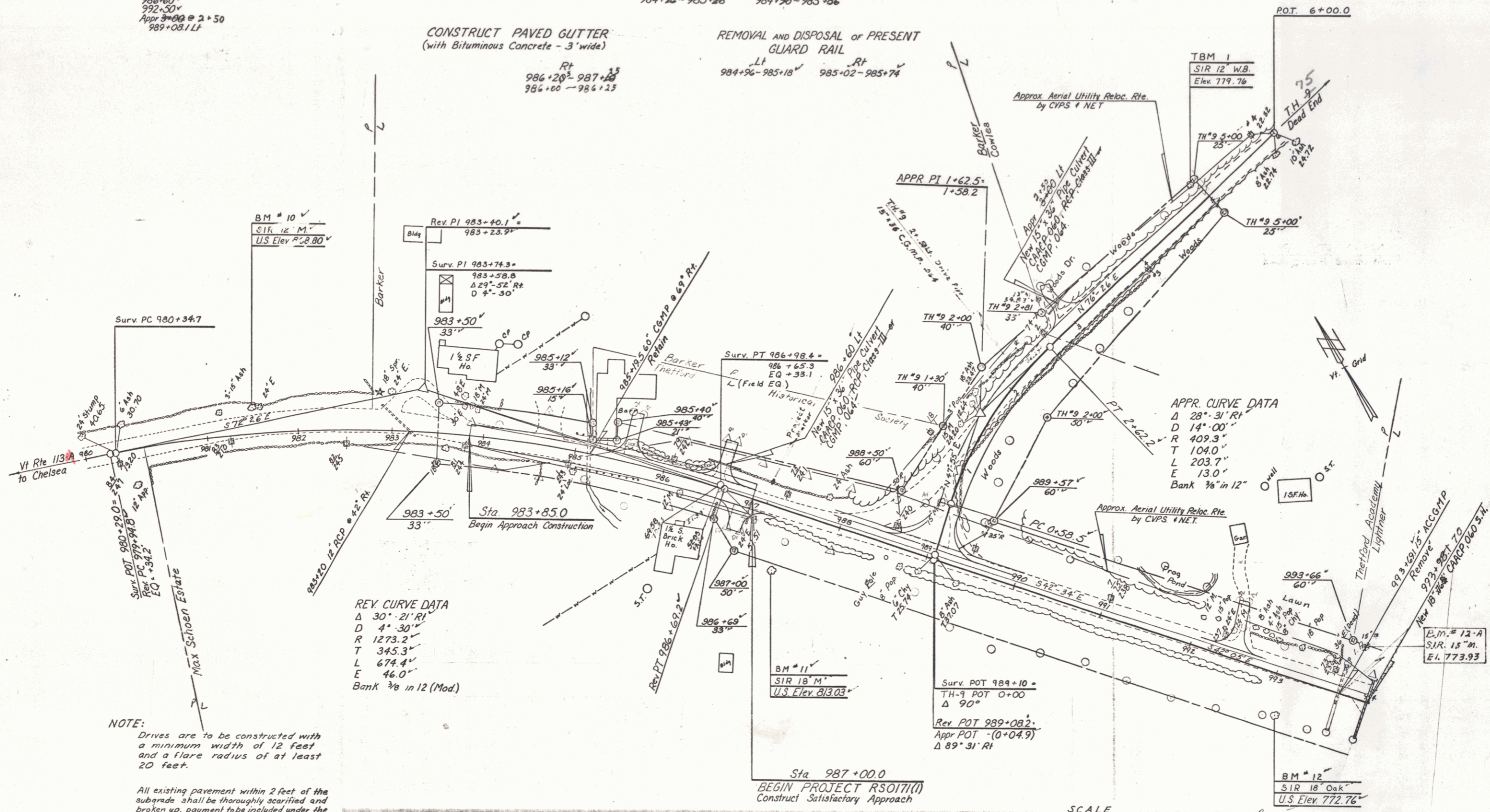

NOTE:
 Drives are to be constructed with a minimum width of 12 feet and a flare radius of at least 20 feet.
 All existing pavement within 2 feet of the subgrade shall be thoroughly scarified and broken up, payment to be included under the bid price of Common Excavation, Item 103-A-I

SURVEYED BY: Jillson DATE: 4
 DRAWN BY: Perkins DATE: 6
 TRACED BY: Perkins DATE: 9-3-69
THETFORD
 PROJ. RS NO. 0171(1)
 SHEET 7 OF 36
 D-7