

INDEX OF SHEETS

SHEET NO. 1 TITLE PAGE
 2 TYPICAL CROSS-SECTION OF IMPROVEMENT (DOUBLE TACK COAT OF REFINED TAR WITH PEASTONE SEAL)
 3 QUANTITY SHEET (ITEMS)
 4 QUANTITY SHEET (DRAINAGE)
 5-6 EARTHWORK SHEETS
 7-11 PLAN AND PROFILE SHEETS
 12 STANDARD STRUCTURE SHEET S 40 (BARRICADES, SIGNS & LIGHTS)
 13 STANDARD STRUCTURE SHEET S 48-46 (THREE CABLE GUARD RAIL)
 14 STANDARD STRUCTURE SHEET S 48-45 (TWO CABLE GUARD RAIL)
 15 STANDARD STRUCTURE SHEET S 53-2 (STEEL BEAM GUARD RAIL)
 16 STANDARD STRUCTURE SHEET S 53-48 (PC RCP DROP INLETS)
 17 CONSTRUCTION DETAILS CD (DRAINAGE & MARKERS)
 18 CONSTRUCTION DETAILS CD1 (DITCHES)
 19 CONSTRUCTION DETAILS CD2 (TYPICAL GRADING)
 20-23 CROSS-SECTIONS
 STANDARD STRUCTURE SHEET APPROVED BY THE CHIEF ENGINEER, VERMONT STATE DEPARTMENT OF HIGHWAYS
 S 40 JUNE 10, 1950
 WASTE DISPOSAL
 24-25 PLAN & PROFILE
 26 EARTHWORK SHEET
 27-28 CROSS SECTION SHEETS

STATE OF VERMONT
 DEPARTMENT OF HIGHWAYS
PROPOSED IMPROVEMENT
 FEDERAL AID PROJECT
TOWN OF THETFORD
 COUNTY OF ORANGE
VT ROUTE 113
POST MILLS - EAST THETFORD ROAD

BEGINNING AT A POINT APPROXIMATELY 700 FEET NORTHERLY OF TOWN HIGHWAY NO. 29 IN THE HAMLET OF THETFORD CENTER AND EXTENDING SOUTH EASTERLY 6593.8 FEET.
 LENGTH OF ROADWAY 6593.8 FT. = 1.249 MILES
 LENGTH OF PROJECT 6593.8 FT. = 1.249 MILES

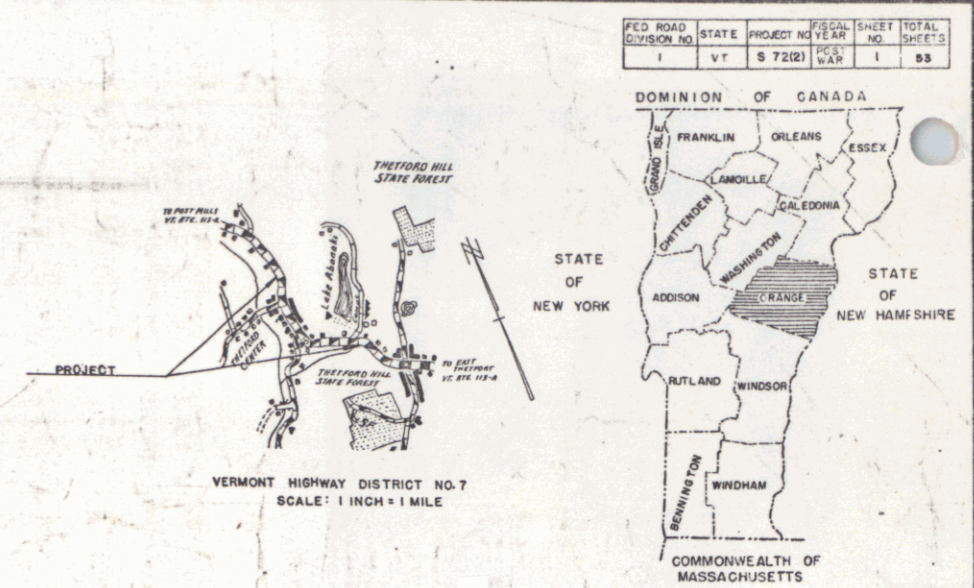

Bldg THIS END

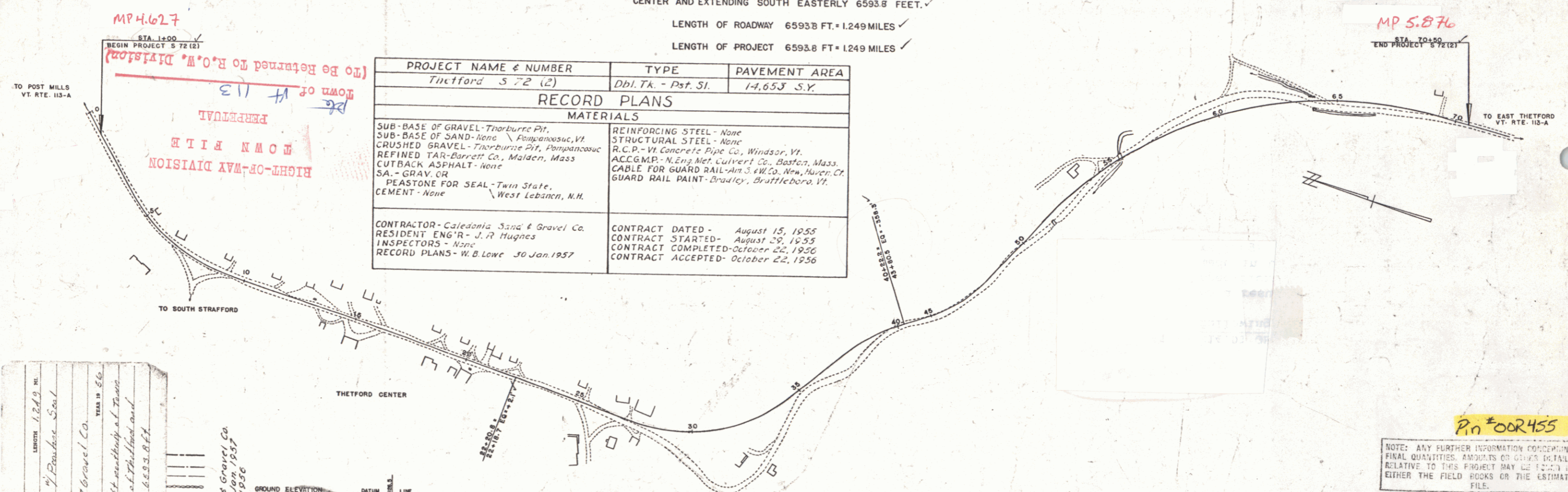

PROJECT NAME & NUMBER	TYPE	PAVEMENT AREA
Thetford S 72 (2)	Dbl. Tk. - Pst. Sl.	1-4,653 S.Y.
RECORD PLANS		
MATERIALS		
SUB-BASE OF GRAVEL - Thorburne Pit.	REINFORCING STEEL - None	
SUB-BASE OF SAND - None	STRUCTURAL STEEL - None	
CRUSHED GRAVEL - Thorburne Pit, Pompanoosuc, Vt.	R.C.P. - Vt. Concrete Pipe Co., Windsor, Vt.	
REFINED TAR - Barrett Co., Malden, Mass.	ACCG.M.P. - N. Eng. Met. Culvert Co., Boston, Mass.	
CUTBACK ASPHALT - None	CABLE FOR GUARD RAIL - Am. S. & W. Co., New Haven, Ct.	
SA. - GRAY CR	GUARD RAIL PAINT - Bradley, Brattleboro, Vt.	
PEASTONE FOR SEAL - Twin State.		
CEMENT - None		
CONTRACTOR - Caledonia Sand & Gravel Co.		CONTRACT DATED - August 15, 1955
RESIDENT ENG'R - J. P. Hughes		CONTRACT STARTED - August 29, 1955
INSPECTORS - None		CONTRACT COMPLETED - October 22, 1956
RECORD PLANS - W. B. Lowe 30 Jan 1957		CONTRACT ACCEPTED - October 22, 1956

PROJECT: Thetford
 DISTRICT: S 72 (2)
 TYPE: 61. Thetford Rd. to 4' Pouchie Seal
 CONTRACT: W. B. Western Sand & Gravel Co.
 LOCATION: Beginning approx. 700 ft. north of Vt. 29 in hamlet of Thetford Center and extending south easterly 6593.8 ft.

THETFORD S 72 (2)
 CONTRACTOR: Caledonia Sand & Gravel Co.
 RECORD PLANS: W. B. Lowe 30 Jan 1957
 CONTRACT COMPLETED: 22 Oct 1956

SCALES

TITLE 1" = 200'
 TYPICAL 1" = 2'
 PLAN 1" = 50'
 PROFILE HORIZONTAL 1" = 10'
 PROFILE VERTICAL 1" = 10'
 CROSS-SECTIONS 1" = 5'

APPROVED: [Signature] DISTRICT ENGINEER DATE July 11 1955
 APPROVED: [Signature] SECONDARY ENGINEER DATE 7/11/55
 APPROVED: [Signature] DISTRICT ENGINEER DATE Mar. 14, 1955
 APPROVED: [Signature] DISTRICT ENGINEER DATE July 11 1955
 APPROVED: [Signature] DISTRICT ENGINEER DATE July 11 1955

NOTE: ANY FURTHER INFORMATION CONCERNING FINAL QUANTITIES, AMOUNTS OR OTHER DETAILS RELATIVE TO THIS PROJECT MAY BE FOUND IN EITHER THE FIELD BOOKS OR THE ESTIMATE FILE.

DEPARTMENT OF COMMERCE
 BUREAU OF PUBLIC ROADS
 APPROVED: [Signature] DISTRICT ENGINEER DATE

PROJECT S NO. 72(2)
 SHEET 1 OF 23 SHEETS