

FLAT  
 1/4" = 100'  
 1/8" = 50'  
 1/16" = 25'  
 1/32" = 12.5'

VERTICAL  
 1" = 10'  
 1/2" = 5'  
 1/4" = 2.5'

CONSTRUCT STA.	DRIVES Pos.
579+00.00	RT
580+71.4	RT
587+62.1	LT
588+50.0	LT
589+99.0	LT
582+10.0	LT

Non-Op't Participation  
 579+50 Install sleeve for water pipe  
 across roadway Item 103-A, Streets to  
 be furnished by property owner except for

CONSTRUCT APPROACH STA.	Pos.	LT.
589+37		

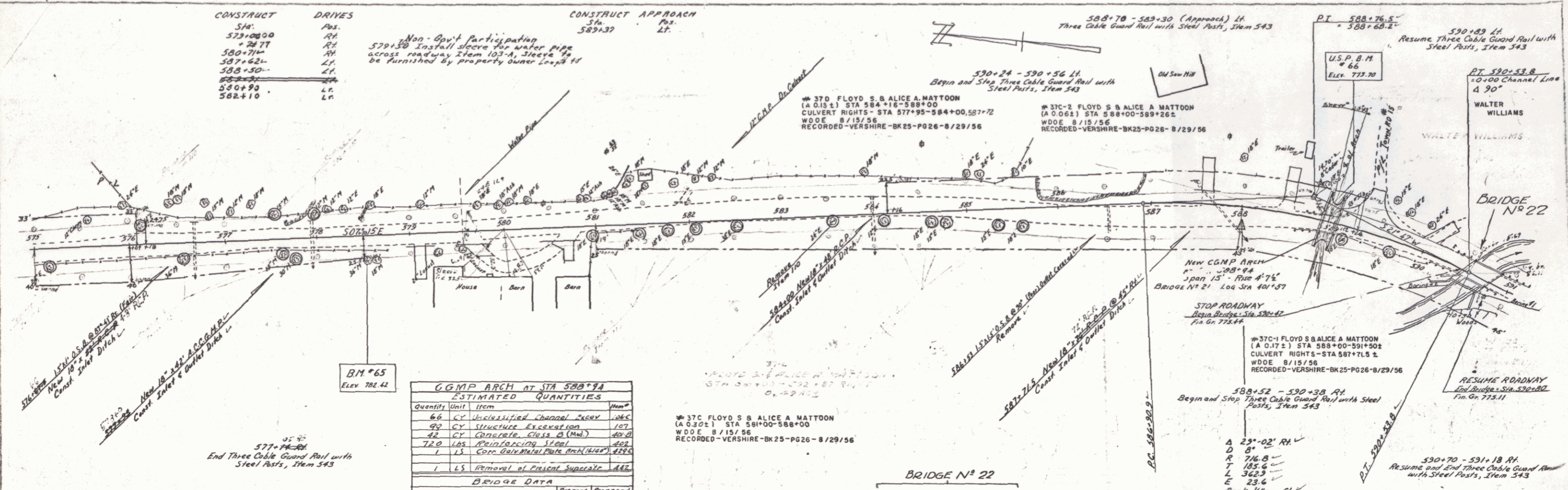

ESTIMATED QUANTITIES	
Quantity	Item
6.6	CV Unclassified Channel Excav
92	CV Structure Excavation
42	CV Concrete Class 2 (M4)
72.0	LS Reinforcing Steel
1	LS Corr Galv Metal Plate Arch (1/2\"/>

BRIDGE DATA	
Type	CGMP Arch
Clear Span Normal to Stream	10'
Clear Height	15'
Waterway	45' x 6.4'

LIST OF SHEETS  
 Plan & Profile - (This Sheet)  
 Details of CGMP Arch

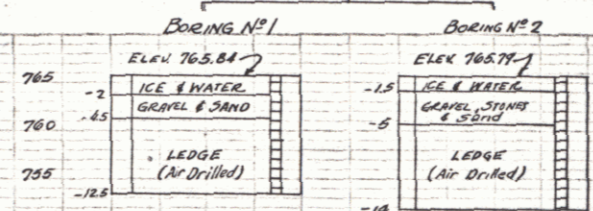

BRIDGE DATA (On No. 22)	
Type	CGMP Arch
General Length	53'
Clear Span to Stream	25'
Clear Height	9'
Roadway Width	20'
Waterway	22.5' x 22.5'
Elev. Max. High Water	771.00

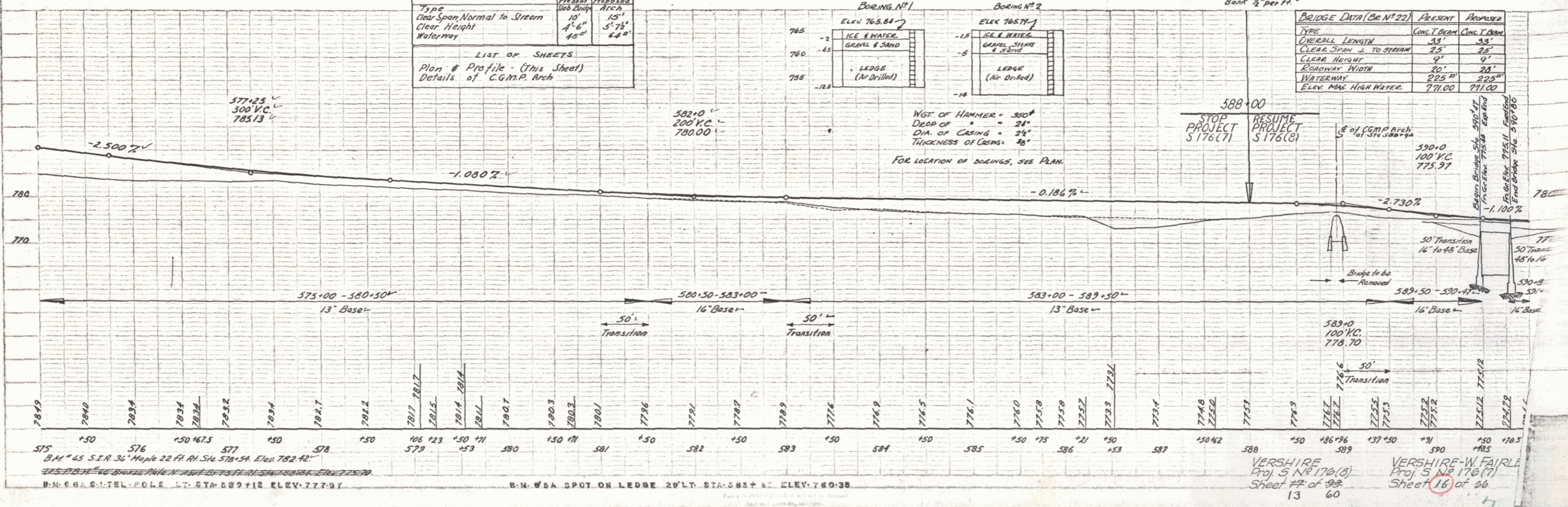

VERSHIRE  
 Proj. 5 N 170(1)  
 Sheet # of 98  
 13

VERSHIRE-W FAIRLE  
 Proj. 5 N 170(1)  
 Sheet (16) of 66