

| Station | Offset |
|---------|--------|
| 37400 | 4.5 |
| 37500 | 3.0 |
| 37600 | 0 |

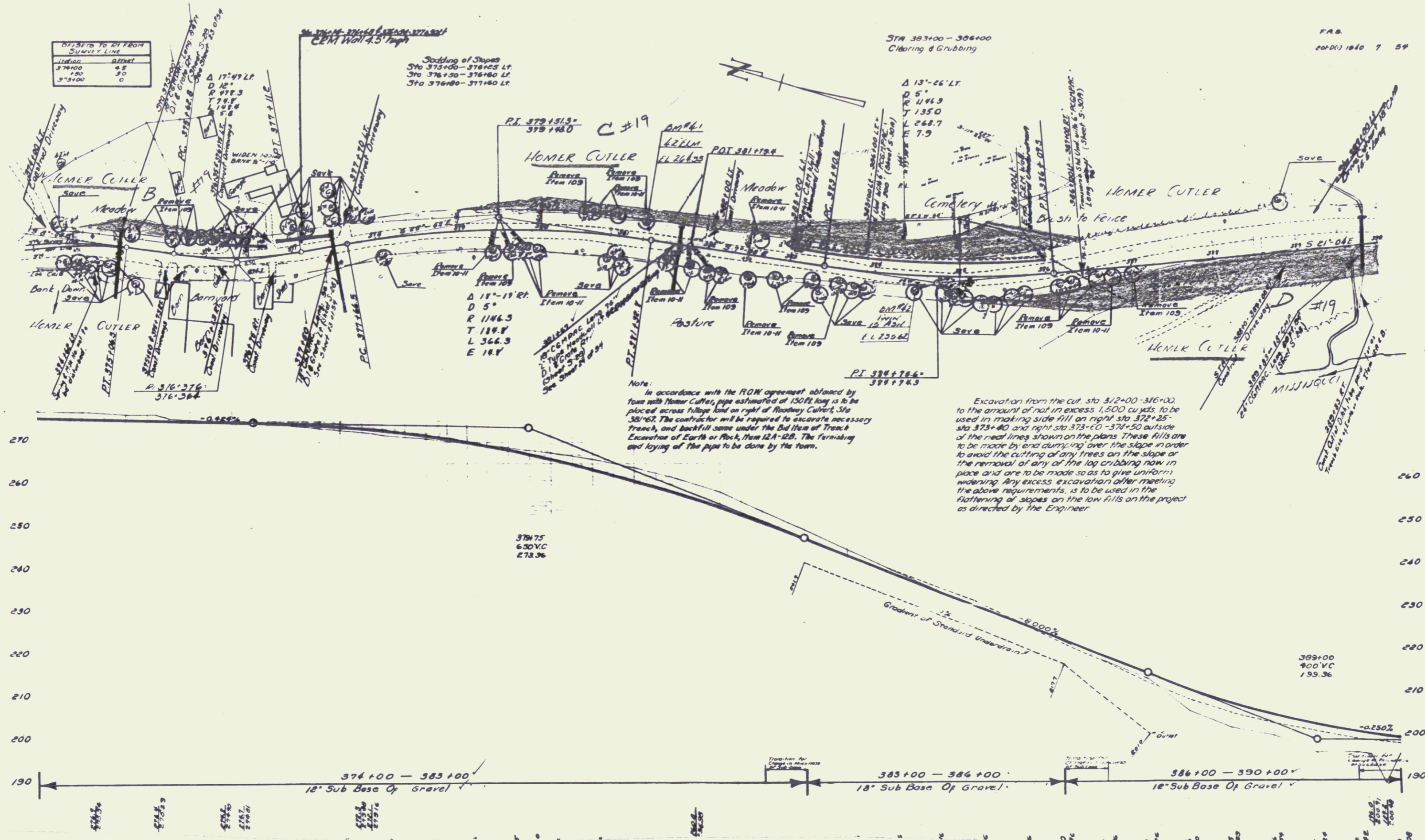

Note:
 In accordance with the ROW agreement obtained by
 town with Homer Cutler, pipe established at 150 ft long is to be
 placed across village land on right of Roadway Cutler, Sta
 381+67. The contractor will be required to excavate necessary
 trench, and backfill same under the Bid Item of Trench
 Excavate of Earth or Rock, Item 12A-12B. The forming
 and laying of the pipe to be done by the town.

Excavation from the cut, sta 312+00-316+00,
 to the amount of not in excess 1,500 cu yds. to be
 used in making side fill on right sta 372+25-
 sta 373+40 and right sta 373+00-374+50 outside
 of the real lines shown on the plans. These fills are
 to be made by end dumping over the slope in order
 to avoid the cutting of any trees on the slope or
 the removal of any of the log cribbing now in
 place and are to be made so as to give uniform
 widening. Any excess excavation after meeting
 the above requirements, is to be used in the
 flattening of slopes on the low fills on the project
 as directed by the Engineer.

SHEET 7