

STA 29+50-30+50-31+50 Lt.  
 The present plank superstructure on each of these bridges is to be carefully removed and replaced on the new abutments. Payment for this work is to be included in the bid price for Cement Rubble Masonry, Item 43.

Rev Curve  
 Δ 1°-45' Lt.  
 D 0°-20'  
 E 17108.8  
 T 242.6  
 L 323.0  
 E 2.0

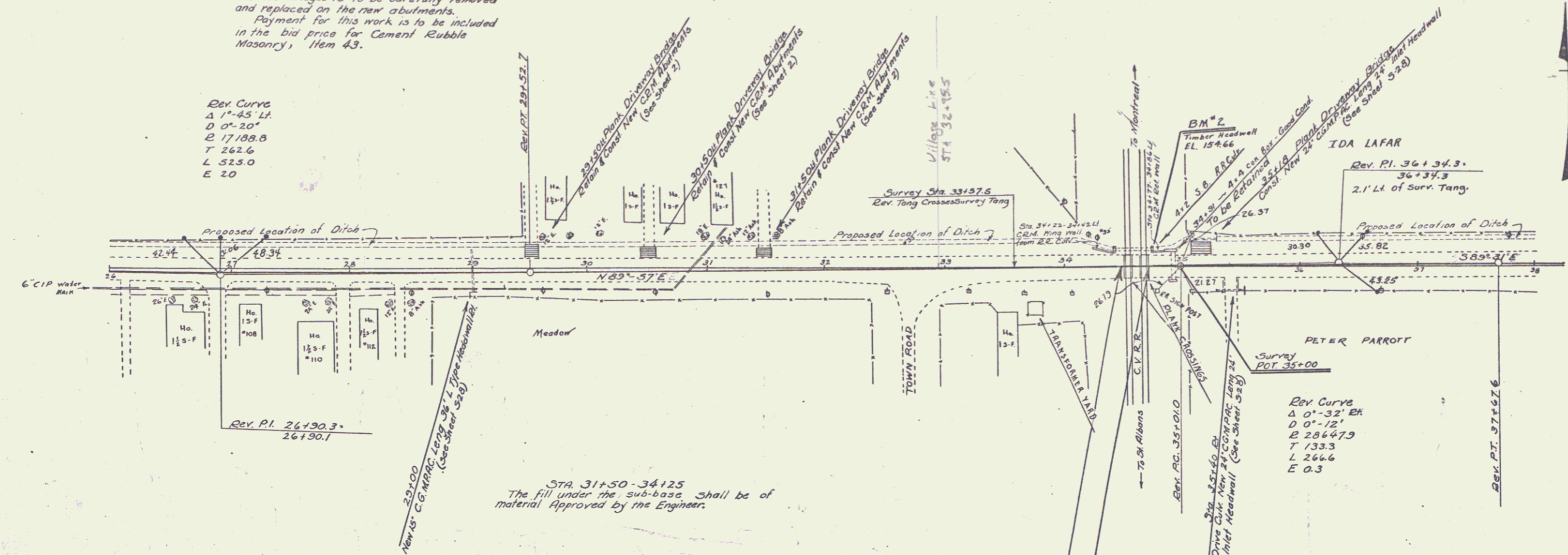

STA 31+50-34+25  
 The fill under the sub-base shall be of material approved by the Engineers.

Rev Curve  
 Δ 0°-32' Rt.  
 D 0°-12'  
 E 28664.79  
 T 133.3  
 L 266.6  
 E 0.3

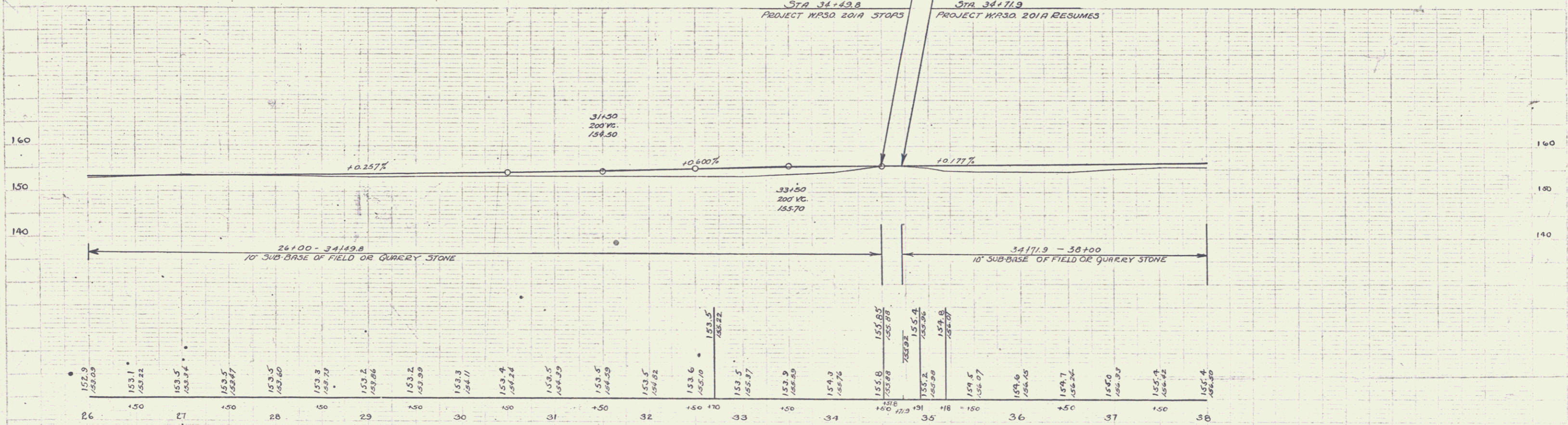

B.M. #2 - Spike in top of R.R. culvert head 15' left 34+77. Elev. = 154.66