

INDEX OF SHEETS

SHEET NO. 1	TITLE PAGE
2	TYPICAL CROSS SECTION OF IMPROVEMENT
3	BANKING & WIDENING TABLES
4	QUANTITY SHEET (ITEMS & DRAINAGE)
5-6	EARTHWORK SHEETS
7-10	PLAN AND PROFILE SHEETS
11	CONSTRUCTION DETAILS CD (DRAINAGE & MARKERS)
12	CONSTRUCTION DETAILS CD 2 (TYPICAL SLOPE GRADING)
13	STANDARD STRUCTURE SHEET S 40 (BARRICADES, SIGNS & LIGHTS)
14	STANDARD STRUCTURE SHEET S 40-46 (THREE CABLE GUARD RAIL)
15-29	CROSS SECTIONS

STANDARD STRUCTURE SHEET APPROVED BY THE CHIEF ENGINEER, VERMONT STATE DEPARTMENT OF HIGHWAYS S 40 JUNE 10, 1950

STATE OF VERMONT
DEPARTMENT OF HIGHWAYS
PROPOSED IMPROVEMENT

SECONDARY PROJECT

TOWNS OF CORNWALL AND SHOREHAM

COUNTY OF ADDISON

VT. ROUTE 74

CORNWALL-SHOREHAM ROAD

BEGINNING AT A POINT 3237.0 FEET EASTERLY OF THE CORNWALL-SHOREHAM TOWN LINE AND EXTENDING WESTERLY 4933.5 FEET
TOTAL LENGTH OF PROJECT 4933.5 FEET = 0.934 MILES.

PROJECT NAME AND NUMBER		TYPE	PAVEMENT AREA
CORNWALL-SHOREHAM S 26 (1)		DOUBLE TRACK PAVEMENT	11,111 sq. yds.
RECORD PLANS			
MATERIALS			
CEMENT; Atlas Cement - Hudson, N.Y.	CGRRAL; Cable American Street & Wire Co. - New Haven, Conn.		
SAND; Casey's Plant - Hinesburg, Vt.	Paint; Erudley Labs. - Brattleboro Vt.		
STONE; " " " " " "	LEDGE ROCK; Lewis Cut on Pog		
TA; " " " " " " " "	Asphalt Ledge - Shoreham Vt.		
RCP; Vt. Concrete Pipe Co. - Windsor, Vt.	SAND; Bass Douglas Pit - Shoreham Vt.		
ACCOMP.; " " " " " " " "	GRAVEL; O'Dell's Pit - Cornwall Vt.		
REIN. STEEL; W. Structures - Shelburne, Burlington, Vt.	Muck's Pit - E. Middlebury Vt.		
CONTRACTOR; Ray Dubois	CONTRACT DATED - Dec. 21, 1955		
RES. ENGR.; C. J. Crosswell	STARTED - April 25, 1956		
RECORD PLANS; C. J. Crosswell 1-31-57	COMPLETED - Dec. 12, 1956		
	ACCEPTED - Dec. 12, 1956		

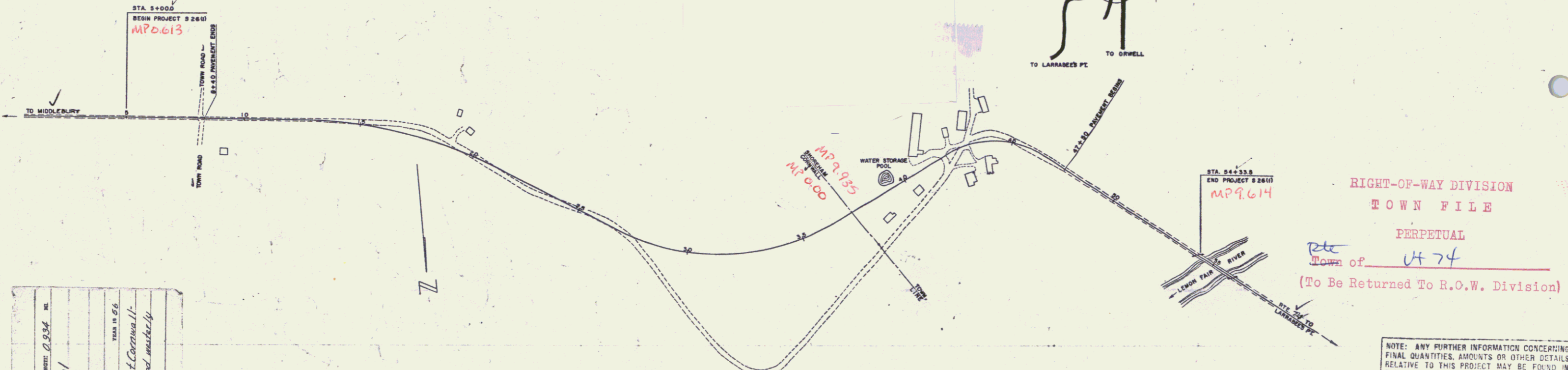
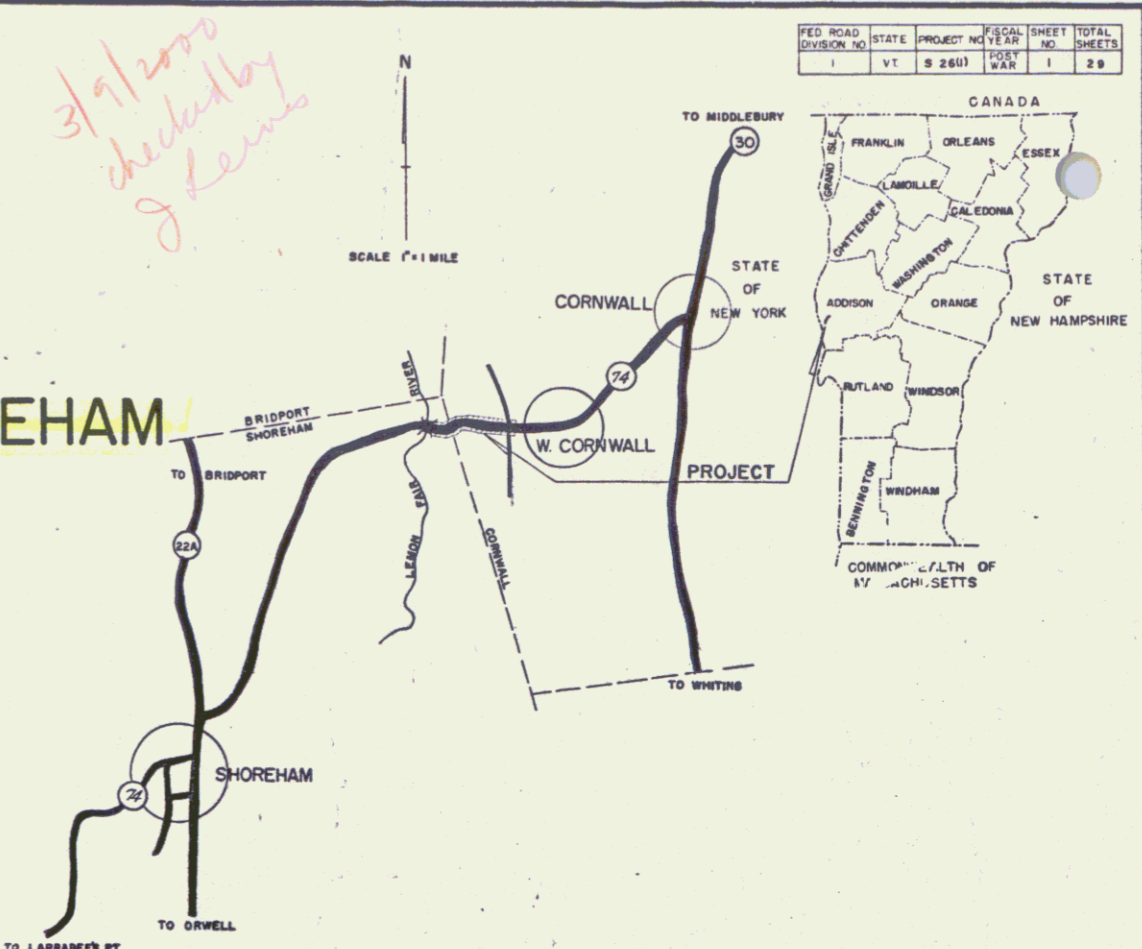

Cornwall - Shoreham
S 26 (1)
Length: 0.934 mi.
Year: 1956
Location: Beg. 3237.0 ft. easterly of Cornwall-Shoreham town line and extend westerly 4933.5 ft.

GROUND ELEVATION DATUM: M.S.L. LINE

GRADE ELEVATION DATUM: M.S.L. LINE

CURVE DATA

DEFLECTION OF ANGLE	A
DEGREE OF CURVE	D
RADIUS OF CURVE	R
TANGENT DISTANCE	T
LENGTH OF CURVE	L
EXTERNAL DISTANCE	E
POINT OF INTERSECTION	P.I.
POINT OF CURVE	P.C.
POINT OF TANGENT	P.T.
POINT ON TANGENT	P.O.T.
POINT ON SUB-TANGENT	P.O.S.T.

SCALES

TITLE	1" = 200'
TYPICAL	1" = 2'
PLAN	1" = 50'
PROFILE HORIZONTAL	1" = 50'
PROFILE VERTICAL	1" = 10'
CROSS-SECTIONS	1" = 5'

RIGHT-OF-WAY DIVISION
TOWN FILE
PERPETUAL
Town of VT 74
(To Be Returned To R.O.W. Division)

NOTE: ANY FURTHER INFORMATION CONCERNING FINAL QUANTITIES, AMOUNTS OR OTHER DETAILS RELATIVE TO THIS PROJECT MAY BE FOUND IN EITHER THE FIELD BOOKS OR THE ESTIMATE FILE.

Pin# 00R426

DEPARTMENT OF COMMERCE
BUREAU OF PUBLIC ROADS

THESE PLANS ARE SUBJECT TO SUCH REVISIONS AS MAY BE REQUIRED BY THE BUREAU OF PUBLIC ROADS OR THE COMMISSIONER OF HIGHWAYS.

CONSTRUCTION IS TO BE CARRIED ON IN ACCORDANCE WITH THE PLANS AND THE STANDARD ROAD AND BRIDGE SPECIFICATIONS OF 1948, AS APPROVED JULY 25, 1949 BY THE BUREAU OF PUBLIC ROADS, INCLUDING ALL SUBSEQUENT APPROVED REVISIONS AND SUCH REVISED SPECIFICATIONS AND SPECIAL PROVISIONS AS ARE SUBMITTED WITH THE PLANS.

APPROVED SECONDARY ENGINEER DATE <u>Sept 12 1955</u>	APPROVED CONSTRUCTION ENGINEER DATE <u>AUG 17 1955</u>	APPROVED DISTRICT ENGINEER DATE <u>Sept. 30, 1955</u>	APPROVED HIGHWAY ENGINEER DATE <u>Oct 12, 1955</u>	APPROVED CHIEF ENGINEER DATE <u>OCT 17 1955</u>
--	--	---	--	---

APPROVED
DISTRICT ENGINEER
DATE

PROJECT S. NO. 26 (1)
SHEET 1 OF 29 SHEETS
WEBSTER-MARTIN, INC. CONSULTING ENGINEERS, 30 BURLINGTON, VERMONT

3/9/2000 checked by J. Lewis