

CONSTRUCTION NOTES
 ROCK FILLS ARE TO BE MADE WITH
 EXCAVATION ON THE PROJECT. NO
 FILL COMPENSATION WILL BE
 MADE FOR THIS ITEM

"SUB-BASE OF GRAVEL, ITEM 3014"
 SHALL BE USED TO STABILIZE CUT SLOPES
 AS INDICATED ON THE PLANS OR AS ORDERED
 BY THE ENGINEER

ALL DRIVES WILL HAVE A MINIMUM
 12' WIDTH AND 15' FLARE RADIUS

TWO CABLE GUARD RAIL
 LF
 405+00 - 407+04
 407+00 - 407+22
 407+50 - 407+90
 408+30 - 408+35

DRILLING AND BLASTING OF
 SOLID ROCK SUB-GRADE
 406+80 - 407+35
 407+35 - 407+50

Construct Drives
 412+50 BIV

PARCEL	: 1A	STA 404+00 - 418+52 ±
GRANTOR	:	GREEN MOUNTAIN NATIONAL FOREST
TAKING RIGHTS	:	1.7 A.1 REM.
TITLE TAKEN	:	SPECIAL USE PERMIT 8/15/62
RECORDED	:	NONAPPLICABLE DT.

PLAN
 DRAWN BY
 CHECKED BY
 DATE
 PROJECT NO.

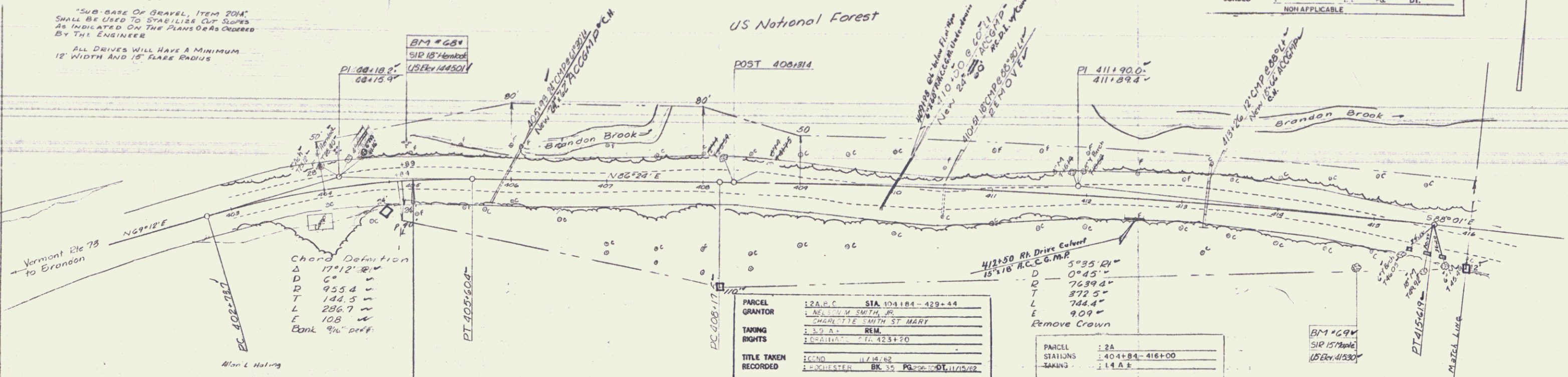

PROFILE
 DRAWN BY
 CHECKED BY
 DATE
 PROJECT NO.

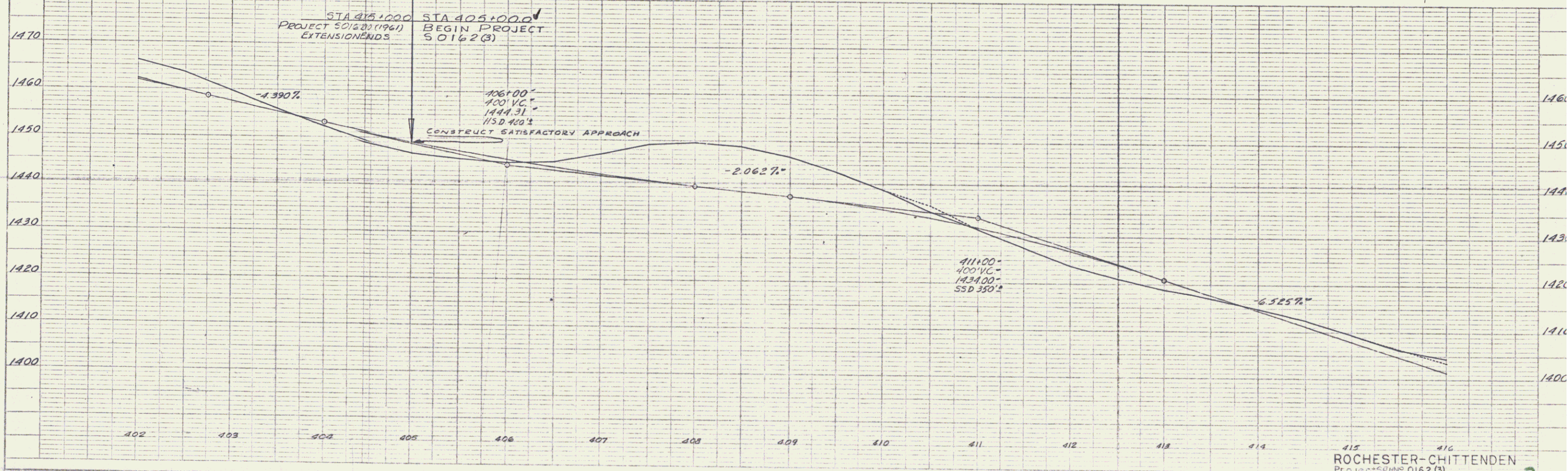

ROCHESTER-CHITTENDEN
 PROJECT 50162(3)
 SHEET 25 OF 28