

J.L.B. 10/10/00
 C.H.B. 10/10/00
 J.L.B. 10/10/00
 J.L.B. 10/10/00

J.L.B. 10/10/00
 C.H.B. 10/10/00
 J.L.B. 10/10/00
 J.L.B. 10/10/00

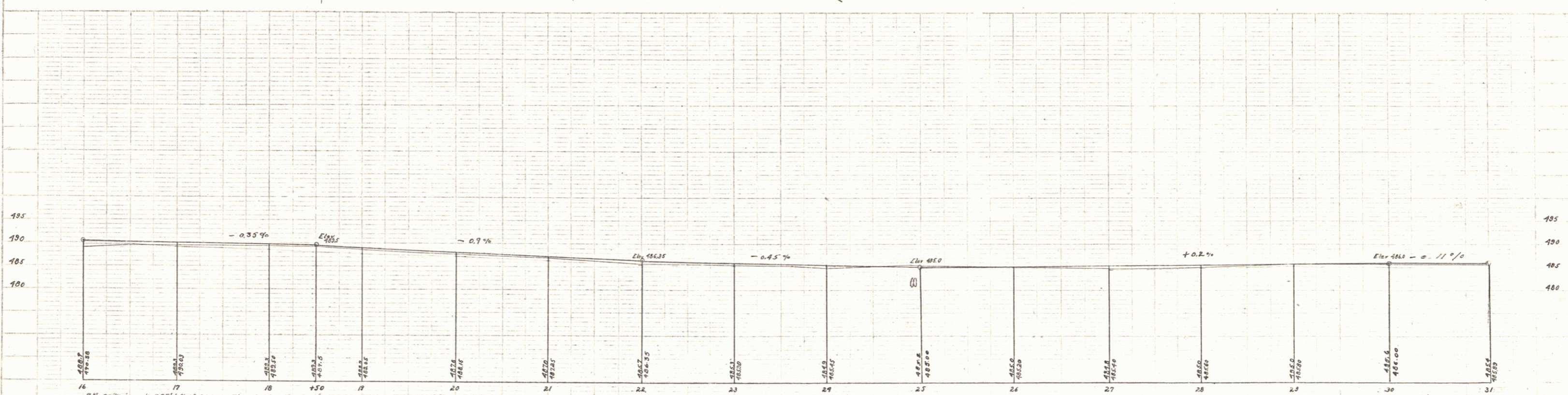
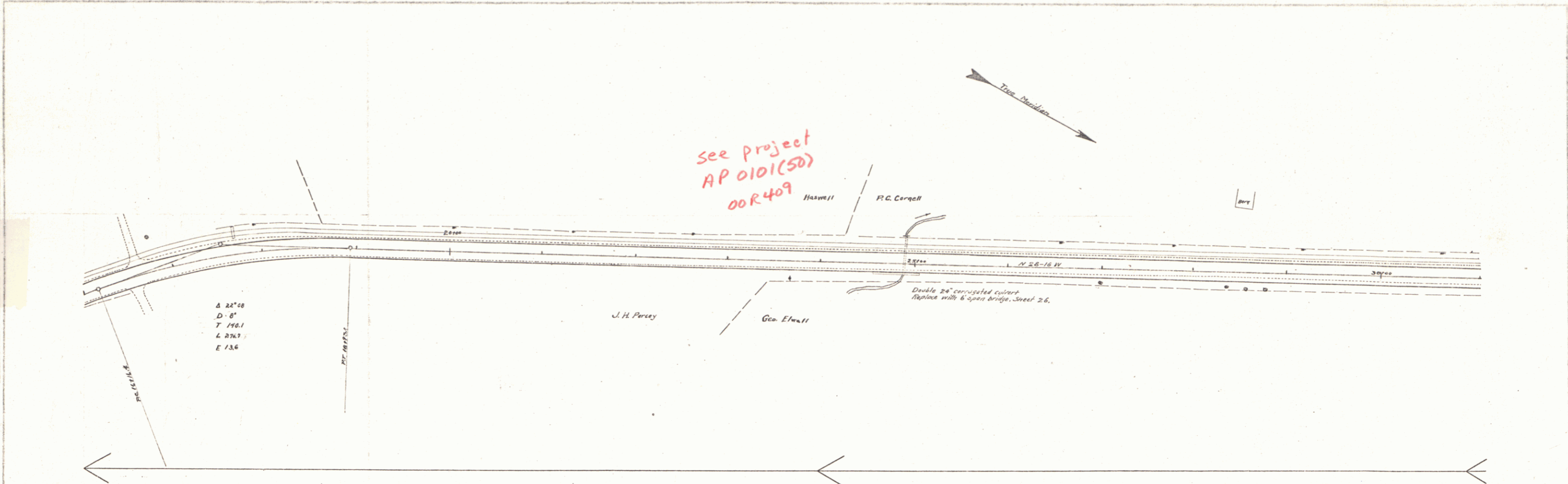

B.M. Spike in pole 265' left of 20+00, Elev 481.24
 B.M. Spike in elm left of Elev 485.51

Note: All Crown Elevations to be Lowered 0.08 FT.

Series J-5
 Sheet 3 of 26 M.B.-15