

INDEX OF SHEETS

SHEET NO. 1	TITLE PAGE
2	TYPICAL CROSS-SECTION OF IMPROVEMENT
3	BANKING AND WIDENING TABLES
4-5	QUANTITIES (DRAINAGE)
6	QUANTITIES (ITEMS)
7-11	EARTHWORKS
12-26	PLAN AND PROFILE
27	STANDARD STRUCTURE SHEET S-40 BARRICADES, SIGNS AND LIGHTS.
28	STANDARD STRUCTURE SHEET S-45-45 PLANK GUARD RAIL
29	STANDARD STRUCTURE SHEET S-46-45 BOUNDARY MARKERS
30	STANDARD STRUCTURE SHEET S-47-45 DROP INLETS AND HEADWALLS
31-69	CROSS SECTIONS

STANDARD STRUCTURE SHEETS APPROVED BY THE CHIEF ENGINEER, VERMONT STATE DEPARTMENT OF HIGHWAYS.

S-40	JUNE 10, 1950
S-46-45	JAN. 16, 1950
S-47-45	JAN. 16, 1950

STATE OF VERMONT
STATE HIGHWAY DEPARTMENT

PLAN AND PROFILE OF PROPOSED
STATE HIGHWAY

TOWN OF RANDOLPH
COUNTY OF ORANGE
RANDOLPH CTR.-E. RANDOLPH ROAD
STATE AID ROUTE

BEGINNING AT THE INTERSECTION OF THE RANDOLPH CENTER-BROOKFIELD ROAD, AND EXTENDING EASTERLY 19,5706 FEET.
LENGTH OF PROJECT 19,5706 FEET = 3.707 MILES

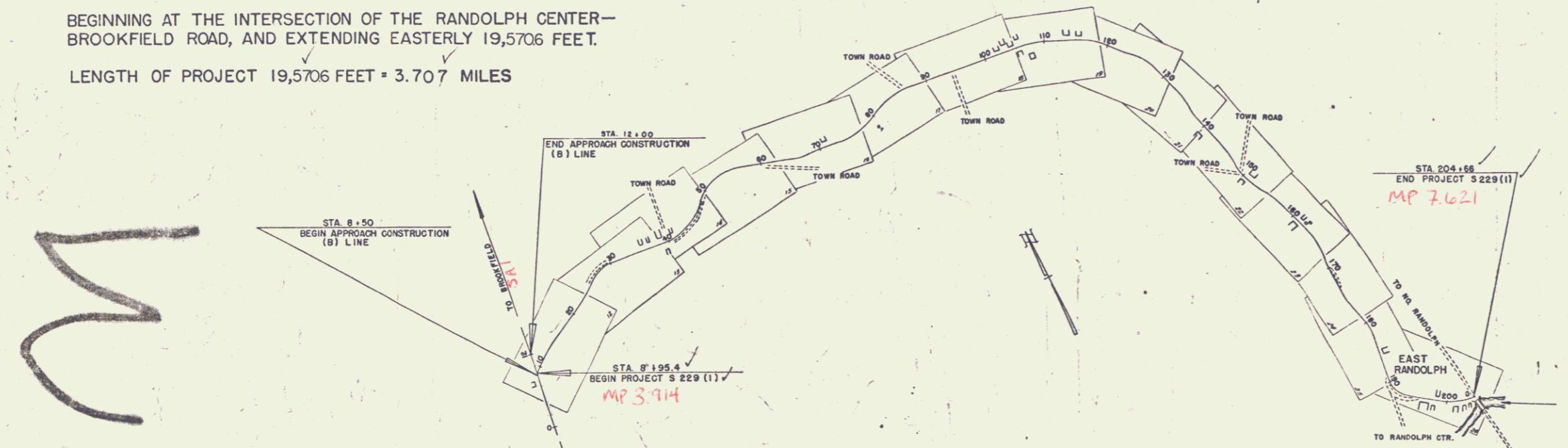
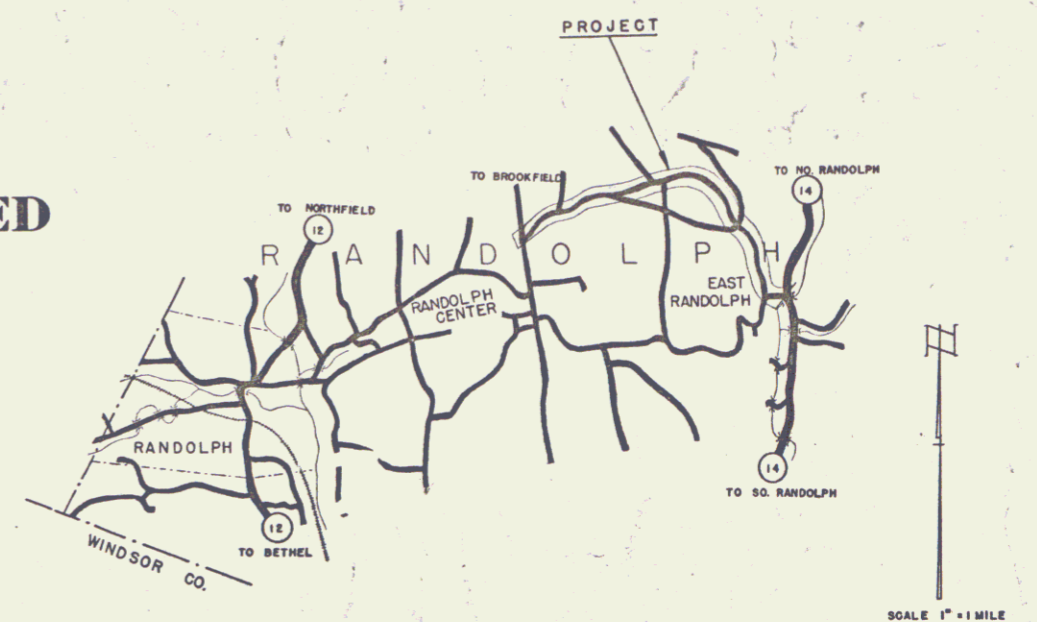

RIGHT-OF-WAY DIVISION
TOWN FILE
PERPETUAL
Town of Randolph
(To Be Returned To R.O.W. Division)

APPROVED: July 18, 1950
H.E. Sargent
CHIEF ENGINEER
SUBMITTED BY ORDER OF THE STATE HIGHWAY BOARD

CONTRACTOR: W. J. LaPerle
SUPERVISOR: W. J. LaPerle
DATE: July 11, 1950
LOCATION: Randolph, Vt.

CURVE DATA

DEFLECTION ANGLE Δ
DEGREE OF CURVE D
RADIUS OF CURVE R
TANGENT DISTANCE T
LENGTH OF CURVE L
EXTERNAL DISTANCE E
POINT OF INTERSECTION P. I.
POINT OF CURVE P. C.
POINT OF TANGENCY P. T.
POINT ON TANGENT P. O. T.

SCALES

TITLE	1" = 1000'
TYPICAL	1" = 2'
PLAN	1" = 50'
PROFILE HORIZONTAL	1" = 50'
PROFILE VERTICAL	1" = 10'
CROSS SECTIONS	1" = 5'

PROJECT NAME AND NUMBER	TYPE	PAVEMENT AREA
RANDOLPH S 229 (1)	ROAD	43,490 S.Y.
RECORD PLANS		
MATERIALS		
SUBBASE GRAVEL	SHAVILLE PIT LOCAL STONE	COLONIAL SD (DR. CO. SHILTON VERMONT)
REFINED TAR	BARRETT CO. (OLD COM)	WORCESTER, MASS.
REINFC. PIPE	WITLAND CONC. PIPE	ROSLAND VT.
A.C.C.M.P.	DANFORTH & MARTIN	ROSELAND MAINE
PERF. ACC. MUNDL	BLACKFLORENT	ROSLAND MAINE
CONTRACTOR	W. J. LA PERLE	CONTRACT DATED
RESIDENT ENGINEER	F. F. HARRIS	CONTRACT STARTED
INSPECTOR	E. J. JILLSON	CONTRACT COMPLETED
RECORD PLANS BY	E. J. JILLSON	CONTRACT ACCEPTED

THESE PLANS ARE SUBJECT TO SUCH REVISIONS AS MAY BE REQUIRED BY THE BUREAU OF PUBLIC ROADS OR THE COMMISSIONER OF HIGHWAYS.
CONSTRUCTION IS TO BE CARRIED ON IN ACCORDANCE WITH THE PLANS AND THE STANDARD ROAD AND BRIDGE SPECIFICATIONS OF 1948, AS APPROVED JULY 25, 1949 BY THE BUREAU OF PUBLIC ROADS INCLUDING ALL SUBSEQUENT APPROVED REVISIONS AND SUCH REVISED SPECIFICATIONS AND SPECIAL PROVISIONS AS ARE SUBMITTED WITH THE PLANS.

APPROVED: July 16, 1950 W. J. LaPerle HIGHWAY ENGINEER
APPROVED: July 17, 1950 W. J. LaPerle DISTRICT HIGHWAY COMMISSIONER
SERIES 5 No. 229(1) FILED
SHEET 1 OF 69