

GUARD RAIL, THREE CABLE w/ LT Wood Posts
 RT.
 108+50 ~ 118+82
 LT 11+27 - 71

CONSTRUCTION NOTE:
 Rock Fills Are To Be Made With Rock
 Excavation On The Project. No Further
 Compensation Will Be Made For This Item.

GUARD RAIL, STD STEEL BEAM w/ STEEL
 POSTS, TYPE II (12'-6" SPACING)
 RT.
 118+50 ~ 125+00
 LT 52

CONSTRUCT DRIVE
 LT
 110+00
 50

WOOD GUIDE POSTS (8'0" SPACING)
 LT
 109+00 ~ 110+00

DRILLING & BLASTING OF
 SOLID ROCK SUB GRADE
 LT
 111+75 ~ 119+25

REMOVAL & DISPOSAL OF
 EXISTING GUARD RAIL
 LT
 120+30 ~ 125+00
 RT
 114+10 ~ 120+50
 48

GUARD RAIL, PLANK w/ Wood Posts
 (for Barricade)
 RT
 109+45

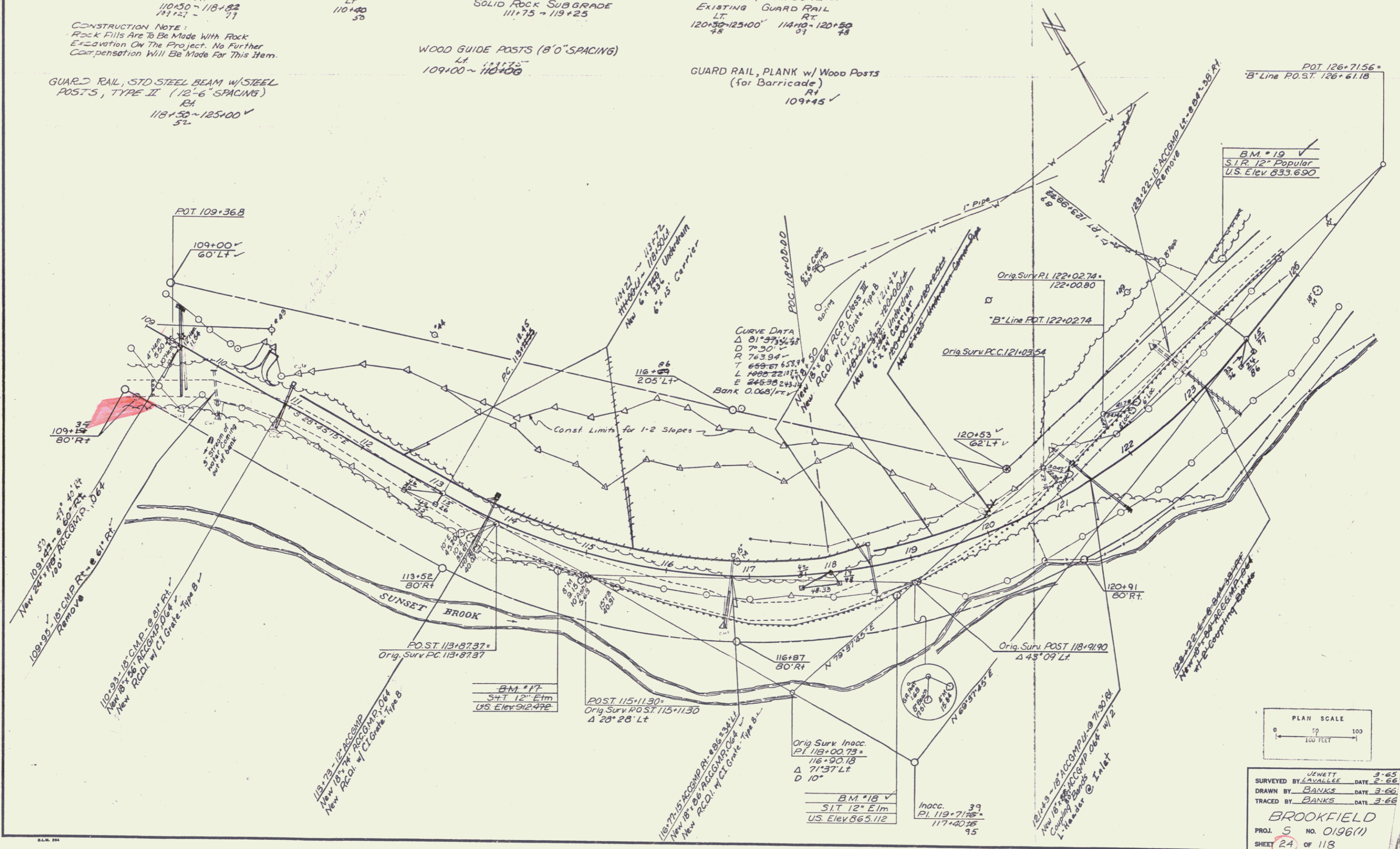

POT 126+71.56
 B-Line P.O.S.T. 126+61.18
 B.M. *19
 S.I.R. 12" Popular
 U.S. Elev 833.690

CURVE DATA
 Δ 81° 37' 54.48"
 D 7° 30' ✓
 R 763.94 ✓
 T 659.87 ✓
 L 1980.22 ✓
 E 24538.24 ✓
 Bank 0.068/ft ✓

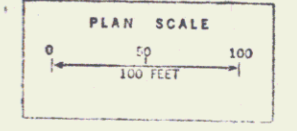

SURVEYED BY JEWETT DATE 3-65
 DRAWN BY LAVALLEE DATE 2-66
 TRACED BY BANKS DATE 3-66
 BROOKFIELD
 PROJ. S NO. 0196(1)
 SHEET 24 OF 118