

WOOD GL DE POSTS (8'-0" SPACING)

81+59 Rt 14
78+28 ~ 82+00
85+00 ~ 88+20
84+36 13

CONSTRUCT DRIVE

Lt 92+00 Rt 87
90+50
84+57

MUCK EXCAVATION

77+25 - 80+75

DRILLING AND BLASTING

OF SOLID ROCK SUBGRADE
81+75 - 84+75
86+75 - 91+75

STONE FILL, Type II

Lt Rt
81+50 (6' wide @ Outlet)

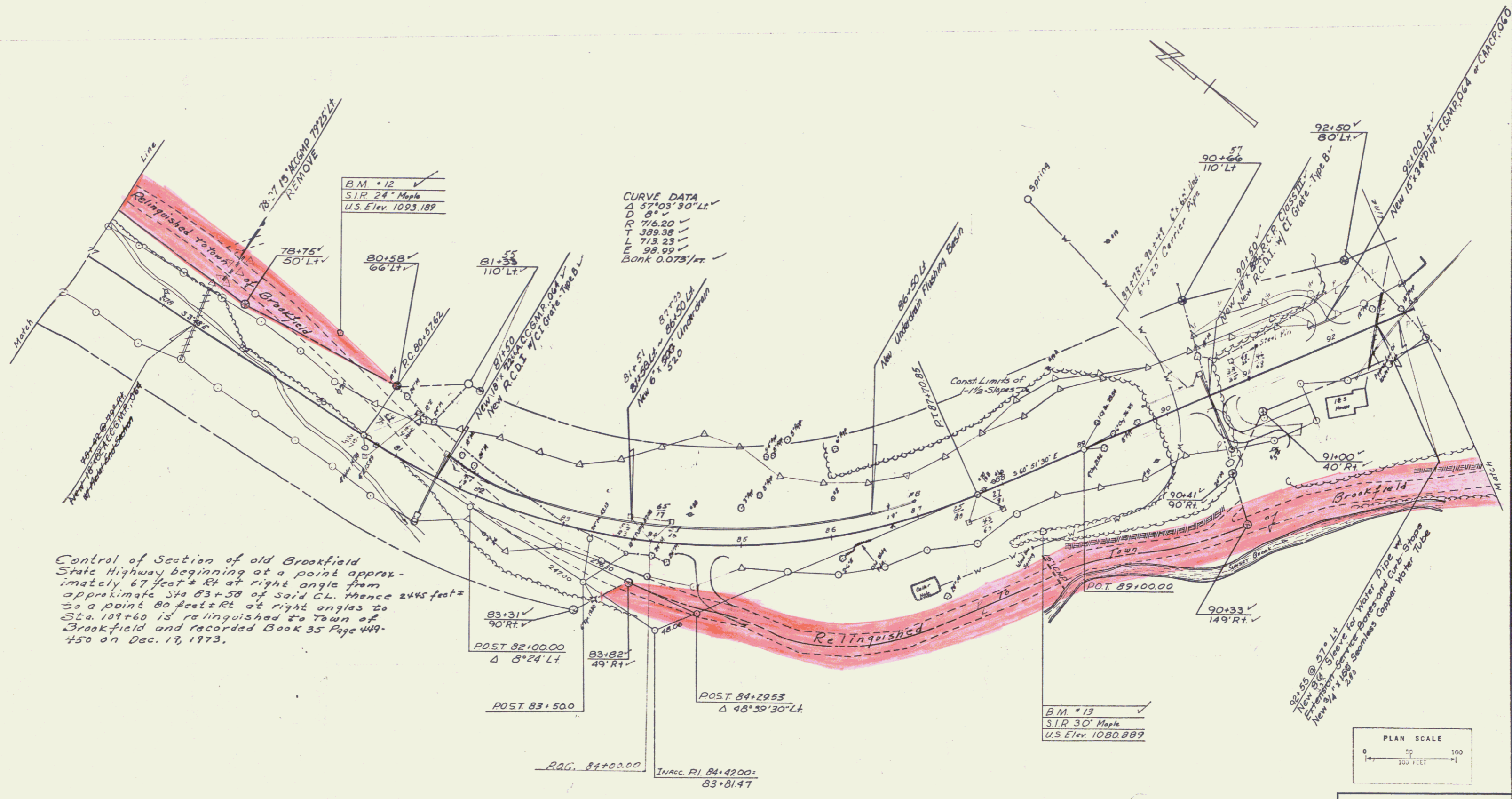

Control of Section of old Brookfield State Highway beginning at a point approximately 67 feet Rt at right angle from approximate Sta 83+58 of said GL, thence 2445 feet ± to a point 80 feet ± Rt at right angles to Sta. 109+60 is relinquished to town of Brookfield and recorded Book 35 Page 449-450 on Dec. 19, 1973.

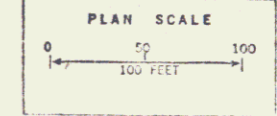

SURVEYED BY *Stuart H* DATE *Mar 1965*
 DRAWN BY *Sava* DATE *Mar 1965*
 TRACED BY *Woodback* DATE *Mar 1965*
 BROOKFIELD
 PROJ. S. NO. 0196(1)
 SHEET 20 OF 118