

TWO CABLE GUARD RAIL LT. Rev 48+00-50+24
 TREATED TIMBER CURB RT. Rev 48+50-Rev 61+00
 PAVED SHOULDERS (Item 361) LT. Rev 48+100-50+24 RT. Rev 48+50-Rev 61+00
 CONSTRUCT DRIVE LT. Rev 52+50 RT.
 MUCK EXCAVATION Rev 51+75-53+25

REMOVAL & DISPOSAL of PRESENT GUARD RAIL LT. Rev 52+35 RT. Rev 52+75

CONSTRUCT APPROACH LT. Rev 48+00

PLANK GUARD RAIL (For Barricades) LT. Rev 52+35 RT. Rev 52+75

END RELINQUISHMENT I STA. 48+23 (68' LT.)

BEGIN RELINQUISHMENT II STA. 51+50 (128' RT.) LENGTH 355' ±

END RELINQUISHMENT II STA. 55+00 80' RT.

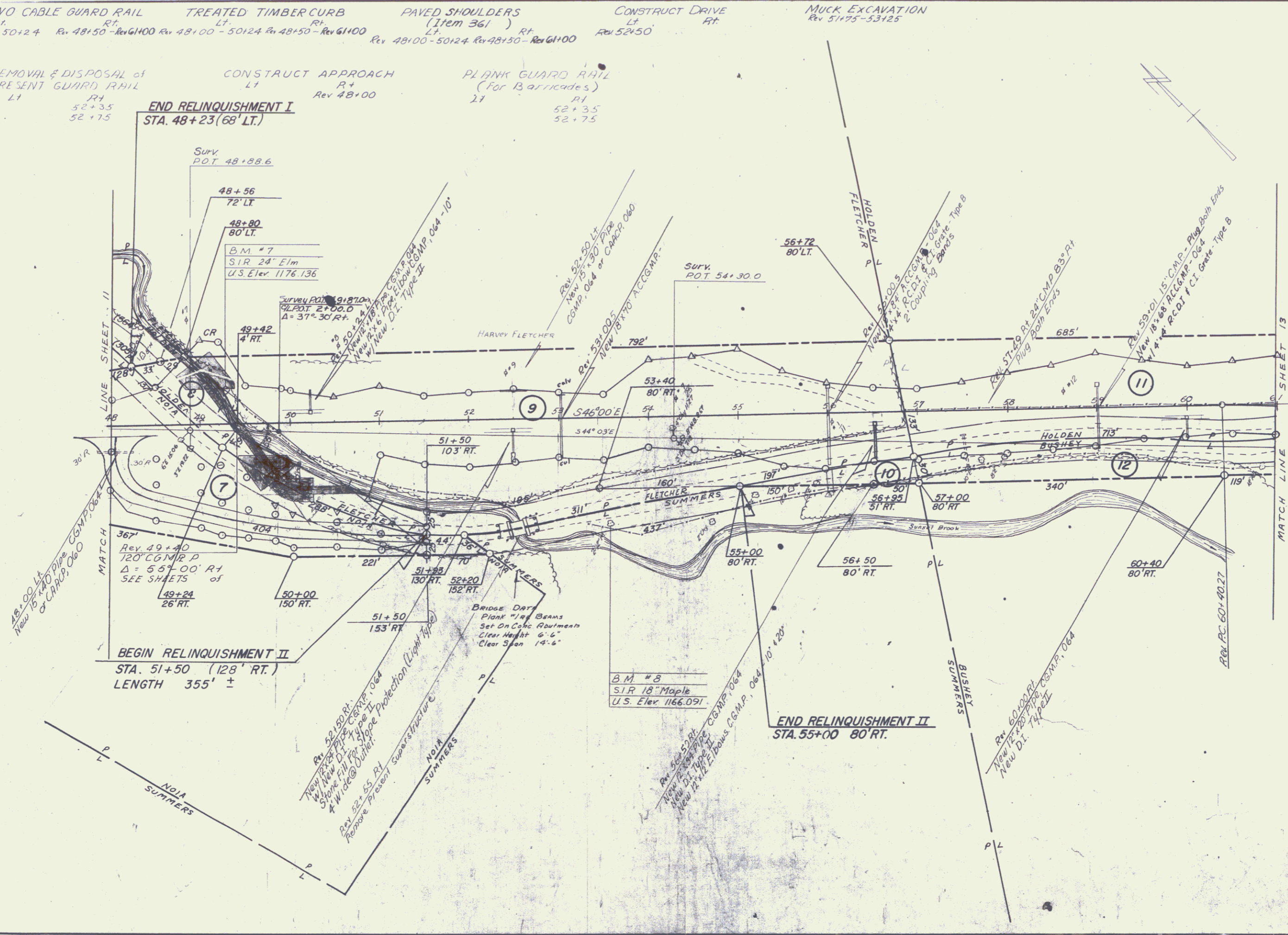

SURVEYED BY Woolley DATE Mar 1965
 DRAWN BY Sain DATE Mar 1965
 TRACED BY Woolley DATE Mar 1965
 BROOKFIELD
 PROJ. S NO. 0126(1)
 SHEET 16A OF 16

16