

TREATED TIMBER CURB
 LT. 48+00-50+24 RT. 48+60-60+00
 47+80-47+78 48+58 60+03

STONE FILL, TYPE I
 LT. 48+50-49+00 RT. 50+50-51+25

CONSTRUCT DRIVE
 LT. 51+50-52+15 RT. 51+25

MUCK EXCAVATION
 51+75-53+25

UNCLASSIFIED CHANNEL EXCAVATION
 LT. 48+74-49+10 RT. 49+56-51+00

CONSTRUCT APPROACH
 LT. 48+00-50+24 RT. 48+60-60+00
 47+80-50+18 48+35 61+00

GUARD RAIL, Plank w/ Wood Posts (For BARRICADES)
 LT. 48+106 RT. 52+35
 52+75 52+89

STONE FILL, Type II
 LT. 48+74-49+42 RT. 49+56-49+93
 50+30-50+75 52+50

STONE FILL, Type IV
 LT. 49+66-50+30 RT. 49+66-50+30

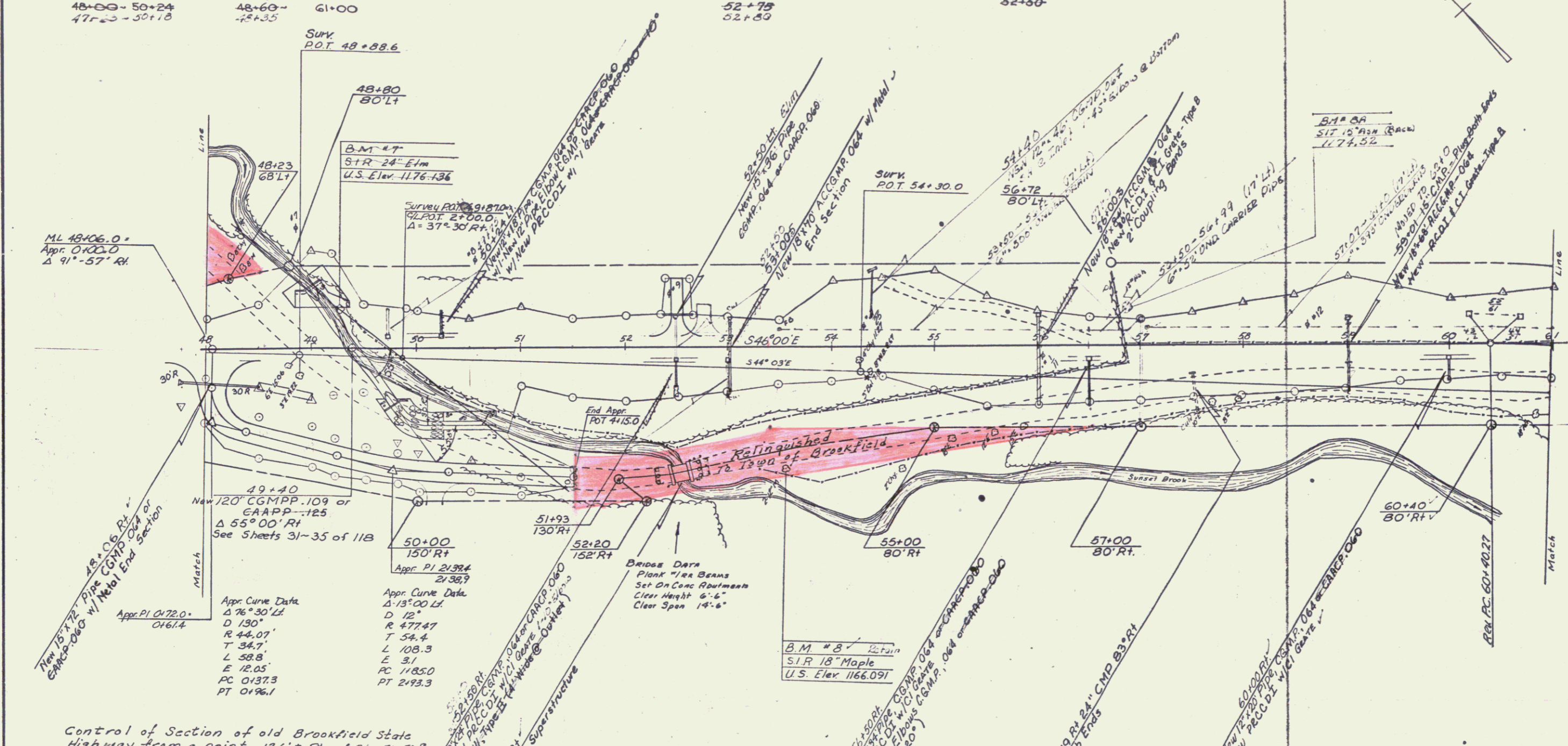

Control of Section of old Brookfield State Highway from a point 126' R of Sta 51+50 & thence approximately 500' southeasterly to a point 80' R of Sta. 56+50 in said & is Relinquished to the Town of Brookfield. Book 35 Page 441-450 Dec. 1973.

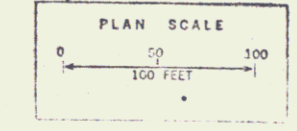

SURVEYED BY *W. H. H.* DATE *Mar. 1961*
 DRAWN BY *S. A. S.* DATE *Mar. 1961*
 TRACED BY *W. Woodcock* DATE *Mar. 1961*
 B. BROOKFIELD
 PROJ. S. NO. 0196(1)
 SHEET 16 OF 118

15