

GRANULAR BORROW
BERLIN ST HWY
89+00 - 104+00
RAMP A
27+50 - 36+40

SAND BORROW
RAMP A
23+75 - 27+50

GUARD RAIL, PLANK W/ WOOD POSTS
B.S.H. STA. 97+50 Lt.

GUARD RAIL, THREE CABLE
7 LIGHT STEEL POSTS
BERLIN STATE HWY
89+00 - 94+00 Rt.
93+10 - 96+78 Lt.

TREATED TIMBER CURB
RAMP A
34+28 - 36+40 Rt.

SODDING
BERLIN ST HWY
93+85 - 94+50 Rt.

STONE FILL, TYPE II
BERLIN ST HWY
89+00 - 93+85 Rt. (Spec. Ditch)
96+00 - 100+00 Lt. (Spec. Ditch)
100+62 - 100+92 Lt.

RAMP A
25+75 - 26+25 Lt.

34+20 - 34+50 Rt.

GRANITE SLOPE EDGING
BERLIN ST HWY
99+06 - 101+06 Rt. (Island)

STONE FILL, TYPE III
BERLIN ST HWY
100+00 - 100+70 Lt. (Spec. Ditch)

RAMP A
34+50 - 36+50 Rt. (Spec. Ditch)

GUARD RAIL STANDARD STEEL BEAM W/ STEEL POSTS, TYPE II
B.S.H. STA. 100+23 - 101+35 Lt.
RAMP A 23+00 - 25+00.5 Rt.

BERLIN STATE HIGHWAY
Δ 15° 03' 30" Lt.
D 2° 10' ✓
R 2546.40 ✓
T 336.57 ✓
L 669.26 ✓
E 22.15 ✓
Bank 0.0281 ft. per ft.

REMOVAL & DISPOSAL OF EXISTING GUARD RAIL
BERLIN STATE HIGHWAY
89+00 - 90+50 Rt.
93+00 - 94+50 Rt.
101+35 - 103+00 Lt.

EXCAVATION & REMOVAL OF ROAD SURFACES & PAVEMENTS
94+50 - 96+00 Lt. B.S.H.
101+80 - 102+90 Lt. B.S.H.

SEED
94+50 - 96+00 Lt. B.S.H.

AGRICULTURAL LIMESTONE
94+50 - 96+00 Lt. B.S.H.

FERTILIZER
94+50 - 96+00 Lt. B.S.H.

HAY MULCH
94+50 - 96+00 Lt. B.S.H.

TOPSOIL
94+50 - 96+00 Lt. B.S.H.

WOVEN WIRE FENCE W/ STEEL POSTS
89+00 - 101+20 Lt. B.S.H.
102+00 - 104+00 Lt. B.S.H.
23+00 - 33+44 Rt. Ramp A
34+17 Rt. Ramp A - 104+00 Rt. B.S.H.

CONSTRUCT DRIVE
33+70 Rt. (Ramp A)

CONSTRUCT APPROACH
101+60 Lt.

Stone Fill, Type I
Berlin State Hwy
89+50 - 94+75 Lt.
94+75 - 96+00 Lt.
Ramp A
24+25 - 25+75 Lt.
26+50 - 33+60 Rt.

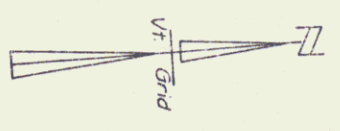
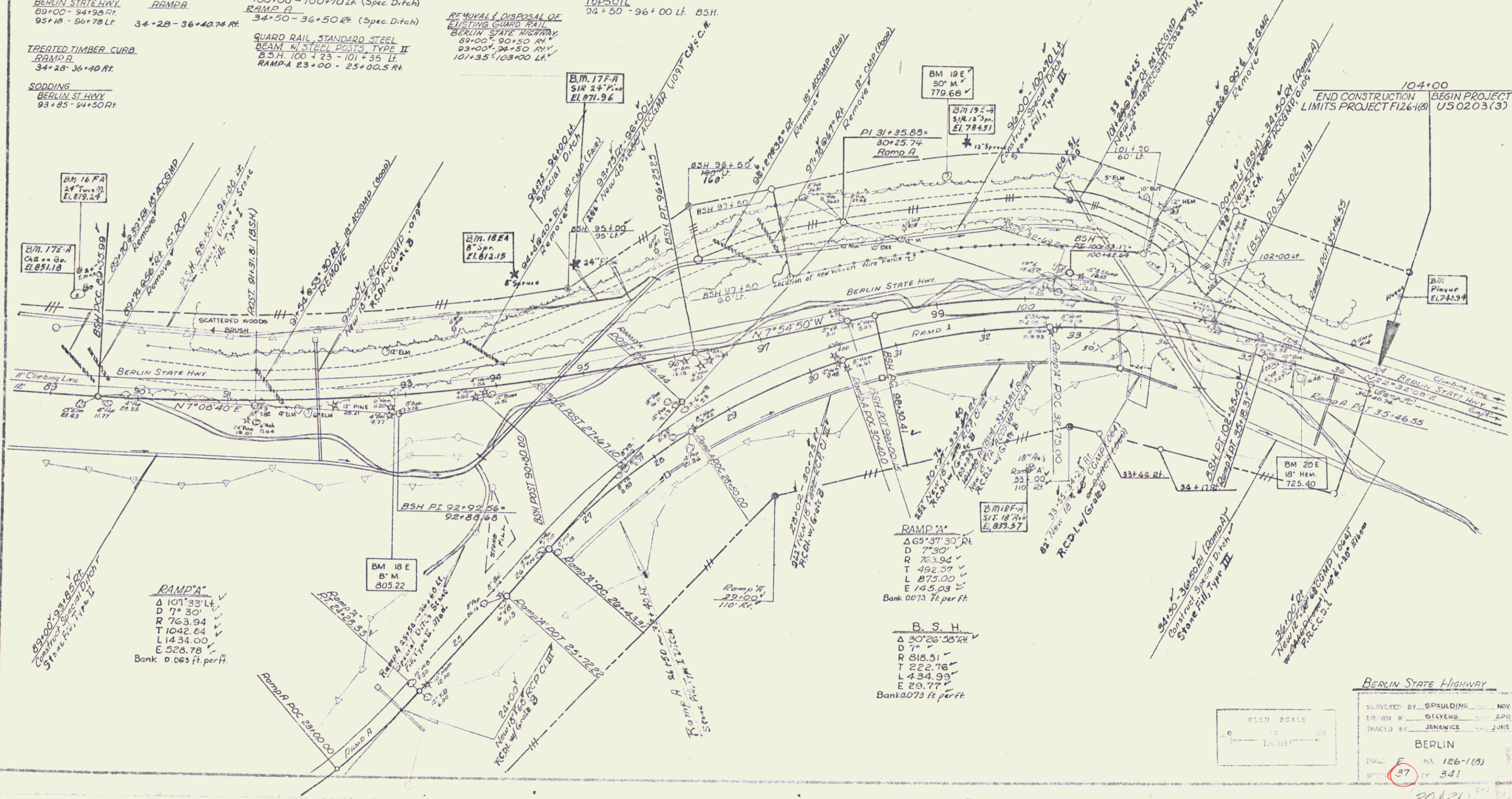

BERLIN STATE HIGHWAY

Surveyed by SPAULDING NOV 57
Drawn by STEVENS APR 58
Traced by JANAWICZ JUNE 58

BERLIN

NO. 126-1(B)
SHEET 37 OF 341