

GRANULAR BORROW
130+25 - 133+00
SAND BORROW
118+00 - 130+25
TREATED TIMBER CURB
118+00 - 119+50 Lt
131+00 - 133+00 Rt

GUARD RAIL, THREE CABLE
W/ LIGHT STEEL POSTS
118+00 - 120+00 Lt
130+26 - 133+00 Rt
GUARD RAIL, STANDARD STEEL
BEAM w/ STEEL POSTS, TYPE II
125+44 - 133+00 Lt

EXCelsIOR MATTING
124+50 - 127+00 Rt (Inf. Ditch)
127+00 - 128+25 Rt (Inf. Ditch)
WOVEN WIRE FENCE w/ STEEL POSTS
118+00 - 133+00 Rt

STONE FILL, TYPE I
118+00 - 120+00 Rt (Inf. Ditch)
120+00 - 124+50 Rt (Inf. Ditch)
118+00 - 130+50 Rt (Slope, Refer to Sht. 40 of 341)

STEVENS BRANCH

BM 20G
SIR 12' YB
643.69

BM 21G
SIR 12' YB
664.75

BM 22G
SIR 6' Ash
630.19

BM 23F
SIR 12' Ash
641.57

BM 24F
SIR 15' New
618.17

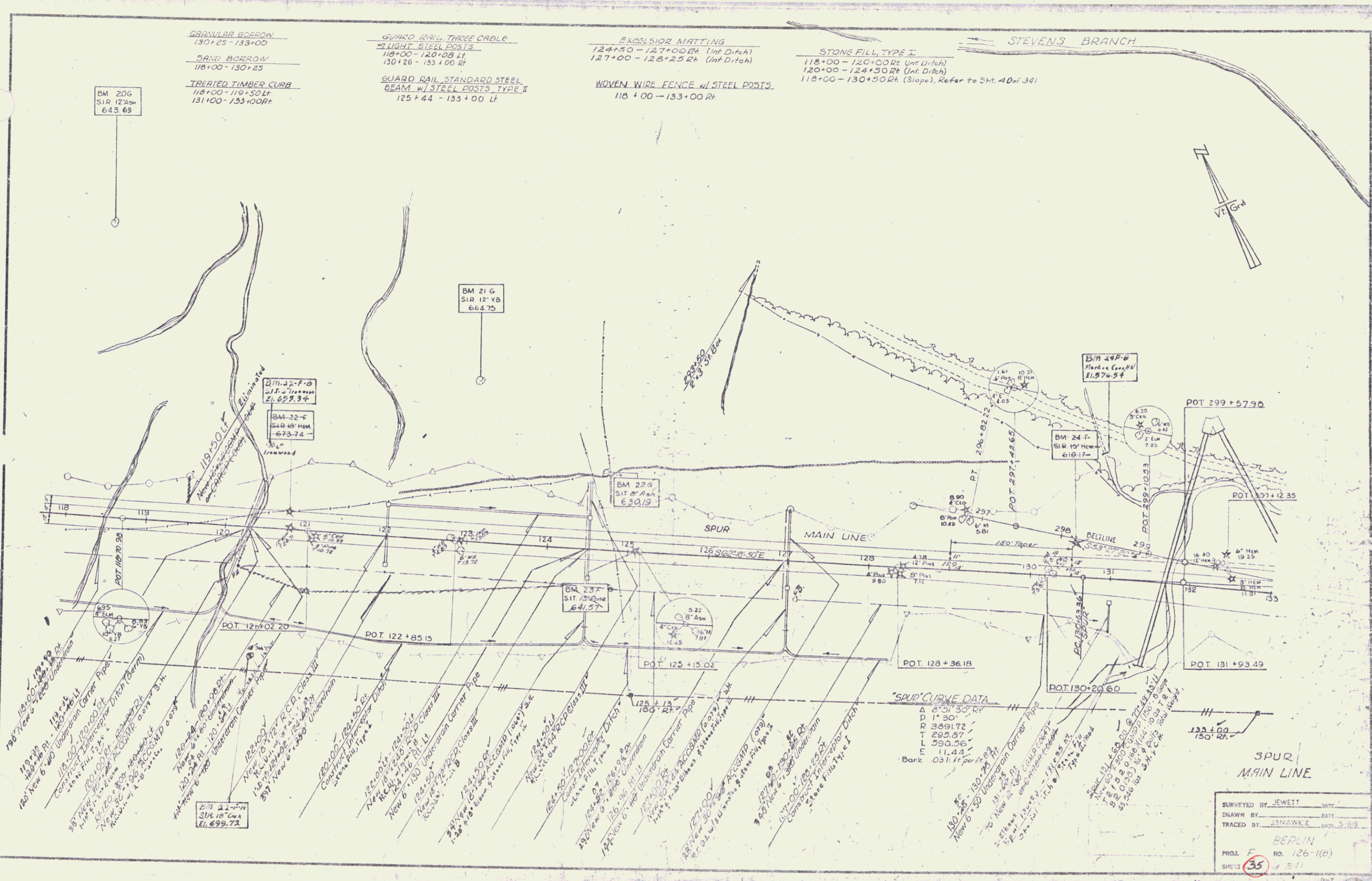

SURVEYED BY JEWETT
DRAWN BY JANAWCZ
TRACED BY JANAWCZ
BERLIN
NO. 126-1(B)
SHEET 35 of 311