

STATE OF VERMONT  
DEPARTMENT OF HIGHWAYS  
**PROPOSED IMPROVEMENT**

FEDERAL PROJECT  
F 126-1(8)  
**TOWN OF BERLIN**  
COUNTY OF WASHINGTON  
INTERSTATE 89 - BARRE-MONTPELIER-EXPRESSWAY ROAD  
BEGINNING AT A POINT ON THE BERLIN STATE HIGHWAY 0.229 MILE NORTHERLY  
OF THE JUNCTION OF S.A. HIGHWAY #5 AND EXTENDING SOUTHEASTERLY

LENGTH OF R.O.W. 10,451 FEET 1.99 MILES  
LENGTH OF PROJECT 6744.43 FEET 1.277 MILES  
ADT 1972 - 4125  
ADT 1992 - 8250  
DMV 1972 - 550  
DMV 1992 - 795  
D - 5%  
T - 8%  
V - 50

*Route: VT 62  
Project: F126-1(8)  
Pin: 00R399  
Date: 02/10/1971*

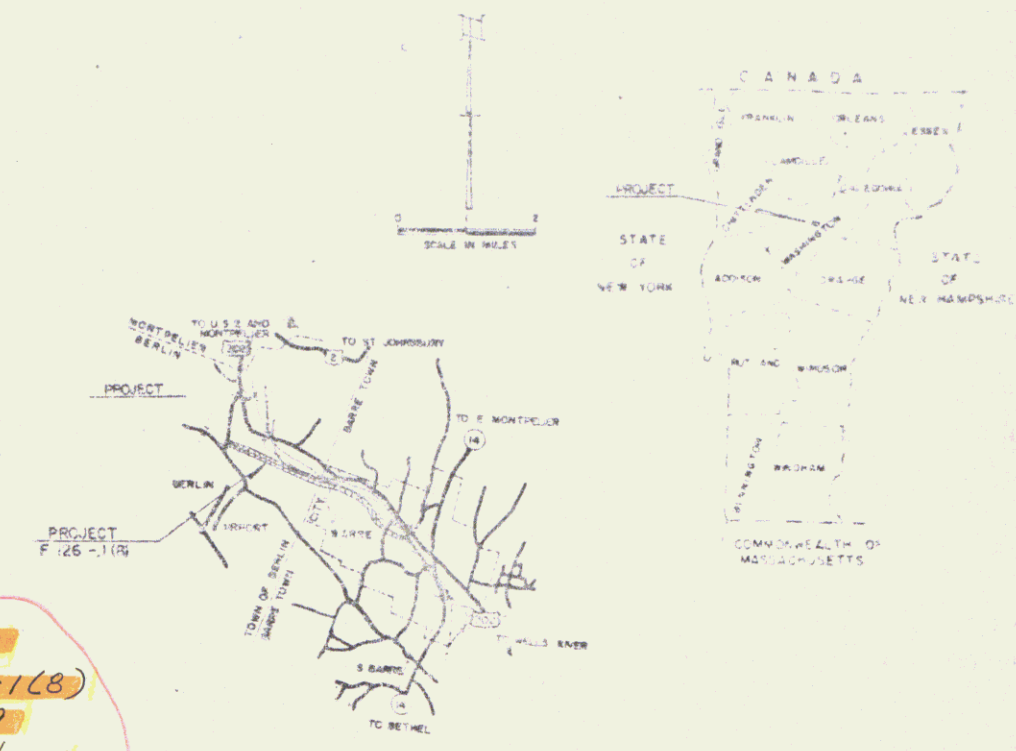

R.O.W. PLANS

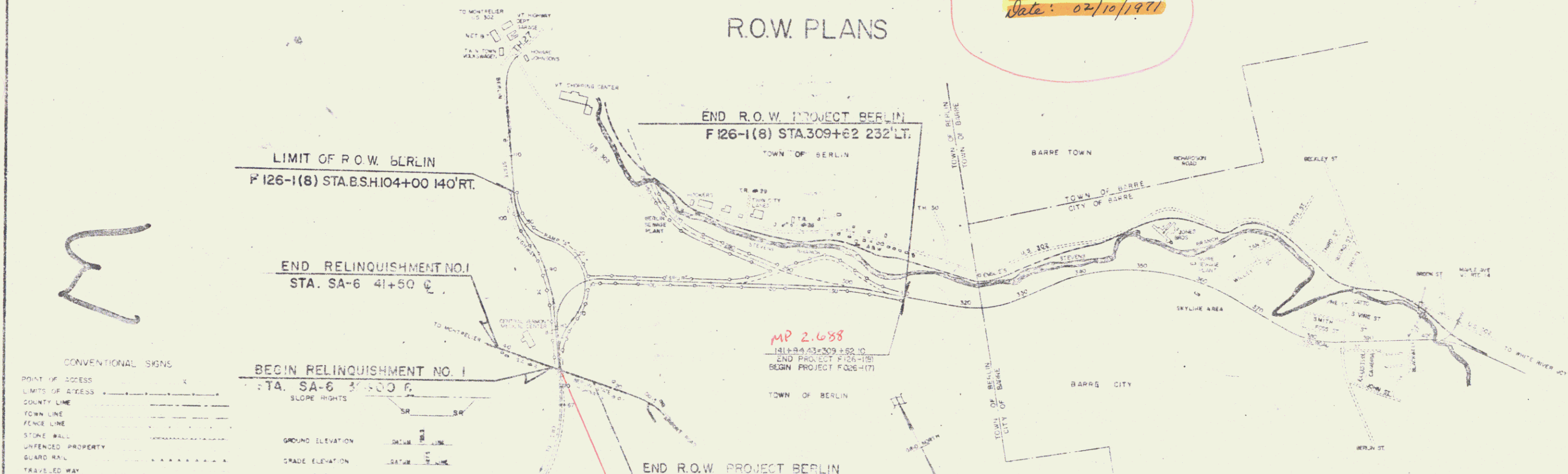

CONVENTIONAL SIGNS

POINT OF ACCESS	---
LIMITS OF ACCESS	---
COUNTY LINE	---
TOWN LINE	---
FENCE LINE	---
STONE WALL	---
UNFENCED PROPERTY	---
GUARD RAIL	---
TRAVELLED WAY	---
RAILROAD	---
RETAINING WALL	---
CENTER LINE	---
SURVEY LINE	---
CULVERT	---
DROP INLET	---
TROLLEY HOLE	---
POWER POLE	---
TELEPHONE POLE	---
TREE	---
MEDE	---

GROUND ELEVATION	SCALE 1" = 10' LINE
GRADE ELEVATION	SCALE 1" = 10' LINE
CURVE DATA	
DEFLECTION OF ANGLE	A
DEGREE OF CURVE	D
RADIUS OF CURVE	R
TANGENT DISTANCE	T
LENGTH OF CURVE	L
EXTERNAL DISTANCE	E
POINT OF INTERSECTION	PI
POINT OF CURVE	PC
POINT OF TANGENT	PT
POINT ON TANGENT	POT
POINT ON SUB-TANGENT	PST

THESE RIGHT-OF-WAY PLANS ARE SUBJECT TO SUCH ENGINEERING CHANGES AS MAY BE REQUIRED BY THE FEDERAL HIGHWAY ADMINISTRATION OR THE CHIEF ENGINEER.

APPROVED	APPROVED	APPROVED	APPROVED
DATE	DATE	DATE	DATE

DEPARTMENT OF TRANSPORTATION  
FEDERAL HIGHWAY ADMINISTRATION

APPROVED \_\_\_\_\_ DATE \_\_\_\_\_

PROJECT F 126-1(8)

SHEET 1 OF 37

STATE OF VERMONT  
DEPARTMENT OF HIGHWAYS  
RIGHT-OF-WAY PLANS  
ALPHABETICAL INDEX

GRANTOR	SHEET NO.	PARCEL NO.
<b>A</b>		
ANDREWS, JAMES D.	16,	17
ANDREWS, JAMES D.	17,23 24	20
ANDREWS, JAMES D.	17,21,22	12
ANDREWS, JAMES D. & PHYLLIS	7,21,22	12
<b>B</b>		
BARIL, NORMAN P.	16,18	2
BARIL, PAUL H.	18	7
BARIL, RAYMOND P.		
BERLIN, TOWN OF		
<b>C</b>		
CENTRAL VERMONT MEDICAL CENTER INC.	16,18 19	3
CENTRAL VERMONT PROFESSIONAL BUILDING INC.	16,17	25
CESARI, GENE S.	17,23 24	20
CESARI, GENE & MARY A.	17,21,22	12
CIAMPI, OSVALDO	22,23	19
<b>D</b>		
DENTE, NELSON	16	5
<b>E</b>		

GRANTOR	SHEET NO.	PARCEL NO.
<b>F</b>		
FLUET, SIMONE L.	24	21
<b>G</b>		
GREEN MOUNTAIN POWER CORP.	18	6&27
<b>H</b>		
<b>I</b>		
<b>J</b>		

GRANTOR	SHEET NO.	PARCEL NO.
<b>K</b>		
KING, ELIZA, AKA KING, ELIZABETH, ESTATE	23-24	23
LOATI, DELINA B., EXECUTRIX		
<b>L</b>		
LAGUE, HENRY	16-18	1
LAGUE INC.	19	9
LAVIN, LOUIS	16	17
LEVINSKY, BRUCE J. & LYNN H/W	21,23	11
LUCCHINA, EUGENIA A. & MILDRED H/W	23,24	23
LYONS, DANIEL C.	16	4
<b>M</b>		
MARTINEAU, EUGENE J. & JULIA G. H/W	24	22
MONTPELIER & BARRE RAILROAD CO.	23,24	18
<b>N</b>		
<b>O</b>		
<b>P</b>		

GRANTOR	SHEET NO.	PARCEL NO.
<b>Q</b>		
<b>R</b>		
<b>S</b>		
SALDI, ALFRED	16	5
SALDI, FERNANDO	16	5
SALDI, ROBERT	16	5
SHADROU, PAUL	17,21,22	12
<b>T</b>		
THE LEDGES OF BURLINGTON VT. INC.	17,18 19,20 21	10&15
<b>U</b>		
UNSWORTH, RAYMOND R.	17,18,19 20	8&15
<b>V</b>		
VERMONT ELECTRIC POWER CO. INC.		28

GRANTOR	SHEET NO.	PARCEL NO.
<b>W</b>		
WARK BROTHERS INC.	16	17
WARK, ROY JR.	16	5
<b>X</b>		
<b>Y</b>		
YOUNG & EMSLIE WATER CO.	21	24&30
<b>Z</b>		

MADE BY J.P.R. DATE 1-26-71  
CHECKED BY R.L.B. DATE 1-26-71

PROJECT BERLIN  
NO. F 126-1(B)  
SHEET 8 OF 37

STATE OF VERMONT  
DEPARTMENT OF HIGHWAYS  
RIGHT-OF-WAY PLANS  
DETAIL SHEET  
A OF G

TABLE OF PROJECT PROPERTY ACQUISITION

PARCEL NO.	GRANTOR	SHEET NO.	BEGINNING STATION	ENDING STATION	TAKING	REM.	RIGHTS	TITLE TAKEN	DATE	TOWN OR CITY RECORDED	BK.	PG.	REMARKS		
1A	LAGUE, HENRY	16	AIRPORT RD. 25+60 RT.	AIRPORT RD. 28+52 RT.	0.4 A±			COND.	9-18-72	BERLIN	40	268	(0.12 A±) HIGHWAY EASEMENT (AIRPORT RD.)		
			27+50 RT. 26+00 RT. 27+50 RT.	28+52 RT.		4.1A±	DRIVE (T)								
B		18	BSH 74+38 RT.	RAMP "A" 11+73 RT.	4.4A±								SPRING (0.4A±) HIGH EASE. (BSH) (18 INCLUDES AREA OF 7-B)		
			RAMP "A" 4+10 RT.											HOUSE (1 1/2 SWF)	
			RAMP "A" 4+50 RT.												BARN
			RAMP "A" 4+20 RT.	RAMP "A" 4+75 RT.					EASE TO REMOVE BLDG. (T) 3025 S.F.±						
			RAMP "A" 9+50 RT. SPUR 81+96 RT.	RAMP "A" 12+04 RT. RAMP "A" 9+47 RT.				0.8 A±							LOSS OF ACCESS
2A	BARIL, NORMAN P BARIL, PAUL H. BARIL, RAYMOND E.	16	BSH 73+74 RT.	AIRPORT RD. 27+63 RT.				COND.	9-18-72	BERLIN	40	268	SEWER LINE OWNED JOINTLY BY LAGUE & LAVINSKY		
			AIRPORT RD. 26+50 RT.	AIRPORT RD. 28+52 RT.			ALL RT.&L							RIGHT-OF-WAY LIMITED ACCESS	
B		18	RAMP "A" 8+78 RT.	RAMP "A" 8+99 RT.	105 S.F.±								RIGHT-OF-WAY AIRPORT RD. & B.S.H. NON-LIMITED ACCESS		
			AIRPORT RD. 27+65 RT.	RAMP "A" 10+79 RT.	6.0A±										
3A	CENTRAL VERMONT MEDICAL CENTER, INC.	16	SA-6 39+00 RT.	SA-6 41+50 RT.	0.31A±			COND.	9-18-72	BERLIN	40	268	0.14 A± HIGHWAY EASEMENT (SA-6)		
			35+08 RT.	36+50 RT.			SLOPE 2100 SF± (T)							SIGN	
			35+60 RT.												LIGHT POST
			35+62 RT.												
			35+76 RT.					DRIVE (T)							
			37+50 RT.	39+65 RT.				SLOPE 0.12A± (T)							
			37+78 RT.					DRIVE (T)							
			38+08 RT.												SIGN
38+15 RT.	39+20 RT.					RT. TO CONST. & INSTALL PIPES & DROP INLET (P)									

TABLE OF REVISIONS

REVISION NO.	SHEET NO.	DESCRIPTION OF REVISION	DATE	MADE BY	APPROVED BY
1	8,13	Parcel #15 Deleted "Arthur N. McLeod, Executor" Per C.O. #1873	3/25-71	KMD	T.P.M.
2	10,18	ADDED NEW PARCEL #3F PER C.O. #1896	4-8-71	NBB	T.P.M.
3	8,9,16,18,1A	TITLE CHANGE OF PARCEL #1 PER C.O. #1957	5-26-71	WEB	T.P.M.
4	10,16,8,10,1E	DELETED Parcel #5 AND REVISED Slope Rights On Parcel #4 From 655 S.F.± To 344 S.F.± Per C.O. #1987	6-23-71	XMD	T.P.M.
5	9,16,10,1E	Parcel #1 CHANGE IN PROPERTY LINE. REDUCED TAKE TO 0.4 A± PER CHANGE ORDER #2036	8-9-71	XMD	T.P.M.
6	9,12	Parcel #1 & 11 New sewer line built by LAGUE & LAVINSKY. Per Change order #206B.	9-7-71	M.T.A.	T.P.M.
7	9,17,18,1A	Parcel #1 Delete Parcel #1C taken under PPM 80-1, par 7A(2). Per Change Order #2086.	10-7-71	M.T.A.	T.P.M.
8	17,21	Miscellaneous changes on plans Per Change Order #2097	11-2-71	RE	T.P.M.
9	16,18	INCREASED TAKE OF SEWER LINE BETWEEN STATION SA#6 32+00 LT. & B.S.H. 75+28 LT. Per C.O. #2166	1-13-72	WEB	RGG
10	9	Parcel #3A CORRECTED HWY EASEMENT FROM 0.55 A± TO 0.4 A± PER C.O. #2228	3-2-72	KMD	T.P.M.
11	9	Parcel #3A Revised Drop Inlet Pipe Stations And Marked Them (P) Per C.O. #2230	3-2-72	KMD	T.P.M.
12	9,8,1	Parcel #2A & B. Change in ownership. Per change order #2257.	3-30-72	M.T.A.	T.P.M.
13	8,12,1A	Parcel #12 Change of Owner-Ship From Green Mt. Estates Inc. To Andrews et al 18-C.O. #2270	4-13-72	KMD	T.P.M.
14	19	Parcel #9 Added Drive At Sta. 10+65 Rt. Also Added On Revised Ditch And Const Limits Per C.O. #2283	4-26-72	KMD	T.P.M.
15	9,16	Parcel #2A Revised Width of R.O.W. Per C.O. #2292	4-27-72	HD	T.P.M.

MADE BY: KMD DATE: 1-21-71  
CHECKED BY: KMD DATE: 1-21-71

PRESENT R.O.W.  
---#---#--- TAKING WITHOUT ACCESS  
---P---#--- TAKING WITHOUT ACCESS ALONG PROPERTY LINES  
---#---#--- TAKING WITH ACCESS  
(P) PERMANENT EASEMENT  
(T) TEMPORARY EASEMENT

LEGEND  
---SR---SR--- SLOPE RIGHTS  
---P---P--- PROPERTY LINE  
---A---A--- TOP OF CUR  
---O---O--- TOP OF SLOPE

APPROVED: T.P.M. DATE: 2-11-71  
CHIEF OF PLANS & TITLES  
APPROVED: RE DATE: 2  
APPROVED: HD DATE: 2-11-71

PROJECT: BERLIN  
NO. F126-1(8)  
SHEET 9 OF 37  
20 OF 341

STATE OF VERMONT  
DEPARTMENT OF HIGHWAYS  
RIGHT-OF-WAY PLANS  
DETAIL SHEET  
B OF G

TABLE OF PROJECT PROPERTY ACQUISITION

PARCEL NO.	GRANTOR	SHEET NO.	BEGINNING STATION	ENDING STATION	TAKING	REM.	RIGHTS	TITLE TAKEN	DATE	TOWN OR CITY RECORDED	BK.	PG.	REMARKS	
3B	CENTRAL VERMONT MEDICAL CENTER INC.	16	SA-6	SA-6										
			32+00 RT.	34+00 RT.	0.14A±		DRIVE (T)							
C		16, 18	SA-6	B.S.H.										
			32+00 RT.	83+49 LT.	2.1A±									
			B.S.H.	B.S.H.										
			75+40 LT.	76+90 LT.										
D		18, 19	B.S.H.	B.S.H.										
			80+88 LT.	82+40 LT.										
E		19	B.S.H.	B.S.H.										
			76+60 L.	82+40 LT.										
F		18	B.S.H.	B.S.H.										
			80+95 LT.	82+40 LT.										
4	LYONS, DANIEL C.	16	SA-6	B.S.H.										
			41+50 RT.	100+51 LT.	0.5A±	62.5A±								
5	DELETED		B.S.H.	B.S.H.										
			86+75 LT.	96+50 LT.	1.2A±									
			37+33 LT.	38+41 LT.	0.35A±	260A±								
6	GREEN MOUNTAIN POWER CORP.	18	B.S.H.	B.S.H.										
			86+80 LT.	87+85 LT.	0.16A±									
6		18	B.S.H.	B.S.H.										
			83+20 LT.	86+79 LT.	0.5A±									
			83+20 LT.	86+75 LT.	1.2A±									
6		18	B.S.H.	B.S.H.										
			86+50 LT.											

TABLE OF REVISIONS

REVISION NO.	SHEET NO.	DESCRIPTION OF REVISION	DATE	MADE BY	APPROVED BY
16	8, 15	Parcel #23 Change in Title Per Change Order #2300	5/4/72	KMD	T.P.M.
17	11	Parcel #3 Revised Take And Remainder Areas Per Change Order #2308	5/8/72	KMD	T.P.M.
18	8, 10	Parcel #4 Deleted SUZANNI From Title Per C.O. #2309	5/8/72	KMD	T.P.M.
19	8, 12	Parcel #12 Change Title To Include All Owners Per Change Order #2355	6-27-72	DLB	T.P.M.
20	14	Parcel #19 Rev. Beg. Sta. For All R.T.&I. To R.O.W. From 266+04 Lt. To 283+65 Lt. Per Change Order #2387	7-27-72	KMD	T.P.M.
21	14	Parcel #20 Rev. Beg. Sta. For All R.T.&I. To R.O.W. From 266+04 Lt. To 283+65 Lt. Per Change Order #2384	7-27-72	KMD	T.P.M.
22	14	Parcel #21 Rev. Beg. Sta. For All R.T.&I. To R.O.W. From 266+04 Lt. To 283+65 Lt. Per Change Order #2385	7-27-72	KMD	T.P.M.
23	14	Parcel #22A Rev. Beg. Sta. For All R.T.&I. To R.O.W. From 266+04 To 283+65 Lt. Per Change Order #2386	7-27-72	KMD	T.P.M.
24	8, 14	Parcel #19 Change In Title From DOOGIE TO DATE CIAMPI Per C.O. #2431	8-24-72	KMD	T.P.M.
25	15, 16	Parcel #25 Deleted All R.T.&I. To Sewer Line Sta. 6 39+00 - 41+50 Rt. Per C.O. #2438	8-30-72	KMD	T.P.M.
26	8, 15	Parcel #29 Tows Of Berlin Water Pollution Control Deleted Per Change Order #2459	9-22-72	DLB	T.P.M.
27	8, 15	Parcel #26 N.E.T. & T. Co. Deleted Per Change Order #2460	9-22-72	DLB	T.P.M.
28	9, 16	Parcel #2 Baril, Relocate Winter ROW, And Revise Detail Sheet Accordingly Per Change Order #2471	10-6-72	DLB	T.C.C.

MADE BY: FRP DATE: 1-18-71  
CHECKED BY: KMD DATE: 7-22-71

PRESENT R.O.W.  
 --- TAKING WITHOUT ACCESS  
 --- TAKING WITHOUT ACCESS ALONG PROPERTY LINES  
 --- TAKING WITH ACCESS  
 (P) PERMANENT EASEMENT  
 (T) TEMPORARY EASEMENT

LEGEND  
 SR SR SLOPE RIGHTS  
 P L PROPERTY LINE  
 Δ Δ TOP OF CUT  
 O O TOE OF SLOPE

APPROVED: T.P. Mays DATE: 2-11-71  
 CHIEF OF PEANS ATTILES  
 APPROVED: \_\_\_\_\_ DATE: \_\_\_\_\_  
 APPROVED: DLB DATE: 2-11-71  
 R.O.W. DIRECTOR

PROJECT: BERLIN  
 NO. F126-1(8)  
 SHEET: 10 OF 37  
21

STATE OF VERMONT  
DEPARTMENT OF HIGHWAYS  
RIGHT-OF-WAY PLANS  
DETAIL SHEET  
C OF G

TABLE OF PROJECT PROPERTY ACQUISITION

PARCEL NO.	GRANTOR	SHEET NO.	BEGINNING STATION	ENDING STATION	TAKING	REM.	RIGHTS	TITLE TAKEN	DATE	TOWN OR CITY RECORDED	BK.	FG.	REMARKS
7A	TOWN OF BERLIN	18	B.S.H. 82+07 RT.	B.S.H. 83+74 LT.	0.16A±			COND.	9-18-72	BERLIN	40	268	2750 SF± HIGHWAY EASEMENT B.S.H.
B		18	B.S.H. 81+45 RT.	B.S.H. 82+16 RT.			ALL RT & I SEWER LINE						
C		18	B.S.H. 82+12 RT. SPUR 91+50 LT.	SPUR 92+22 RT. SPUR 92+22 LT.	1.6A±  1.3A±								
D	DELETED												PARCEL 7D NOW PARCEL 3B OF U026-11 )
E	DELETED												PARCEL 7E NOW PARCEL 3B OF U026-11 )
8A	UNSWORTH, RAYMOND R.	18	B.S.H. 82+07 RT.	B.S.H. 82+53 RT.	550S.F.±			COND.	9-18-72	BERLIN	40	268	550S.F.± HIGHWAY EASE.
B		18,19	B.S.H. 82+12 RT. RAMP "A" 20+51 RT. 17+25 RT. 20+00 RT.	SPUR 91+50 LT. 91+50 LT.	8.0A±  3.5A±		DRAINAGE (P) DRAINAGE (P)						0.26A± HIGHWAY EASE.
C		18,20	B.S.H. 82+16 RT.	SPUR 93+38 RT.	8.7A±								
D		17,18,20	RAMP "A" 11+73 RT.	SPUR 93+84 RT.	1.5A±								(PPM 80-1-742)
9	LAGUE, INCORPORATED	19	B.S.H. 100+44 LT.	B.S.H. 104+00 LT.	0.8A±			COND.	9-18-72	BERLIN	40	268	0.28A± HIGHWAY EASE. SEE SU0203(1) FOR REM.

TABLE OF REVISIONS

REVISION NO.	SHEET NO.	DESCRIPTION OF REVISION	DATE	MADE BY	APPROVED BY
29	16	Parcel #1 Revised Portion of House On Plans. Per CO#2511	11/9/72	L.S.	J.R.V.
30	16 9	Parcel #2A Corrected Boril winter R.O.W. Per Change Order #2529	12-14-72	CB	T.P.M.
31	12, 19	Parcel #10 Add Drive At Sta. 33+78 R.I. P.P.A. Reuse Culverts. (Providing Access To Remainder) Per Change Order #2612	4-13-73	CB	T.P.M.
32	115, 16	Added Relinquishment No. 1 To The Plans Per CO #2846	10-20-74	SEP	T.P.M.
33	9,11,16	Added Sewer Line Access Per Change Order #3334	4/5/77	A.C.S.	T.P.M.

MADE BY: ST DATE: 1-26-71  
CHECKED BY: SLB DATE: 1-26-71  
Revised 4-23-71 RGG

PRESENT R.O.W.  
--- TAKING WITHOUT ACCESS  
--- P --- TAKING WITHOUT ACCESS ALONG PROPERTY LINES  
--- TAKING WITH ACCESS  
(P) PERMANENT EASEMENT  
(T) TEMPORARY EASEMENT

LEGEND  
--- SR --- SR --- SLOPE RIGHTS  
--- P --- P --- PROPERTY LINE  
--- Δ --- Δ --- TOP OF CUT  
--- ○ --- ○ --- TOP OF SLOPE

APPROVED: [Signature] DATE: 2-2-71  
CHIEF OF MEASUREMENTS  
APPROVED: \_\_\_\_\_ DATE: \_\_\_\_\_  
APPROVED: [Signature] DATE: 2-11-71  
R.O.W. SHEET OR

PROJECT BERLIN  
NO. F 125-1 (8)  
SHEET 11 OF 37

STATE OF VERMONT  
DEPARTMENT OF HIGHWAYS  
RIGHT-OF-WAY PLANS  
DETAIL SHEET  
D OF G

TABLE OF PROJECT PROPERTY ACQUISITION

PARCEL NO.	GRANTOR	SHEET NO.	BEGINNING STATION	ENDING STATION	TAKING	REM.	RIGHTS	TITLE TAKEN	DATE	TOWN OR CITY RECORDED	BK.	PG.	REMARKS
10A	LEDGES OF BURLINGTON, VT., INC.	17-19	RAMP A 20+61 RT 20+00 RT 22+00 RT 24+00 RT 20+61 RT.	B.S.H. 104+00 RT.	10.0 A±		DRAINAGE (P) DRAINAGE (P) DRAINAGE (P)	COND.	9-18-72	BERLIN	40	268	0.70A± HIGHWAY EASEMENT  LOSS OF ACCESS NOTE: FOR REM. OF L.O.A. SEE SU0203 (1) SECTION II
B		18,20,21	SPUR 92+93 LT. 94+00 LT. 98+50 LT. 105+50 LT. 106+55 LT. 108+50 LT. 93+11 LT.	SPUR 112+90 RT.	12.3 A±		DRAINAGE (P) DRAINAGE (P) DRAINAGE (P) DRAINAGE (P) DRAINAGE (P)						
C		20,21	SPUR 93+38 RT.	SPUR 107+93 RT.	4.5 A±								(PPMBO-1-7A2)
11	LEVINSKY, BRUCE J. & LYNN H/W	21,23	SPUR 107+93 RT. RAMP A 12+04 RT.	SPUR 125+13 RT.	5.4 A±			COND.	9-18-72	BERLIN	40	268	
		18	SPUR 81+96 RT.	RAMP "A" 10+08 RT.	120.8 A±		ALL RT. & I.						SEWER LINE OWNED JOINTLY BY LAGUE & LAVINSKY
12 A	ANDREWS, JAMES D. ANDREWS, JAMES D. & PHYLLIS CESARI, GENE & MARY A. SHADROU, PAUL	21,22	SPUR 109+57 LT. SPL 283+68 LT.	SPUR 124+72 LT. SPL 309+62 LT.	12.0 A±	NONE	ALL RT. & I.	COND.	9-18-72	BERLIN	40	268	8.0A± NOW PARCEL 7A OF U026-1(1) SEC. II RIGHT-OF-WAY
B		17	SPL 285+20 LT.	SPL 303+45 LT.			ALL RT. & I.						RIGHT-OF-WAY FROM RTE. 302 UNSPECIFIED
C	DELETED												PARCEL 12C NOW PARCEL 7A OF U026-1(1) SEC. II
D	DELETED												PARCEL 12D NOW PARCEL 7C OF U026-1(1) SEC. II

TABLE OF REVISIONS

REVISION NO.	SHEET NO.	DESCRIPTION OF REVISION	DATE	MADE BY	APPROVED BY

MADE BY: KMD DATE: 1-25-71  
CHECKED BY: *gjm* DATE: 1-25-71  
Revised 4-23-71 RGG.

PRESENT R.O.W.  
---/--- TAKING WITHOUT ACCESS  
---/--- TAKING WITHOUT ACCESS ALONG PROPERTY LINES  
---/--- TAKING WITH ACCESS  
(P) PERMANENT EASEMENT  
(T) TEMPORARY EASEMENT

LEGEND

SR SR SLOPE RIGHTS  
P L PROPERTY LINE  
---Δ--- TOP OF CUT  
---O--- TOE OF SLOPE

APPROVED: *J.P. Basso* DATE: 2-11-71  
CHIEF OF PLANS & TITLES  
APPROVED: \_\_\_\_\_ DATE: \_\_\_\_\_  
APPROVED: *A.R. Johnson* DATE: 2-11-71  
S.C. DIRECTOR

PROJECT BERLIN  
NO. F.126-1(18)  
SHEET 12 OF 37  
23 OF 34

6

STATE OF VERMONT  
DEPARTMENT OF HIGHWAYS  
RIGHT-OF-WAY PLANS  
DETAIL SHEET  
EOFG

TABLE OF PROJECT PROPERTY ACQUISITION

PARCEL NO.	GRANTOR	SHEET NO.	BEGINNING STATION	ENDING STATION	TAKING	REM.	RIGHTS	TITLE TAKEN	DATE	TOWN OR CITY RECORDED	BK.	PG.	REMARKS
13 A	DELETED												PARCEL 13A NOW PARCEL 2B OF U026-1(1) SEC. II
B													PARCEL 13B NOW PARCEL 2A OF U026-1(1) SEC. II
14	DELETED												PARCEL 14 NOW PARCEL 1 OF U026-1(1) SEC. II
15	DELETED												PARCEL 15 NOW PARCEL 6 OF U026-1(1) SEC. II
16	DELETED												NOT APPLICABLE TO ANY OTHER PROJECT
17 A	DELETED												PARCEL 17A NOW PARCEL 5A OF U026-1(1) SEC. II
B													PARCEL 17B NOW PARCEL 5B OF U026-1(1) SEC. II
C													PARCEL 17C NOW PARCEL 5C OF U026-1(1) SEC. II

TABLE OF REVISIONS

REVISION NO.	SHEET NO.	DESCRIPTION OF REVISION	DATE	MADE BY	APPROVED BY

MADE BY: XMO DATE 4-23-71  
 CHECKED BY: ESG DATE 4-23-71  
 Replaces original sheet 13

PRESENT R.O.W.  
 // // TAKING WITHOUT ACCESS  
 // P // TAKING WITHOUT ACCESS ALONG PROPERTY LINES  
 // L // TAKING WITH ACCESS  
 (P) PERMANENT EASEMENT  
 (T) TEMPORARY EASEMENT

LEGEND  
 SR SR SLOPE RIGHTS  
 P L PROPERTY LINE  
 Δ Δ Δ TOP OF CUT  
 O O O TOE OF SLOPE

APPROVED: Howard P. Davis DATE 4-22-71  
 CHIEF OF PLANS & TITLES  
 APPROVED: \_\_\_\_\_ DATE \_\_\_\_\_  
 APPROVED: J.R. Seale DATE 4-23-71  
 R.O.W. DIRECTOR

PROJECT BERLIN  
 NO. F126-1(8)  
 SHEET 13 OF 37  
24 341

STATE OF VERMONT  
DEPARTMENT OF HIGHWAYS  
RIGHT-OF-WAY PLANS  
DETAIL SHEET  
F OF G

TABLE OF PROJECT PROPERTY ACQUISITION

PARCEL NO.	GRANTOR	SHEET NO.	BEGINNING STATION	ENDING STATION	TAKING	REM.	RIGHTS	TITLE TAKEN	DATE	TOWN OR CITY RECORDED	BK.	PG.	REMARKS
18	MONTPELIER & BARRE RAILROAD CO.	22,23	SPL 283+65 LT.	SPL 309+62 LT.	7.2 A±			COND.	9-18-72	BERLIN	40	268	REM. NOT COMPUTED PART OF PARCEL 18 NOW PARCEL 4 OF U026-1(1) SEC. II
19	CIAMPI, OSVALDO		SPL 291+04 LT. SPUR 125+13 RT. SPL 283+65 LT.	SPUR 301+10 RT. SPL 301+10 RT. SPL 309+62 LT.	7.8 A± 25.6 A±		ALL R.T. & I.	COND.	9-18-72	BERLIN	40	268	RIGHT-OF-WAY
20	ANDREWS, JAMES D. CESARI, GENE S.	17,22,23	SPL 285+17 LT. SPUR 302+70 LT. SPL 283+65 LT.	SPUR 303+45 LT. SPL 302+70 LT. SPL 309+62 LT.	10.0 A±	NONE	ALL R.T. & I.	COND.	9-18-72	BERLIN	40	268	SPRING BOX SPRING BOX RIGHT-OF-WAY
21	FLUET, SIMONE L.	17,22,23	SPUR 133+68 LT. SPL 283+65 LT.	SPUR 305+05 LT. SPL 309+62 LT.	0.53 A±	NONE	ALL R.T. & I.	WD	1-4-73	BERLIN	40	425	RIGHT-OF-WAY
22 A	MARTINEAU, EUGENE U. & JULIA G. H/W	17,22,23	SPUR 303+06 LT. SPL 283+65 LT.	SPUR 309+62 LT. SPL 309+62 LT.	0.55 A±	0.55 A±	ALL R.T. & I.	COND.	9-18-72	BERLIN	40	268	RIGHT-OF-WAY
B		23	SPUR 301+10 RT. 301+10 RT.	SPUR 309+62 RT. 309+62 RT.	5.7 A±	16.0 A±							LOSS OF ACCESS, FOR REM. OF L.O.A. SEE F026-1(7)

TABLE OF REVISIONS

REVISION NO.	SHEET NO.	DESCRIPTION OF REVISION	DATE	MADE BY	APPROVED BY

MADE BY: AMD DATE: 1-25-71  
CHECKED BY: ES DATE: 1-26-71  
Revised 4-23-71 RGG

PRESENT R.O.W.  
---  
--- TAKING WITHOUT ACCESS  
--- TAKING WITHOUT ACCESS ALONG PROPERTY LINES  
--- TAKING WITH ACCESS  
(P) PERMANENT EASEMENT  
(T) TEMPORARY EASEMENT

LEGEND

SR SR SLOPE RIGHTS  
P L PROPERTY LINE  
-Δ- Δ- Δ- TOP OF CUT  
-O- O- O- TOP OF SLOPE

APPROVED: T. C. Mayo DATE: 2-11-71  
CHIEF OF PLANS & TITLES  
APPROVED: \_\_\_\_\_ DATE: \_\_\_\_\_  
APPROVED: A. R. Jenkins DATE: 3-11-71  
R.O.W. DIRECTOR

PROJECT BERLIN  
NO. F126-1(8)

SHEET 14 OF 37  
25

STATE OF VERMONT  
DEPARTMENT OF HIGHWAYS  
RIGHT-OF-WAY PLANS  
DETAIL SHEET  
G OF G

TABLE OF PROJECT PROPERTY ACQUISITION

PARCEL NO.	GRANTOR	SHEET NO.	BEGINNING STATION	ENDING STATION	TAKING	REM.	RIGHTS	TITLE TAKEN	DATE	TOWN OR CITY RECORDED	BK.	PG.	REMARKS
23	KING, ELIZA, AKA KING, ELIZABETH ESTATE LOATI, DELINA B., EXECUTRIX LUCCHINA, EVO A. & A. MILDRED H/W	22, 23	SPL 283+65 LT.	SPL 309+62 LT.			ALL R.T. & I.	COND.	9-18-72	BERLIN	40	268	RIGHT-OF-WAY PART OF PARCEL 23 NOW PARCEL 8 OF U026-1( ) SEC. II
24	YOUNG & EMSLIE WATER CO.	21	SPUR 110+55 RT.	SPUR 112+53 LT.			ALL R.T. & I.	WD	12-29-72	BERLIN	40	411	WATER LINE PART OF PARCEL 24 NOW PARCEL 9 OF U026-1( ) SEC. II
25	CENTRAL VERMONT PROFESSIONAL BUILDING INC.	16, 18	SA-6 32+00 LT.	BSH 82+40 LT.			ALL R.T. & I. TO SEWER LINE	COND.	9-18-72	BERLIN	40	268	
27	GREEN MOUNTAIN POWER CORP.							COND.	9-18-72	BERLIN	40	268	UTILITY
28	VERMONT ELECTRIC POWER CO., INC.							COND.	9-18-72	BERLIN	40	268	UTILITY
30	YOUNG & EMSLIE WATER CO.  RELINQUISHMENT NO. 1	16	SA-6 32+00 @	SA-6 41+50 @				COND.	9-18-72	BERLIN	40	268	UTILITY  SA-6

TABLE OF REVISIONS

REVISION NO.	SHEET NO.	DESCRIPTION OF REVISION	DATE	MADE BY	APPROVED BY

MADE BY: KMD DATE: 1-26-71  
CHECKED BY: BS DATE: 1/28-71  
Revised 4-23-71 RGG

PRESENT R.O.W.  
---/--- TAKING WITHOUT ACCESS  
---/--- P ---/--- TAKING WITHOUT ACCESS ALONG PROPERTY LINES  
---/--- TAKING WITH ACCESS  
(P) PERMANENT EASEMENT  
(T) TEMPORARY EASEMENT

LEGEND  
--- SR --- SR --- SLOPE RIGHTS  
--- P --- P --- PROPERTY LINE  
--- Δ --- Δ --- TOP OF CUT  
--- O --- O --- TOP OF SLOPE

APPROVED: J.P. M... DATE: 2-11-71  
CHIEF OF PLANS & TITLES  
APPROVED: \_\_\_\_\_ DATE: \_\_\_\_\_  
APPROVED: A.P. Berlin DATE: 2-11-71

PROJECT BERLIN  
NO. F126-1-(8)  
SHEET 15 OF 37  
26-27 341

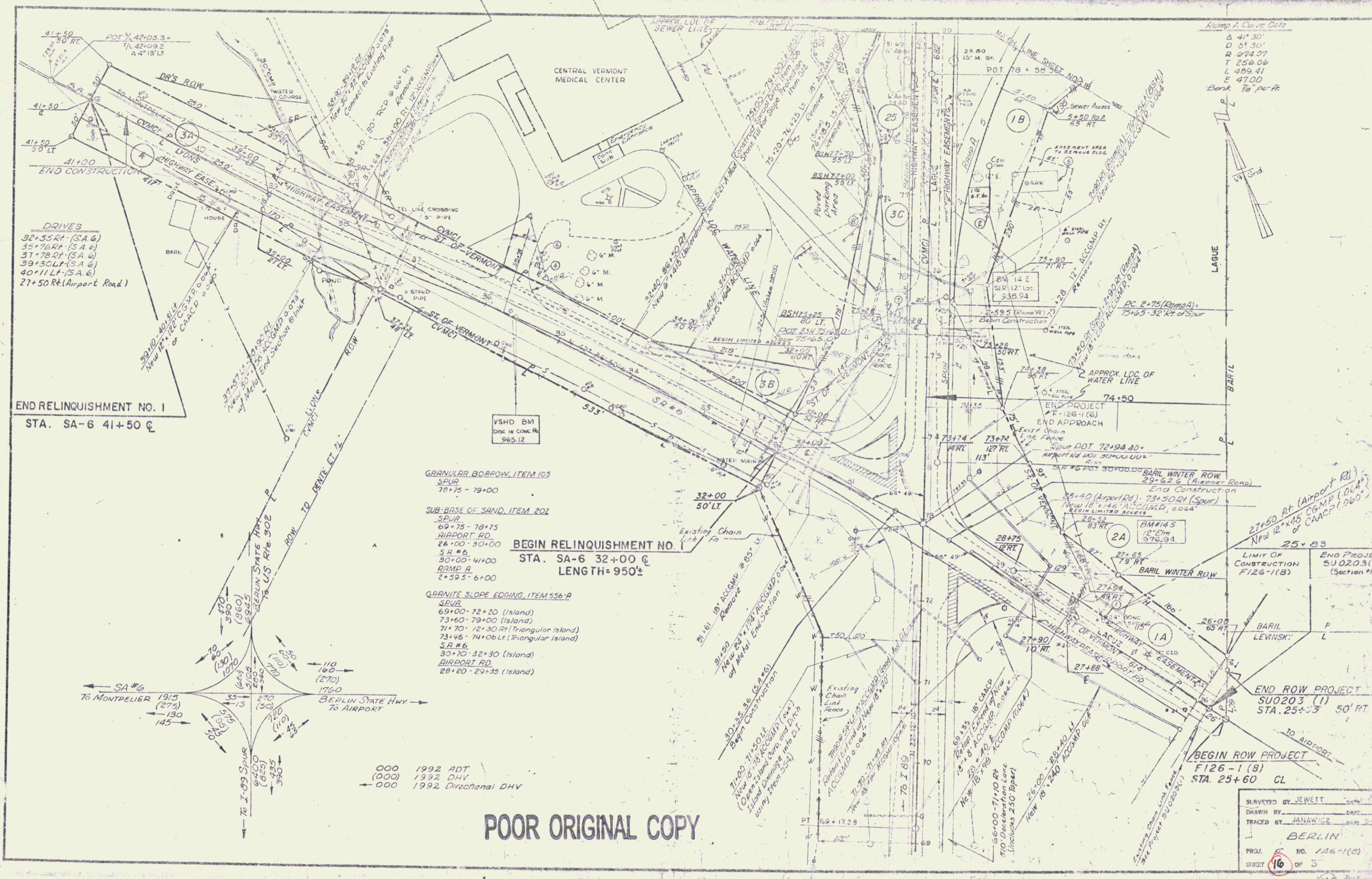

- DRIVES**
- 32+55 RT (S.A. 6)
  - 35+76 RT (S.A. 6)
  - 37+78 RT (S.A. 6)
  - 39+30 LT (S.A. 6)
  - 40+11 LT (S.A. 6)
  - 27+50 RT (Airport Road)

END RELINQUISHMENT NO. 1  
STA. SA-6 41+50 CL

- GRANULAR BORROW, ITEM 105**  
SPUR  
78+75 - 79+00
- SUB-BASE OF SAND, ITEM 202**  
SPUR  
69+75 - 78+75  
AIRPORT RD  
26+00 - 30+00  
S.A. #6  
30+00 - 41+00  
RAMP A  
2+59.5 - 6+00

BEGIN RELINQUISHMENT NO.  
STA. SA-6 32+00 CL  
LENGTH = 950'

- GRANITE SLOPE EDGING, ITEM 536-A**  
SEVER  
69+00 - 72+20 (Island)  
73+60 - 79+00 (Island)  
71+70 - 72+30 Rt. (Triangular Island)  
73+46 - 74+06 Lt. (Triangular Island)  
S.A. #6  
30+70 - 32+30 (Island)  
AIRPORT RD  
28+20 - 29+35 (Island)

- 000 1992 ADT
- (000) 1992 DHV
- 000 1992 Directional DHV

POOR ORIGINAL COPY

**Curve Data**

- Δ 41° 30'
- D 51.50'
- R 674.07'
- T 256.06'
- L 489.41'
- E 47.00'
- Bank 7/8' per ft.

SURVEYED BY	JEWETT	DATE	
DRAWN BY	JANAWICZ	DATE	2-5-92
TRACED BY	BERLIN	DATE	
PROJ. NO.	126-1(2)	SHEET	10 OF 3

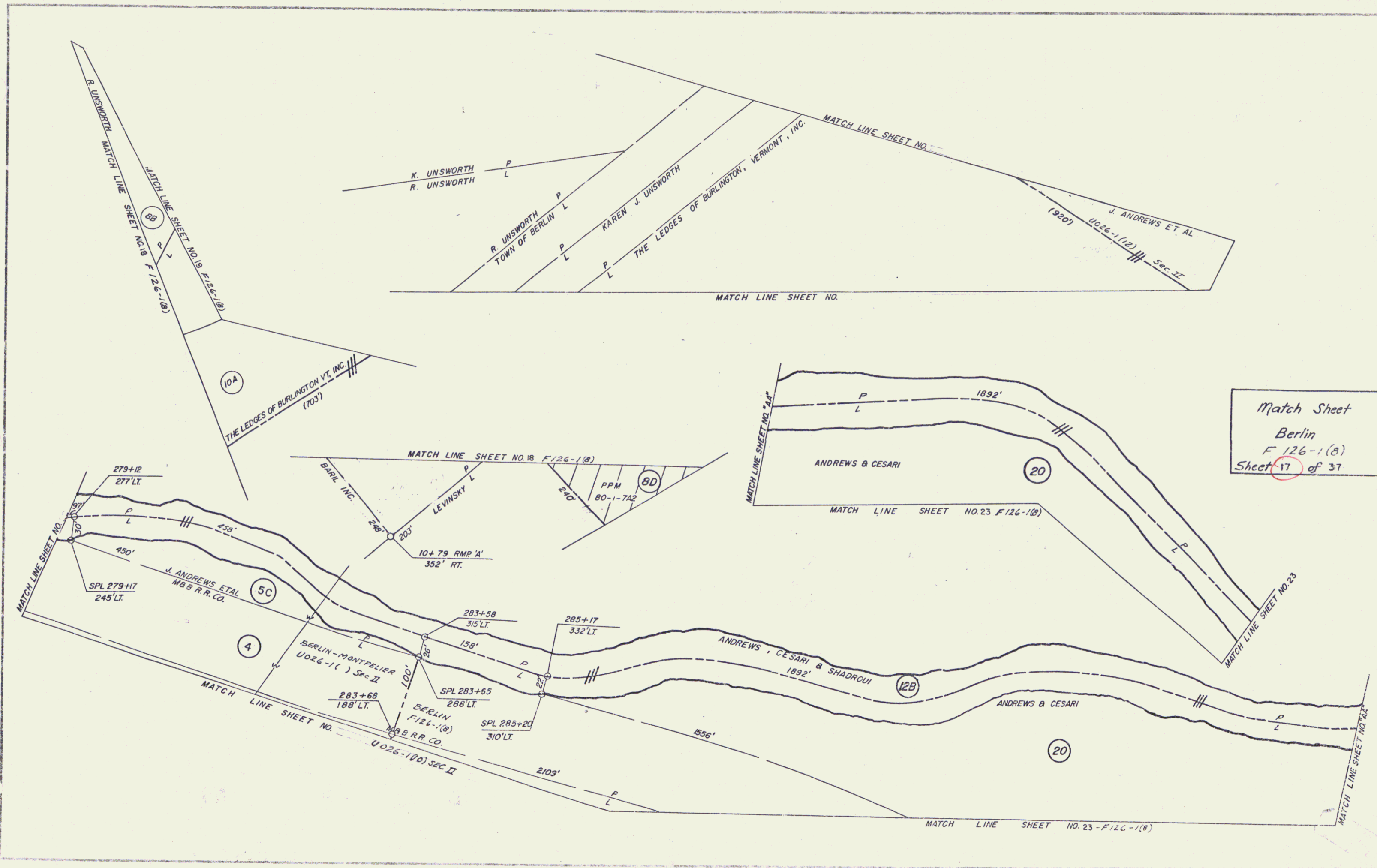

Match Sheet  
 Berlin  
 F 126-1(B)  
 Sheet 17 of 37

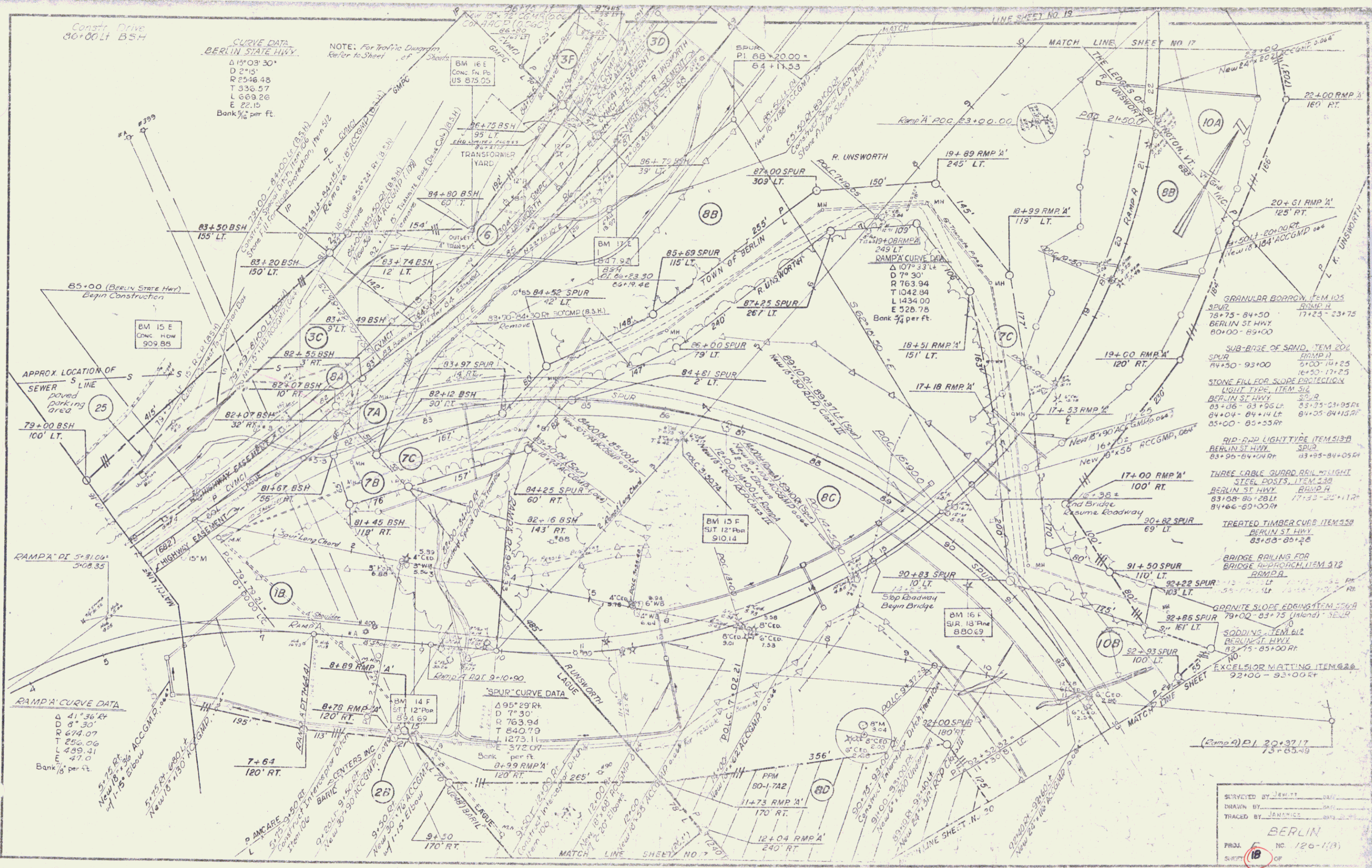

CURVE DATA  
BERLIN STATE HWY  
 $\Delta$  15° 03' 30"  
 $D$  215'  
 $R$  2546.48  
 $T$  336.57  
 $L$  669.26  
 $E$  22.15  
 Bank  $\frac{1}{2}$  per ft.

NOTE: For Traffic Diagram  
Refer to Sheet \_\_\_\_\_ of \_\_\_\_\_

APPROX. LOCATION OF  
SEWER  
LINE  
 Sewer  
 79+00 BSH  
 100' LT.

RAMP A CURVE DATA  
 $\Delta$  41° 36' 04"  
 $D$  30'  
 $R$  674.07  
 $T$  256.06  
 $L$  499.41  
 $E$  47.0  
 Bank  $\frac{1}{2}$  per ft.

SPUR CURVE DATA  
 $\Delta$  95° 29' 00"  
 $D$  7' 30"  
 $R$  763.94  
 $T$  840.79  
 $L$  1273.11  
 $E$  372.07  
 Bank per ft.

RAMP A CURVE DATA  
 $\Delta$  107° 33' 14"  
 $D$  78' 30"  
 $R$  763.94  
 $T$  1042.84  
 $L$  1434.00  
 $E$  328.76  
 Bank  $\frac{1}{4}$  per ft.

GRANULAR BORROW ITEM 105  
 SPUR  
 78+75-84+30 17+23-23+75  
 BERLIN ST HWY  
 80+00-89+00

SUB-BASE OF SAND ITEM 204  
 SPUR  
 84+50-93+00 5+00-14+25  
 16+50-17+25  
 STONE FILL FOR SLOPE PROTECTION  
 LIGHT TYPE ITEM 312  
 BERLIN ST HWY  
 83+16-83+56 LT 83+25-83+56 RT  
 84+04-84+14 LT 84+25-84+15 RT  
 85+00-85+55 RT

RIP-RAP LIGHT TYPE ITEM 519  
 BERLIN ST HWY  
 83+95-84+05 RT 83+95-84+05 RT

THREE CABLE GUARD RAIL LIGHT  
 STEEL POSTS ITEM 230  
 BERLIN ST HWY  
 83+58-86+28 LT 77+23-22+11 RT  
 84+66-89+00 RT

TREATED TIMBER CURB ITEM 558  
 BERLIN ST HWY  
 85+85-85+26

BRIDGE RAILING FOR  
 BRIDGE APPROACH ITEM 312  
 RAMP A  
 10' LT  
 13+25-14' LT 13+25-14' RT  
 GRANITE SLOPE EDGING ITEM 568  
 SPUR  
 79+00-83+75 (Island) SEWER  
 2' 16' LT  
 SODDING ITEM 612  
 BERLIN ST HWY  
 82+75-85+00 RT  
 NO. \_\_\_\_\_  
 EXCELSIOR MATTING ITEM 628  
 92+00-93+00 RT

SURVEYED BY JENNY  
 DRAWN BY JENNY  
 CHECKED BY JENNY  
 BERLIN  
 PROJ. NO. 126-1(3)  
 SHEET 18 OF

POOR ORIGINAL COPY

GRANULAR BORROW, ITEM 105  
 BERLIN ST HWY  
 89+00 - 104+00  
 RAMP A  
 27+50 - 36+00  
 SUB-BASE OF SAND, ITEM 202  
 RAMP A  
 23+75 - 27+50  
 RIP-RAD LIGHT TYPE, ITEM 513-9  
 BERLIN ST HWY  
 93+70 - 93+80 RT  
 100+72 - 100+82 LT  
 THREE CABLE GUARD RAIL  
 LIGHT STEEL POSTS, ITEM 533  
 BERLIN STATE HWY  
 89+00 - 95+34 RT  
 95+00 - 96+75 LT  
 100+00 - 101+50 LT  
 TREATED TIMBER CURB, ITEM 559  
 RAMP A  
 33+30 - 36+00 RT  
 SODDING, ITEM 616  
 BERLIN ST HWY  
 93+85 - 94+50 RT

STONE FILL FOR SLOPE PROTECTION  
 LIGHT TYPE, ITEM 512  
 BERLIN ST HWY  
 93+00 - 93+70 RT  
 93+00 - 93+90 RT  
 100+62 - 100+72 LT  
 100+82 - 100+92 LT  
 RAMP A  
 23+50 - 26+00 LT  
 GRANITE SLOPE EDGING, ITEM 556-A  
 BERLIN ST HWY  
 101+30 - 102+20 RT

BERLIN STATE HIGHWAY  
 $\Delta 15^{\circ}03'30''$  LT  
 $D 2^{\circ}15'$   
 $R 2546.46$   
 $T 336.57$   
 $L 669.26$   
 $E 22.15$   
 Bank  $\frac{3}{8}$  per ft

Contract Drive  
 93+78 Rt (Ramp A)

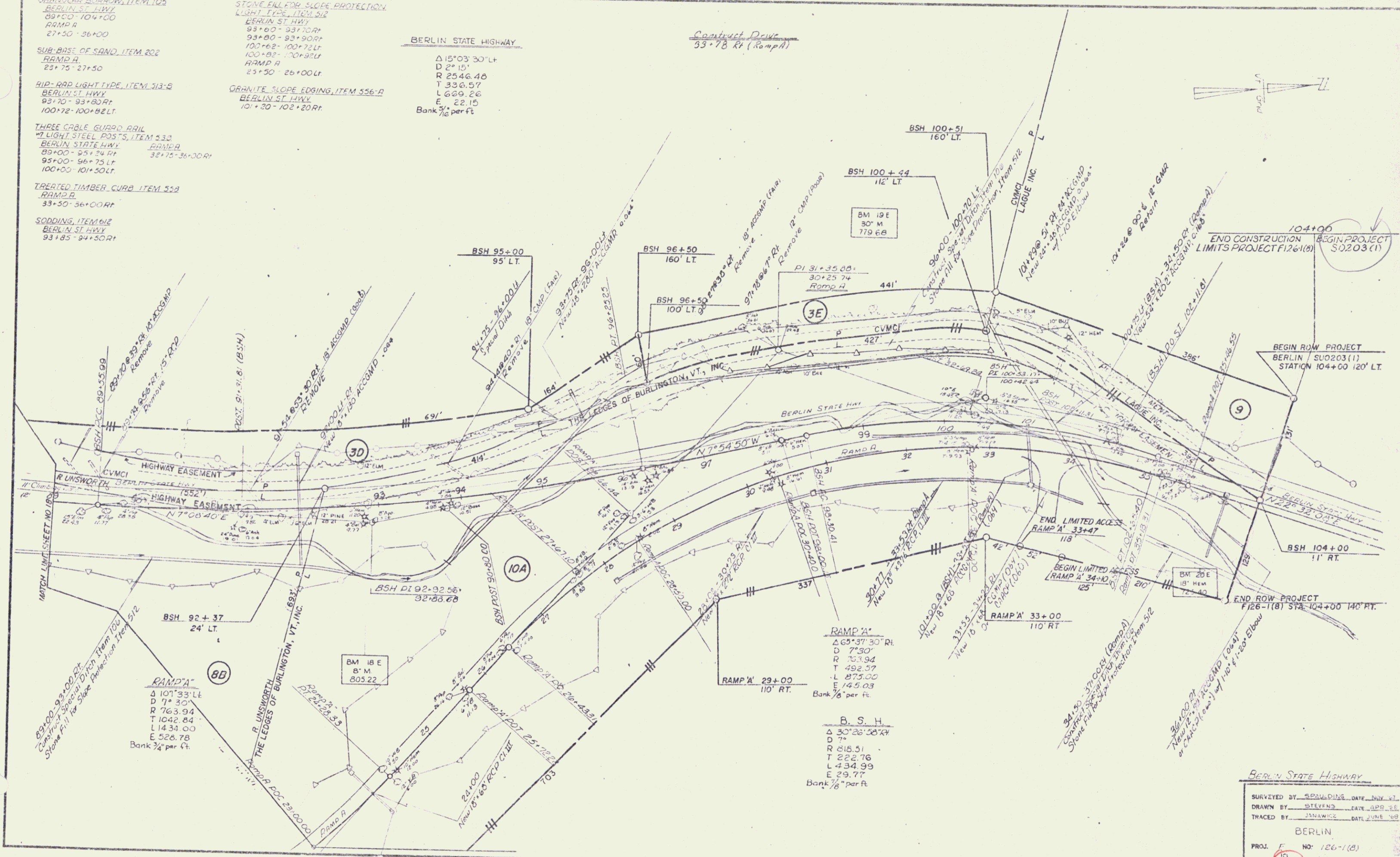

RAMP A'  
 $\Delta 69^{\circ}37'30''$  RT  
 $D 7^{\circ}30'$   
 $R 763.94$   
 $T 492.37$   
 $L 875.00$   
 $E 145.03$   
 Bank  $\frac{3}{8}$  per ft

B. S. H.  
 $\Delta 30^{\circ}26'50''$  RT  
 $D 7^{\circ}$   
 $R 816.51$   
 $T 222.76$   
 $L 434.99$   
 $E 29.77$   
 Bank  $\frac{3}{8}$  per ft

BERLIN STATE HIGHWAY  
 SURVEYED BY SPENDING DATE NOV 81  
 DRAWN BY STEVENS DATE APR 82  
 TRACED BY JONAWICK DATE JUNE 82  
 BERLIN  
 PROJ. NO. 126-1(B)  
 SHEET 19 OF 27

SUR-BASE OF SAND ITEM 202  
 93+00 - 105+00  
 THREE CABLE GUARD RAIL  
 TWELVE STEEL POSTS ITEM 538  
 102+25 - 105+00 LT  
 TREATED TIMBER CURB ITEM 539  
 102+50 - 105+00 LT

MATCH LINE SHEET NO. 17

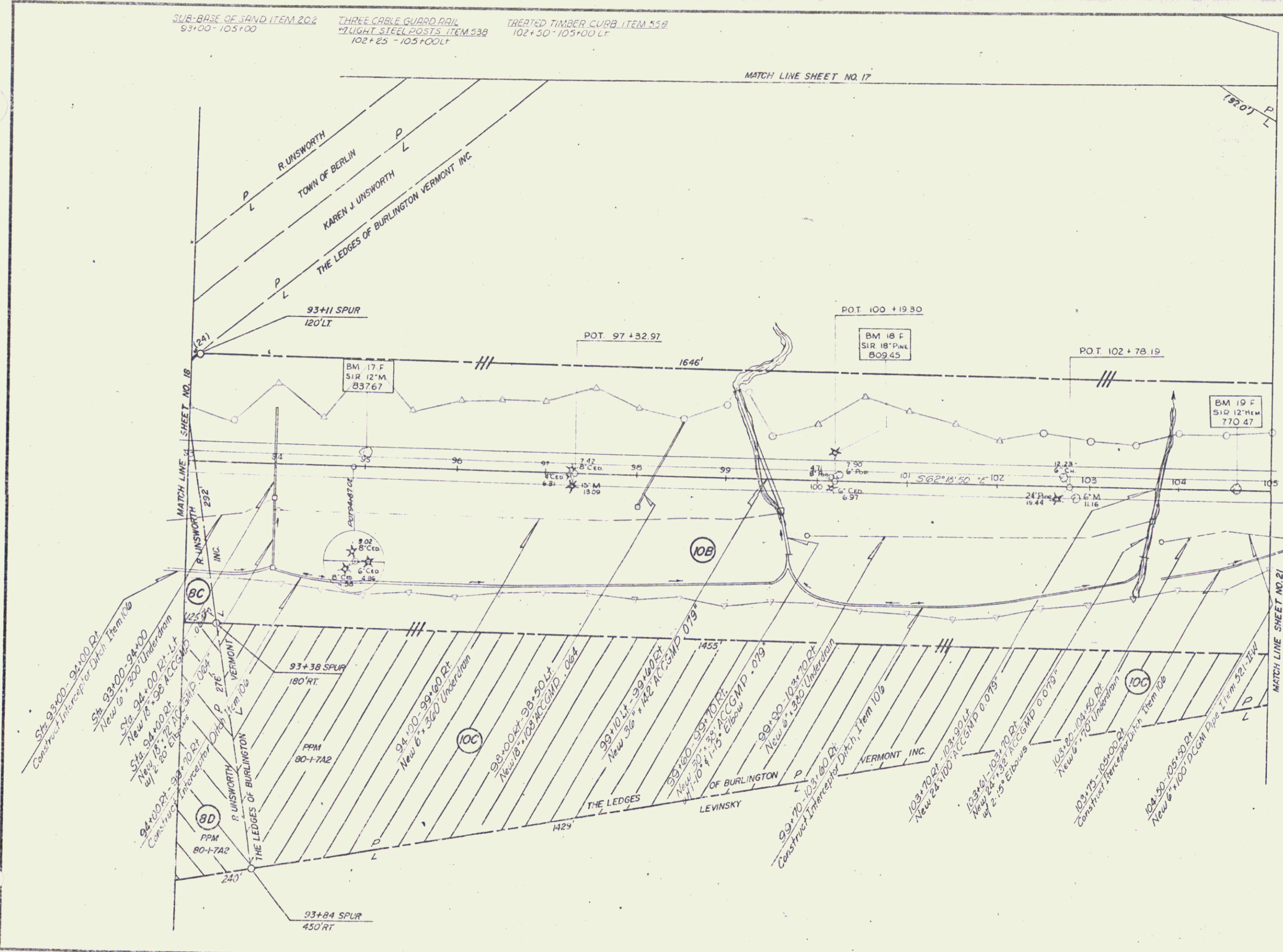
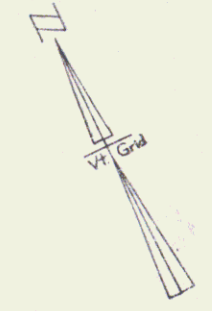

SPUR

SURVEYED BY	JERRETT	DATE	
DRAWN BY	JANAWICZ	DATE	3-58
TRACED BY	BERLIN	DATE	
PROJ.	F	NO.	126-1(B)
SHEET	20	OF	77

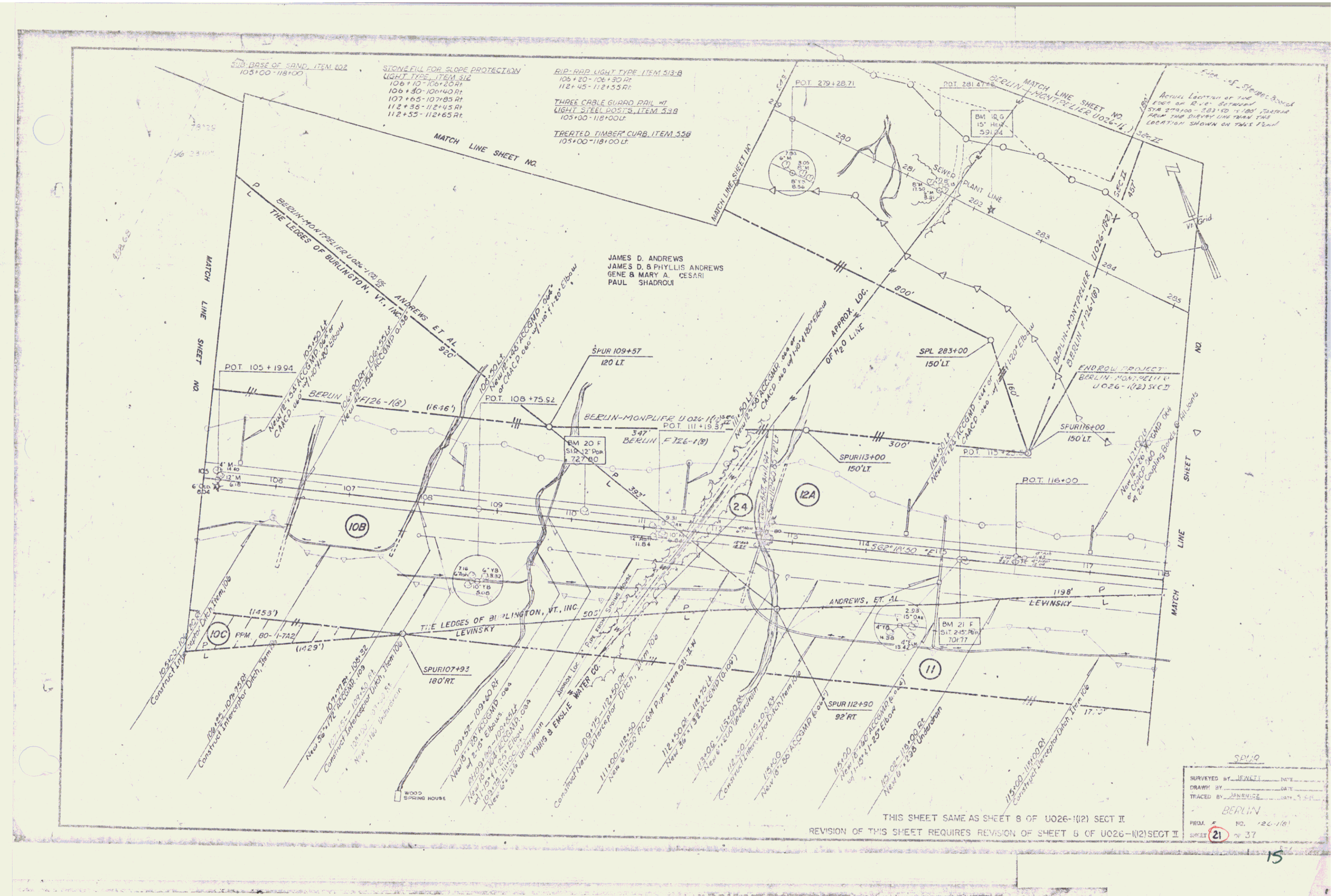

JAMES D. ANDREWS  
 JAMES D. & PHYLLIS ANDREWS  
 GENE & MARY A. CESARI  
 PAUL SHADROUI

Actual Location of the  
 Edge of R.V. determined  
 5/18/2010 - 2010 15' from  
 the survey line from the  
 location shown on this plan

THIS SHEET SAME AS SHEET 8 OF U026-1(12) SECT II  
 REVISION OF THIS SHEET REQUIRES REVISION OF SHEET 8 OF U026-1(12) SECT II

SPUR	
SURVEYED BY: JENKINS	DATE:
DRAWN BY: JENKINS	DATE:
TRACED BY: JENKINS	DATE:
BERLIN	
PROJ. NO. 20-161	SHEET 21 OF 37

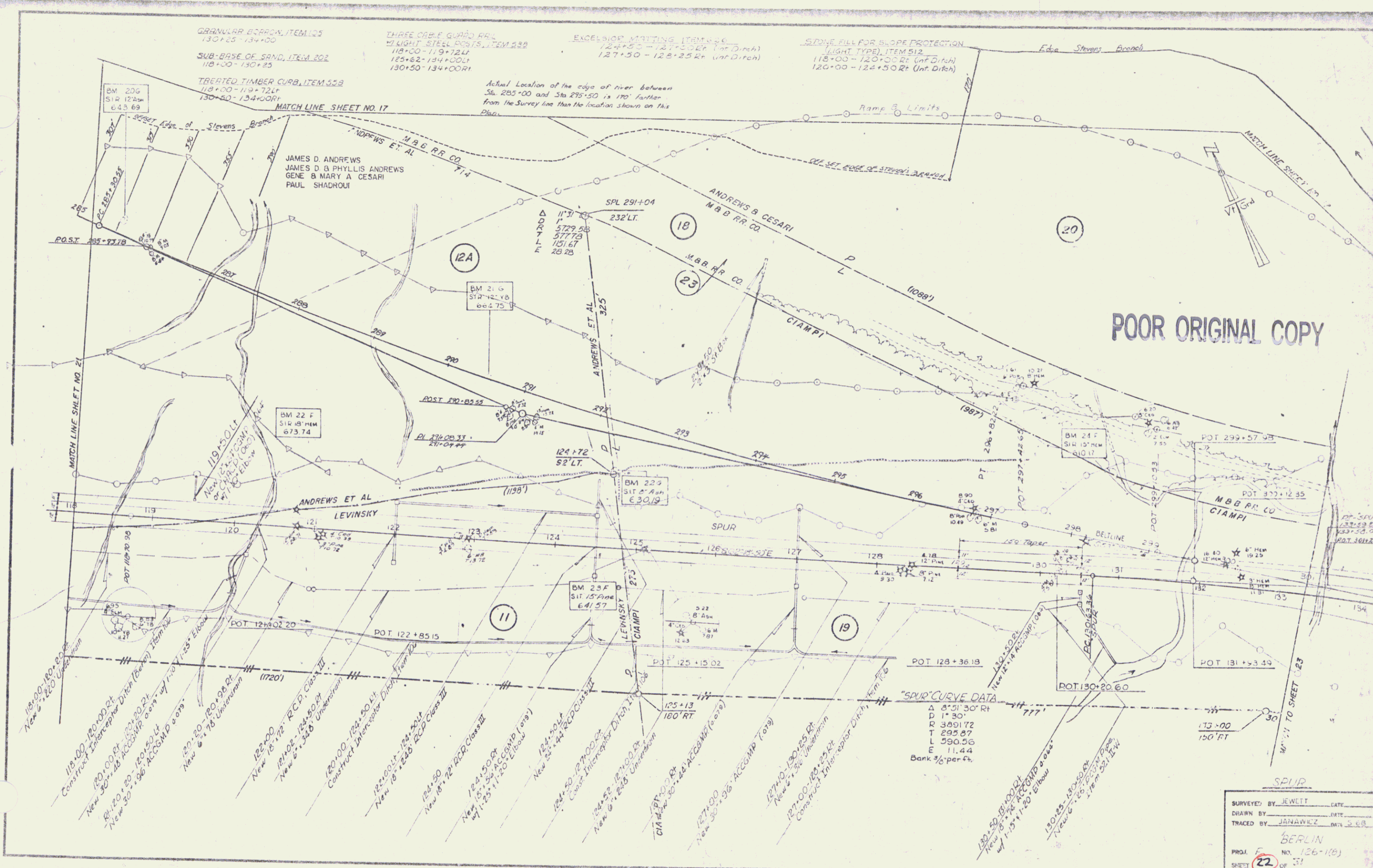

POOR ORIGINAL COPY

SURVEYED BY: JEWETT		DATE:
DRAWN BY: JANAWICZ		DATE: 5-68
TRACED BY: BERLIN		DATE: 5-68
PROJ. F.	NO. 126-118	
SHEET 22	OF 31	

11-19-70

16



PLAN  
 DATE: \_\_\_\_\_  
 DRAWN BY: \_\_\_\_\_  
 CHECKED BY: \_\_\_\_\_  
 SCALE: \_\_\_\_\_

FILE  
 PROJECT: \_\_\_\_\_  
 SHEET: \_\_\_\_\_

GRANULAR HOPROW  
 67+75 - 69+75  
 GRANITE SLOPE EDGING  
 67+00 - 69+00 (Island)

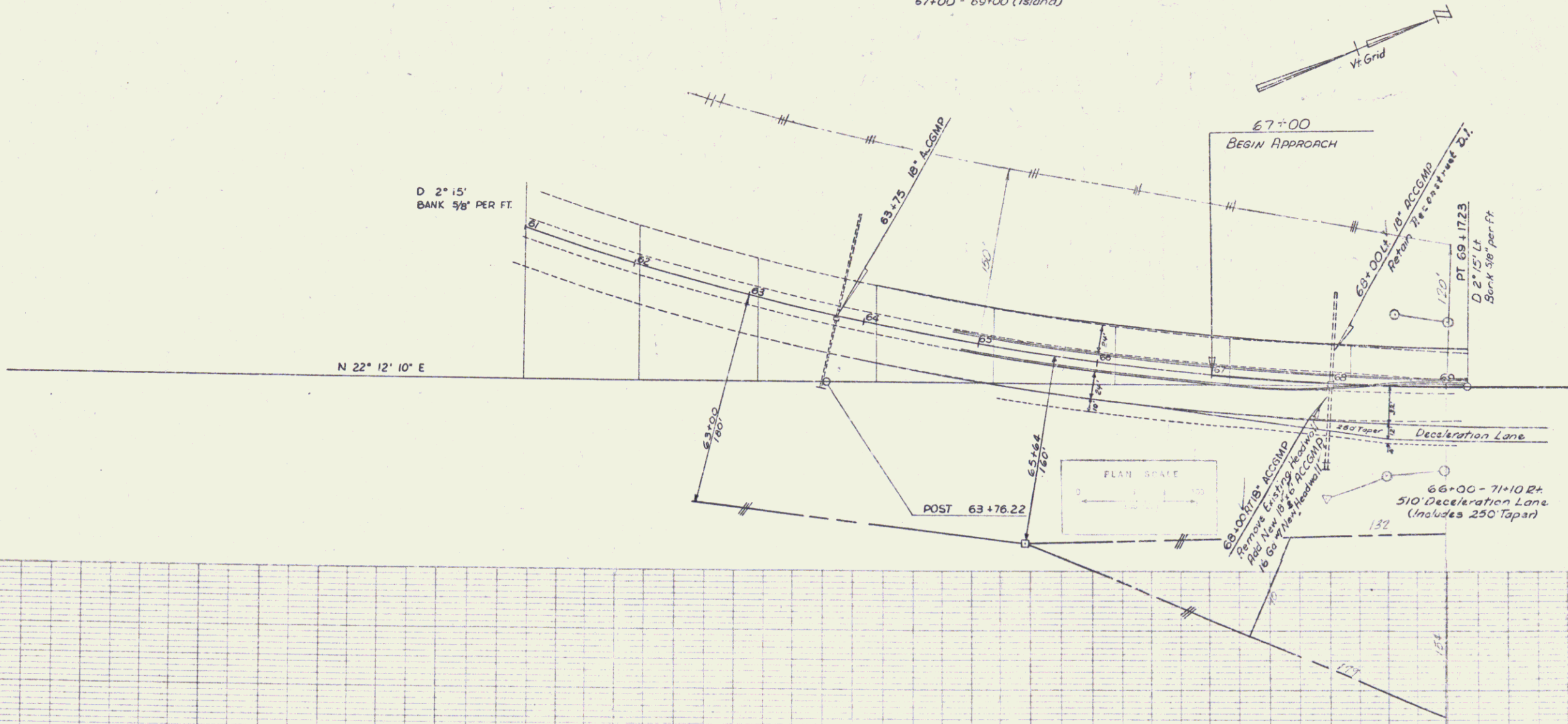

BERLIN  
 SPUR - MAIN LINE  
 F 126-1(8)  
 Sheet 23 of 34

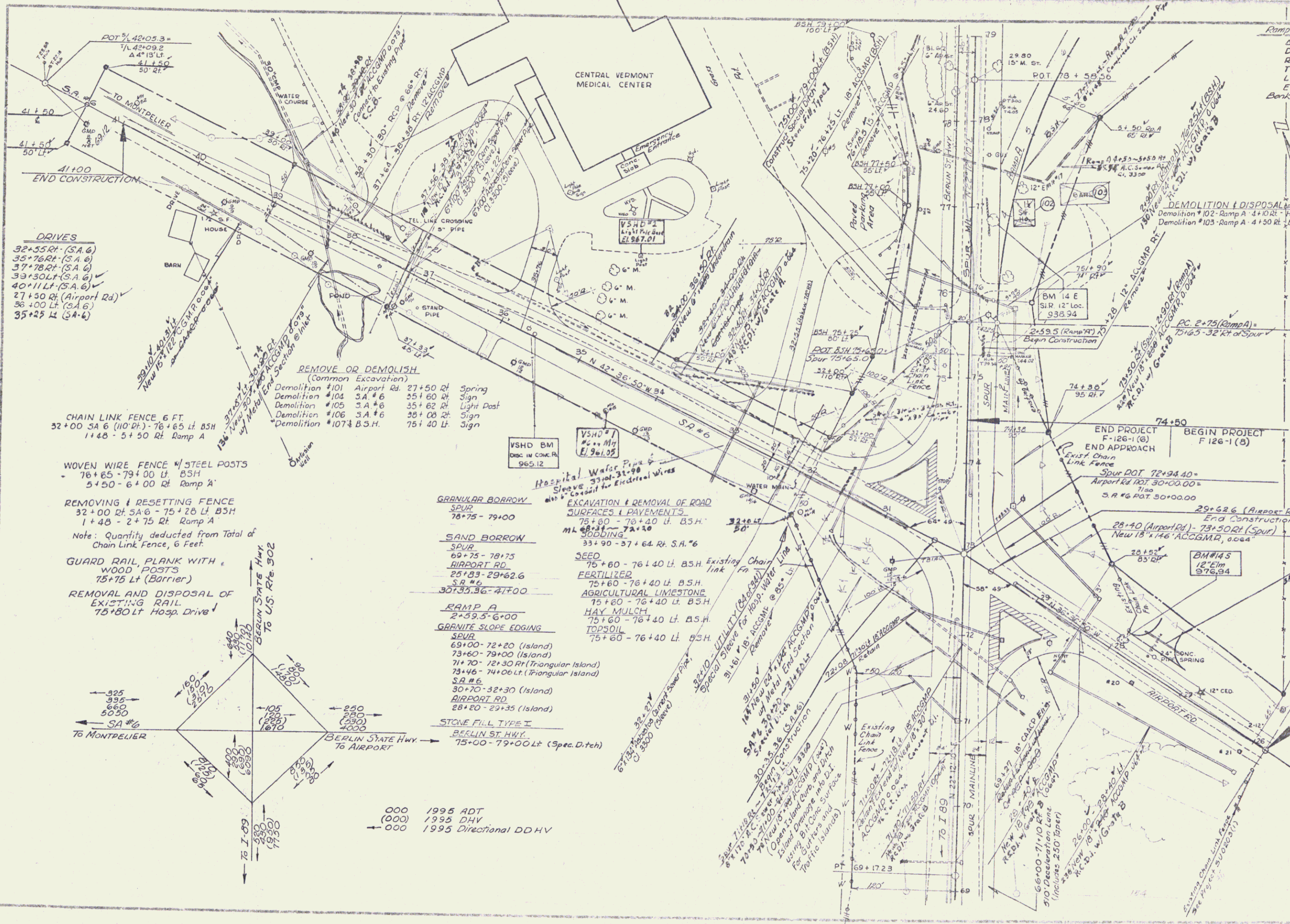

- DRIVES**
- 32+55 RT (SA 6)
  - 35+75 RT (SA 6)
  - 37+78 RT (SA 6)
  - 39+30 LT (SA 6)
  - 40+11 LT (SA 6)
  - 27+30 RT (Airport Rd)
  - 36+00 LT (SA 6)
  - 35+25 L (SA 6)

**REMOVE OR DEMOLISH**  
(Common Excavation)

- Demolition #101 Airport Rd. 27+50 Rt Spring
- Demolition #104 SA #6 55+60 Rt Sign
- Demolition #105 SA #6 55+62 Rt Light Post
- Demolition #106 SA #6 56+00 Rt Sign
- Demolition #107 B.S.H. 75+40 Lt Sign

**CHAIN LINK FENCE 6 FT**  
52+00 SA 6 (110' RT) - 76+65 Lt B.S.H.  
1+48 - 5+50 Rt Ramp A

**WOVEN WIRE FENCE W/ STEEL POSTS**  
76+65 - 79+00 Lt B.S.H.  
5+50 - 6+00 Rt Ramp A

**REMOVING & RESETTING FENCE**  
32+00 Rt SA 6 - 75+20 Lt B.S.H.  
1+48 - 2+75 Rt Ramp A

**GUARD RAIL PLANK WITH WOOD POSTS**  
75+75 Lt (Barrier)

**REMOVAL AND DISPOSAL OF EXISTING RAIL**  
75+80 Lt Hosp. Drive

**GRANULAR BORROW**  
SPUR  
78+75 - 79+00

**SAND BORROW**  
SPUR  
69+75 - 78+75  
AIRPORT RD  
28+83 - 29+62.6  
3.8 #6  
30+33.36 - 41+00

**RAMP A**  
2+39.5 - 6+00

**GRANITE SLOPE EDGING**  
SPUR  
69+00 - 72+20 (Island)  
73+60 - 79+00 (Island)  
71+70 - 72+30 Rt (Triangular Island)  
73+46 - 74+06 Lt (Triangular Island)

**STONE FILL TYPE I**  
SPUR  
30+70 - 32+30 (Island)  
AIRPORT RD  
28+20 - 29+35 (Island)

**BERLIN ST. HWY**  
75+00 - 79+00 Lt (Spec. Ditch)

000 1995 ADT  
000 1995 DHV  
000 1995 Directional DDHV

**Ramp A Curve Data**

- L 41' 38" 36'
- D 8' 30" V
- R 674.07'
- T 250.06'
- L 489.41'
- E 47.00'
- Bank 0.75 ft per ft

**UTILITIES**  
For Details of BERLIN SANITARY SEWER refer to Sheets 74-83 of 341. For Electric and Communication Details, refer to 85-88 of 341.

PLAN SCALE  
1" = 40'

PREPARED BY: JEWETT  
DESIGNED BY: JANAWICZ  
CHECKED BY: J. S. B. 5-68  
**BERLIN**  
F-126-1(C)  
SHEET 341



PLAN  
 1/4" = 100'  
 1/8" = 100'  
 1/16" = 100'

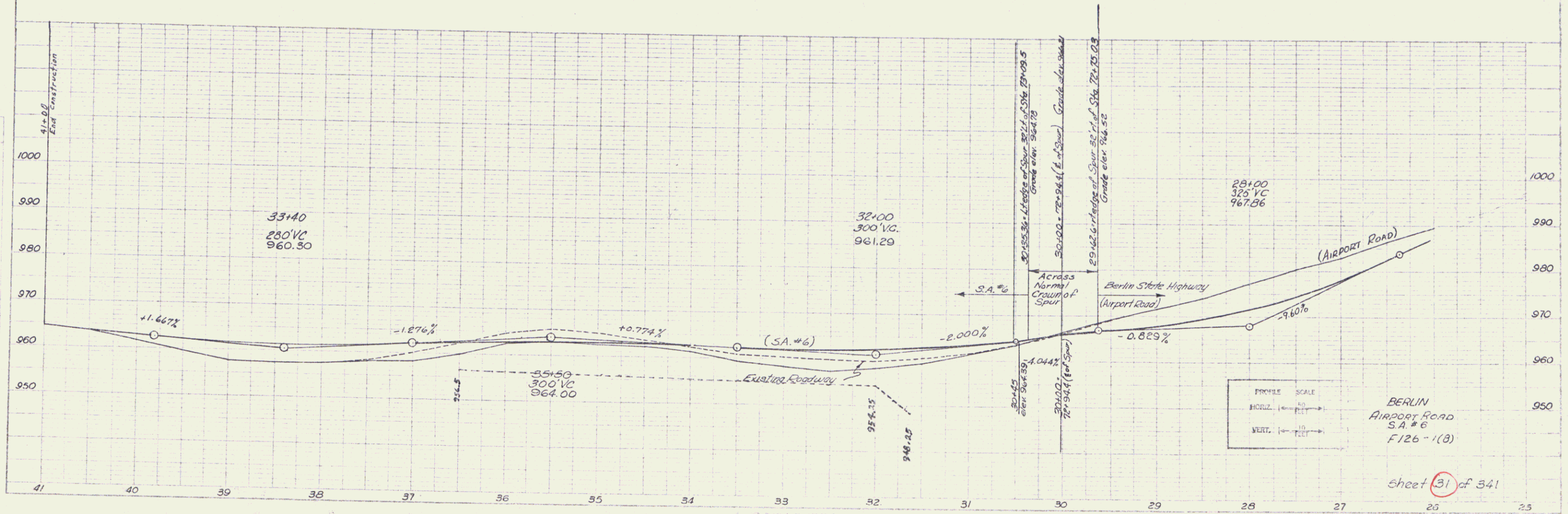

PROFILE SCALE  
 HORIZ. 1" = 100'  
 VERT. 1" = 10'  
 BERLIN  
 AIRPORT ROAD  
 S.A. # 6  
 F 126-1(B)

Sheet 31 of 34

140  
21

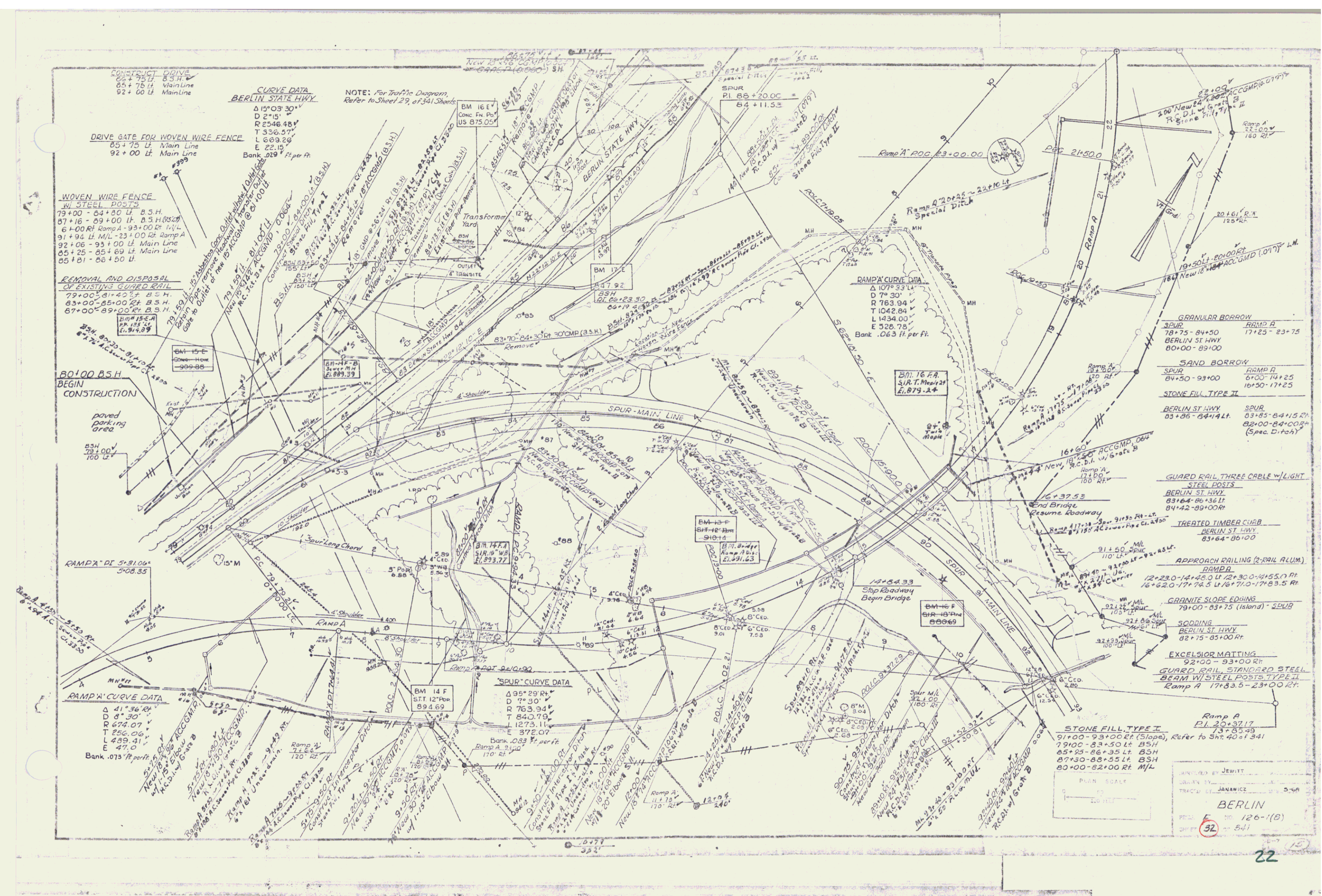

CONSTRUCT DRIVE  
 66+75 Lt. B.S.H.  
 65+75 Lt. Main Line  
 92+00 Lt. Main Line

**CURVE DATA**  
**BERLIN STATE HWY**  
 Δ 15° 03' 30"  
 D 2° 15'  
 R 2546.48'  
 T 336.57'  
 L 689.29'  
 E 22.15'  
 Bank .029' ft. per ft.

NOTE: For Traffic Diagram  
 Refer to Sheet 29, of 341 Sheets

**WOVEN WIRE FENCE**  
 W/ STEEL POSTS  
 79+00 - 84+00 Lt. B.S.H.  
 87+16 - 89+00 Lt. B.S.H. (8320)  
 6+00 Rt. Ramp A - 93+00 Lt. M/L  
 91+94 Lt. M/L - 23+00 Lt. Ramp A  
 92+06 - 93+00 Lt. Main Line  
 85+25 - 85+89 Lt. Main Line  
 85+81 - 86+50 Lt.

**REMOVAL AND DISPOSAL**  
**OF EXISTING GUARD RAIL**  
 79+00 - 81+40 Lt. B.S.H.  
 83+00 - 85+00 Lt. B.S.H.  
 87+00 - 89+00 Lt. B.S.H.

80+00 B.S.H.  
 BEGIN CONSTRUCTION

**RAMP A CURVE DATA**  
 Δ 41° 36' 00"  
 D 8° 30'  
 R 674.07'  
 T 256.09'  
 L 439.41'  
 E 47.0'  
 Bank .073' ft. per ft.

**"SPUR" CURVE DATA**  
 Δ 95° 29' 00"  
 D 7° 30'  
 R 763.94'  
 T 840.78'  
 L 1273.11'  
 E 372.07'  
 Bank .033' ft. per ft.

**RAMP A CURVE DATA**  
 Δ 107° 33' 00"  
 D 7° 30'  
 R 763.94'  
 T 1042.84'  
 L 1434.00'  
 E 328.78'  
 Bank .063' ft. per ft.

**GRANULAR BORROW**  
 SPUR RAMP A  
 78+75 - 84+50 17+25 - 23+75  
 BERLIN ST HWY  
 80+00 - 89+00

**SAND BORROW**  
 SPUR RAMP A  
 84+50 - 93+00 67+00 - 74+25  
 16+50 - 17+25

**STONE FILL TYPE II**  
 BERLIN ST HWY  
 83+85 - 84+14 Lt.  
 SPUR  
 82+00 - 84+00 Rt.  
 (Spec. Ditch)

**GUARD RAIL THREE CABLE W/ LIGHT**  
**STEEL POSTS**  
 BERLIN ST HWY  
 83+84 - 86+36 Lt.  
 84+42 - 89+00 Rt.

**TREATED TIMBER CURB**  
 BERLIN ST HWY  
 83+84 - 86+100

**APPROACH RAILING (2-RAIL ALUM)**  
**RAMP A**  
 12+23.0 - 14+48.0 Lt / 12+30.0 - 14+55.0 Rt.  
 16+52.0 - 17+74.5 Lt / 16+71.0 - 17+83.5 Rt.

**GRANITE SLOPE EDGING**  
 79+00 - 83+75 (Island) - SPUR

**SOODING**  
 BERLIN ST HWY  
 82+75 - 85+00 Rt.

**EXCELSIOR MATTING**  
 92+00 - 93+00 Rt.  
**GUARD RAIL STANDARD STEEL**  
**BEAM W/ STEEL POSTS TYPE II**  
 Ramp A 17+83.5 - 23+00 Rt.

**STONE FILL TYPE I**  
 91+00 - 93+00 Rt (Slope), Refer to Sht. 40 of 341  
 79+00 - 83+50 Lt. B.S.H.  
 85+25 - 86+35 Lt. B.S.H.  
 87+30 - 88+55 Lt. B.S.H.  
 80+00 - 82+00 Lt. M/L

PLAN SCALE  
 1" = 40'

DESIGNED BY JEWITT  
 DRAWN BY JANAWICE  
 TRACED BY 5-04  
**BERLIN**  
 126-1(B)  
 52-541



SAND BORROW  
105+00 - 118+00

STONE FILL, TYPE II  
106+10 - 106+40 Rt.  
107+65 - 107+85 Rt.  
112+35 - 112+65 Rt.

GUARD RAIL, THREE CABLE  
W/ LIGHT STEEL POSTS  
105+00 - 118+00 Lt.

TREATED TIMBER CURB  
105+00 - 118+00 Lt.

STONE FILL, TYPE I  
105+00 - 106+20 Rt. (Int. Ditch)  
106+25 - 107+25 Rt. (Int. Ditch)  
107+75 - 109+50 Rt. (Int. Ditch)  
109+75 - 112+50 Rt. (Int. Ditch)  
112+50 - 115+00 Rt. (Int. Ditch)  
113+00 - 118+00 Rt. (Int. Ditch)  
108+00 - 111+00 Rt. (Slopes)  
113+00 - 118+00 Rt. (Slopes) Refer to Sheet 40 of 341

WOVEN WIRE FENCE W/ STEEL POSTS  
105+00 - 118+00 Lt.

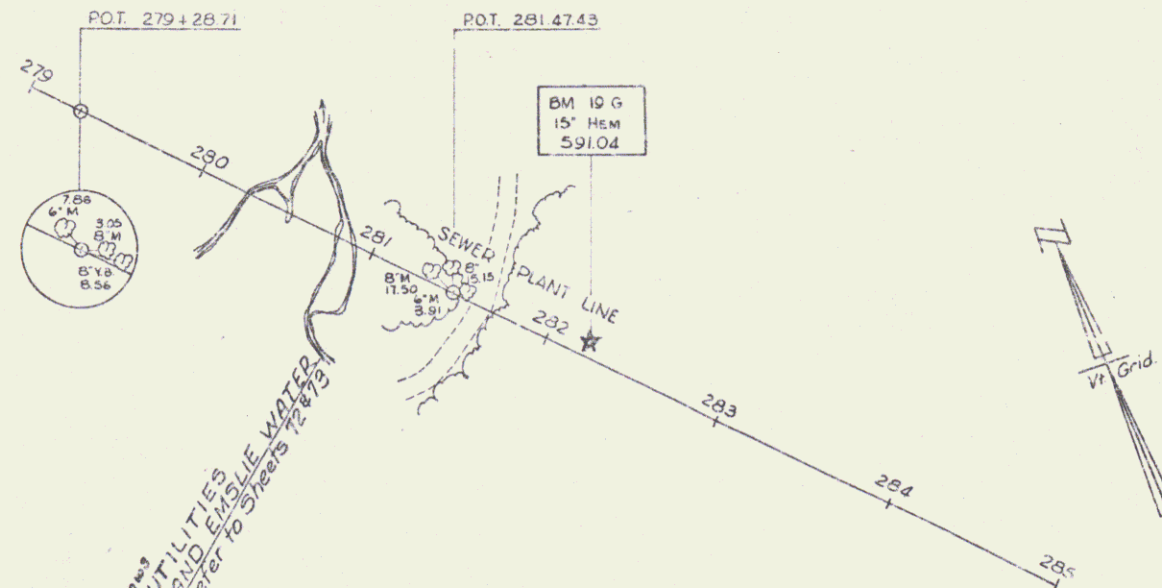

POOR ORIGINAL COPY

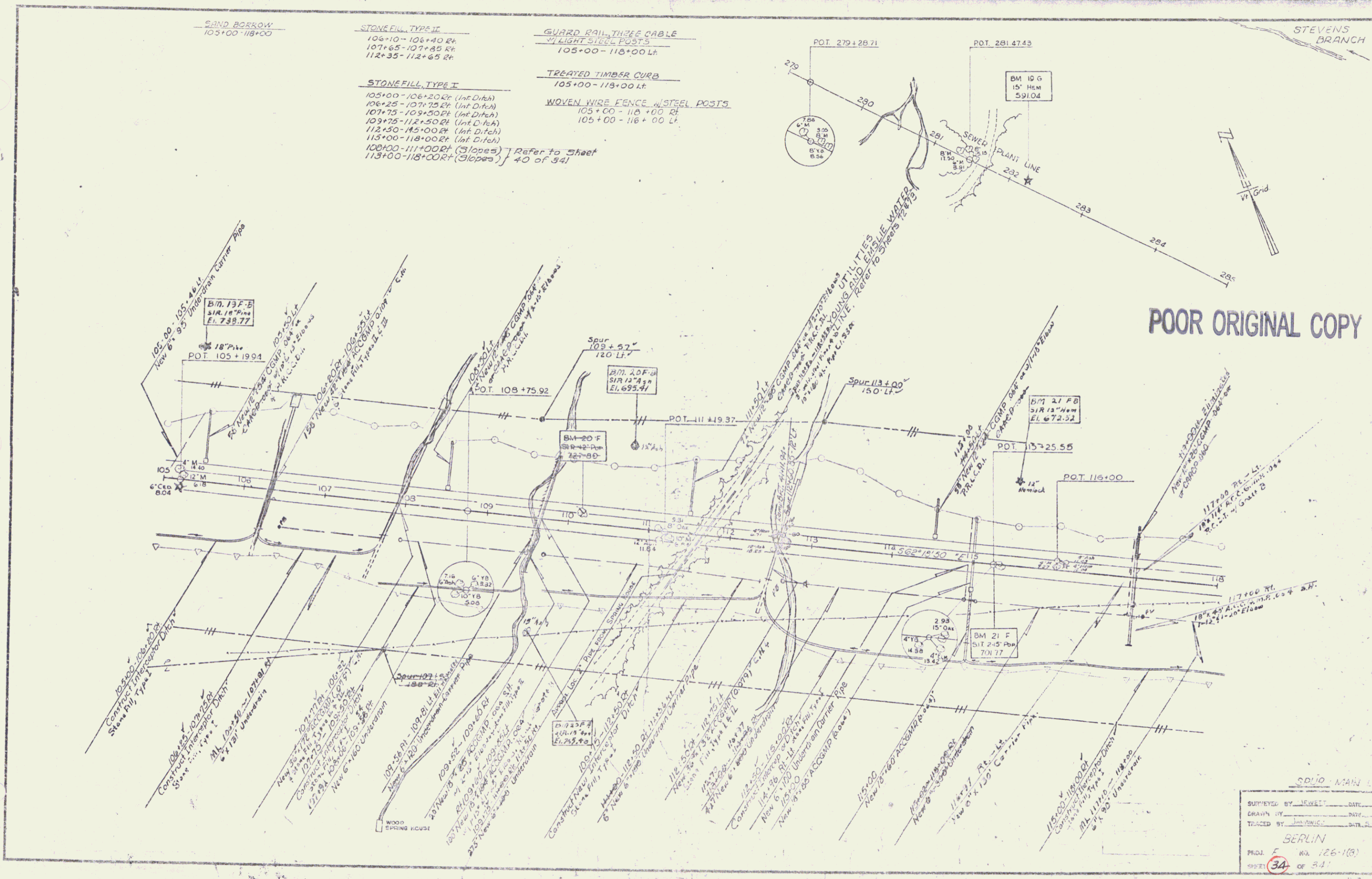

SD10 - MAIN LINE  
SUPPLIED BY: SEWET DATE: \_\_\_\_\_  
DRAWN BY: J. W. B. DATE: \_\_\_\_\_  
TRACED BY: J. W. B. DATE: \_\_\_\_\_  
BERLIN  
PROJ. NO. 126-1(B)  
SHEET 34 OF 34

GRANULAR BORROW  
130+25 - 133+00  
SAND BORROW  
118+00 - 130+25  
TREATED TIMBER CURB  
118+00 - 119+50 Lt  
131+00 - 133+00 Rt

GUARD RAIL, THREE CABLE  
W/ LIGHT STEEL POSTS  
118+00 - 120+00 Lt  
130+26 - 133+00 Rt  
GUARD RAIL, STANDARD STEEL  
BEAM w/ STEEL POSTS, TYPE II  
125+44 - 133+00 Lt

EXCelsIOR MATTING  
124+50 - 127+00 Rt (Inf. Ditch)  
127+00 - 128+25 Rt (Inf. Ditch)  
WOVEN WIRE FENCE w/ STEEL POSTS  
118+00 - 133+00 Rt

STONE FILL, TYPE I  
118+00 - 120+00 Rt (Inf. Ditch)  
120+00 - 124+50 Rt (Inf. Ditch)  
118+00 - 130+50 Rt (Slope, Refer to Sht. 40 of 341)

STEVENS BRANCH

BM 20G  
SIR 12' YB  
643.69

BM 21G  
SIR 12' YB  
664.75

BM 22G  
SIR 6' Ash  
630.19

BM 23F  
SIR 12' YB  
641.57

BM 24F  
SIR 10' New  
610.17

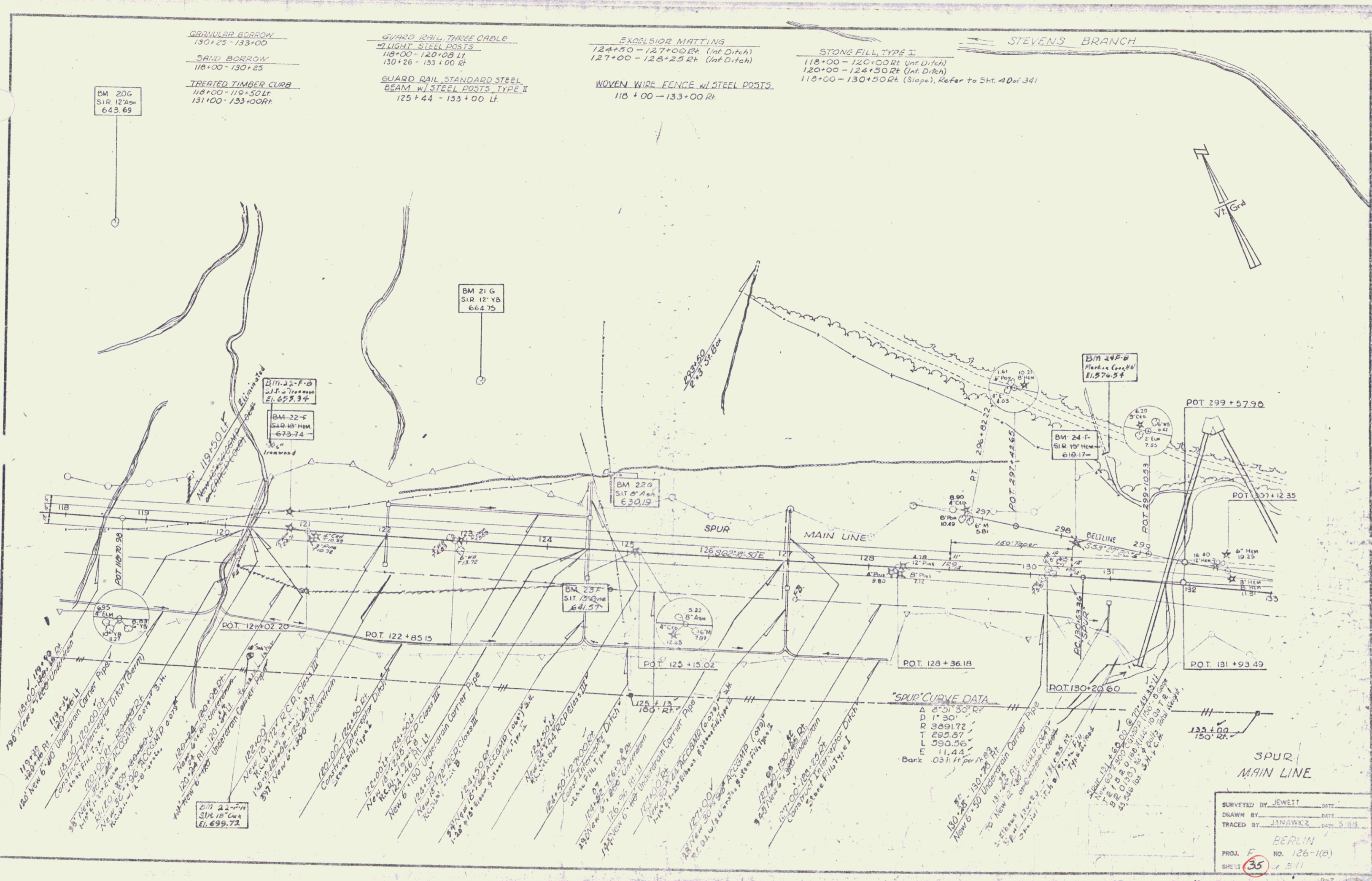

SPUR CURVE DATA

A	6° 31' 30" Rt
D	1' 30"
R	3891.72
T	295.57
L	590.56
E	11.44'
Bank	0.31 ft per ft

SURVEYED BY JEWETT  
DRAWN BY JANAWCZ  
TRACED BY JANAWCZ  
BERLIN  
NO. 126-1(B)  
SHEET 35 of 311

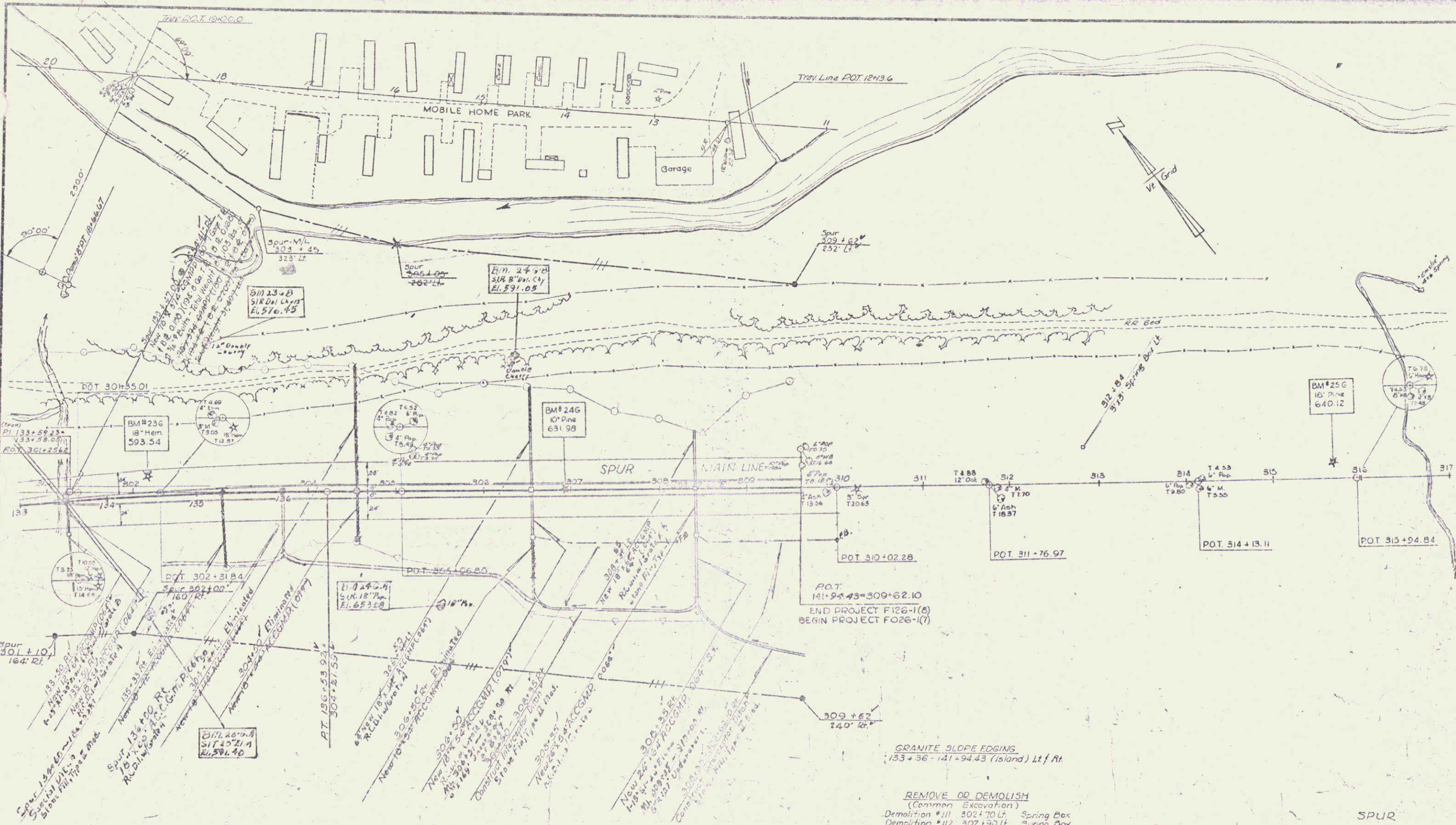

GRANULAR BORROW  
 (134+00) - (135+92)  
 (301+70) - (304+22)

SAND BORROW  
 (136+92) - (141+94.43)  
 (304+22) - (309+62.10)

GUARD RAIL, THREE CABLE  
 W/ LIGHT STEEL POSTS  
 (135+00) - (135+00 RT)  
 (300+70) - (303+52 RT)

GUARD RAIL, STANDARD STEEL  
 BEAM, 6" STEEL POSTS  
 (133+00) - (133+00 RT)  
 (300+70) - (300+82 RT)

INSERTED TIMBER CUBB  
 (135+00) - (135+00 RT)  
 (300+70) - (303+52 RT)

WOVEN WIRE FENCE  
 W/ STEEL POSTS  
 (133+00) - (133+00 RT)  
 (301+00) - (309+62.10)

STONE FILL, TYPE 1  
 306+50 - 306+35 RT (Int. Ditch)  
 303+35 - 303+62.10 RT (Int. Ditch)

GRANITE SLOPE FACING  
 (133+36 - 141+94.43 (island) Lt & Rt)

REMOVE OR DEMOLISH  
 (Common Excavation)  
 Demolition #111 302+70 Lt Spring Box  
 Demolition #112 302+50 Lt Spring Box

SPUR  
 MAIN LINE

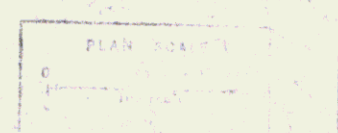

SURVEYED BY	SEWELL	DATE	
DRAWN BY		DATE	
TRACED BY	JANSEN	DATE	
BERLIN			
PROJ. NO.	F NO. 125-101	DATE	
CHECKED	316	DATE	

**GRANULAR BORROW**  
BERLIN ST HWY  
89+00 - 104+00  
RAMP A  
27+50 - 36+40

**SAND BORROW**  
RAMP A  
23+75 - 27+50

**GUARD RAIL, PLANK W/ WOOD POSTS**  
B.S.H. STA. 97+50 LT.

**GUARD RAIL, THREE CABLE**  
7 LIGHT STEEL POSTS  
BERLIN STATE HWY  
89+00 - 94+20 Rt.  
93+10 - 96+78 Lt.

**TREATED TIMBER CURB**  
RAMP A  
34+28 - 36+40 Rt.

**SODDING**  
BERLIN ST HWY  
93+85 - 94+50 Rt.

**STONE FILL, TYPE II**  
BERLIN ST HWY  
89+00 - 93+85 Rt. (Spec. Ditch)  
96+00 - 100+00 Lt. (Spec. Ditch)  
100+62 - 100+92 Lt.

**RAMP A**  
25+75 - 26+25 Lt.

**34+20 - 34+50 Rt.**

**GRANITE SLOPE EDGING**  
BERLIN ST HWY  
99+06 - 101+06 Rt. (Island)

**STONE FILL, TYPE III**  
BERLIN ST HWY  
100+00 - 100+70 Lt. (Spec. Ditch)

**RAMP A**  
34+50 - 36+50 Rt. (Spec. Ditch)

**GUARD RAIL STANDARD STEEL BEAM W/ STEEL POSTS, TYPE II**  
B.S.H. STA. 100+23 - 101+35 Lt.  
RAMP A 23+00 - 25+00.5 Rt.

**BERLIN STATE HIGHWAY**  
Δ 15° 03' 30" Lt.  
D 2° 10' ✓  
R 2546.40 ✓  
T 336.57 ✓  
L 669.26 ✓  
E 22.15 ✓  
Bank 0.0281 ft. per ft.

**EXCAVATION & REMOVAL OF ROAD SURFACES & PAVEMENTS**  
94+50 - 96+00 Lt. B.S.H.  
101+80 - 102+90 Lt. B.S.H.

**SEED**  
94+50 - 96+00 Lt. B.S.H.

**AGRICULTURAL LIMESTONE**  
94+50 - 96+00 Lt. B.S.H.

**FERTILIZER**  
94+50 - 96+00 Lt. B.S.H.

**HAY MULCH**  
94+50 - 96+00 Lt. B.S.H.

**TOPSOIL**  
94+50 - 96+00 Lt. B.S.H.

**WOVEN WIRE FENCE W/ STEEL POSTS**  
89+00 - 101+20 Lt. B.S.H.  
102+00 - 104+00 Lt. B.S.H.  
23+00 - 33+44 Rt. Ramp A  
34+17 Rt. Ramp A - 104+00 Rt. B.S.H.

**CONSTRUCT DRIVE**  
33+70 Rt. (Ramp A)

**CONSTRUCT APPROACH**  
101+60 Lt.

**Stone Fill, Type I**  
Berlin State Hwy  
89+50 - 94+75 Lt.  
94+75 - 96+00 Lt.  
Ramp A  
24+25 - 25+75 Lt.  
26+50 - 33+60 Rt.

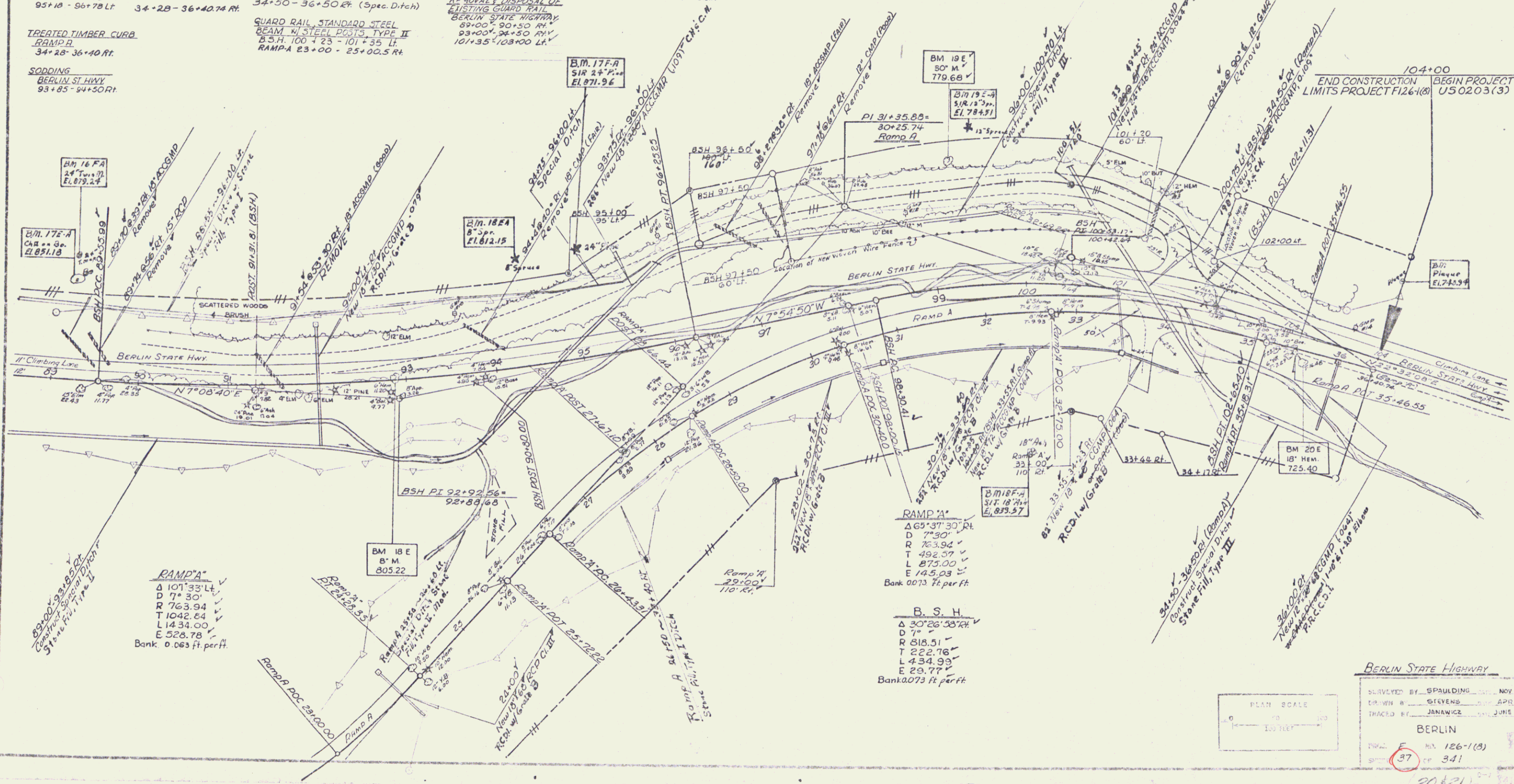
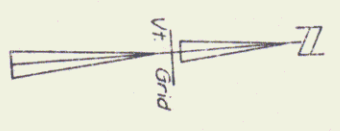

**BERLIN STATE HIGHWAY**

Surveyed by: SPAULDING NOV 57  
 Drawn by: STEVENS APR 58  
 Traced by: JANAWICZ JUNE 58

**BERLIN**

Sheet 37 of 341