

VT 62

VT 62

INDEX OF SHEETS

1	TITLE SHEET	
2	TYPICAL SHEET	
3	QUANTITY SHEET	
4	DRAINAGE SHEET	
5-6	EARLY WORK AND GRADE	
7-9	ROW DETAIL SHEETS	
10-21	PLAN AND PROFILE SHEETS	
22-24	20 SCALE INTERSECTION PLAN SHEETS	
25	PLAN AND PROFILE OF 96' GMP STA. 11+50	
26	BORINGS OF 96' GMP STA. 11+50	
27-28	ELEVATION OF 7X7 RC BOX (PIPE GALLERY) AT STA. 13+52	
29-30	DETAILS OF 7X7 RC BOX (PIPE GALLERY) AT STA. 13+52	
31	REINFORCING STEEL SCHEDULE FOR 7X7 RC BOX (PIPE GALLERY) AT STA. 13+52	
32	BLANK	
33	BLANK	
34	A-60 SOLID ROCK EXCAVATION	DEC-21-67-R
35	B-1 BANKING TABLES	DEC-21-67-R
36	B-5 TYPICAL SLOPE GRADING	JULY-17-67-W
37	B-6 MUCK EXCAVATION	MAR-10-65
38	B-10 EMBANKMENT ON A SLOPE	MAR-10-65
39	B-11 SLOPE STABILIZATION	MAR-10-65
40	D-2 UNDERDRAIN AND HEADWALLS	JULY-25-67-W
41	D-3 GUTTERS	JULY-19-67-W
42	D-4 ELDSWS, FLUSHING BASINS, CURB STOPS	AUG-11-66-R
43	BLANK	
44	BLANK	
45	D-18 DROP INLETS	MAR-10-65
46	D-19 DROP INLET TOPS	MAR-10-65
47	D-21 DETAIL OF GRATES AND COVERS	MAR-10-65
48	D-22 CONCRETE CATCH BASIN	MAR-10-65
49	D-23 PRECAST REINFORCED CONCRETE CURB DROP INLET	MAR-10-65
50	F-1 CONC. VERTICAL SIGNS	AUG-21-67-R
51	F-2 CONC. VERTICAL SIGNS	AUG-21-67-R
52	F-3 CONC. VERTICAL SIGNS	AUG-21-67-R
53	F-4 CONC. VERTICAL SIGNS	AUG-21-67-R
54	F-5 CONC. VERTICAL SIGNS	AUG-21-67-R
55	F-6 CONC. VERTICAL SIGNS	AUG-21-67-R
56	F-7 CONC. VERTICAL SIGNS	AUG-21-67-R
57	F-8 CONC. VERTICAL SIGNS	AUG-21-67-R
58	F-9 CONC. VERTICAL SIGNS	AUG-21-67-R
59-92	MAINLINE CROSS SECTIONS	
93	S&B CROSS SECTIONS	
94	S&B CROSS SECTIONS	
95-99	96' GMP CHANNEL SECTIONS	
100-104	BLANK	

STATE OF VERMONT
DEPARTMENT OF HIGHWAYS
PROPOSED IMPROVEMENT

PRIMARY PROJECT
TOWN OF BERLIN
COUNTY OF WASHINGTON
ROUTE U.S. 302 SPUR
INTERSTATE ROUTE 89--U.S. ROUTE 302 ROAD

BEGINNING AT A POINT 2.259 MILES WESTERLY OF THE JUNCTION OF BERLIN STATE HIGHWAY AND U.S. ROUTE 302 AND EXTENDING EASTERLY 1.241 MILES.

LENGTH OF ROADWAY 6,550.00 FEET = 1.241 MILES
LENGTH OF PROJECT 6,550.00 FEET = 1.241 MILES

DHV (1970)	610
ADT (1970)	4060
ADT (1987)	7830
DHV (1987)	1175
D	51.5%
T	7%
V	50

Route: VT 62
PROJECT F126-1(9)
PIN: 00R398
DATE: 03/28/1968

SECTION	STATE	PROJECT	DATE	SHEET	TOTAL SHEETS
1	VT	F126-1(9)	03/28/68	1	99

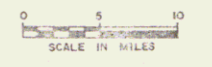
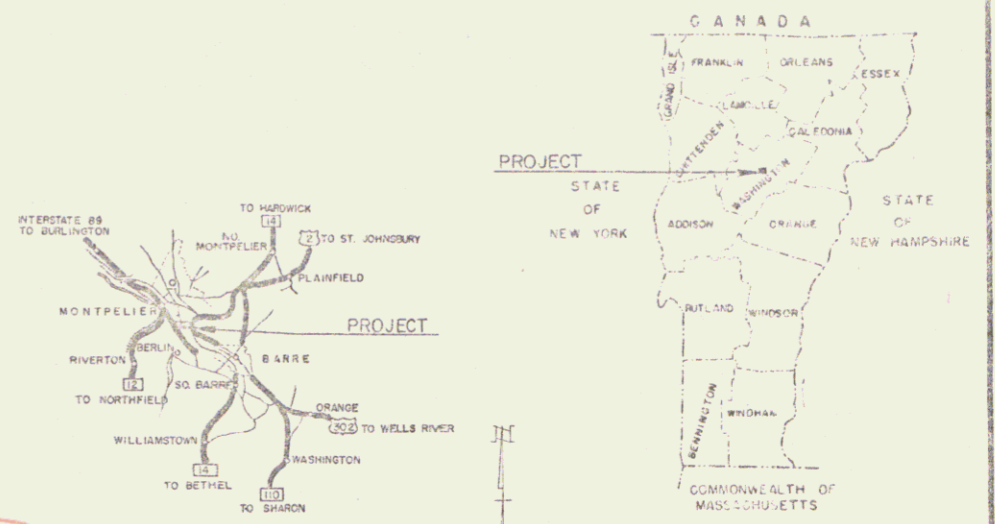

PAVEMENT	TYPE	THICKNESS	AREA
ASPH	1 1/2"	100,000	100,000
CONC	6"	100,000	100,000

SUB-BASE OF GRAVEL - Longs Pt - 8" (11) - 7%
SUB-BASE OF SAND - 7" (11) - 7%
BASE COURSE - 4" (11) - 7%
ROADWAY - 12" (11) - 7%
PAVEMENT - 1 1/2" (11) - 7%
CONCRETE - 6" (11) - 7%
PAVEMENT - 1 1/2" (11) - 7%
CONCRETE - 6" (11) - 7%
PAVEMENT - 1 1/2" (11) - 7%
CONCRETE - 6" (11) - 7%

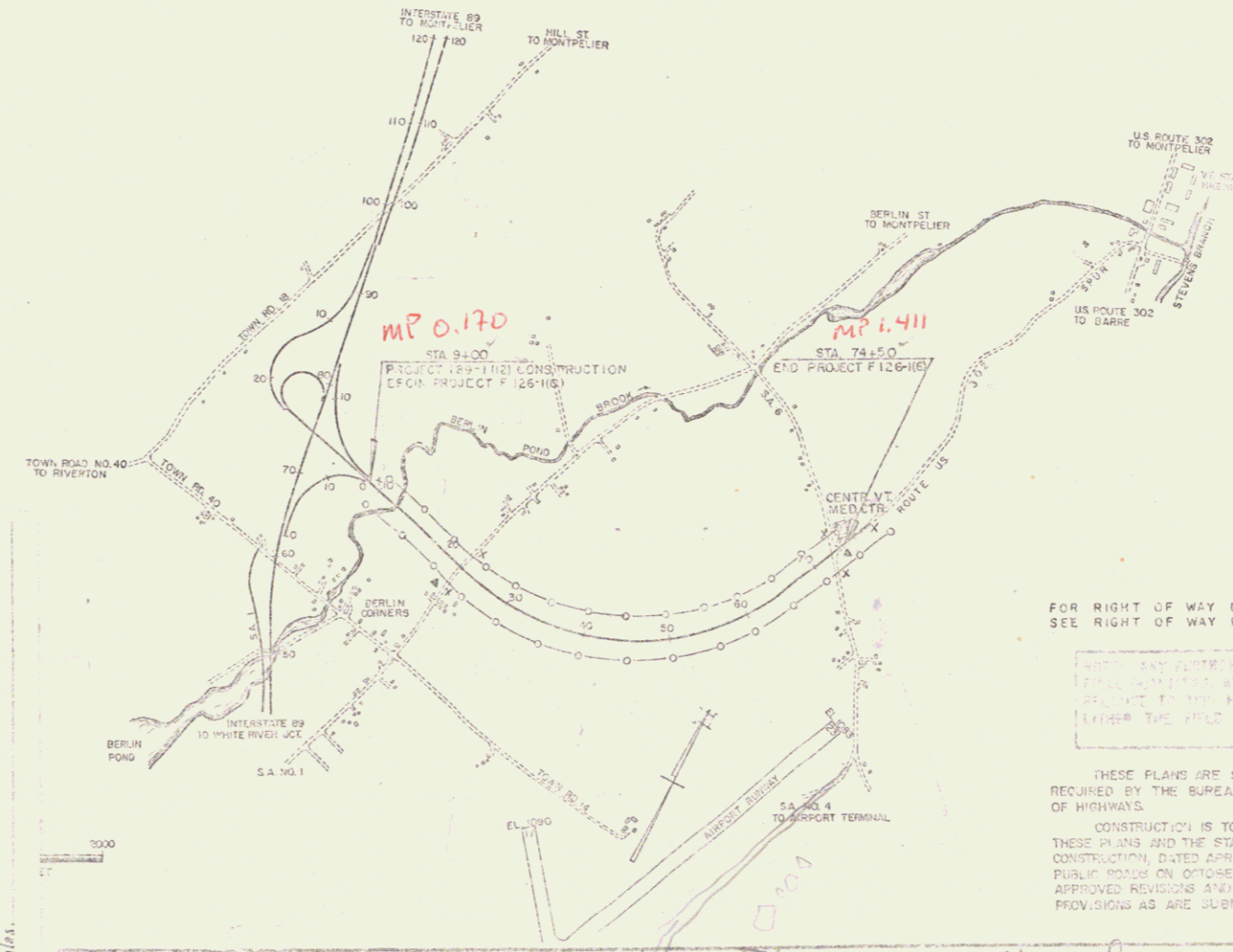

CONVENTIONAL SIGNS

RIGHT-OF-WAY	[Symbol]
SLOPE RIGHTS	[Symbol]
POINTS OF ACCESS	[Symbol]
LIMITED ACCESS	[Symbol]
COUNTY LINE	[Symbol]
TOWN LINE	[Symbol]
FENCE LINE	[Symbol]
STONE WALL	[Symbol]
UNFENCED PROPERTY	[Symbol]
GUARD RAIL	[Symbol]
TRAVELED WAY	[Symbol]
RAILROAD	[Symbol]
RETAINING WALL	[Symbol]
CENTER LINE	[Symbol]
SURVEY LINE	[Symbol]
CULVERT	[Symbol]
DRIVE INLET	[Symbol]
TROLLEY POLE	[Symbol]
POWER POLE	[Symbol]
TELEPHONE POLE	[Symbol]
TRUSS	[Symbol]
HEDGE	[Symbol]

F.A. CONSTRUCTION IDENTIFICATION SK

GROUND ELEVATION
GRADE ELEVATION
CURVE DATA
DEFLECTION OF ANGLE
DEGREE OF CURVE
RADIUS OF CURVE
TANGENT DISTANCE
LENGTH OF CURVE
EXTERNAL DISTANCE
POINT OF INTERSECTION
POINT OF CURVE
POINT OF TANGENT
POINT ON TANGENT
POINT ON CURVE

PROJECT - BERLIN (Stage 1)
NUMBER - F126-1(9)
TYPE - Miscellaneous Concrete Pavement
CONTRACTOR - Colleton's Sons & Gravel Co., Inc.
YEAR 1968
LOCATION - Beginning at a point 2.259 mi. westerly of the junction of Berlin State Hwy. & U.S. Rte. 302 and extending easterly 1.241 miles.

RIGHT-OF-WAY DIVISION
TOWN FILE

PERPETUAL
Town of ~~VT 62~~
(To Be Returned To R.O.W. Division)

FOR RIGHT OF WAY DETAILS FOR THIS PROJECT SEE RIGHT OF WAY PLANS FOR THIS PROJECT

THESE PLANS ARE SUBJECT TO SUCH REVISIONS AS MAY BE REQUIRED BY THE BUREAU OF PUBLIC ROADS OR THE COMMISSIONER OF HIGHWAYS.
CONSTRUCTION IS TO BE CARRIED ON IN ACCORDANCE WITH THESE PLANS AND THE STANDARD SPECIFICATIONS FOR HIGHWAY AND BRIDGE CONSTRUCTION, DATED APRIL 1964, AS APPROVED BY THE BUREAU OF PUBLIC ROADS ON OCTOBER 12, 1964 INCLUDING ALL SUBSEQUENT APPROVED REVISIONS AND SUCH REVISED SPECIFICATIONS AND SPECIAL PROVISIONS AS ARE SUBMITTED WITH THESE PLANS.

DEPARTMENT OF TRANSPORTATION
BUREAU OF PUBLIC ROADS

APPROVED: [Signature]	APPROVED: [Signature]	APPROVED: [Signature]	APPROVED: [Signature]	APPROVED: [Signature]	APPROVED: [Signature]
DATE: 3/27/68	DATE: 3/27/68	DATE: 3/27/68	DATE: 3/27/68	DATE: 3/27/68	DATE: 3/27/68

PROJECT: F NO 126-1(9)
SHEET 1 OF 99 SHEETS

* TREATED TIMBER CURB
ITEM 550
9+00 - 14+92' L
9+00 - 14+44' D

* Standard Steel Beam Guard
Rail w/ 3" Steel Posts Spaced 5'-0"
9+00 - 14+50' L
9+00 - 15+80' C

PROPERTY LINE FENCE
ITEM 580-II
9+00 - 19+00' L

* SLOPE EDGING
9+00 - 19+00' L

* DENOTES STAGE II ITEMS
Begin Protect
F 126-1(9) ST 19+00
9+00' 199'
9+92' 195'
Rev Ramp B
Δ 18°00' RT
D 4979.050'
R 1150.74'
T 182.26'
L 381.92'
E 14.34'
Bank 3/4' per ft

Rev Ramp A
Δ 40°57' RT
D 4424.05'
R 401.90'
T 236.29'
L 427.53'
E 64.47'
Bank 7/8' per ft

STOP [89-1] CONST
BEGIN F 126-1 AP
10+51' 150'

Topsoil Stockpile Area
16+75 to 20+00 at 10%
16+75 to 19+75 at 65%

BM 3-1
US Elev
997.143

BM 3-2
US Elev
998.043

BM 3-3
US Elev
998.323

BM 3-4
US Elev
997.207

PVI
121.50
600' VC
998.04

NOTE: GRADE IS CARRIED 8' RT OF E

cut to fill transition
10+20 - 10+90

CONTROL OF ACCESS IS COMPLETE ON THIS SHEET EXCEPT AT STA 9+00

STAGE II CONSTRUCTION
BERLIN F 126-1(9) 4P
SHEET 6 OF 62

2

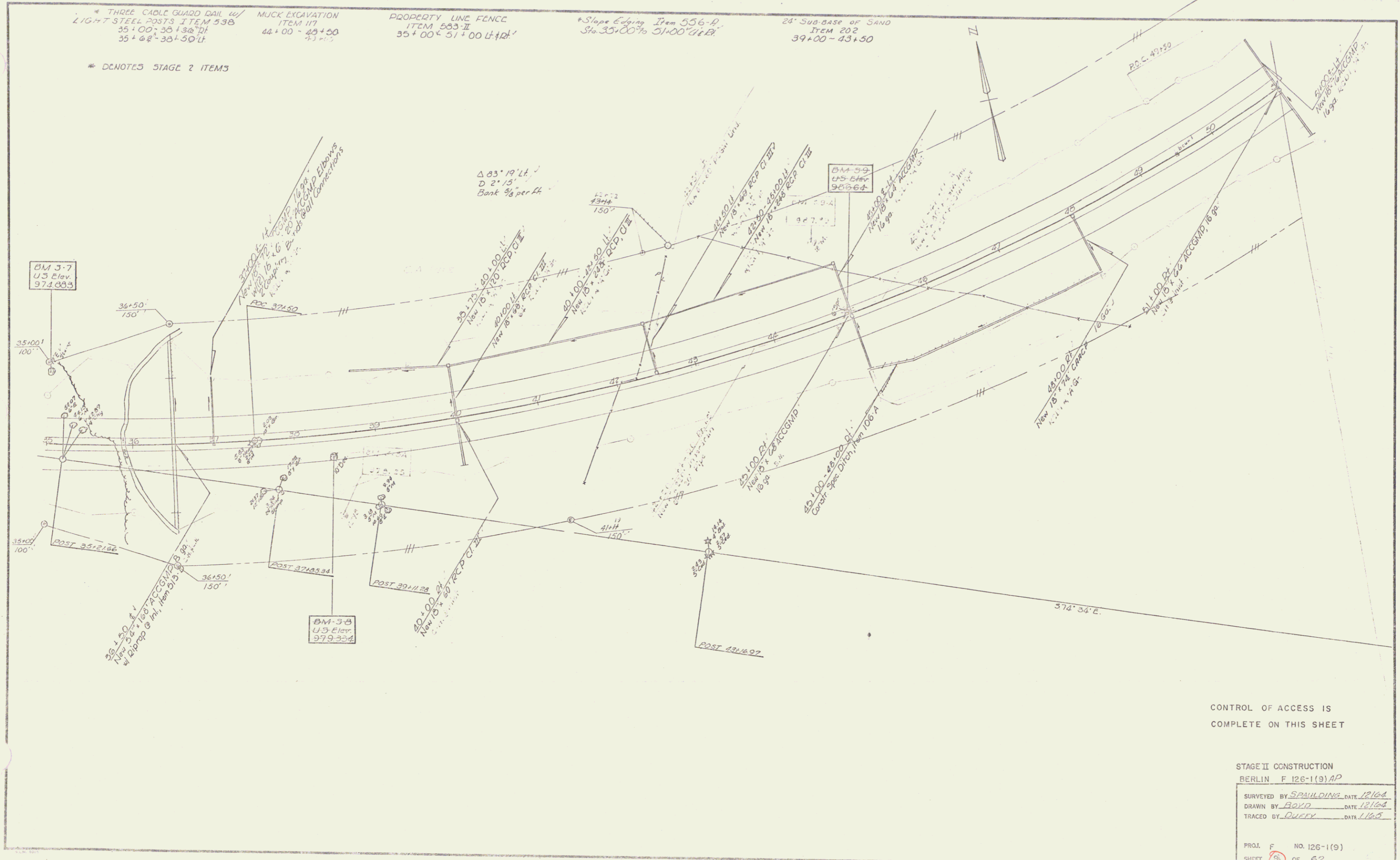

CONTROL OF ACCESS IS COMPLETE ON THIS SHEET

STAGE II CONSTRUCTION	
BERLIN F 126-1(9) AP	
SURVEYED BY SPALDING	DATE 12/64
DRAWN BY BOYD	DATE 12/64
TRACED BY QUEEY	DATE 1/65
PROJ. F	NO. 126-1(9)
SHEET 9	OF 52

Ending of diaphragm
Settled next to road
56+25 - 62+75

* Slope Edging Item 536-A
Sta. 51+00 to 62+00 1/4" ft.

BM 3-10
115 Elev
986.179

PROPERTY LINE FENCE
51+00 - 62+00 1/4" ft.

24' SUB BASE OF SAND
ITEM 202
54+00 - 62+00

BM 3-11A
115 Elev
985.61

BM 3-10-A
115 Elev
999.25

51+00 - 51+75 DI
Const. Spec. Ditch, Item 106-A

54+00
150'

56+00 - 62+00 DI
New 10' x 30' ACCOMP. B. & S. 1/4

58+00 - 62+00 DI
New 10' x 30' ACCOMP. B. & S. 1/4
W/ UNDERPASS BRG.

BM 3-11
115 Elev
1001.508

POST 60152.26

N 22° 07' E

372.32 E

INACCESS. DI
DI 52+70.80
46+31.70

Δ 83° 19' 14"
D 2' 10"
D 2546.48'
T 2765.53'
L 3702.98'
E 61.92'
bank 5/8 per ft.

CONTROL OF ACCESS IS
COMPLETE ON THIS SHEET

STAGE II CONSTRUCTION
BERLIN

SURVEYED BY SPAULDING DATE 12/104
DRAWN BY BOYD DATE 12/104
TRACED BY DUFFY DATE 1/105

PROJ. F NO. 125-1(9)AP
SHEET 11 OF 62

6

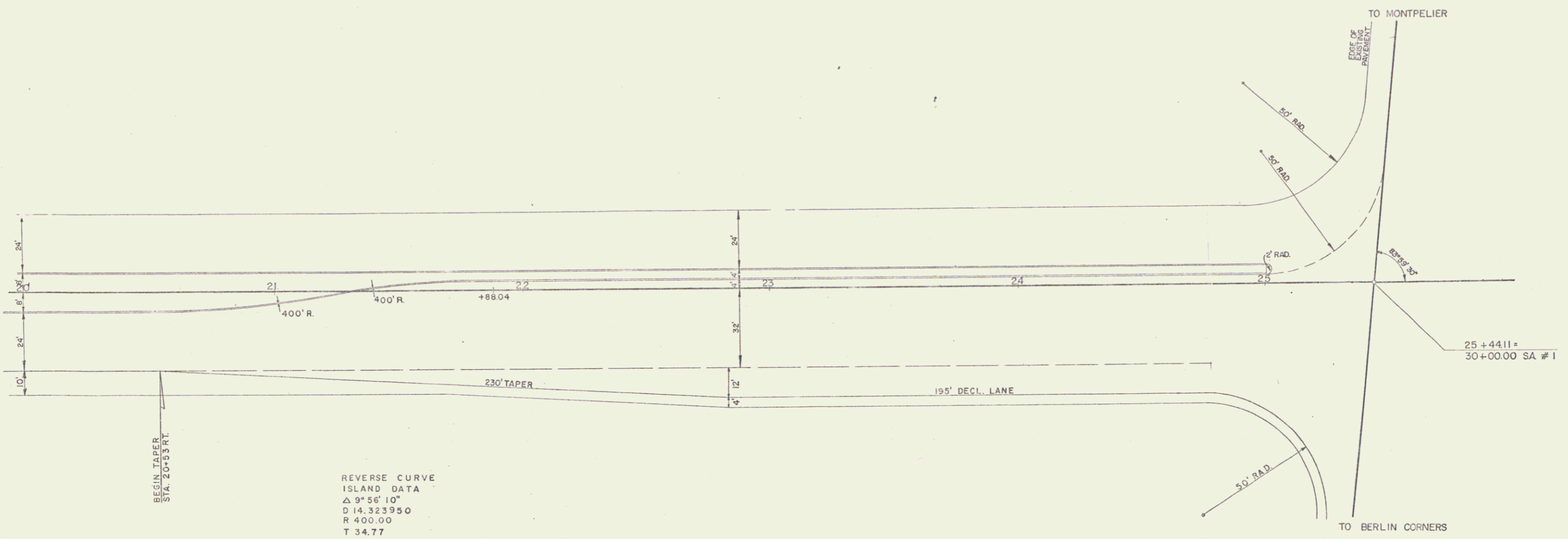

0 20 40
SCALE IN FEET

State 2 Construction
SAI INTERSECTION

BERLIN

SURVEYED BY: R.V.T. DATE: 11/65
DRAWN BY: A.J.A. DATE: 11/65
TRACED BY: DATE: 11/65

PROJ. F NO. 126-1(9)AP
SHEET 16 OF 62

8

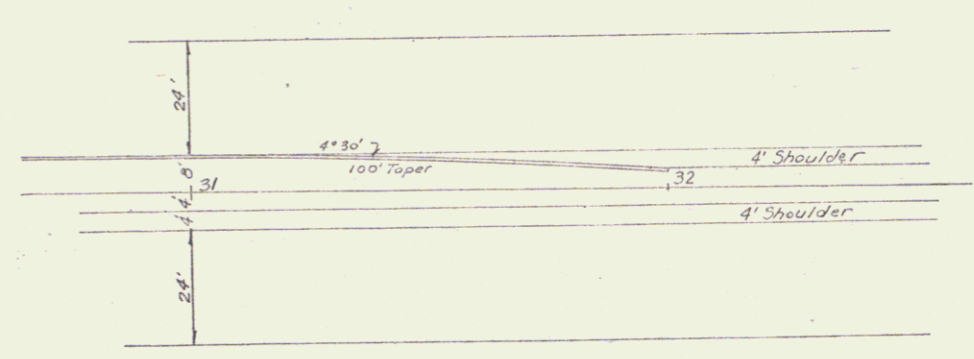
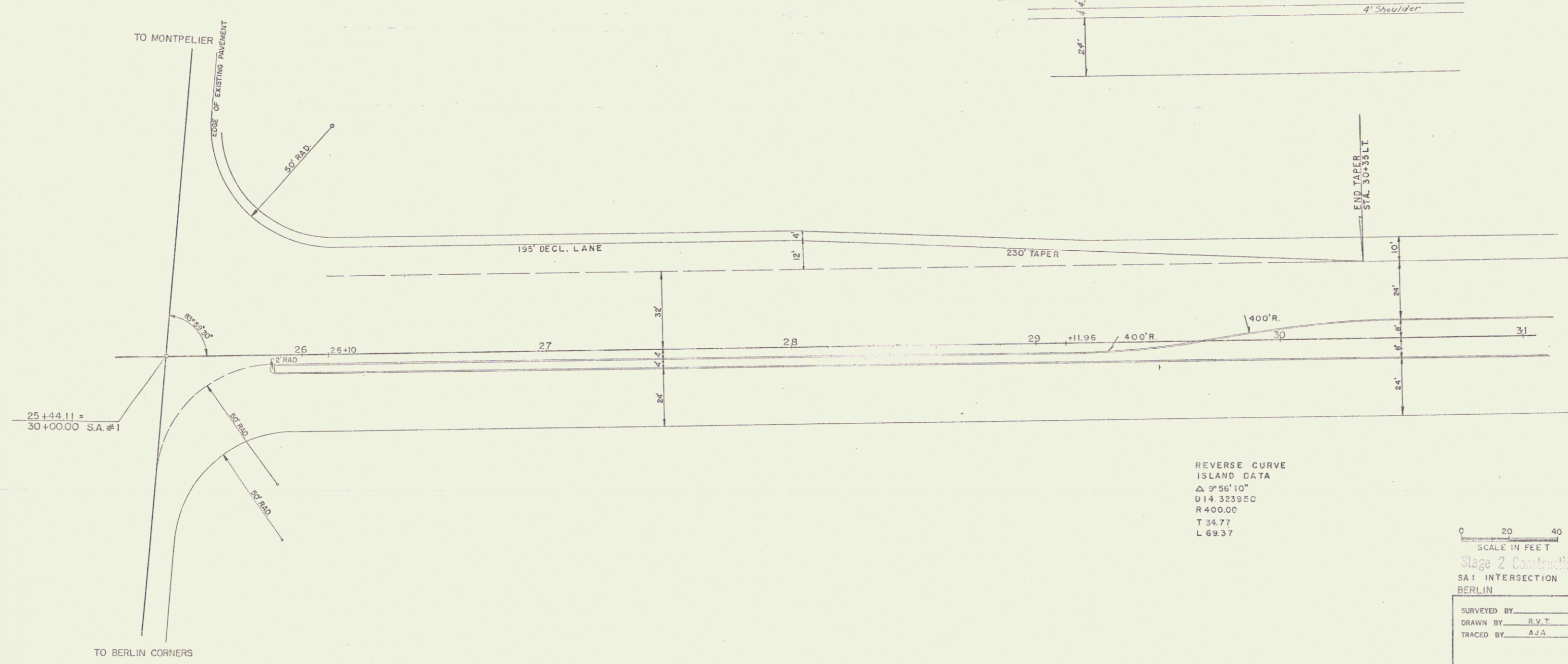

REVERSE CURVE
 ISLAND DATA
 Δ 9°56'10"
 D 14 323950
 R 400.00
 T 34.77
 L 69.37

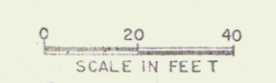

Stage 2 Construction
 SA 1 INTERSECTION (CONT.)
 BERLIN

SURVEYED BY	DATE
DRAWN BY R.V.T.	DATE 11/65
TRACED BY A.J.A.	DATE 11/65
PROJ. F No. 126-1(9)AP	
SHEET 17	OF 52

9

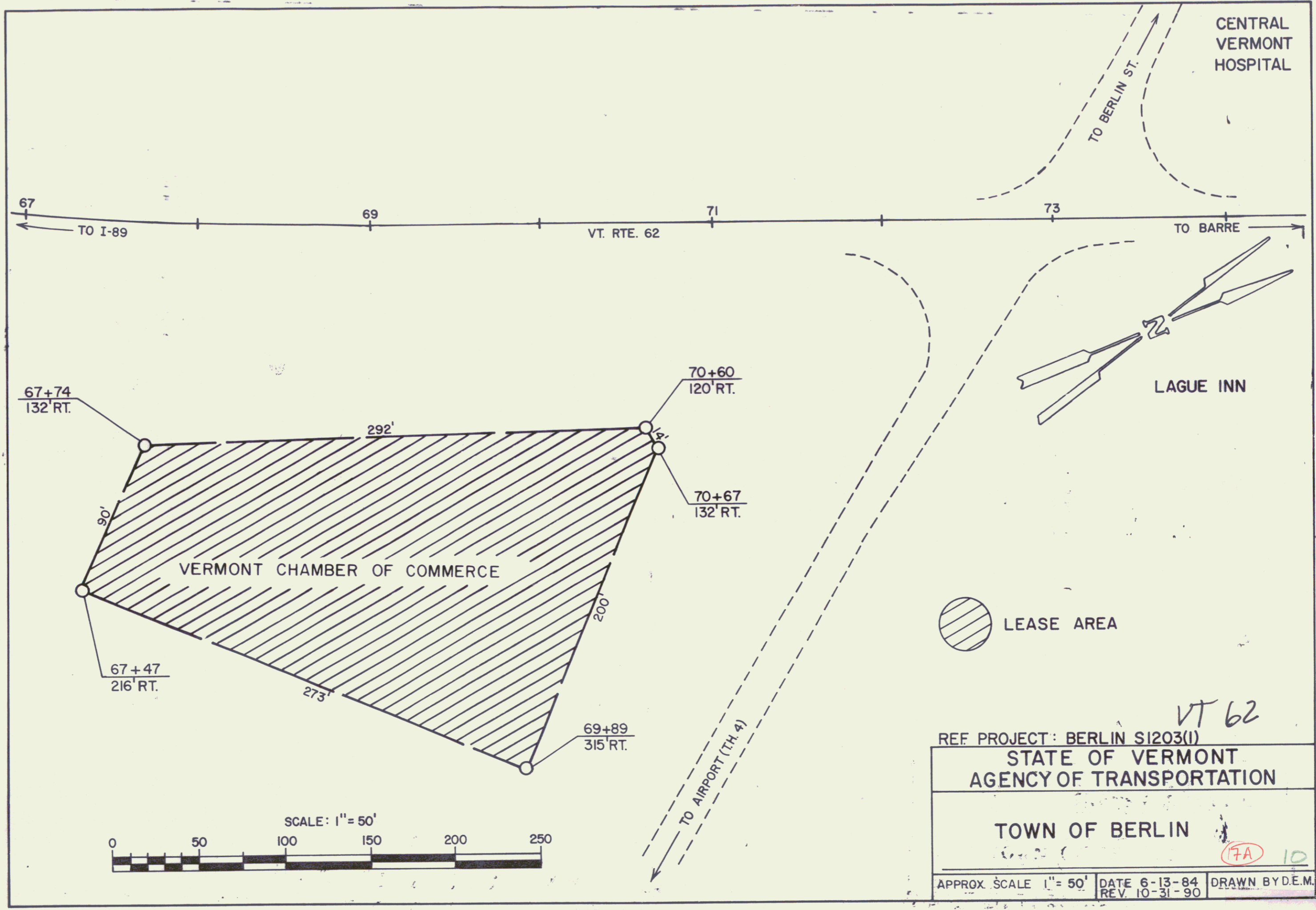

VT 62

REF PROJECT: BERLIN S1203(1)

STATE OF VERMONT
AGENCY OF TRANSPORTATION

TOWN OF BERLIN

APPROX. SCALE 1" = 50' DATE 6-13-84 DRAWN BY D.E.M.
REV. 10-31-90

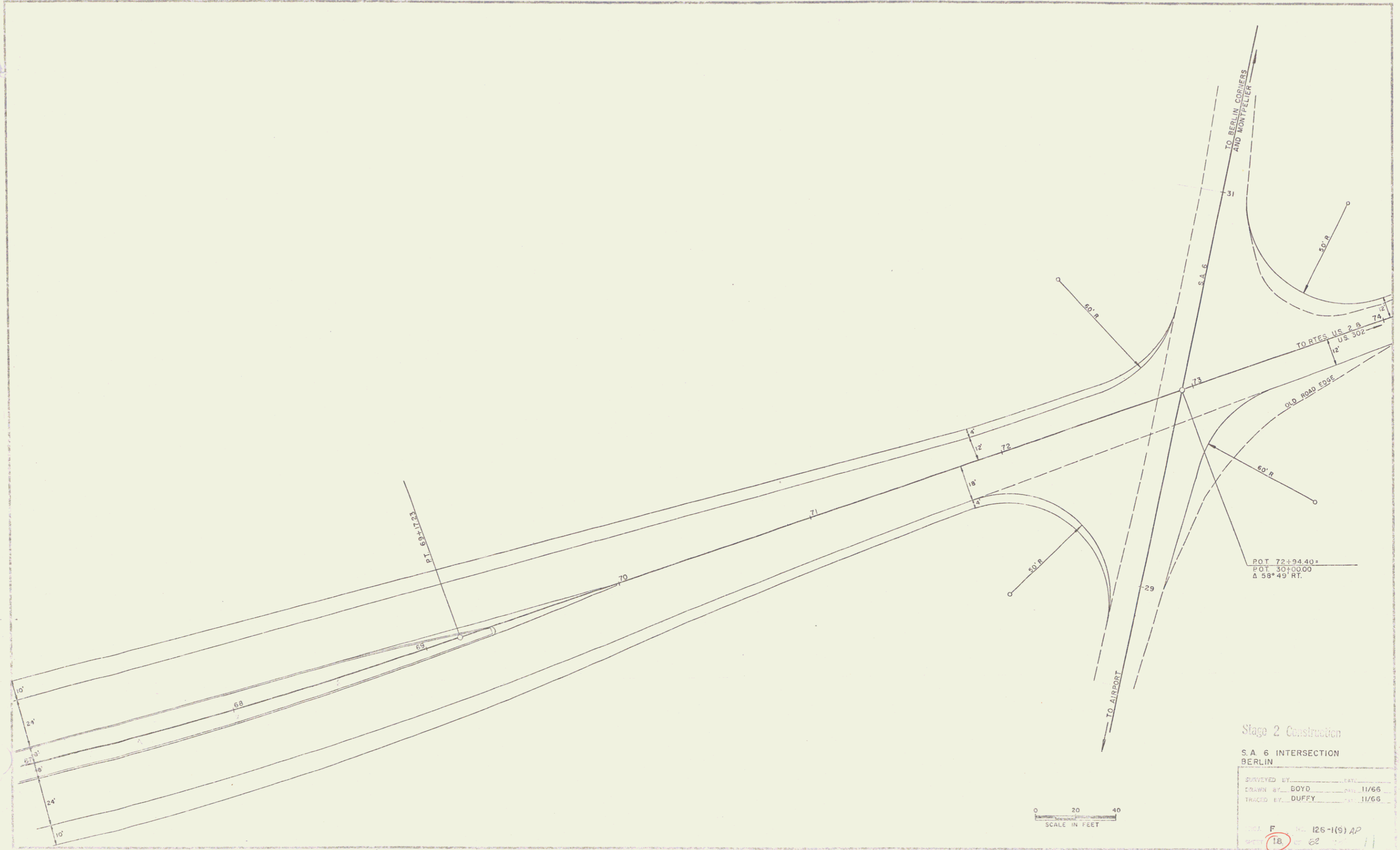

Stage 2 Construction
 S.A. 6 INTERSECTION
 BERLIN

SURVEYED BY: _____ DATE: _____
 DRAWN BY: BOYD DATE: 11/66
 TRACED BY: DUFFY DATE: 11/66

0 20 40
 SCALE IN FEET

126-1(S) AP
 18 22