

PLAN
 NO. 11/15
 DATE 12/85
 DRAWN BY
 CHECKED
 TRACED

PROFILE
 NO. 11/15
 DATE 12/85
 DRAWN BY
 CHECKED
 TRACED

TWO CABLE GUARD RAIL
 ITEM 54.1, 50
 T.H. 46 21+00 L.S. - 24+75 L.S.
 T.H. 46 21+00 R.S. - 24+66 R.S.
 20+00 L.S. - 22+26 R.S.

CONSTRUCT DRIVE
 25+10 - 25+50 L.S.
 25+79 L.S.
 26+10 L.S.
 26+50 R.S.

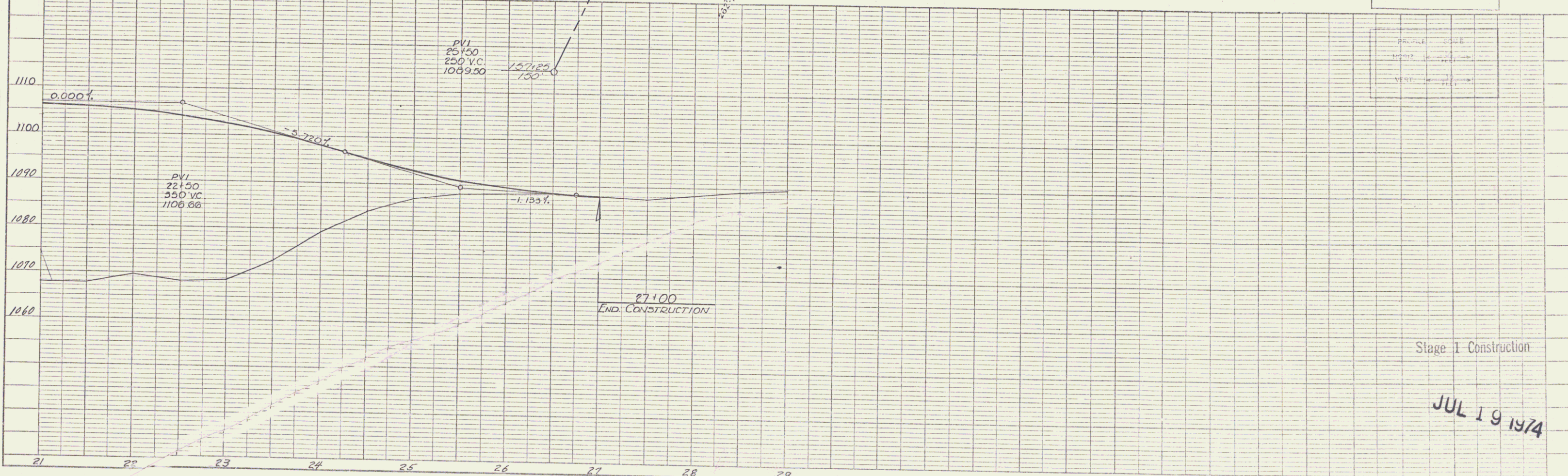
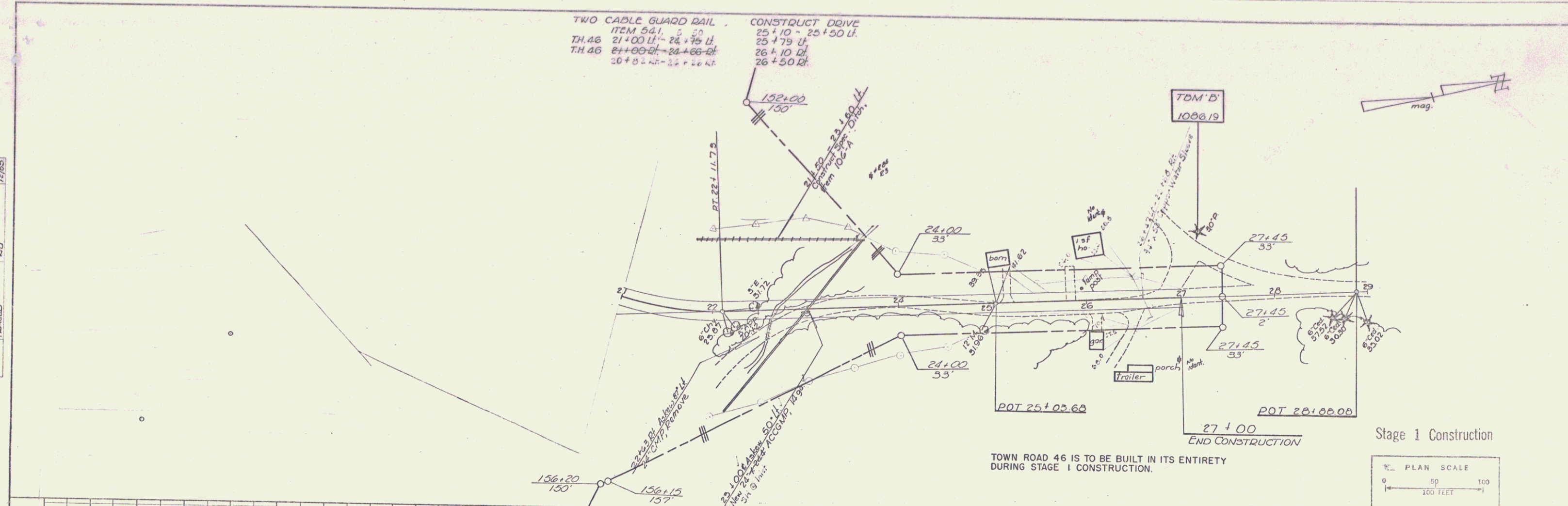

TOWN ROAD 46 IS TO BE BUILT IN ITS ENTIRETY DURING STAGE I CONSTRUCTION.

Stage I Construction

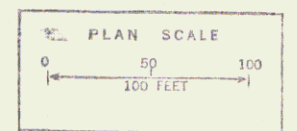

Stage I Construction

JUL 19 1974

PLATE 1, PLAN-PROFILE
 BERLIN-BARRE
 487018 IMPERIAL™

T.H. 46
 Berlin-Barre
 F137-1 (4)

SHEET 50 of 235

37