

PLAN  
 CHECKED BY  
 DATE  
 NO. OF SHEETS  
 NO. OF THIS SHEET

PROFILE  
 CHECKED BY  
 DATE  
 NO. OF SHEETS  
 NO. OF THIS SHEET

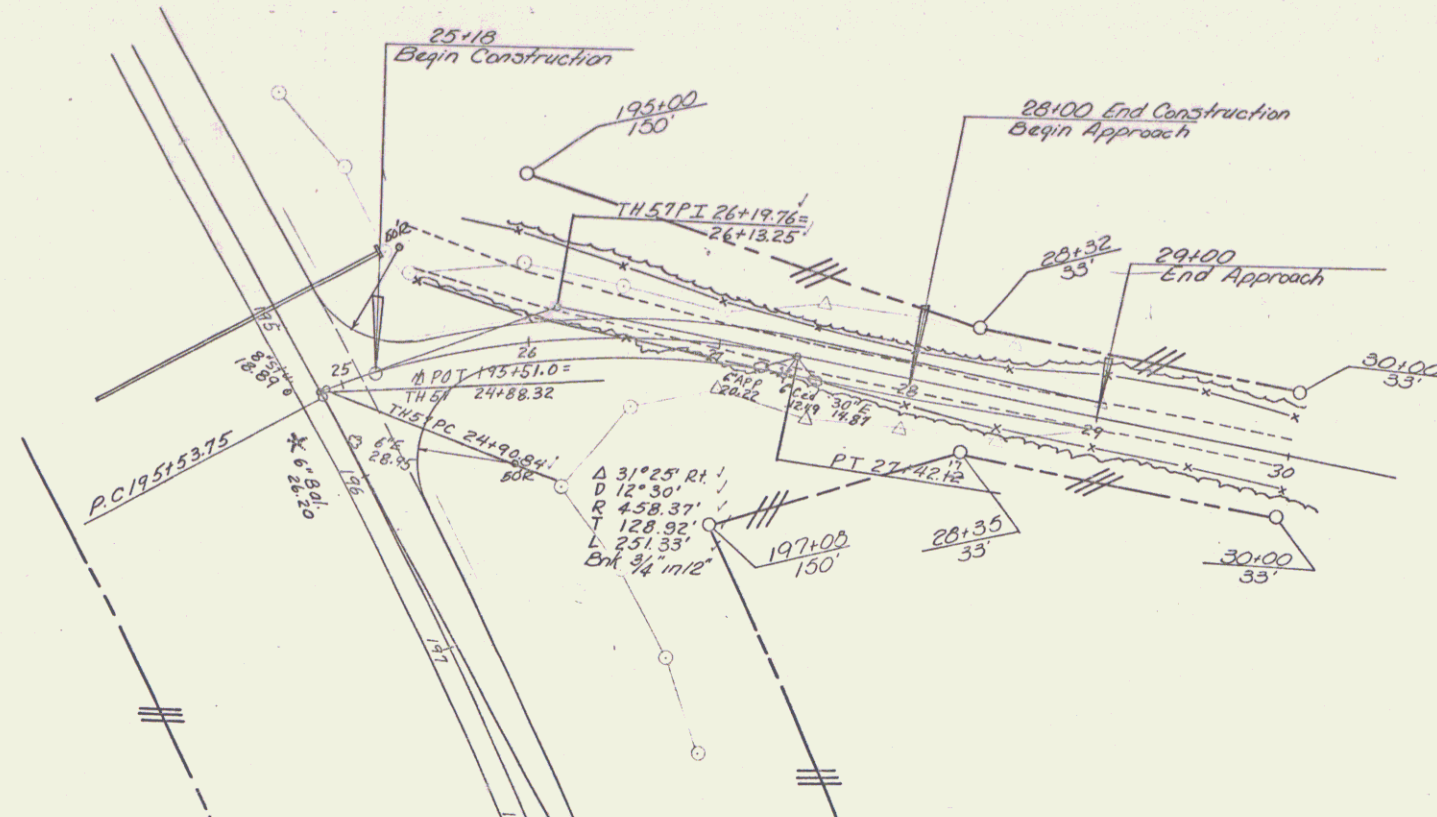

TOWN ROAD 57 IS TO BE BUILT IN ITS ENTIRETY DURING STAGE I CONSTRUCTION.

Stage 1 Construction

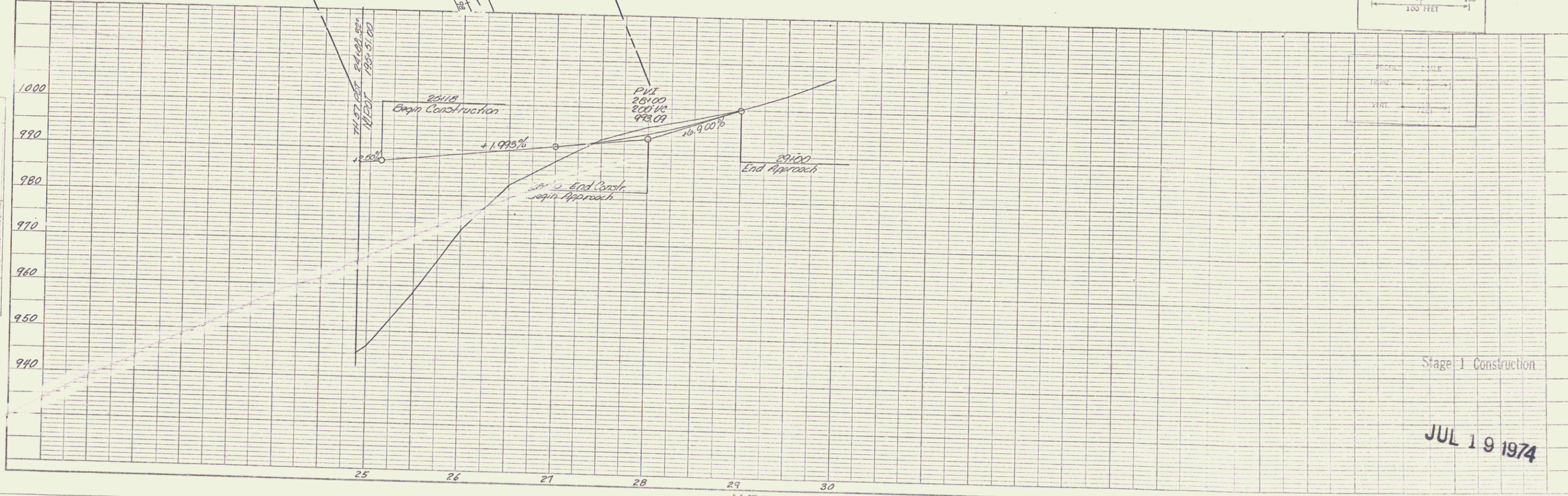
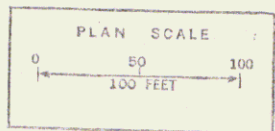

Stage 1 Construction

JUL 19 1974

PLATE 1, PLAN-PROFILE  
 K&E ENGINEERS & ARCHITECTS  
 48 7012 IMPERIAL TRADING OLIVE

TH 57 BERLIN-BARRE  
 F137-1(4)  
 SHEET 48 of 35