

PLAN
 NORTH
 SCALE
 DATE
 DRAWN BY
 CHECKED BY
 NO. OF SHEETS
 SHEET NO.

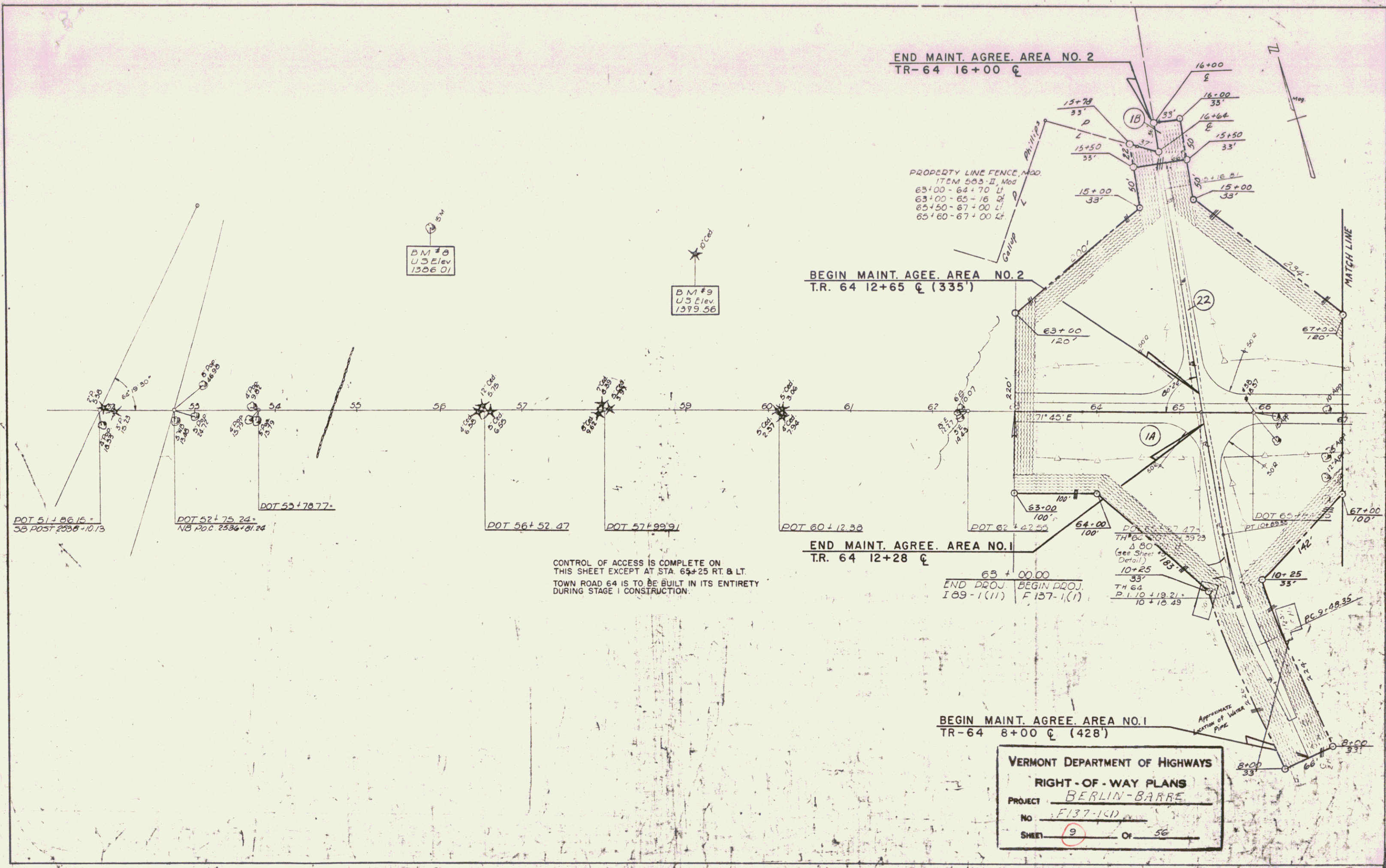

BM #8
 U.S. Elev.
 1306.01

BM #9
 U.S. Elev.
 1379.56

DOT 51+86.15
 SB POST 2006-10/13

DOT 52+75.24
 NB P.O.C. 2336-01/24

DOT 53+78.77

DOT 56+52.47

DOT 57+89.91

DOT 60+12.38

DOT 62+42.55

DOT 65+74.75

DOT 67+00

CONTROL OF ACCESS IS COMPLETE ON
 THIS SHEET EXCEPT AT STA. 63+25 RT. & LT.
 TOWN ROAD 64 IS TO BE BUILT IN ITS ENTIRETY
 DURING STAGE I CONSTRUCTION.

END MAINT. AGREE. AREA NO. 1
 T.R. 64 12+28 ±

63+00.00
 END PROJ. I 69-1(11)
 BEGIN PROJ. F 157-1(1)

BEGIN MAINT. AGREE. AREA NO. 1
 TR-64 8+00 ± (428')

VERMONT DEPARTMENT OF HIGHWAYS
 RIGHT-OF-WAY PLANS
 PROJECT BERLIN-BARRE
 NO. F137-1(1)
 SHEET 9 Of 56

SEP 26 1979