

NO. OF SHEETS

1 Title Page
2-3 Topographical Sections
4-5 Quantity Sheets
6-7 Change Sheets
8-12 Construction Sheets
13 Island Detail
14-27 Plan & Profile Sheets
28-37 Cross Sections

STATE OF VERMONT
DEPARTMENT OF HIGHWAYS

PROPOSED IMPROVEMENT

FEDERAL AID PROJECT

TOWNS OF BERLIN-BARRE
COUNTY OF WASHINGTON
ACCESS ROAD-INTERSTATE 89 TO SOUTH BARRE

BEGINNING AT A POINT 0.032 MILES WESTERLY
OF THE JUNCTION OF VERMONT ROUTE 14 AND
EXTENDING WESTERLY 3.655 MILES.

LENGTH OF ROADWAY 19,143.00 FEET = 3.625 MILES
LENGTH OF BRIDGE 157.00 FEET = 0.030 MILES
LENGTH OF PROJECT 19,300.00 FEET = 3.655 MILES

ADT 1965 1560-1620
ADT 1987 3720-3800
DHV 1987 560-570
D 55%
T 10%
V 50MPH

ROW PLANS

*MAINT AGREEMENT
9-26-79*

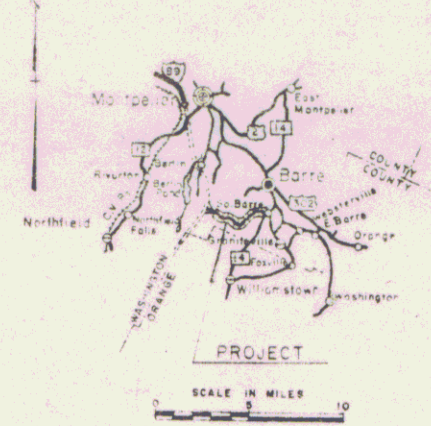

Access Rd. to South Barre

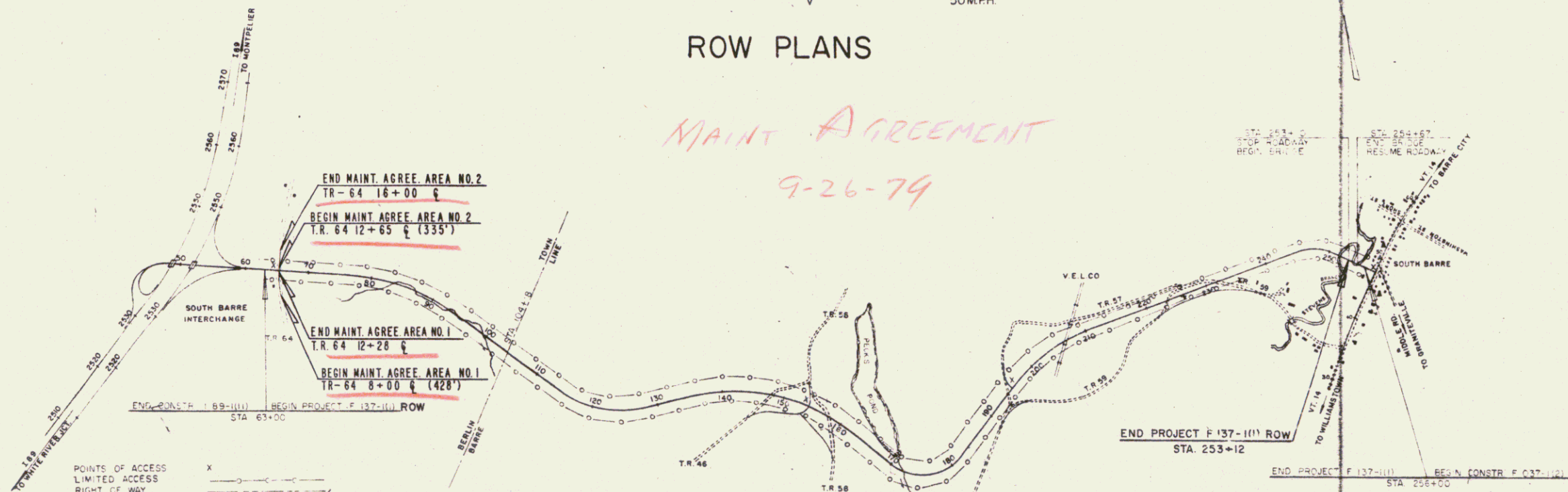

- CONVENTIONAL SIGNS
- TRAVELED WAY
 - RAILROAD
 - RETAINING WALL
 - CENTER LINE
 - SURVEY LINE
 - CULVERT
 - DROP INLET
 - TROLLEY POLE
 - POWER POLE
 - TELEPHONE POLE
 - TREES
 - WEDG.
- POINTS OF ACCESS
- LIMITED ACCESS
 - RIGHT OF WAY
- SLOPE RIGHTS
- GROUND ELEVATION
- GRADE ELEVATION
- CURVE DATA
- DEFLECTION OF ANGLE
 - DEGREE OF CURVE
 - RADIUS OF CURVE
 - TANGENT DISTANCE
 - LENGTH OF CURVE
 - EXTERNAL DISTANCE
 - POINT OF INTERSECTION
 - POINT OF CURVE
 - POINT OF TANGENT
 - POINT ON TANGENT
 - POINT ON SUB-TANGENT
- FEDERAL AID CONSTRUCTION IDENTIFICATION SIGNS

SCALE IN FEET
0 1000 2000 3000

THESE PLANS ARE SUBJECT TO SUCH REVISIONS AS MAY BE
REQUIRED BY THE BUREAU OF PUBLIC ROADS OR THE COMMISSIONER
OF HIGHWAYS.
CONSTRUCTION IS TO BE CARRIED ON IN ACCORDANCE WITH
THESE PLANS AND THE STANDARD SPECIFICATIONS FOR HIGHWAY
AND BRIDGE CONSTRUCTION DATED APRIL 1964, AS APPROVED BY
THE BUREAU OF PUBLIC ROADS ON OCT. 12, 1964, INCLUDING ALL
SUBSEQUENT APPROVED REVISIONS AND SUCH REVISED
SPECIFICATIONS AND SPECIAL PROVISIONS AS ARE INCORPORATED IN
THESE PLANS.

STAGE I CONSTRUCTION

APPROVED <i>H.P. Redigan</i> ROW DIRECTOR DATE <i>Sept 8-1966</i>	APPROVED <i>R.H. Crowl</i> ASST. CHIEF ENGINEER DATE <i>11/5/65</i>	APPROVED <i>C.F. Stebbins</i> CONTRACTOR-IN-CHARGE DATE <i>11/5/65</i>	APPROVED <i>Paul Ryan</i> ASST. ENGINEER DATE <i>11/5/65</i>	APPROVED <i>R.F. Taylor</i> DISTRICT ENGINEER DATE <i>11/9/65</i>	APPROVED <i>G.W. Deane</i> HIGHWAY ENGINEER DATE <i>11/9/65</i>	APPROVED <i>A.D. Nichols</i> CHIEF ENGINEER DATE <i>11/5/65</i>	PROJECT NO. 137-1(1) SHEET PA 3 SHEETS 36
---	---	--	--	---	---	---	--

SEP 26 1979