

PARCEL INSTRUMENT DATE GRANTOR GRANTEE RECORDED REMARKS
 A W.D.O.E. 4-29-40 FRANK A. LUTHER & RENA LUTHER ST OF VT BOOK 13 PAGE 229 DATE 4-29-40

FED. ROAD DIST. NO. STATE FISCAL YEAR SHEET TOTAL
 9 VI. 192 L 5 5

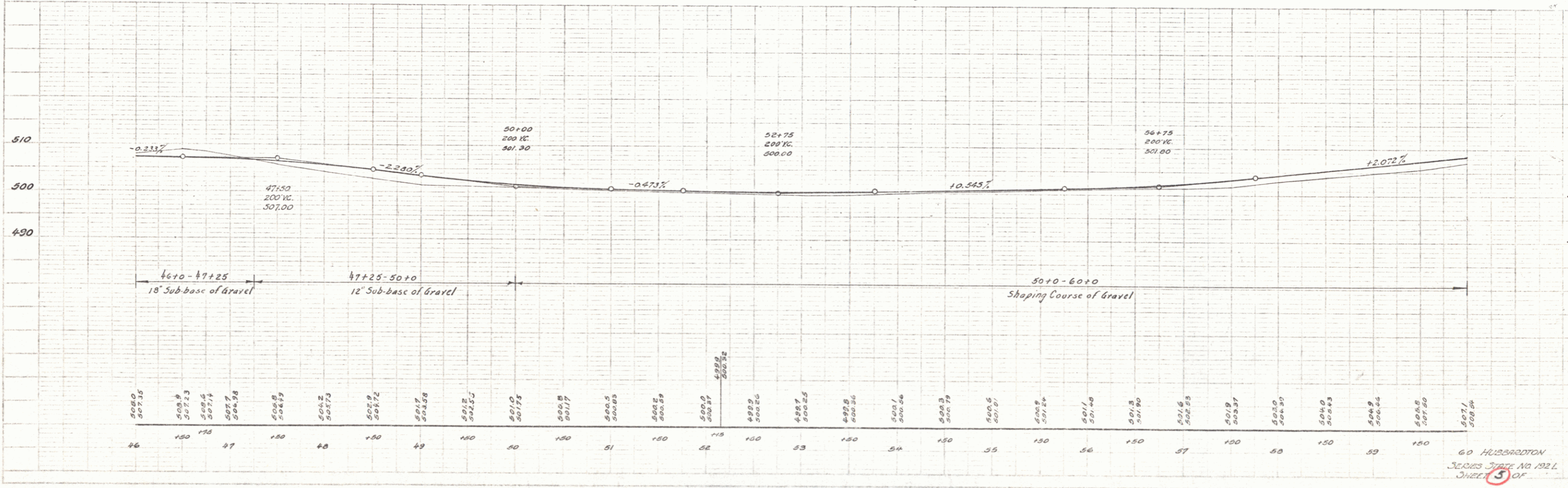
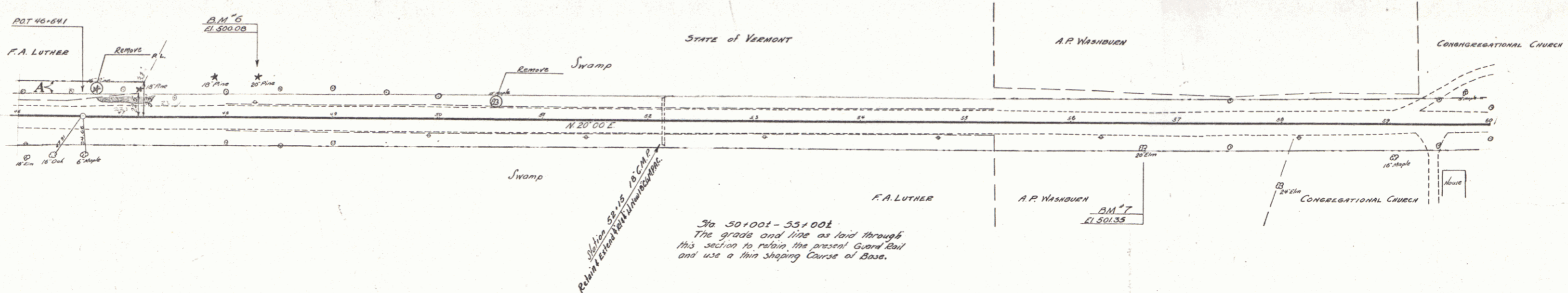

60 HUBBARDTON
 SERIES STATE NO 192 L
 SHEET 3 OF