

INDEX OF SHEETS

SHEET NO. 1	TITLE PAGE
" 2	TYPICAL CROSS-SECTION OF IMPROVEMENT (GRADING, BASE & DRAINAGE WITH GUARD RAIL AND DOUBLE TRACK COAT OF REFINED TFR-11274 23)
" 3	BANKING AND WIDENING TABLES
" 4-7	PLAN AND PROFILE SHEETS
" 8	STANDARD STRUCTURE SHEET 520; PIPE CULVERTS
" 9	" " " 530; GUARD RAIL
" 10	" " " 531; BOUNDARY MARKERS
" 11	" " " 540; BARRICADES, SIGNS & LIGHTS
" 12-23	CROSS-SECTION SHEETS

Standard Structure Sheet 520 approved by the Chief Engineer on July 11, 1933.

Standard Structure Sheet 530 approved by the Chief Engineer on Aug. 15, 1933.

Standard Structure Sheet 531 approved by the Chief Engineer on July 25, 1934.

STATE OF VERMONT
STATE HIGHWAY DEPARTMENT

PLAN AND PROFILE OF PROPOSED
STATE HIGHWAY
U.S. WORKS PROGRAM STATE SECONDARY PROJECT (W.P.S.S. 192A)

TOWN OF HUBBARDTON
CASTLETON-HUBBARDTON ROAD

BEGINNING AT THE CASTLETON-HUBBARDTON TOWN LINE,
AND EXTENDING NORTHERLY 0.792 MILES.

LENGTH OF PROJECT 4182.0 FT. = 0.792 MILES
LENGTH OF EXTENSION 4500 FT. = 0.085 MILES

FED. ROAD DIST. NO.	STATE	W.P.S.S. PROJ. NO.	FISCAL YEAR	SHEET NO.	TOTAL SHEETS
9	Vt.	192A	1934	1	23

Route **430**
Project **WPSS192A**
Pin **00R 384**
Date **10/28/1935**

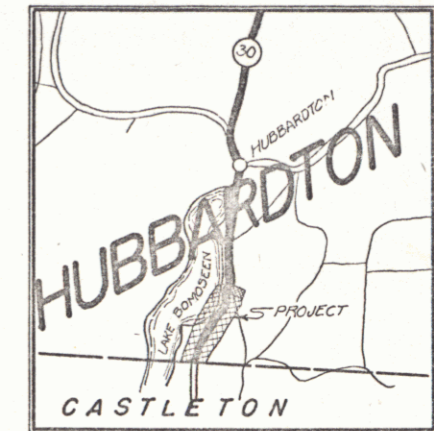

R.I.C.W. DIVISION
TOWN FILE
PERPETUAL
Rte. No. of **430**
(To Be Returned To R.O.W. Division)

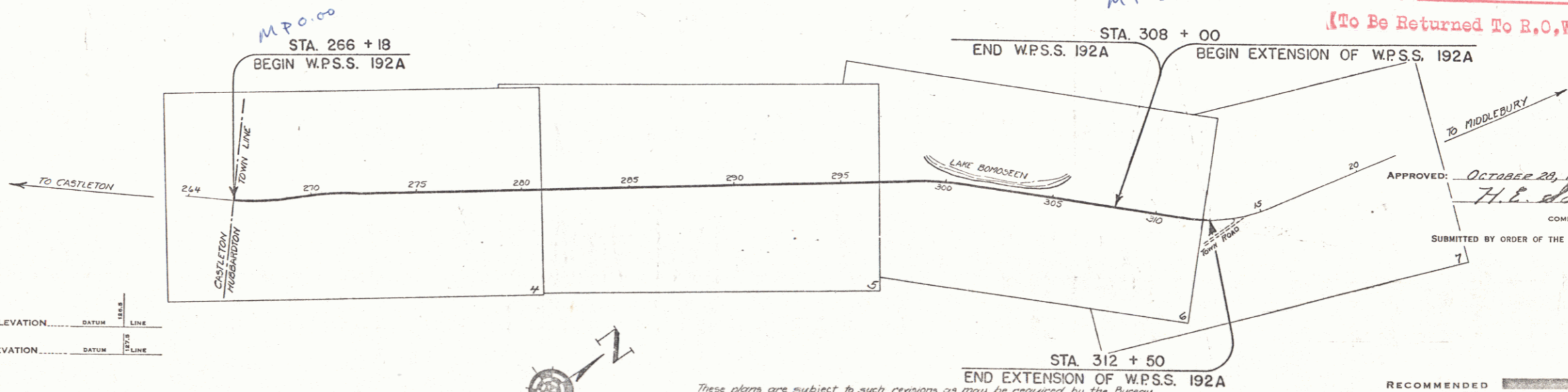

APPROVED: *October 28, 1935*
H. E. Dargent
COMMISSIONER OF HIGHWAYS
SUBMITTED BY ORDER OF THE STATE HIGHWAY BOARD

CONVENTIONAL SIGNS

COUNTY LINE	-----
TOWN LINE	-----
FENCE LINE	-----
STONE WALL	-----
UNFENCED PROPERTY	-----
GUARD RAIL	-----
TRAVELED WAY	-----
RAILROAD	-----
RETAINING WALL	-----
CENTER LINE	-----
SURVEY LINE	-----
CULVERT	-----
DROP INLET	-----
TROLLEY POLE	-----
POWER POLE	-----
TELEPHONE POLE	-----
TREES	-----
HEDGE	-----

CURVE DATA

DEFLECTION ANGLE Δ
DEGREE OF CURVE D
RADIUS OF CURVE R
TANGENT DISTANCE T
LENGTH OF CURVE L
EXTERNAL DISTANCE E
POINT OF INTERSECTION P. I.
POINT OF CURVE P. C.
POINT OF TANGENT P. T.
POINT ON TANGENT P. O. T.

SCALES

TITLE	1" = 300'
TYPICAL	1" = 2'
PLAN	1" = 50'
PROFILE	HOR. 1" = 10'
CROSS SECTIONS	1" = 5'

These plans are subject to such revisions as may be required by the Bureau of Public Roads or the Commissioner of Highways. Construction is to be carried on in accordance with the plans and Standard Road and Bridge Specifications of 1930, including all subsequent approved revisions, and such revised specifications and special provisions as are submitted with the plans. Attention of the contractor is called to the fact that the State Highway Board reserves the right to extend this project at the same contract prices. Said cost of extension not to exceed 25% of the amount of the contract.

RECOMMENDED _____
DISTRICT ENGINEER BUREAU OF PUBLIC ROADS
RECOMMENDED FOR APPROVAL _____
CHIEF ENGINEER BUREAU OF PUBLIC ROADS
APPROVED _____
DIRECTOR - BUREAU OF PUBLIC ROADS

CORRECT: *October 28, 1935*
G. J. ...
ROAD ENGINEER

SERIES W.P.S.S. NO. 192A FILED
SHEET 1 OF 23

DIST. #3 PLANS