

INDEX OF SHEETS

SHEET NUMBER	TITLE PAGE
1	TITLE PAGE
2	TYPICAL CROSS SECTION OF IMPROVEMENT (DOUBLE TACK COAT OF BITUMINOUS MATERIAL WITH PEA STONE AND STONE GRITS SEAL) (PRIME COAT OF REFINED TAR AND DOUBLE SEAL COAT OF CUTBACK ASPHALT, ITEM 315)
3	QUANTITY SHEET (ITEM & DRAINAGE)
4	EARTHWORK SHEET
5	DETAILS OF 15'-10" x 9'-10" COMPPA AT STA. 19+65
6-8	CHANNEL SECTIONS
9	RS 56-1
10	RS 56-3
11	RS 56-4
12	RS 56-6
13	RS 56-10
14	RS 56-12
15	PLAN & PROFILE
16-20	CROSS SECTIONS

PROJECT NAME & NUMBER	TYPE	PAVEMENT AREA
CASTLETON - DS-0161(1)	3" CRUSHED GRAVEL PLANT MIXED DOUBLE TACK COAT OF BITUMINOUS MATERIAL WITH PEA STONE AND STONE GRITS SEAL, PRIME COAT OF REFINED TAR, AND DOUBLE SEAL COAT OF CUTBACK ASPHALT	3195 s.y.

RECORD PLANS  
MATERIALS

SUBBASE OF GRAVEL - GREER PIT - POULTNEY, VERMONT.  
 CRUSHED GRAVEL (PLANT MIXED) - VT. MARBLE CO. - FLORENCE, VERMONT.  
 CUTBACK ASPHALT - SUGCONY - E. PROVIDENCE, RHODE ISLAND.  
 REFINED TAR - KOPPER PRODUCTS CO. - EVERETT, MASS.  
 ACCUMETAL PIPE - NORTH EASTERN CULVERT CO. - WESTMINSTER, VT.  
 RIPRAP - NORTHTRUP SLATE QUARRY - CASTLETON, VT.  
 T/WO CABLE GUARD RAIL - BETHLEHEM STEEL CO. (GARRONS PT. MD.)  
 WOOD GUIDE POSTS - S. T. GIBSWOLD CO. - ESSEX JUNCTION, VERMONT.  
 CONTRACTOR - EARL & MERRY  
 RESIDENT ENGINEER - ROBERT ARONSON  
 RECORD PLANS - A.G. SPIDLE  
 CONTRACT DATE - NOVEMBER 20, 1958  
 CONTRACT STARTED - DECEMBER 8, 1958  
 CONTRACT COMPLETED - JULY 10, 1959  
 CONTRACT ACCEPTED - JULY 10, 1959.

STATE OF VERMONT  
DEPARTMENT OF HIGHWAYS

PROPOSED IMPROVEMENT

FEDERAL AID SECONDARY

TOWN OF CASTLETON  
COUNTY OF RUTLAND  
VERMONT ROUTE # 30  
POULTNEY-MIDDLEBURY ROAD

BEGINNING AT A POINT APPROXIMATELY 3.5 MILES NORTHERLY OF THE INTERSECTION OF VERMONT ROUTE # 30 AND U.S. ROUTE # 4 IN THE HAMLET OF CASTLETON CORNERS AND EXTENDING NORTHERLY 0.227 MILES.

LENGTH OF PROJECT 1198.0' FEET = 0.227 MILES

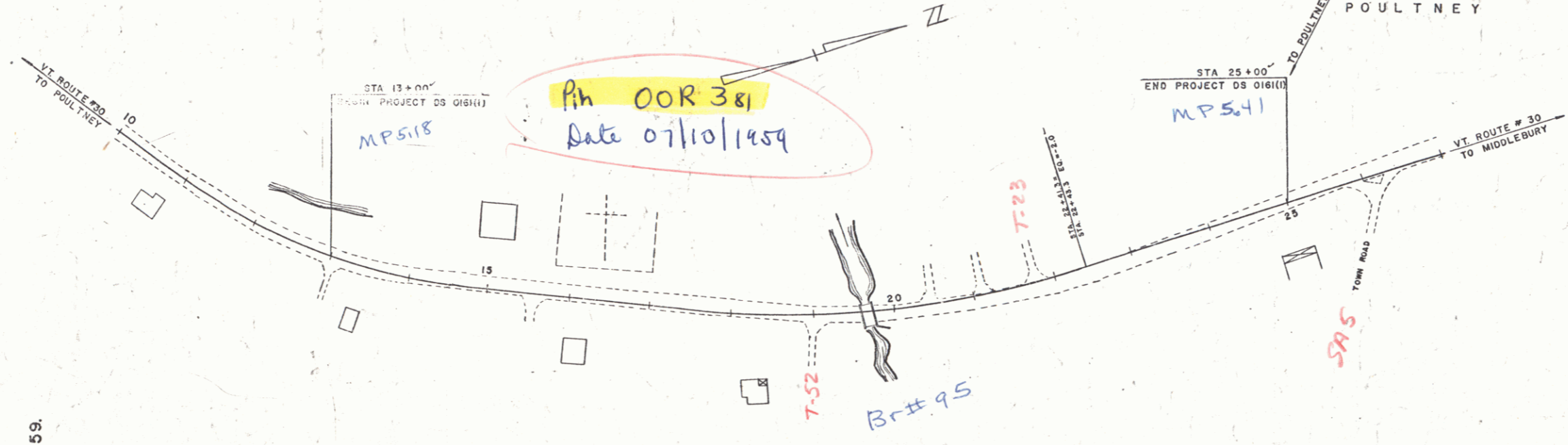
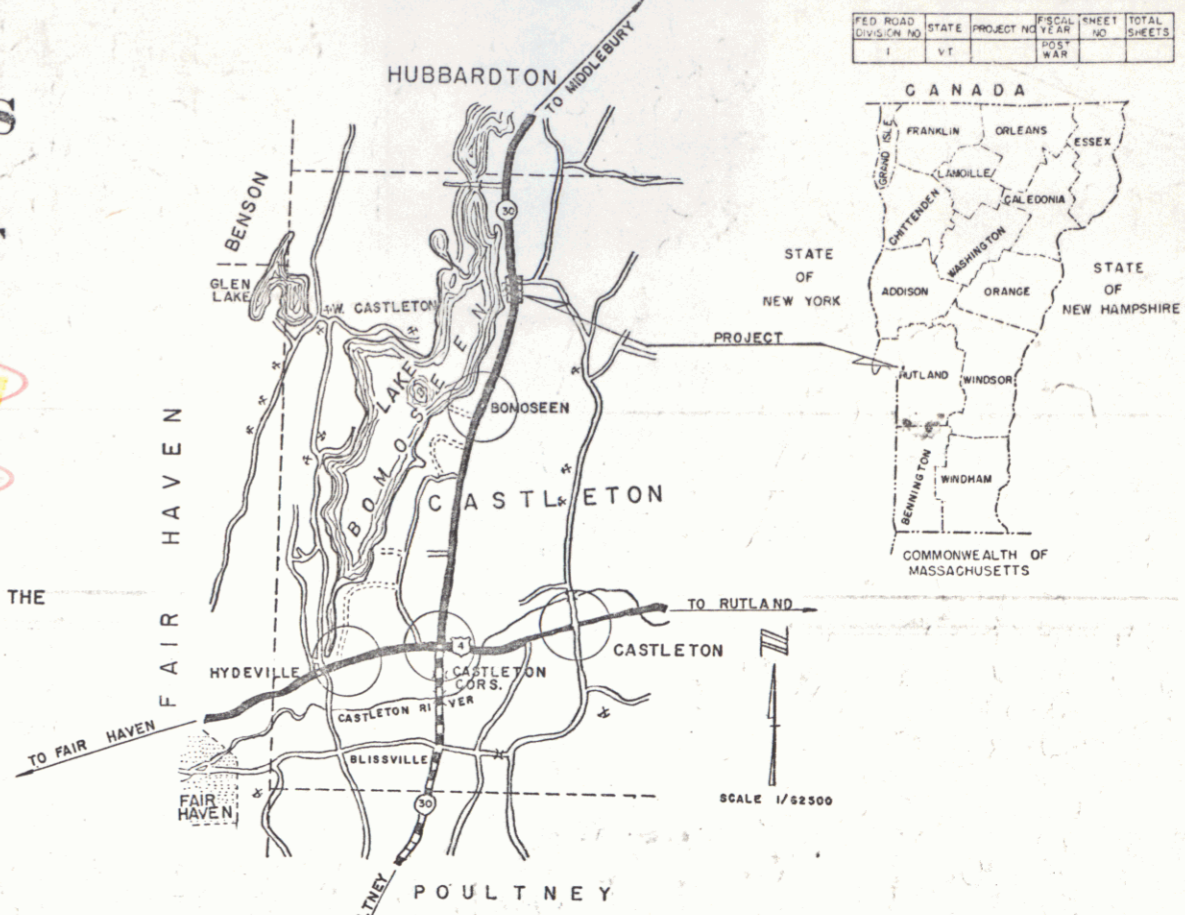

ITEM	QUANTITY	UNIT	PRICE	TOTAL
1. Double tacked coat of bituminous material with pea stone and stone grits seal, prime coat of refined tar and double seal coat of cutback asphalt.	3195	S.Y.		
2. 3" Crushed gravel plant mixed.		S.Y.		
3. Cutback asphalt.		S.Y.		
4. Refined tar.		S.Y.		
5. Accumetal pipe.		LINEAL FEET		
6. Riprap.		CY		
7. Two cable guard rail.		LINEAL FEET		
8. Wood guide posts.		NO.		

ITEM	QUANTITY	UNIT	PRICE	TOTAL
1. Double tacked coat of bituminous material with pea stone and stone grits seal, prime coat of refined tar and double seal coat of cutback asphalt.	3195	S.Y.		
2. 3" Crushed gravel plant mixed.		S.Y.		
3. Cutback asphalt.		S.Y.		
4. Refined tar.		S.Y.		
5. Accumetal pipe.		LINEAL FEET		
6. Riprap.		CY		
7. Two cable guard rail.		LINEAL FEET		
8. Wood guide posts.		NO.		

ITEM	QUANTITY	UNIT	PRICE	TOTAL
1. Double tacked coat of bituminous material with pea stone and stone grits seal, prime coat of refined tar and double seal coat of cutback asphalt.	3195	S.Y.		
2. 3" Crushed gravel plant mixed.		S.Y.		
3. Cutback asphalt.		S.Y.		
4. Refined tar.		S.Y.		
5. Accumetal pipe.		LINEAL FEET		
6. Riprap.		CY		
7. Two cable guard rail.		LINEAL FEET		
8. Wood guide posts.		NO.		

ITEM	QUANTITY	UNIT	PRICE	TOTAL
1. Double tacked coat of bituminous material with pea stone and stone grits seal, prime coat of refined tar and double seal coat of cutback asphalt.	3195	S.Y.		
2. 3" Crushed gravel plant mixed.		S.Y.		
3. Cutback asphalt.		S.Y.		
4. Refined tar.		S.Y.		
5. Accumetal pipe.		LINEAL FEET		
6. Riprap.		CY		
7. Two cable guard rail.		LINEAL FEET		
8. Wood guide posts.		NO.		

ITEM	QUANTITY	UNIT	PRICE	TOTAL
1. Double tacked coat of bituminous material with pea stone and stone grits seal, prime coat of refined tar and double seal coat of cutback asphalt.	3195	S.Y.		
2. 3" Crushed gravel plant mixed.		S.Y.		
3. Cutback asphalt.		S.Y.		
4. Refined tar.		S.Y.		
5. Accumetal pipe.		LINEAL FEET		
6. Riprap.		CY		
7. Two cable guard rail.		LINEAL FEET		
8. Wood guide posts.		NO.		

ITEM	QUANTITY	UNIT	PRICE	TOTAL
1. Double tacked coat of bituminous material with pea stone and stone grits seal, prime coat of refined tar and double seal coat of cutback asphalt.	3195	S.Y.		
2. 3" Crushed gravel plant mixed.		S.Y.		
3. Cutback asphalt.		S.Y.		
4. Refined tar.		S.Y.		
5. Accumetal pipe.		LINEAL FEET		
6. Riprap.		CY		
7. Two cable guard rail.		LINEAL FEET		
8. Wood guide posts.		NO.		

ITEM	QUANTITY	UNIT	PRICE	TOTAL
1. Double tacked coat of bituminous material with pea stone and stone grits seal, prime coat of refined tar and double seal coat of cutback asphalt.	3195	S.Y.		
2. 3" Crushed gravel plant mixed.		S.Y.		
3. Cutback asphalt.		S.Y.		
4. Refined tar.		S.Y.		
5. Accumetal pipe.		LINEAL FEET		
6. Riprap.		CY		
7. Two cable guard rail.		LINEAL FEET		
8. Wood guide posts.		NO.		

ITEM	QUANTITY	UNIT	PRICE	TOTAL
1. Double tacked coat of bituminous material with pea stone and stone grits seal, prime coat of refined tar and double seal coat of cutback asphalt.	3195	S.Y.		
2. 3" Crushed gravel plant mixed.		S.Y.		
3. Cutback asphalt.		S.Y.		
4. Refined tar.		S.Y.		
5. Accumetal pipe.		LINEAL FEET		
6. Riprap.		CY		
7. Two cable guard rail.		LINEAL FEET		
8. Wood guide posts.		NO.		

THESE PLANS ARE SUBJECT TO SUCH REVISIONS AS MAY BE REQUIRED BY THE BUREAU OF PUBLIC ROADS OR THE COMMISSIONER OF HIGHWAYS.  
 CONSTRUCTION IS TO BE CARRIED ON IN ACCORDANCE WITH THE PLANS AND THE STANDARD SPECIFICATIONS FOR HIGHWAY AND BRIDGE CONSTRUCTION OF JANUARY 1956 SUBMITTED TO THE BUREAU OF PUBLIC ROADS AS APPROVED JULY 5, 1956, INCLUDING ALL SUBSEQUENT APPROVED REVISIONS AND SUCH REVISED SPECIFICATIONS AND SPECIAL PROVISIONS AS ARE SUBMITTED WITH THE PLANS.

NOTE: ANY FURTHER INFORMATION CONCERNING FINAL QUANTITIES, AMOUNTS OR OTHER DETAILS RELATIVE TO THIS PROJECT MAY BE OBTAINED EITHER FROM THE FIELD BOOKS OR THE ESTIMATE FILE.

APPROVED DATE 7/23/59	APPROVED DATE Aug 18, 1958	APPROVED DATE Aug 18, 1958	APPROVED DATE 7/23/58	APPROVED DATE Aug 18, 1958	APPROVED DATE Aug 18, 1958
--------------------------	-------------------------------	-------------------------------	--------------------------	-------------------------------	-------------------------------

DEPARTMENT OF COMMERCE BUREAU OF PUBLIC ROADS	
APPROVED	DATE
DISTRICT ENGINEER	
PROJECT DS-0161(1)	
SHEET 1 OF 20 SHEETS	