

PARCEL	INSTRUMENT	DATE	GRANTOR	GRANTEE	RECORDED	REMARKS
A	Q.C.D.	6-11-38	HARRY R. LOOMIS	ST. OF VT.	BOOK PAGE DATE	
A'	Q.C.D.	4-19-38	CHARLES H. BROWN	"	41 255 6-11-38	
					41 232 4-22-38	

**"NOTE"**  
 THE CONTRACTOR WILL BE REQUIRED TO REMOVE THE PRESENT CONCRETE SUPERSTRUCTURE. THIS WORK SHALL BE PAID FOR AT THE UNIT PRICE BID FOR ROCK EXCAVATION. THE OLD SUPERSTRUCTURE MAY BE USED AS RIP RAP, IF OF SATISFACTORY SIZE WITH THE APPROVAL OF THE ENGINEER.  
 PRESENT ABUTMENTS SHALL BE BUILT UP WITH CLASS C CONCRETE, FLUSH WITH THE TOP OF THE HAUNCHES, FULL WIDTH OF THE BRIDGE SEATS AND WELL DOWELED TO THE ABUTMENTS. DOWELS SHALL BE AT LEAST 3/4" 3'-0" LONG AND DOWELED INTO PRESENT ABUTMENTS 1'-0". AT LEAST TEN DOWELS FOR EACH ABUTMENT. COST OF DRILLING FOR AND SETTING DOWELS TO BE INCLUDED IN UNIT PRICE BID FOR REINFORCING STEEL.  
 THE FOLLOWING QUANTITIES ARE ALLOWED IN THE ESTIMATE FOR THIS WORK:  
 SOLID ROCK EACH - 38 CU YDS.  
 CONCRETE CLASS C - 7 CU YDS.  
 REINFORCING STEEL - 200 LBS.

BRIDGE DATA

TYPE	PRESENT	PROPOSED
CONCRETE T. BRIDGE	CONCRETE T. BRIDGE	CONCRETE T. BRIDGE
CLEAR SPAN	30'-0"	75'-0"
OVERALL SPAN	33'-0"	79'-0"
LEAD HEIGHT	9'-0"	10'-0"
ROADWAY WIDTH	22'-0"	22'-0"

QUANTITIES FOR BRIDGE ONLY

ITEM 10 SOLID ROCK EXCAV.	38 CY (SEE NOTE)
ITEM 16 STRUCTURE EXCAV.	82 CY
ITEM 18 MAINTENANCE OF TRAFFIC	1 L.S.
ITEM 41A CONCRETE CLASS A	57 CY
ITEM 41C CONCRETE CLASS C	64 CY
ITEM 44 REINFORCING STEEL	13263 LBS.
ITEM 56 TEMPORARY BRIDGE	1 L.S.
ITEM 80A CABLE GUARD RAIL	158 L.F.
" 42B STEEL SUPERSTRUCTURE (94,400")	1 L.S.
" 68 RIP RAP (HEAVY TYPE)	100 CY

LIST OF SHEETS FOR BRIDGE ONLY

SHEET 5 PLAN & PROFILE
SHEET 7 SUPERSTRUCTURE - S.J.B. 22 SQ.
SHEET 8 DETAILS OF ABUTS "9" 2
SHEET 13 30 SQ. DETAILS, P.L. & GENERAL NOTES
SHEET 14 50 SQ. UNDERCABLES, SIGNALS, ETC.
SHEET 15 50 SQ. CABLE GUARD RAIL
SHEET 16 30 SECTIONS

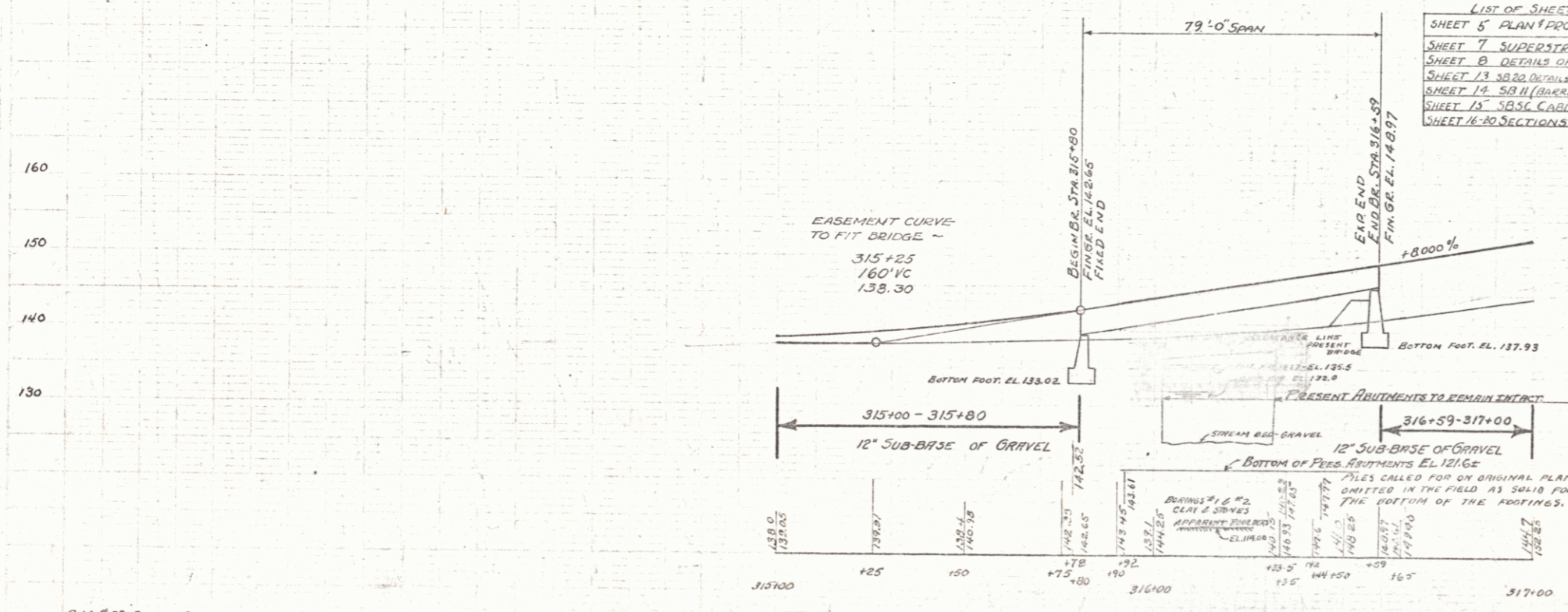

**NOTE:-**  
 ENDS OF WF BEAMS TO BE BEVEL CUT.  
 FILL IN FRONT OF ABUT. #2 TO BE ON A SLOPE OF 10% FROM HAUNCH ELEVATION AND RISE TO BE CARRIED UP TO ELEV. 135.00  
 FILL IN FRONT OF ABUT. #1 ON NORMAL SLOPE OF 10% AND RIP RAP CARRIED UP TO ELEV. 138.00  
 RIP RAP TO BE R.I.P. RAP FOR BANK PROTECTION (HEAVY TYPE) TO BE 2'-0" INTO STREAM BED OR BANK.

CASTLETON  
 PAGES #9  
 Sheet 5 of 20

REVISED APR. 1938. SPAN LENGTHENED TO 79'  
 RIP RAP ADDED.  
 REVISED APR. 16, 1938. REMOVAL OF PRESENT SUPERSTRUCTURE.