

WOODWARD RAIL REQUIRED  
 CULV. STA 198+00 24' 8"

REINF CONCRETE PIPE CULVERTS REQUIRED  
 STA 198+00 15' 36' 2.304 33'

PLAN	DATE	BY
NOTE BOOK		
NO.		

CURVE	DATE	BY

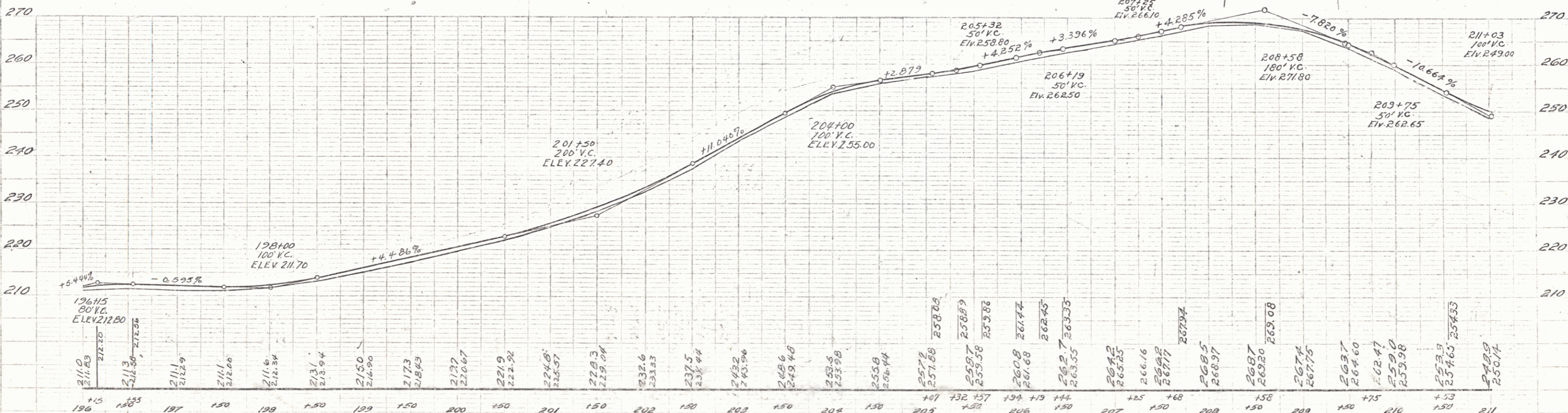
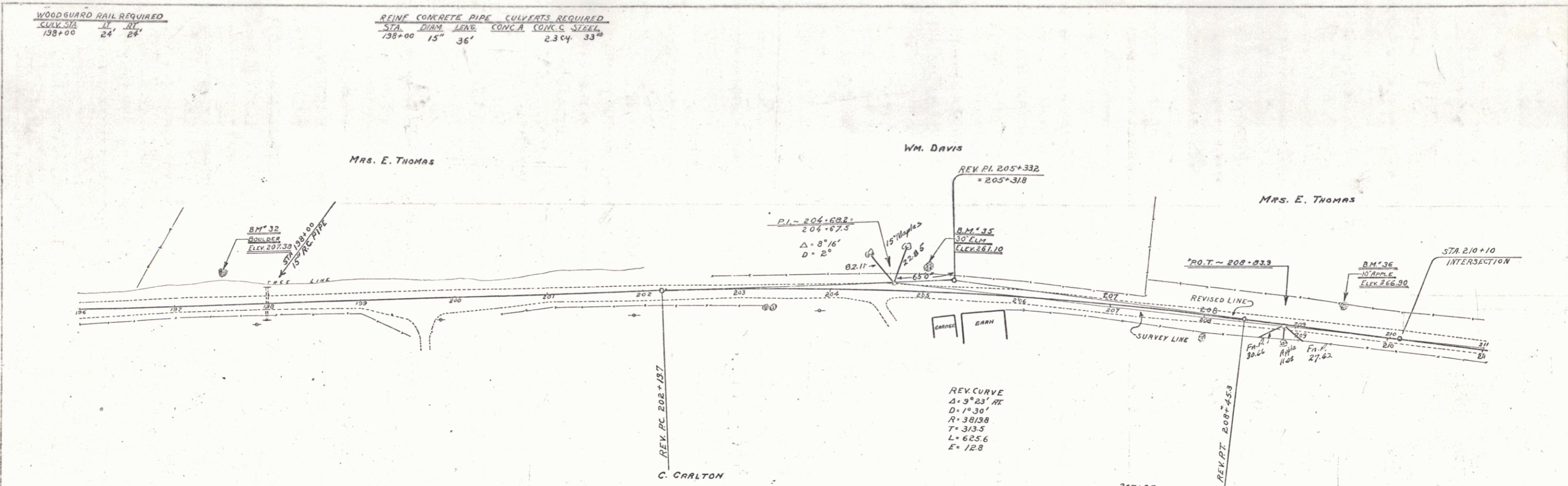

BM.No.32	Top of boulder 32' left	Sta 196+54	Elev. 207.38	
BM.No.33	Spike in 15' elm	left	Elev. 216.15	
BM.No.34	Spike in 6' maple	left	Elev. 235.81	
BM.No.35	Spike in 30' elm	21' left	Sta 205+05	Elev. 261.10
BM.No.36	Spike in 10' apple	24' left	Sta 209+50	Elev. 266.90

POULNEY-CASTLETON  
 SHEET 16 OF