

WOOD GUARD RAIL REQUIRED

CULV. STA.	LT.	RT.
159+52	24'	24'
159+63	24'	24'
162+63	24'	24'

REIN. CONCRETE PIPE CULVERTS REQUIRED

STA.	CHAM.	LENG.	CONG. A	CONC. C	STEEL
159+52	30"	36'	3.2 cy.	59#	
159+63	18"	36'	2.3 cy.	33#	
162+63	18"	40'	2.3 cy.	33#	

PLAN

DATE	1904
BY	W. H. B. S.
CHECKED	W. H. B. S.
SCALE	AS SHOWN
NO.	100

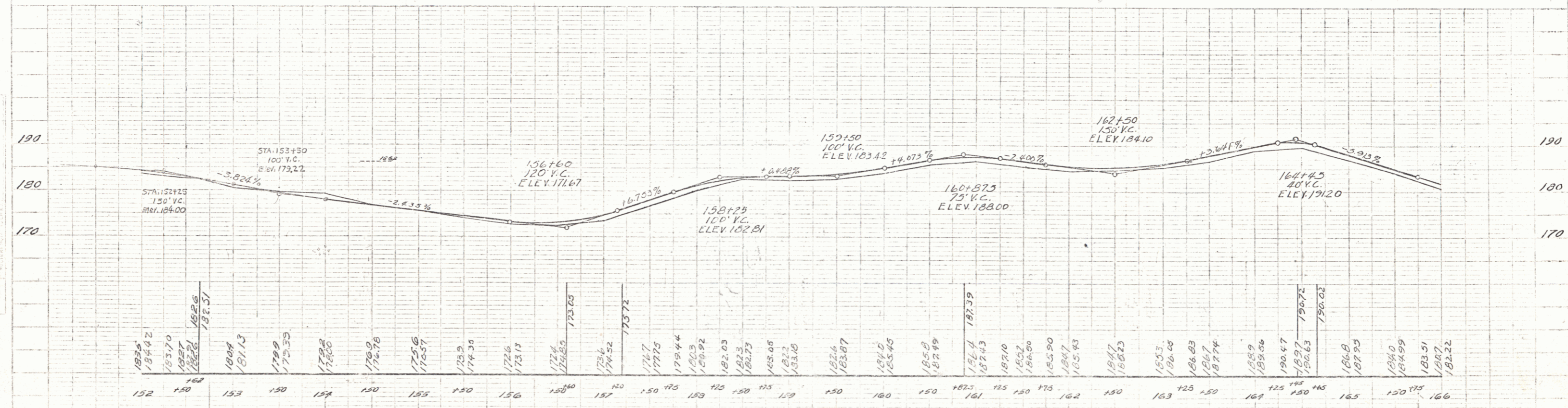
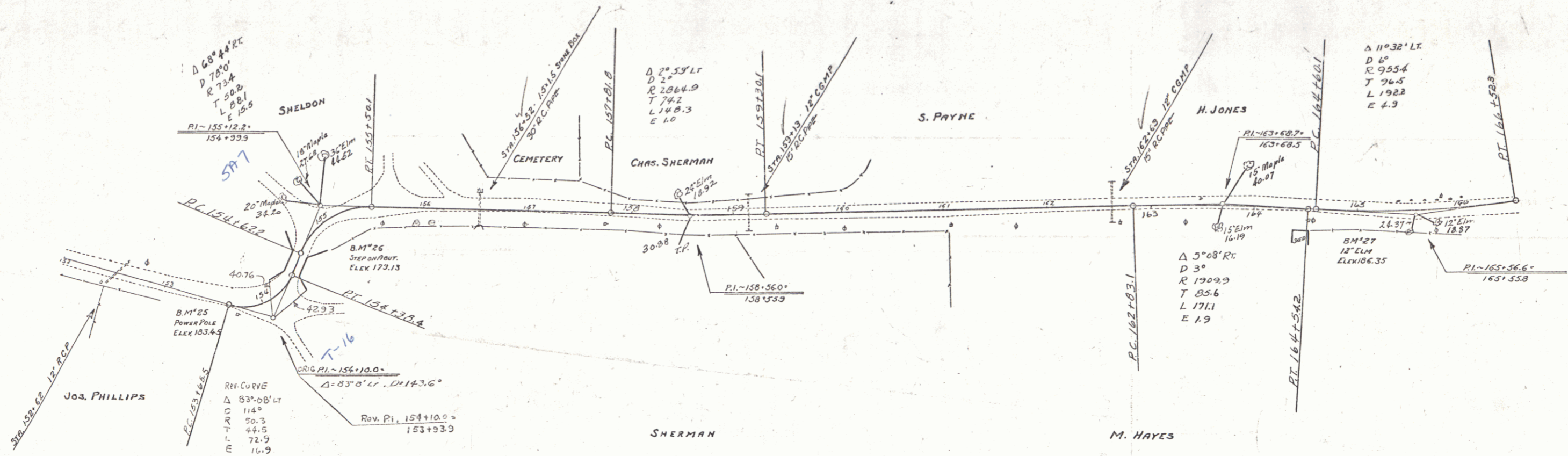

B.M. No. 25 Spire in 18" Power Pole 6 ft right of Sta 153+75 Elev. 183.45  
 B.M. No. 26 Lower Step NW Corner N Abutment Under Pass 21 ft right of Sta 155+25 Elev. 179.13  
 B.M. No. 27 Spire in 12" Elm 19 ft right of Sta 163+50 Elev. 196.35