

INDEX OF SHEETS

STATE OF VERMONT
DEPARTMENT OF HIGHWAYS

PROPOSED IMPROVEMENT

TOWN OF POULTNEY

COUNTY OF RUTLAND

VERMONT ROUTE # 30

BEGINNING AT A POINT 1.030 MILES
NORTHERLY OF THE WELLS-POULTNEY
TOWN LINE AND EXTENDING NORTHERLY
0.286 MILES

LENGTH OF ROADWAY 0.281 MILE
LENGTH OF BRIDGE 0.005 MILE
LENGTH OF PROJECT 0.286 MILE

1966 ADT	700
1987 ADT	1150
1987 DHV	280
D	5.4%
T	5%
V	50 MPH

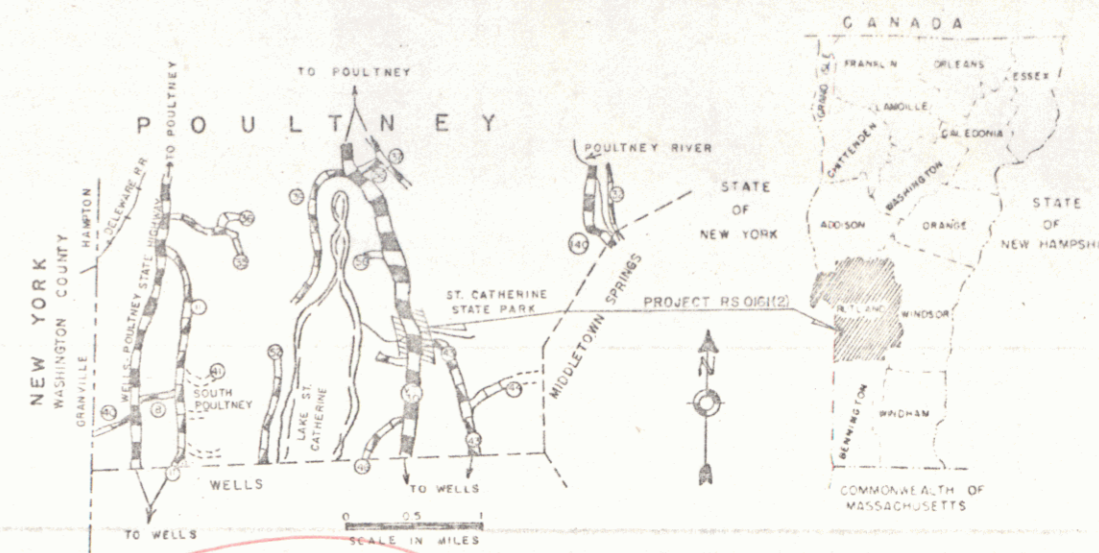

Project RS 016(2)
Pin 00R 373
Date 10/08/1969

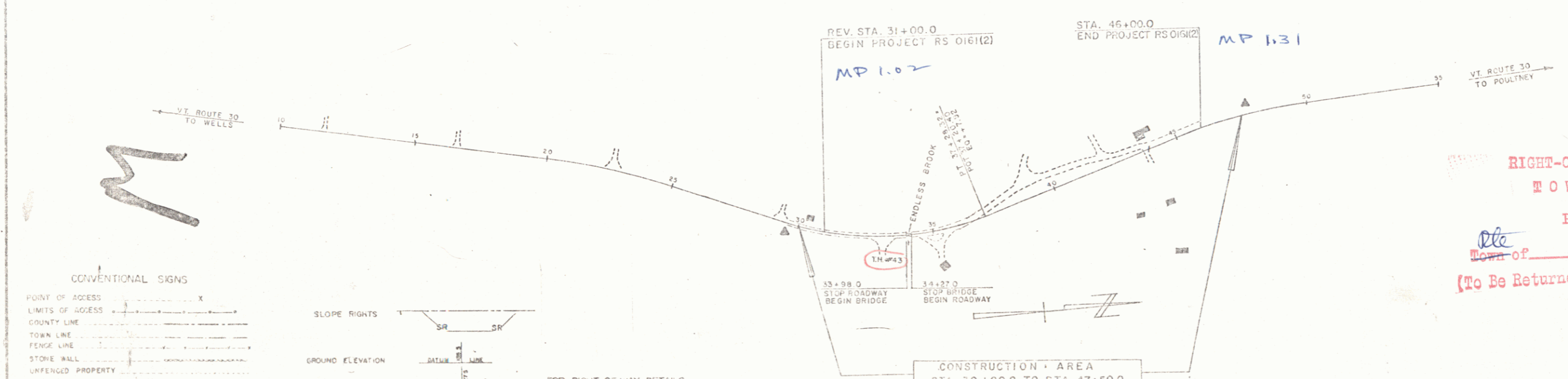

CONVENTIONAL SIGNS

POINT OF ACCESS	X
LIMITS OF ACCESS	---
COUNTY LINE	---
TOWN LINE	---
FENCE LINE	---
STONE WALL	---
UNFENCED PROPERTY	---
GUARD RAIL	---
TRAVELED WAY	---
RAILROAD	---
RETAINING WALL	---
CENTER LINE	---
SURVEY LINE	---
CULVERT	---
DROP RAIL	---
TROLLEY RAIL	---
POWER POLE	---
TELEPHONE POLE	---
TREES	---
HEDGE	---
ALL DIMENSIONS IN FEET	

SLOPE RIGHTS

GROUND ELEVATION

GRADE ELEVATION

CURVE DATA

DEFLECTION OF ANGLE	Δ
DEGREE OF CURVE	D
RADIUS OF CURVE	R
TANGENT DISTANCE	T
LENGTH OF CURVE	L
EXTERNAL DISTANCE	E
POINT OF INTERSECTION	PI
POINT OF CURVE	PC
POINT OF TANGENT	PT
POINT ON SUB-TANGENT	PST
ROAD LIMITS	---

FOR RIGHT OF WAY DETAILS,
SEE RIGHT OF WAY PLANS FOR THIS PROJECT.



RIGHT-OF-WAY DIVISION
TOWN FILE
PERPETUAL
Town of VT 30
(To Be Returned To R.O.W. Division)

THESE PLANS ARE SUBJECT TO SUCH REVISIONS AS MAY BE
REQUIRED BY THE BUREAU OF PUBLIC ROADS OR THE COMMISSIONER
OF HIGHWAYS.
CONSTRUCTION IS TO BE CARRIED ON IN ACCORDANCE WITH
THESE PLANS AND THE STANDARD SPECIFICATIONS FOR HIGHWAY AND BRIDGE
CONSTRUCTION DATED APRIL 1964, AS APPROVED BY THE BUREAU OF
PUBLIC ROADS ON OCTOBER 12, 1964, INCLUDING ALL SUBSEQUENT
APPROVED REVISIONS AND ALL REVISED SPECIFICATIONS AND SPECIAL
PROVISIONS AS ARE INCORPORATED IN THESE PLANS.

DEPARTMENT OF COMMERCE
BUREAU OF PUBLIC ROADS

APPROVED _____
DIVISION ENGINEER DATE _____

PROJECT RS NO. 016(2)
SHEET 1 OF 1 SHEETS

APPROVED <i>[Signature]</i> DATE 10/21/69 REGULATORY ENGINEER	APPROVED <i>[Signature]</i> DATE 10/21/69 DISTRICT ENGINEER	APPROVED <i>[Signature]</i> DATE 10/21/69 CONSTRUCTION ENGINEER	APPROVED <i>[Signature]</i> DATE 10/21/69 BRIDGE ENGINEER	APPROVED <i>[Signature]</i> DATE 10/21/69 TRAVEL ENGINEER	APPROVED <i>[Signature]</i> DATE 10/21/69 CITY ENGINEER
---	---	---	---	---	---