

GEORGE W. MELCHER JR. *File # 3*
 PARCEL I 0.7A±
 STA. 11+50 RT. - STA. 20+30 RT.

BEGIN PARCEL I MILE MARKER 4.701
 END PARCEL I MILE MARKER 4.853

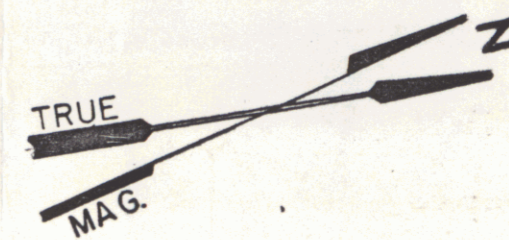

Town Wells
 Route VT 30
 Project BP0161-7501
 Pin 00R371
 Date 09/09/1974

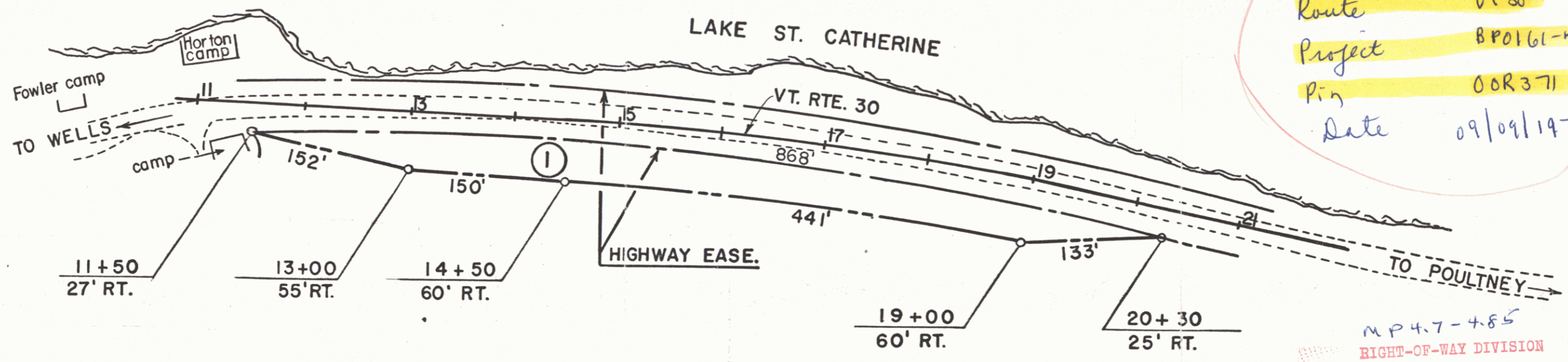

MP 4.7-4.85
 RIGHT-OF-WAY DIVISION
 TOWN FILE
 PERPETUAL
 Town of Wells
 [To Be Returned To R.O.W. Division]

STATE OF VERMONT
 DEPT. OF HIGHWAYS
 TOWN OF WELLS (1)
 PROJECT WELLS BP0161-7501
 APPROX. SCALE 1"=100' DATE 9-9-74 DRAWN BY KDP

