

CONSTRUCT DRIVES

Station	Area	Station	Area
061100 LI	066700 TR	067140 LI	067140 TR
061116 TR	067100 DR	067147 LI	067177 TR
063100 RT	074140 LI	064175 RT	074159 LI
061125 RT	075111 TR	062145 LI	075150 LI
063140 TR	057105 LI	064125 LI	073100 LI
067108 LI	073100 LI	067108 LI	073110 RT
062115-062140 LI	064176 RT		

Retain Present Guard Rail

CONSTRUCT APPROACH
Bal + 72 RT

CONSTRUCT MAILBOX TURNOUTS
#11A - 0.05 acre
#11B - 0.05 acre

Δ 30'00" LI ✓
D 34.5'
R 996.9
T 466.1
L 871.9
E 103.7
Bank 1/4 per foot

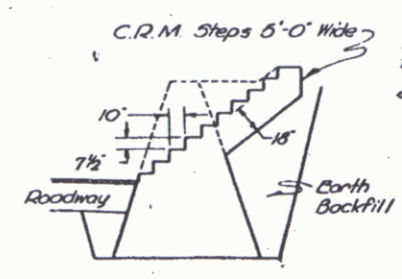

NON-GOV'T PARTICIPATION
875+12
Install Sleeve for water pipe, Item 103. Sleeve to be furnished by property owner.

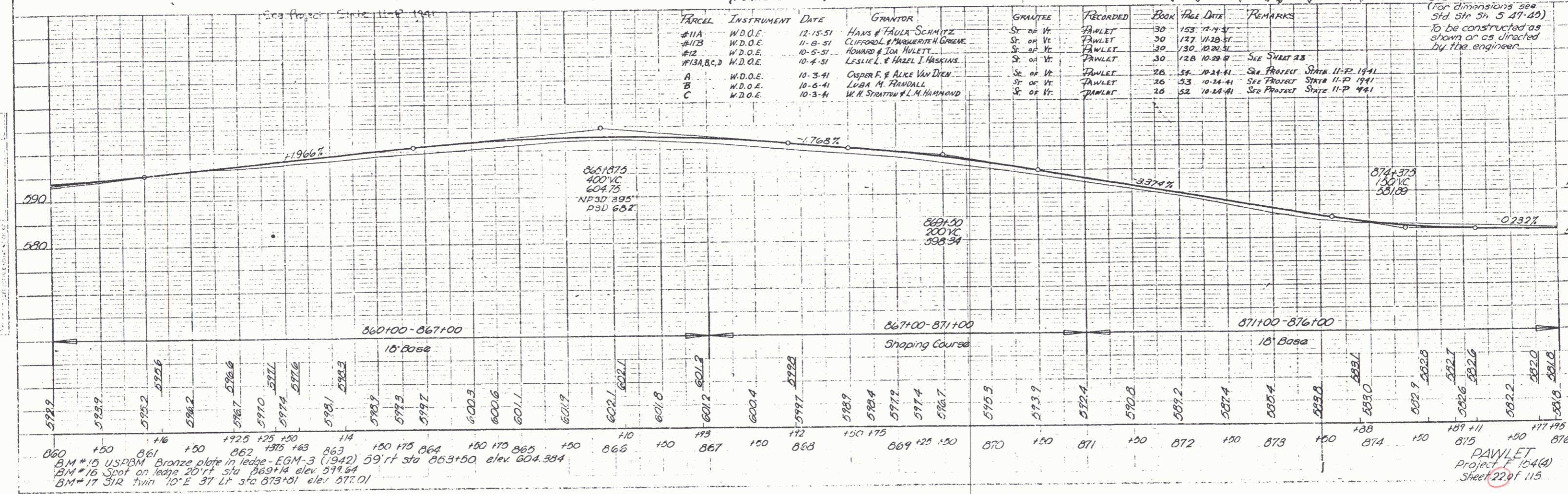

PARCEL	INSTRUMENT	DATE	GRANTOR	GRANTEE	RECORDED	BOOK	PAGE	DATE	REMARKS
#11A	W.D.O.E.	12-15-51	HANS & PAULA SCHMITZ	ST. OF VT.	FAWLET	30	153	12-15-51	
#11B	W.D.O.E.	11-8-51	CLIFFORD & MARGUERITE H. GREENE	ST. OF VT.	FAWLET	30	127	11-20-51	
#11C	W.D.O.E.	10-5-51	HOWARD & IDA HULETT	ST. OF VT.	FAWLET	30	130	10-26-51	
#13A, B, C	W.D.O.E.	10-4-51	LESLIE L. & HAZEL I. HASKINS	ST. OF VT.	FAWLET	30	128	10-29-51	SEE SHEET 28
A	W.D.O.E.	10-3-41	CYRIL F. & ALICE VAN DEN	ST. OF VT.	FAWLET	26	58	10-31-41	SEE PROJECT STRIP 11-P 1941
B	W.D.O.E.	10-5-41	LYON M. FARNALL	ST. OF VT.	FAWLET	26	53	10-24-41	SEE PROJECT STRIP 11-P 1941
C	W.D.O.E.	10-3-41	W. H. SPENTON & L. M. HANCOCK	ST. OF VT.	FAWLET	26	52	10-24-41	SEE PROJECT STRIP 11-P 1941

Section A-A
875+24 RT - C.R.M. Mobil at
(For dimensions see
Std. Str. 5h, 5 47-49)
To be constructed as
shown or as directed
by the engineer.

B.M. #15 USPBM Bronze plate in ledge - EGM-3 (1942) 59' RT STA 863+50 elev. 604.384
B.M. #16 Spot on ledge 20' RT STA 869+14 elev. 599.84
B.M. #17 31R twin 10' E 37' LT STA 873+01 elev. 572.01

FAWLET
Project 154(4)
Sheet 22 of 115