

INDEX OF SHEETS

SHEET NO. 1	TITLE PAGE	
" 2-24	TYPICAL CROSS-SECTION OF IMPROVEMENT	2-24 CRUSHED GRAVEL MIXED-IN-PLACE SURFACE COURSE WITH CUT-BACK ASPHALT
" 3	BANKING AND WIDENING TABLES	3 PRIME COAT OF REFINED TAR (ITEMS 26-30 #31)
" 4-12	PLAN AND PROFILE STA.	
" 13	STANDARD STRUCTURE SHEET	3-20 PIPE CULVERTS
" 14	"	3-30 GUARD RAIL
" 15	"	3-30A CATCH BASIN
" 16	"	3-31 BOUNDARY MARKERS
" 17	"	3-40 BARRICADES, ETC.
" 18	"	3-41 ROUNDED SLOPES
" 19-41	CROSS SECTIONS	

STANDARD STRUCTURE SHEETS APPROVED BY CHIEF ENGINEER
 320 JULY 24, 1933
 330 AUG 15, 1933
 3-31 JULY 23, 1934

STATE OF VERMONT
 STATE HIGHWAY DEPARTMENT

PLAN AND PROFILE OF PROPOSED
 STATE HIGHWAY

FEDERAL AID PROJECT
 SECONDARY

TOWN OF DORSET

MANCHESTER-DORSET ROAD

BEGINNING AT A POINT 2.103 MI. FROM THE DORSET-MANCHESTER TOWN LINE & EXTENDING N. WESTERLY 1.444 MI. TO A POINT 0.149 MI. NORTH WESTERLY OF THE INTERSECTION OF ROUTE 30 WITH THE E. RUPERT ROAD IN DORSET VILLAGE.

Route Vt 30
 Project FAS 11A
 Pin 00R362
 Date 09/20/1937

FED. ROAD DIST. NO.	STATE	F. A. D. PROJ. NO.	TYPICAL SHEET NO.	TOTAL SHEETS
9	VT.	11-A	1	41



Scale: 1 inch = 1 Mile

LENGTH OF PROJECT 7624.7 FT. = 1.444 MI.

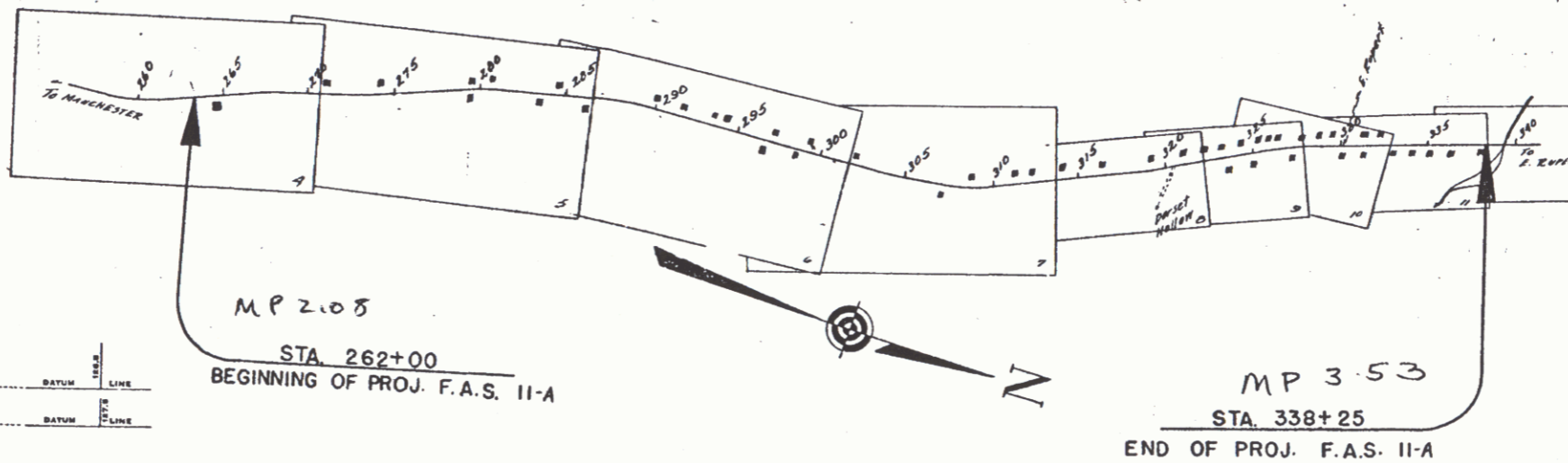

RIGHT-OF-WAY DIVISION
 TOWN FILE
 PERPETUAL
 Town of U+30
 (To Be Returned To R.O.W. Division)

RECORD PLANS

APPROVED: *[Signature]*
 COMMISSIONER OF HIGHWAYS
 SUBMITTED BY ORDER OF THE STATE HIGHWAY BOARD

NOTE: ALL FURTHER REVISIONS TO THESE PLANS MUST BE MADE IN ACCORDANCE WITH THE RULES AND REGULATIONS OF THE BUREAU OF PUBLIC ROADS.

COUNTY LINE	CONVENTIONAL SIGNS	GROUND ELEVATION	BATHYM LINE
TOWN LINE		GRADE ELEVATION	BATHYM LINE
FENCE LINE			
STONE WALL			
UNFENCED PROPERTY			
GUARD RAIL			
TRAVELED WAY			
RAILROAD			
RETAINING WALL			
CENTER LINE			
CULVERT			
DROP INLET			
TROLLEY POLE			
POWER POLE			
TELEPHONE POLE			
TREES			
HEDGE			

DORSET F.A.S. - 1-A
 BY HARVEY J. SON
 RECORD PLANS BY R. P. [Signature]

SCALES	
TITLE	1" = 500'
TYPICAL	1" = 2'
PLAN	1" = 50'-20'
PROFILE	1" = 10'
CROSS SECTIONS	1" = 3'

These plans are subject to such revisions as may be required by the Bureau of Public Roads or the Commissioner of Highways. Construction is to be carried on in accordance with the plans and standard road & bridge specifications as approved Dec. 29, 1936 by the Bureau of Public Roads including all subsequent approved revisions and such revised specifications and special provisions as are submitted with the plans.

RECOMMENDED [Signature]
 DISTRICT ENGINEER BUREAU OF PUBLIC ROADS
 RECOMMENDED FOR APPROVAL [Signature]
 CHIEF ENGINEER BUREAU OF PUBLIC ROADS
 APPROVED [Signature]
 DIRECTOR BUREAU OF PUBLIC ROADS

APPROVED <i>[Signature]</i> District Highway Commissioner	APPROVED <i>[Signature]</i> Chief Engineer	SERIES F.A.S. NO. 11-A FILED
		SHEET 1 OF 41