

INDEX OF SHEETS

SHEET NO. 1	TITLE PAGE
2	TYPICAL CROSS-SECTION OF IMPROVEMENT (GRADING, DRAINAGE, BASE, GUARD RAIL WITH BARRIERS AND WIDENING TABLES)
3	PLAN AND PROFILE
4	STANDARD STRUCTURE SHEET S 29 PIPE CULVERTS
5	S 30 GUARD RAIL
6	S 30A BOUNDARY MARKERS
7	S 40 BARRICADES SIGNS AND LIGHTS
8	S 41 TYPICAL GRADING CROSS SECTIONS
9-13	CROSS SECTIONS

STANDARD STRUCTURE SHEETS APPROVED BY THE CHIEF ENGINEER.

S 29	4-28-41
S 30	5-12-41
S 30A	4-19-41
S 40	9-5-40

STATE OF VERMONT
STATE HIGHWAY DEPARTMENT

PLAN AND PROFILE OF PROPOSED
STATE HIGHWAY

TOWN OF TOWNSHEND
VERMONT ROUTE 30

BEGINNING AT A POINT 3.1 MILES NORTHWESTERLY OF THE NEWFANE-TOWNSHEND TOWN LINE AND EXTENDING NORTHWESTERLY 0.903 MILES.

LENGTH OF PROJECT 4771.9 LF = 0.903 MI.
4771.9 0.902

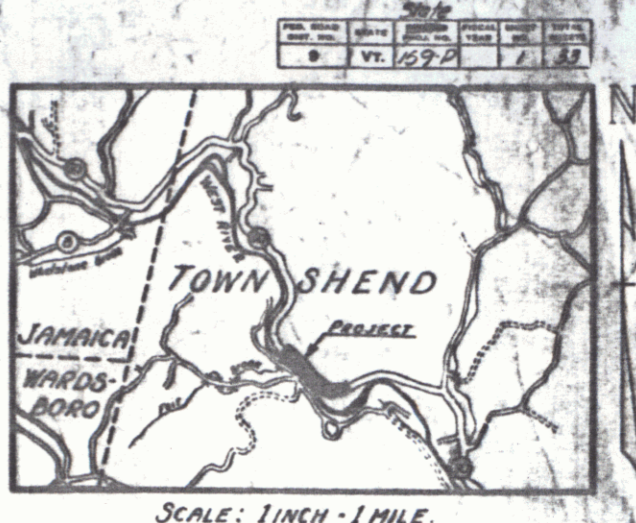

Project SF 159P
Pin OOR 358
Date 08/20/1941

RECORD PLANS
By W.H. Chase

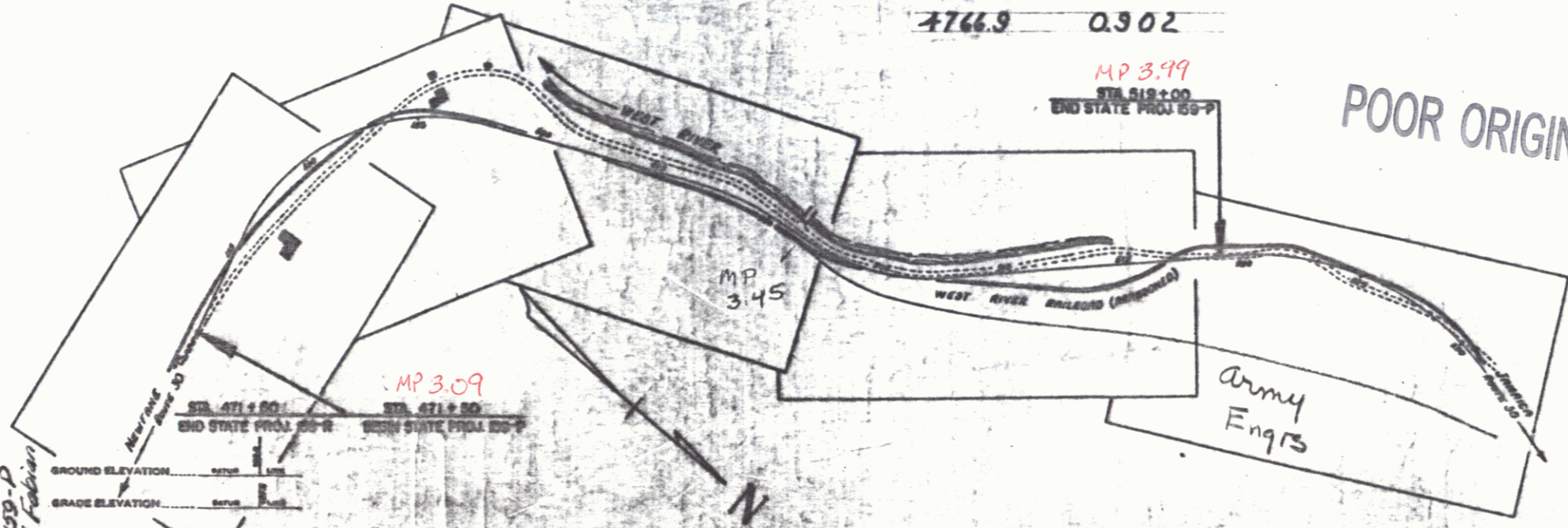

POOR ORIGINAL COPY

COUNTY LINE	---
TOWN LINE	---
FENCE LINE	---
STONE WALL	---
UNFENCED PROPERTY	---
GUARD RAIL	---
TRAVELED WAY	---
RAILROAD	---
RETAINING WALL	---
CENTER LINE	---
SURVEY LINE	---
CULVERT	---

CURVE DATA

DEFLECTION ANGLE	Δ
DEGREE OF CURVE	D
RADIUS OF CURVE	R
TANGENT DISTANCE	T

SCALES

TITLE	1" = 300 FT.
TYPICAL	1" = 10 FT.
PLAN	1" = 50 FT.
PROFILE	1" = 20 FT.

THESE PLANS ARE SUBJECT TO SUCH REVISIONS AS MAY BE REQUIRED BY THE PUBLIC ROADS ADMINISTRATION OR THE COMMISSIONER OF HIGHWAYS.
CONSTRUCTION IS TO BE CARRIED ON IN ACCORDANCE WITH THE PLANS AND THE STANDARD ROAD AND BRIDGE SPECIFICATIONS OF 1938, AS REVISED DECEMBER 29TH, 1938 BY THE PUBLIC ROADS ADMINISTRATION, INCLUDING ALL SUBSEQUENT APPROVED

APPROVED: August 20, 1941
[Signature]
COMMISSIONER OF HIGHWAYS

RECOMMENDED FOR APPROVAL
[Signature]
APPROVED

1