

**INDEX OF SHEETS**

SHEET NO.	1	TITLE PAGE
2	TYPICAL CROSS-SECTION OF IMPROVEMENT (CRUSHED GRAVEL MIXED IN PLACE SURFACE COURSE WITH REFINED TAR, ITEM 34) (MODIFIED)	
3	BANKING AND WIDENING TABLES	
4	QUANTITY SHEET (ITEMS)	
5	QUANTITY SHEET (DRAINAGE)	
6-9	EARTHWORK SHEETS	
10-19	PLAN AND PROFILE SHEETS	
20	PRELIMINARY INFORMATION SHEET	
21	PLAN AND SECTIONS OF SUPERSTRUCTURE	
22	PLAN AND ELEVATIONS OF SUBSTRUCTURE	
23	ABUTMENTS NO. 1 AND NO. 2	
24	PIERS NOS. 1, 2 AND 3	
25	SUPERSTRUCTURE	
26	BEARING DEVICES	
27	DETAILS OF COVER AND SPLICE PLATES	
28	EXPANSION PLATE DETAILS	
29	CURB AND RAIL DETAILS	
30	APPROACH SLABS	
31-35	CHANNEL SECTIONS	
36A	EARTHWORK SHEET - BRIDGE QUANTITIES	
37	STANDARD STRUCTURE SHEET SB 2 DETAIL - S 206	
38	STANDARD STRUCTURE SHEET SB 11 BARRICADES, SIGNS AND LIGHTS (BRIDGE)	
39	STANDARD STRUCTURE SHEET SB 20 DETAILS D, E, F, I, J, AND K	
40	DETAILS OF 4' X 6' R.C. BOX EXTENSION	
41	STANDARD STRUCTURE SHEET S 40 BARRICADES, SIGNS AND LIGHTS ROADWAY	
42	STANDARD STRUCTURE SHEET S 41 ROUNDING OF SLOPES	
43	STANDARD STRUCTURE SHEET S 46-45 BOUNDARY MARKERS	
44	STANDARD STRUCTURE SHEET S 47-45 PIPE CULVERTS	
45	STANDARD STRUCTURE SHEET S 48-46 THREE CABLE GUARD RAIL	
46	STANDARD STRUCTURE SHEET DEAD END ANCHORAGE AT BRIDGE APPROACH	
47-56	CROSS SECTIONS	

STANDARD STRUCTURE SHEETS APPROVED BY THE CHIEF ENGINEER, VERMONT STATE DEPARTMENT OF HIGHWAYS.

SB-11 DEC 18, 1945  
S-40 FEB 28, 1949  
S-46-45 FEB 28, 1949  
S-47-45 FEB 28, 1949  
S-48-46 MAY 13, 1946

STATE OF VERMONT  
STATE HIGHWAY DEPARTMENT

# PLAN AND PROFILE OF PROPOSED STATE HIGHWAY

SECONDARY PROJECT

## TOWN OF TOWNSHEND

COUNTY OF WINDHAM  
BRATTLEBORO-MANCHESTER ROAD  
VERMONT ROUTE 30

BEGINNING AT THE NEWFANE-TOWNSHEND TOWN LINE AND EXTENDING NORTHWESTERLY 4,720.0 FEET.

LENGTH OF ROADWAY 4,273.94 FT. = 0.809 MI.  
LENGTH OF BRIDGE 446.06 FT. = 0.085 MI.  
LENGTH OF PROJECT 4,720.00 FT. = 0.894 MILE

NAME AND NUMBER	TYPE
Townshend R. 3 159 (2)	Cont. vt. Bm Pt. 30 Newl. 4. 11x6" Spans. 2. 1'6" wide 3. 1'
RECORD PLANS	
MATERIALS	
Cement	Wendell, Lehigh
Agg. Co. Conc.	Northfield Washed Sand & Gravel Co.
Crushed Gravel	Met. Culvert Pipe
Pre. Stone	Gravel Sub. Base
Reinf. Steel	Crushed Gravel Sub. Base
Struct. Steel	Gravel Spreaders
Wire Cable	Cable Raw Point
Guard Rail	Grosveld, Warner Co.
Contractor - W. H. Morse	Contract Date - June 22, 1950
Res. Engr. - W. V. Kallio, C.A.P. Plumb, W.B.M. Allister	Construction begun - July 10, 1950
T. Finnello	Construction suspended - Dec. 16, 1951 (Resumed Mar. 1, 1952)
Record Plans - J. G. & D. W. R.	Project then completed Oct. 9, 1952

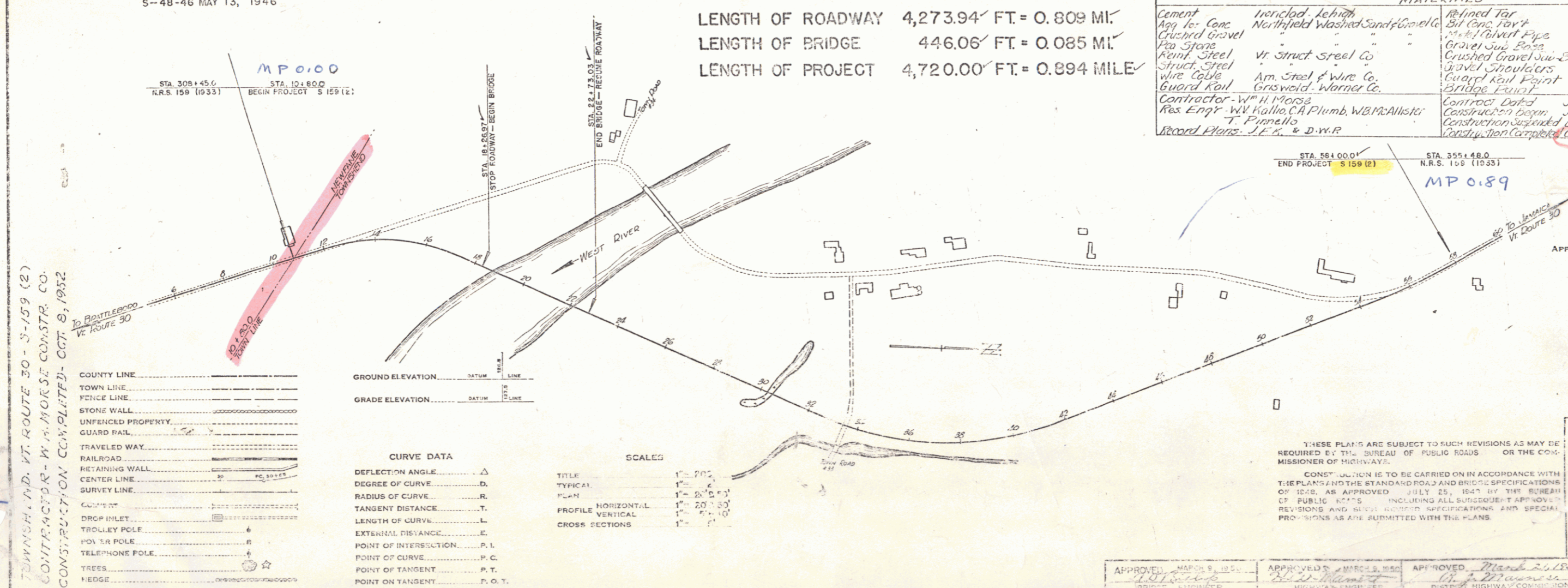
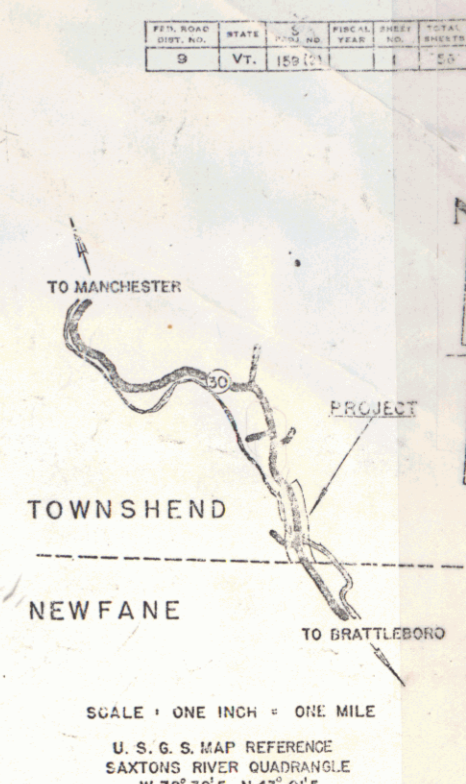

TOWNSHEND, Vt. ROUTE 30 - S-159 (2)  
CONTRACTOR - W. H. MORSE CONSTR. CO.  
CONSTRUCTION COMMENCED - OCT. 8, 1952

APPROVED: MARCH 20, 1950  
H. E. Jenkins  
CHIEF ENGINEER  
SUBMITTED BY ORDER OF THE STATE HIGHWAY BOARD

THESE PLANS ARE SUBJECT TO SUCH REVISIONS AS MAY BE REQUIRED BY THE BUREAU OF PUBLIC ROADS OR THE COMMISSIONER OF HIGHWAYS.

CONSTRUCTION IS TO BE CARRIED ON IN ACCORDANCE WITH THE PLANS AND THE STANDARD ROAD AND BRIDGE SPECIFICATIONS OF 1948, AS APPROVED JULY 25, 1947 BY THE BUREAU OF PUBLIC ROADS, INCLUDING ALL SUBSEQUENT APPROVED REVISIONS AND SUCH MODIFIED SPECIFICATIONS AND SPECIAL PROVISIONS AS ARE SUBMITTED WITH THE PLANS.

DEPARTMENT OF COMMERCE  
BUREAU OF PUBLIC ROADS  
RECOMMENDED FOR APPROVAL

DISTRICT ENGINEER DATE

APPROVED Pin # 008354  
DIVISION ENGINEER D. E.

APPROVED: MARCH 9, 1950  
S. J. Jenkins  
BRIDGE ENGINEER

APPROVED: MARCH 9, 1950  
G. A. Jenkins  
HIGHWAY ENGINEER

APPROVED: March 20, 1950  
G. A. Jenkins  
DISTRICT HIGHWAY COMMISSIONER

SERIES S NO. 1037 PROJECT  
SHEET 0 OF 5

STEARNS R. JENKINS  
Rt 20 1