

Lt Sta 161.30 to 17+0  
 Rt Sta 14+0 to 17+90  
 New 3 Cable Guard  
 Item 542

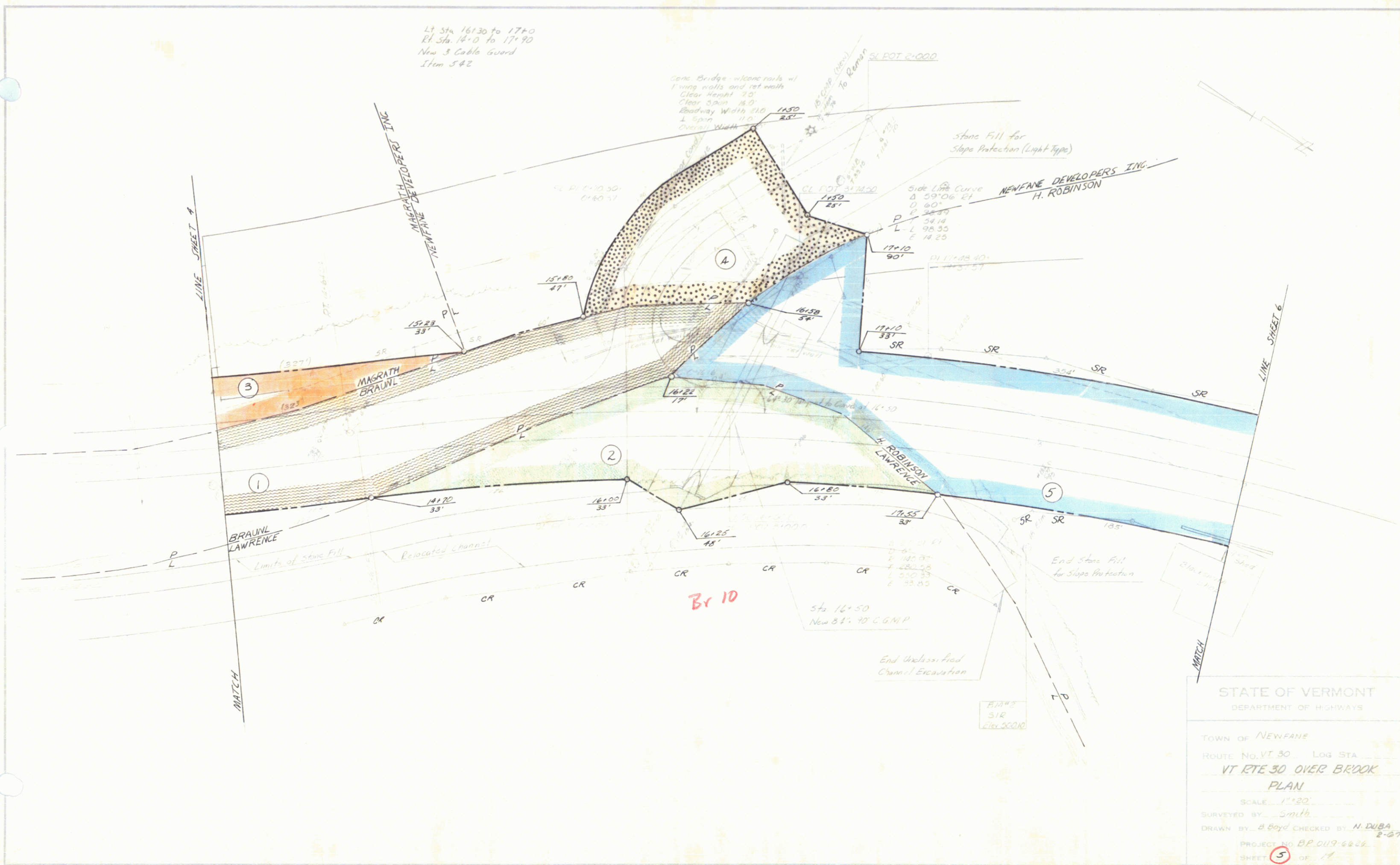

STATE OF VERMONT	
DEPARTMENT OF HIGHWAYS	
TOWN OF NEWFANE	ROUTE No. VT 30 LOG STA.
VT RTE 30 OVER BROOK	
PLAN	
SCALE 1"=20'	
SURVEYED BY Smith	
DRAWN BY B. Boyd CHECKED BY N. DUBA	
PROJECT NO. BP-019-6826	
SHEET 5 OF 11	